

SUPPORT PANEL THICKNESS:

- 1 TO 6MM/0.4 TO 0.24", (METAL)
- 2 TO 6MM/0.8 TO 0.24", (PLASTIC)

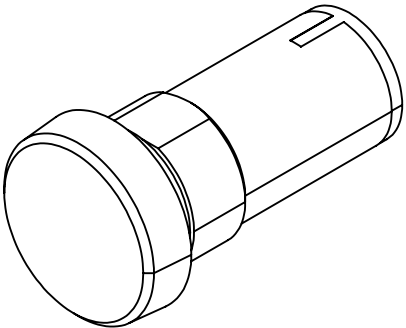

ISOMETRIC VIEW

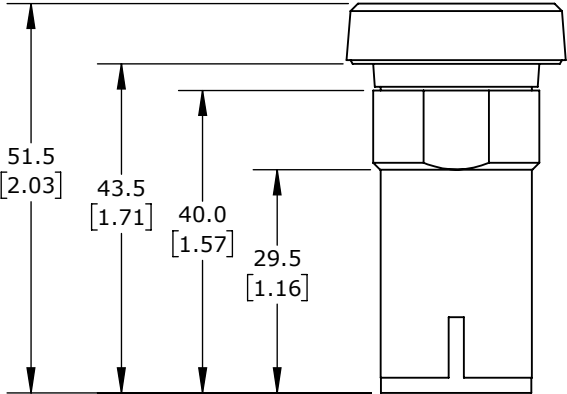
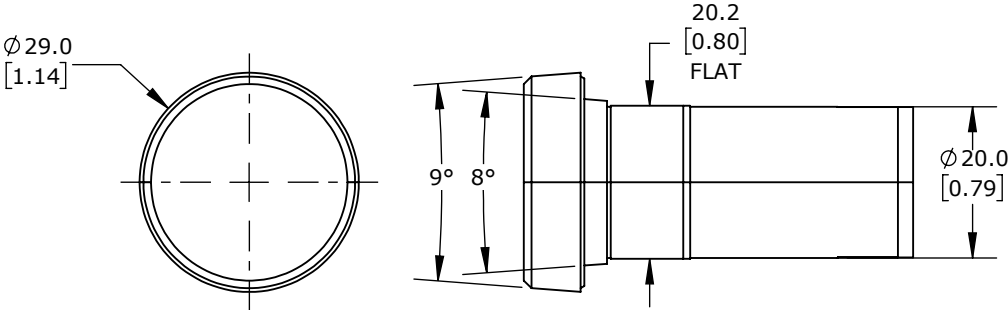

IDEM COMPACT PUSHBUTTON, IP65, 22MM, MOMENTARY, (1) N.O./(1) N.C. CONTACT(S), PLASTIC BASE, PLASTIC BEZEL, OPERATOR: BLACK, FLUSH, 22MM, ROUND, PLASTIC. FOR USE WITH UGB SERIES UNIVERSAL GATE



3rd
ANGLE

NOT TO
SCALE

PART DIMENSIONS MAY DIFFER SLIGHTLY
DUE TO MANUFACTURER'S VARIANCES

METRIC UNITS USED
FOR PART DESIGN

UNLESS OTHERWISE
SPECIFIED UNITS ARE:

mm
[inch]

LATEST VERSION
6/25/2024

SHEET 1 OF 1

522335

AutomationDirect.com
1-800-633-0405