

ENCLOSURE ASSEMBLY TOP VIEW

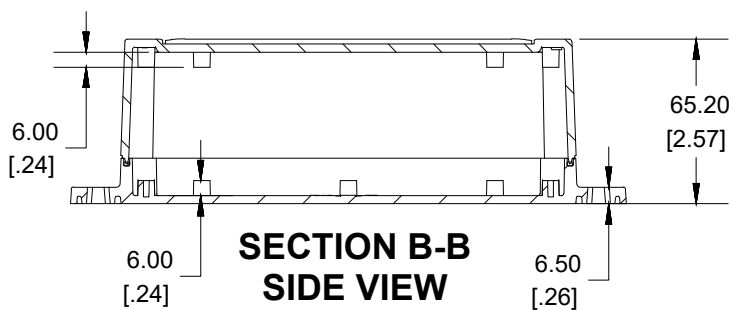

SECTION B-B SIDE VIEW

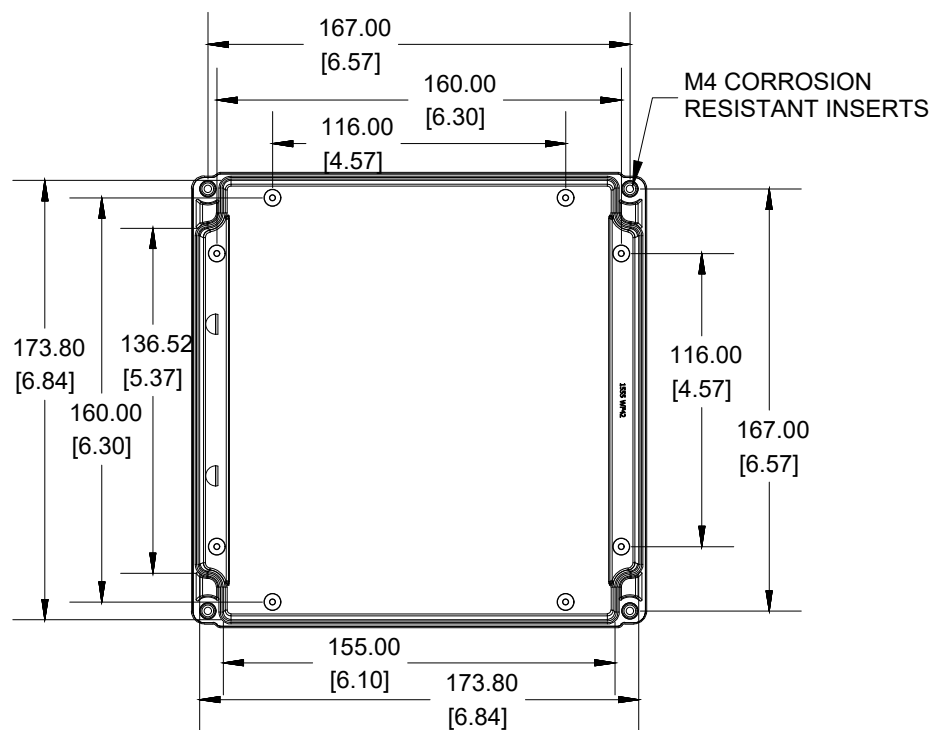

INSIDE BOX VIEW

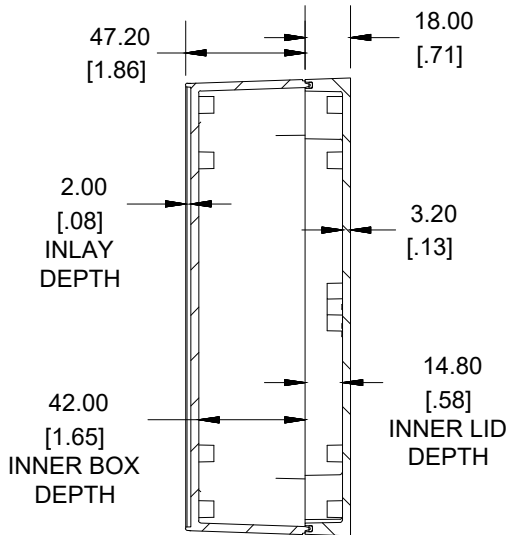

SECTION A-A END VIEW

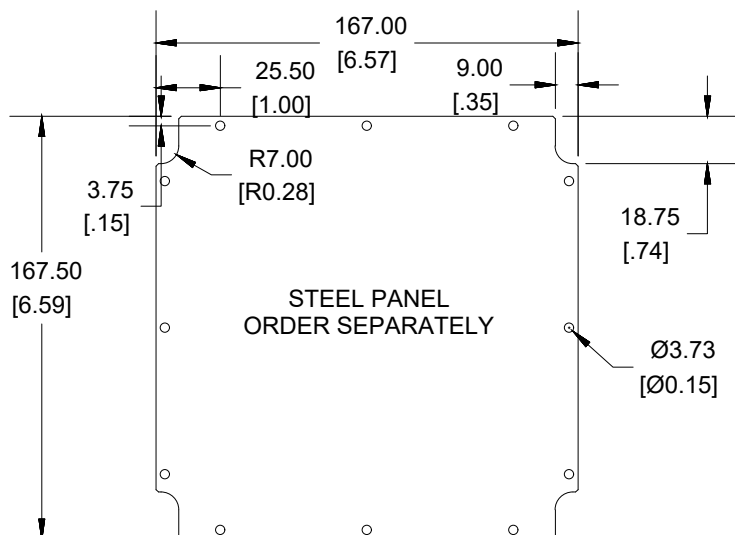

STEEL PANEL ORDER SEPARATELY

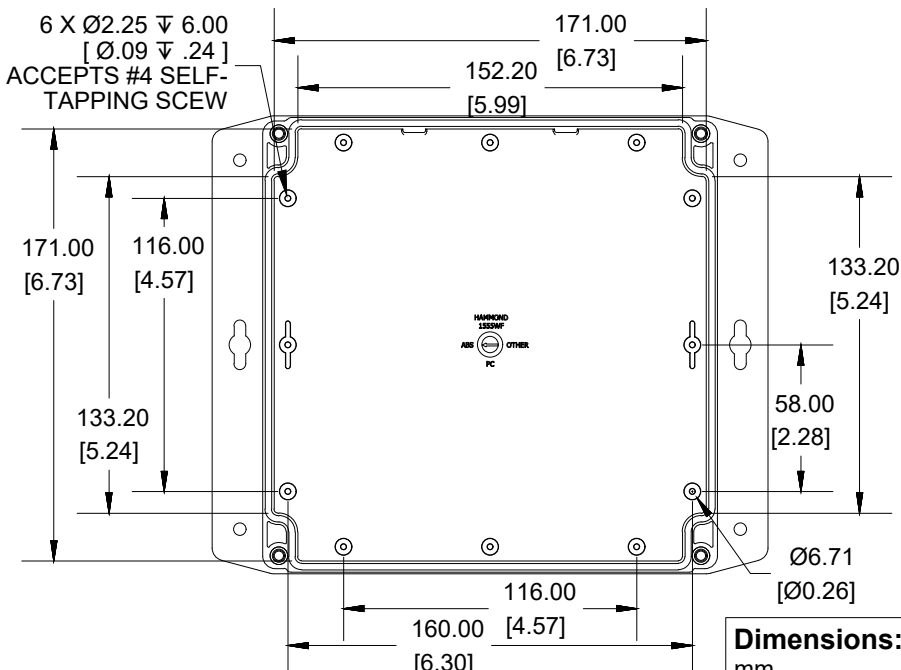

INSIDE LID VIEW

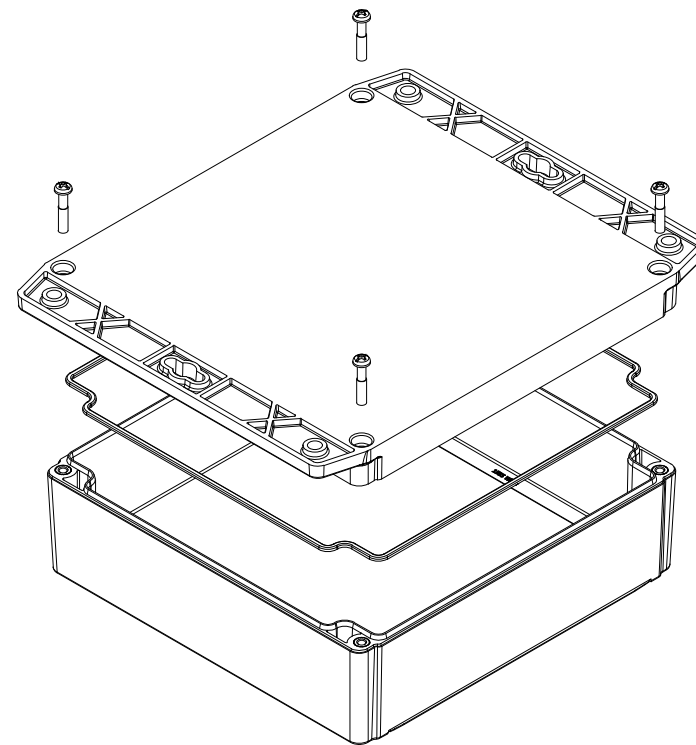

POLYCARBONATE VERSION ONLY

UL US LISTED

FILE #E65324

TYPE 4,4X,6,6P

Enclosures can be Factory Modified (Milling, Drilling, Printing etc.)  
Contact Factory (modshop@hammfg.com) for quotes  
Solid models of this enclosure available in .stp or .x\_t  
(Part number and text placement/orientation on our products are subject to change, we do not recommend using them as a locating reference for modification purposes)

NOTE

Purchased assembly includes styled box, flanged lid, 4 cover screws, and preformed silicone gasket.  
General Purpose ABS version is not UL approved. (Matl UL94 - HB)  
Polycarbonate version is UL 508 approved. (Matl UL94 - 5VA @ 3mm)

Recommended Cover screw torque -- 2.5 lbf-in (30 cN-m)

1555WF

1555WF Regular Enclosure

|   |             |
|---|-------------|
| General Purpose ABS RAL-7035  | 1555WF42GY  |
| Polycarbonate RAL-7035  | 1555W2F42GY |
| ACCESSORIES   |             |
| Steel Inner Panels  | 1554WPL     |
| Silicone Pre-formed Gasket Black (Pkg 2)                                  | 1554WGASKET |
| Steel Panel / P.C. Board Self Tapping Screw<br>[#4 X 1/4" (6.4mm) Plated] | 1555TS100   |
| Stainless Steel Cover Screws<br>[M4-0.7 X 20mm] (Pkg 50)                  | SC576-50    |

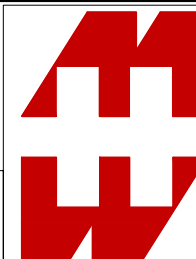

HAMMOND  
MANUFACTURING®

1555WF42

www.hammondmfg.com

Dimensions:  
mm  
[inches]