

ISOMETRIC VIEW

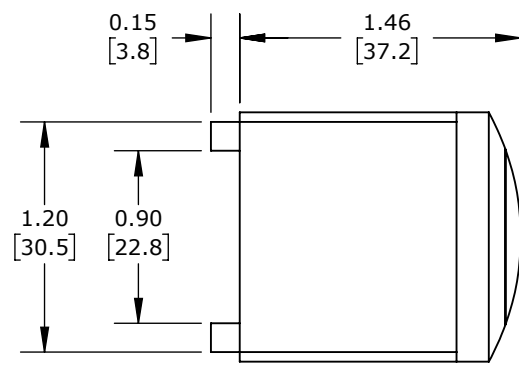

STEGO THERMOSTAT, ADJUSTABLE, N.O. (CLOSE ON RISE) 14 TO 122 DEG F, 12.6 DEG F SWITCHING DIFFERENTIAL, 35MM DIN RAIL MOUNT, FOR ELECTRICAL ENCLOSURE CLIMATE CONTROL.					111019-01			AutomationDirect.com 1-800-633-0405	
	3rd ANGLE	NOT TO SCALE	PART DIMENSIONS MAY DIFFER SLIGHTLY DUE TO MANUFACTURER'S VARIANCES	METRIC UNITS USED FOR PART DESIGN	UNLESS OTHERWISE SPECIFIED UNITS ARE:	inch [mm]	LATEST VERSION 7/28/2022	SHEET 1 OF 1	