

ISOMETRIC VIEW

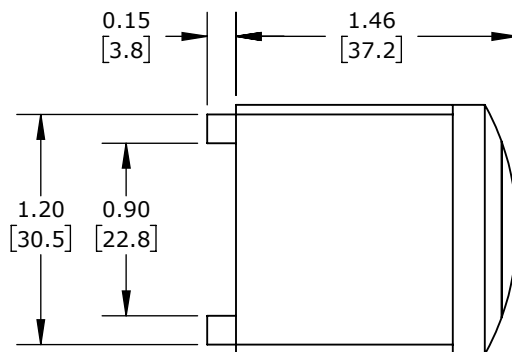

STEGO THERMOSTAT, ADJUSTABLE, N.C. (OPEN ON RISE) 32 TO 140 DEG F, 12.6 DEG F SWITCHING DIFFERENTIAL, 35MM DIN RAIL MOUNT, FOR ELECTRICAL ENCLOSURE CLIMATE CONTROL.

111009-00

AutomationDirect.com
1-800-633-0405



3rd
ANGLE

NOT TO
SCALE

PART DIMENSIONS MAY DIFFER SLIGHTLY
DUE TO MANUFACTURER'S VARIANCES

METRIC UNITS USED
FOR PART DESIGN

UNLESS OTHERWISE
SPECIFIED UNITS ARE:

inch
[mm]

LATEST VERSION
7/28/2022

SHEET 1 OF 1