

DETAIL A
SCALE 2:1

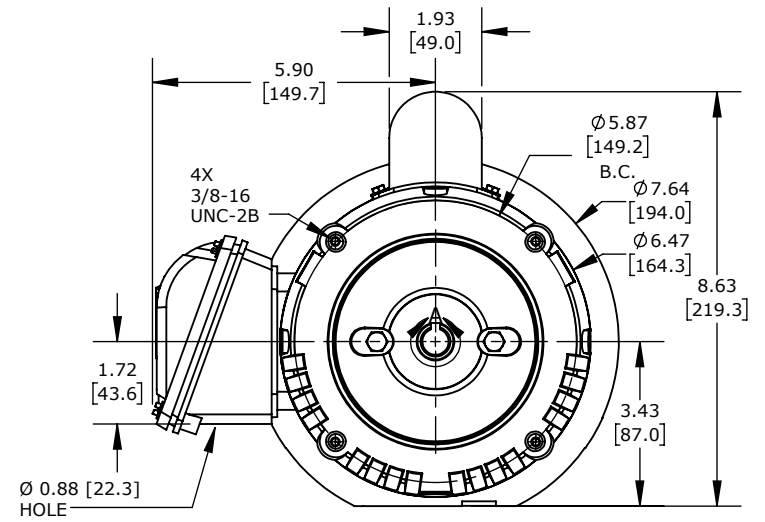

WEG ELECTRIC S SERIES STANDARD EFFICIENCY AC INDUCTION MOTOR, GENERAL PURPOSE, 3/4HP, 1-PH, 115/208-230 VAC, 1800RPM, TEFC, 56C FRAME, ROLLED STEEL, C-FACE ONLY MOUNT

.7518ES1B56CFL-S

AutomationDirect.com
1-800-633-0405

	3rd ANGLE	NOT TO SCALE	PART DIMENSIONS MAY DIFFER SLIGHTLY DUE TO MANUFACTURER'S VARIANCES	METRIC UNITS USED FOR PART DESIGN	UNLESS OTHERWISE SPECIFIED UNITS ARE:	inch [mm]	LATEST VERSION 12/7/2022	SHEET 1 OF 1
--	--------------	-----------------	--	--------------------------------------	--	--------------	-----------------------------	--------------