

DETAIL A  
SCALE 2:1

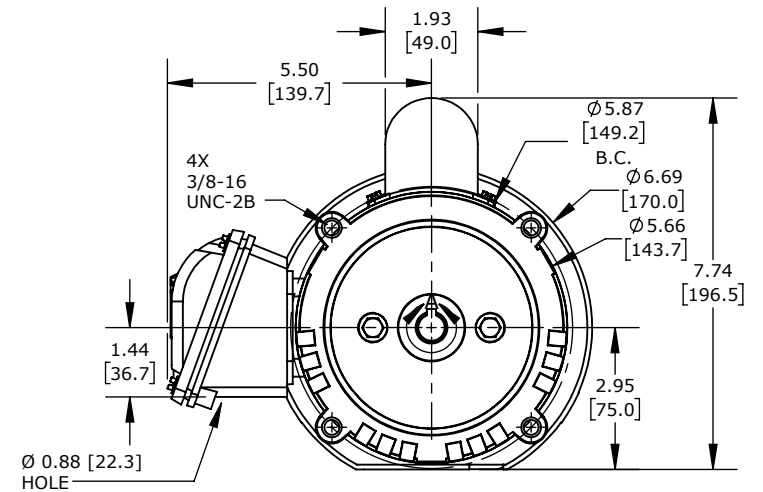

WEG ELECTRIC S SERIES STANDARD EFFICIENCY AC INDUCTION MOTOR, GENERAL PURPOSE, 1/2HP, 1-PH, 115/208-230 VAC, 3600RPM, TEFC, 56C FRAME, ROLLED STEEL, C-FACE ONLY MOUNT

.5036ES1BW56CFL-S

AutomationDirect.com  
1-800-633-0405



3rd  
ANGLE

NOT TO  
SCALE

PART DIMENSIONS MAY DIFFER SLIGHTLY  
DUE TO MANUFACTURER'S VARIANCES

METRIC UNITS USED  
FOR PART DESIGN

UNLESS OTHERWISE  
SPECIFIED UNITS ARE:

inch  
[mm]

LATEST VERSION  
12/7/2022

SHEET 1 OF 1