

DETAIL A
SCALE 2:1

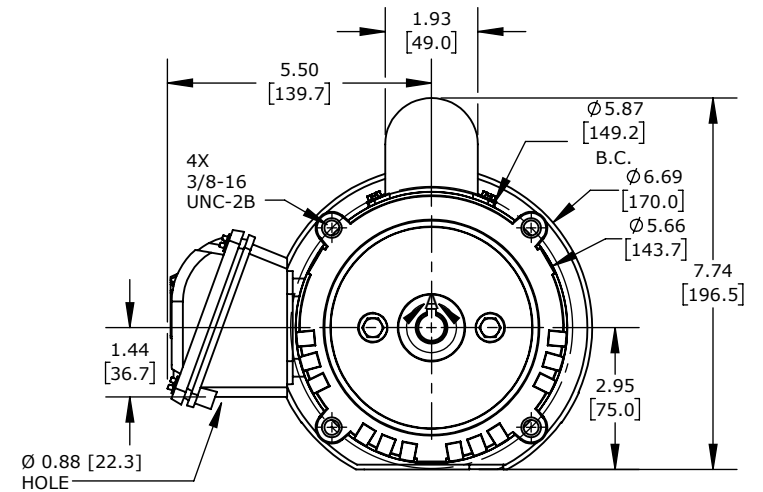

WEG ELECTRIC S SERIES STANDARD EFFICIENCY AC INDUCTION MOTOR, GENERAL PURPOSE, 1/3HP, 1-PH, 115/208-230 VAC, 1800RPM, TEFC, 56C FRAME, ROLLED STEEL, C-FACE ONLY MOUNT

.3318ES1BW56CFL-S

AutomationDirect.com
1-800-633-0405



3rd
ANGLE

NOT TO
SCALE

PART DIMENSIONS MAY DIFFER SLIGHTLY
DUE TO MANUFACTURER'S VARIANCES

METRIC UNITS USED
FOR PART DESIGN

UNLESS OTHERWISE
SPECIFIED UNITS ARE:

inch
[mm]

LATEST VERSION
12/6/2022

SHEET 1 OF 1