

SSP HOLDX Magnetic Locking Safety Switches With RFID



SSP HOLDX Mounting Brackets

SSP HOLDX Mounting Bracket Selection Guide				
Part Number	Price	Mounting	Fits	Drawing
RL-Z-MF1	\$70.00	Hinged door with handle	HOLDX RL safety switches	PDF
RL-Z-MF2	\$34.00	Hinged door without handle		PDF
RL-Z-MS1	\$38.50	Sliding door		PDF
RS-Z-MF1	\$65.00	Hinged door with handle	HOLDX RS safety switches	PDF
RS-Z-MF2	\$30.00	Hinged door without handle		PDF
RS-Z-MS1	\$42.50	Sliding door		PDF



[RL-Z-MF1](#)



[RL-Z-MF2](#)



[RL-Z-MS1](#)



[RS-Z-MF1](#)



[RS-Z-MF2](#)



[RS-Z-MS1](#)

Illustration showing bracket and HOLDX system attached to T-Slot rail

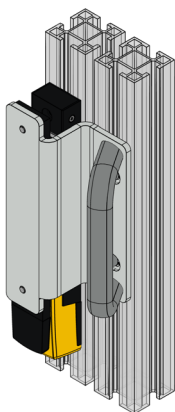

[RL-Z-MF1](#)

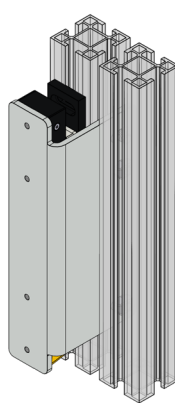

[RL-Z-MF2](#)

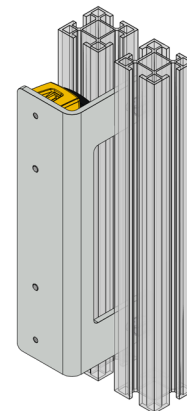

[RL-Z-MS1](#)

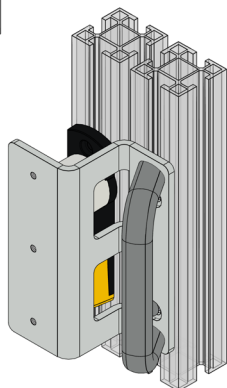

[RS-Z-MF1](#)

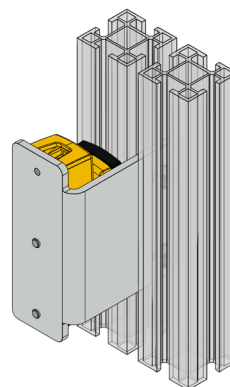

[RS-Z-MF2](#)

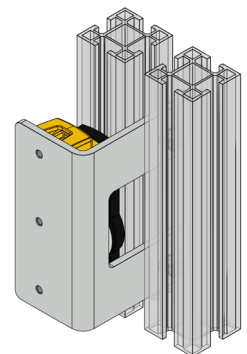

[RS-Z-MS1](#)

Safety Products



Warning: Safety products sold by AutomationDirect are Safety components only. The purchaser/installer is solely responsible for the application of these components and ensuring all necessary steps have been taken to assure each application and use meets all performance and applicable safety requirements and/or local, national and/or international safety codes as required by the application. AutomationDirect cannot certify that our products, used solely or in conjunction with other AutomationDirect or other vendors' products, will assure safety for any application. Any person using or applying any products sold by AutomationDirect is responsible for learning the safety requirements for their individual application and applying them, and therefore assumes all risks, and accepts full and complete responsibility, for the selection and suitability of the product for their respective application.

AutomationDirect does not provide design or consulting services, and cannot advise whether any specific application or use of our products would ensure compliance with the safety requirements for any application.