

# Small RHC Series NEMA 1 and 3R Hinge-Cover Wall-Mount



## Applications

Designed for use as wiring boxes and junction boxes, these enclosures provide protection against rain, sleet and snow in outdoor installations, or against dripping water indoors.

## Construction

- Bodies and doors fabricated from 16-gauge carbon steel
- Continuous hinge
- Hinge is made of carbon steel with a stainless steel hinge pin
- Lid supplied with a padlockable draw latch
- Weldnuts provided for mounting optional back panels
- External mounting plates on top and bottom of enclosure
- Grounding provisions provided

## Finish

- ANSI 61 gray polyester powder light texture inside and out over phosphatized surfaces

## Listings

- UL 50, Types 1 and 3R [UL File E6924]
- NEMA/EEMAC 1 and 3R



Small RHC Series NEMA 1 and 3R Hinge-Cover Wall-Mount				
Part Number	Price	Enclosure Size HxWxD	Knockout Pattern	Painted Steel Subpanel
<b>RHC060604</b>	\$58.00	6.40 x 6.19 x 4.31 [163 x 157 x 109]	G-F-G	<b>N1P0606</b>
<b>RHC060804</b>	\$65.00	8.40 x 6.19 x 4.31 [213 x 157 x 109]	G-F-G	<b>N1P0608</b>
<b>RHC080804</b>	\$77.00	8.40 x 8.19 x 4.31 [213 x 208 x 109]	G-F-G	<b>N1P0808</b>
<b>RHC080806</b>	\$82.00	8.40 x 8.19 x 6.31 [213 x 208 x 160]	G-F-G	<b>N1P0808</b>
<b>RHC081006</b>	\$90.00	10.40 x 8.19 x 6.31 [264 x 208 x 160]	G-F-G	<b>N1P0810</b>
<b>RHC101206</b>	\$110.00	12.40 x 10.19 x 6.31 [315 x 259 x 160]	G-F-G	<b>N1P1012</b>
<b>RHC121206</b>	\$121.00	12.40 x 12.19 x 6.31 [315 x 310 x 160]	F-G-H-I-G	<b>N1P1212</b>
Note: Subpanels must be ordered separately. Dimensions in inches [millimeters] Letters in table correspond to letters on dimensional drawings.				

## Dimensions

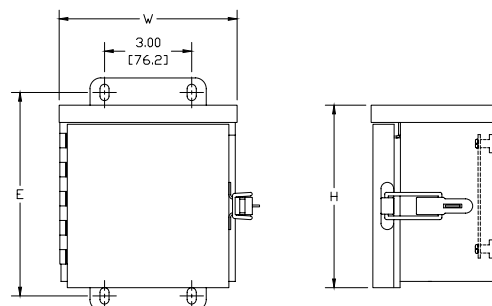

Grounding Kit		
Part Number	Description	Price
<b>WGNDKT</b>	Grounding Kit	\$3.25
Note: Field grounding kit includes necessary parts to properly ground enclosure.		

