

Small RHC Series NEMA 1 and 3R Hinge-Cover Wall-Mount



Applications

Designed for use as wiring boxes and junction boxes, these enclosures provide protection against rain, sleet and snow in outdoor installations, or against dripping water indoors.

Construction

- Bodies and doors fabricated from 16-gauge carbon steel
- Continuous hinge
- Hinge is made of carbon steel with a stainless steel hinge pin
- Lid supplied with a padlockable draw latch
- Weldnuts provided for mounting optional back panels
- External mounting plates on top and bottom of enclosure
- Grounding provisions provided

Finish

- ANSI 61 gray polyester powder light texture inside and out over phosphatized surfaces

Listings

- UL 50, Types 1 and 3R [UL File E6924]
- NEMA/EEMAC 1 and 3R



Small RHC Series NEMA 1 and 3R Hinge-Cover Wall-Mount				
Part Number	Price	Enclosure Size HxWxD	Knockout Pattern	Painted Steel Subpanel
RHC060604	\$59.00	6.40 x 6.19 x 4.31 [163 x 157 x 109]	G-F-G	N1P0606
RHC060804	\$65.00	8.40 x 6.19 x 4.31 [213 x 157 x 109]	G-F-G	N1P0608
RHC080804	\$78.00	8.40 x 8.19 x 4.31 [213 x 208 x 109]	G-F-G	N1P0808
RHC080806	\$83.00	8.40 x 8.19 x 6.31 [213 x 208 x 160]	G-F-G	N1P0808
RHC081006	\$92.00	10.40 x 8.19 x 6.31 [264 x 208 x 160]	G-F-G	N1P0810
RHC101206	\$112.00	12.40 x 10.19 x 6.31 [315 x 259 x 160]	G-F-G	N1P1012
RHC121206	\$123.00	12.40 x 12.19 x 6.31 [315 x 310 x 160]	F-G-H-I-G	N1P1212

Note: Subpanels must be ordered separately.
Dimensions in inches [millimeters]
Letters in table correspond to letters on dimensional drawings.

Dimensions

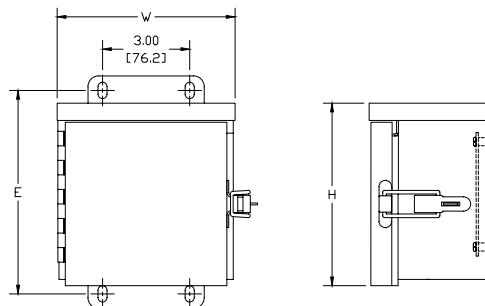

Grounding Kit		
Part Number	Description	Price
WGNDKT	Grounding Kit	\$3.25

Note: Field grounding kit includes necessary parts to properly ground enclosure.

