

Small RHC Series NEMA 1 and 3R Hinge-Cover Wall-Mount



Construction

- Bodies and doors fabricated from 16-gauge carbon steel
- Continuous hinge
- Hinge is made of carbon steel with a stainless steel hinge pin
- Lid supplied with a padlockable draw latch
- Weldnuts provided for mounting optional back panels
- External mounting plates on top and bottom of enclosure
- Grounding provisions provided

Finish

- ANSI 61 gray polyester powder light texture inside and out over phosphatized surfaces

Listings

- UL 50, Types 1 and 3R [UL File E6924]
- NEMA/EEMAC 1 and 3R

Applications

Designed for use as wiring boxes and junction boxes, these enclosures provide protection against rain, sleet and snow in outdoor installations, or against dripping water indoors.



Shipping Schedule				
Same day	1 - 5 days	1 - 7 days	1 - 15 days	1 - 20 days
Color indicates shipping lead time in business days.				

Small RHC Series NEMA 1 and 3R Hinge-Cover Wall-Mount				
Part Number	Price	Enclosure Size HxWxD	Knockout Pattern	Painted Steel Subpanel
RHC060604	\$59.00	6.40 x 6.19 x 4.31 [163 x 157 x 109]	G-F-G	N1P0606
RHC060804	\$65.00	8.40 x 6.19 x 4.31 [213 x 157 x 109]	G-F-G	N1P0608
RHC080804	\$78.00	8.40 x 8.19 x 4.31 [213 x 208 x 109]	G-F-G	N1P0808
RHC080806	\$83.00	8.40 x 8.19 x 6.31 [213 x 208 x 160]	G-F-G	N1P0808
RHC081006	\$92.00	10.40 x 8.19 x 6.31 [264 x 208 x 160]	G-F-G	N1P0810
RHC101206	\$112.00	12.40 x 10.19 x 6.31 [315 x 259 x 160]	G-F-G	N1P1012
RHC121206	\$123.00	12.40 x 12.19 x 6.31 [315 x 310 x 160]	F-G-H-I-G	N1P1212

Note: Subpanels must be ordered separately.
Dimensions in inches [millimeters]
Letters in table correspond to letters on dimensional drawings.

Dimensions

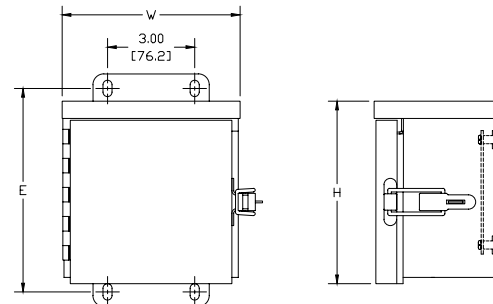

Grounding Kit		
Part Number	Description	Price
WGNDKT	Grounding Kit	\$3.25

Note: Field grounding kit includes necessary parts to properly ground enclosure.

