

# SIRCO M UL 508 Non-Fusible Disconnect Switches

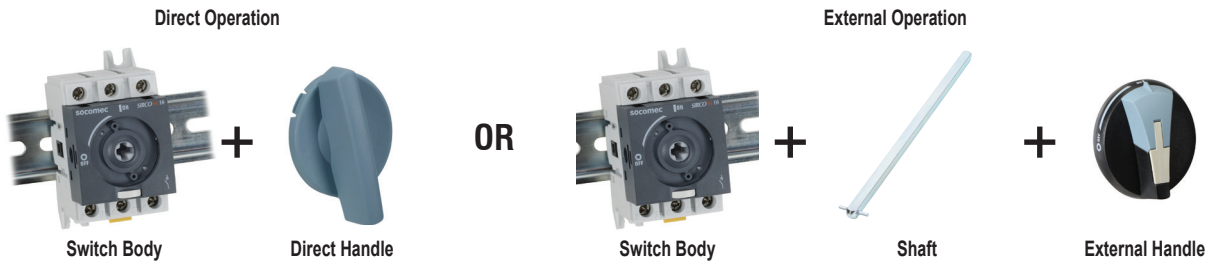

To assemble a switch, please select:



UL 508 Non-Fusible Disconnect Switches				
Part Number*	Description	Switch Body Rating (A)	# of Poles	Price
<a href="#">22003000</a>	Non-fusible UL 508 disconnect rotary 600VAC disconnect switch	16	3	\$24.50
<a href="#">22003001</a>		20	3	\$26.00
<a href="#">22003002</a>		25	3	\$28.50
<a href="#">22003003</a>		32	3	\$29.00
<a href="#">22003004</a>		40	3	\$30.00
<a href="#">22003006</a>		63	3	\$39.50
<a href="#">22003008</a>		80	3	\$44.50
<a href="#">22003009</a>		100	3	\$57.00

\* These part numbers are direct replacements for previous part numbers with a "-UL" suffix. They have identical technical specs, form, fit and function. There is no change in agency approvals, the UL mark, listing, or File number E173959.

Handles – Defeatable and Lockable							
Part Number	Description	Switch Body Rating (A)	Handle Color	Handle Type	NEMA/UL Type	Price	
<a href="#">22995012</a>	Direct operation handle, shaft not required*	16 - 100	Blue	M00	-	\$3.00	
<a href="#">14731111</a>	Front and right side handles I - O, shaft required		Black/Blue	S00	1, 3R, 12	\$14.00	
<a href="#">14741111</a>			Red/Yellow			\$14.00	
<a href="#">147D1111</a>			Black/Blue			4, 4X	\$23.00
<a href="#">147E1111</a>			Red/Yellow	S0	1, 3R, 12	\$24.00	
<a href="#">14831111</a>			Black/Blue			\$24.00	
<a href="#">14841111</a>			Red/Yellow			4, 4X	\$40.50
<a href="#">148D1111</a>			Black/Blue	S01	1, 3R, 12	\$40.50	
<a href="#">148E1111</a>			Red/Yellow			4, 4X	\$49.50
<a href="#">140F2111</a>			Black/Blue			4, 4X	\$33.50
<a href="#">140G2111</a>			Red/Yellow	\$33.50			
<a href="#">140D2111</a>			Black/Blue	\$49.50			
<a href="#">140E2111</a>			Red/Yellow	\$49.50			



\* Not defeatable

Shafts for External Handles						
Part Number	Description	Switch Body Rating (A)	Handle Type	Length		Price
				in	mm	
<a href="#">14070515</a>	For 3/4-pole switches: shafts are for external front and side handle	16 - 100	S00, S0	5.9	150	\$4.50
<a href="#">14070520</a>				7.9	200	\$5.75
<a href="#">14070532</a>				12.6	320	\$7.25
<a href="#">14040520</a>	For 3/4-pole switches: shafts are for external front and side handle.		S01	7.9	200	\$10.50
<a href="#">14040532</a>				12.6	320	\$13.00
<a href="#">14040540</a>				15.7	400	\$21.00



# SIRCO M UL 508 Non-Fusible Disconnect Switches



Shaft Guide for External Handle			
Part Number	Description	Fits Handle Type	Price
<a href="#">14190000</a>	This accessory makes alignment connections between the shaft and handle easier. Allows up to 15mm misalignment tolerance. Required for a shaft length over 300mm. Included with longer shafts.	S0, S00	\$2.75
<a href="#">14290000</a>		S01, S1, S2, S3	\$6.50

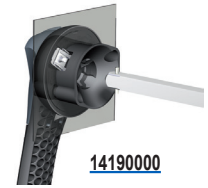

Additional Poles					
Part Number*	Description	Switch Body Rating (A)	No. of Poles	Use	Price
<a href="#">22001000</a>	Module switched 4th pole	16	1	Transforms a 3-pole switch into a 4-pole	\$14.00
<a href="#">22001001</a>		20			\$15.00
<a href="#">22001002</a>		25			\$15.00
<a href="#">22001003</a>		32			\$16.50
<a href="#">22001004</a>		40			\$18.00



22001000

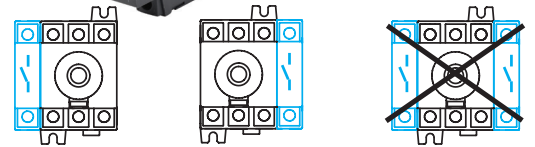

4th Pole Configurations

\* These part numbers are direct replacements for previous part numbers with a "-UL" suffix. They have identical technical specs, form, fit and function. There is no change in agency approvals, the UL mark, listing, or File number E173959.

Terminal Shrouds				
Part Number	Description	Switch Body Rating (A)	No. of Poles	Price
<a href="#">22941005</a>	Terminal shroud line/load mount, 2 per pack, offers additional protection against direct contact with the terminals.	16-40	1	\$3.00
<a href="#">22943005</a>			3	\$4.50
<a href="#">22941009</a>		63-100	1	\$3.50
<a href="#">22943009</a>			3	\$5.75



22941005

Auxiliary Contacts				
Part Number*	Description	Switch Body Rating (A)	Contacts	Price
<a href="#">22990001</a>	Auxiliary contact block module, 10A @ 240VAC, can be mounted on left or right side of switch, maximum 4 auxiliary contacts can be used (requires 2 modules).	16 - 100	1 NO / 1 NC	\$18.50
<a href="#">22990011</a>		16 - 100	2 NO	\$20.00



22990001

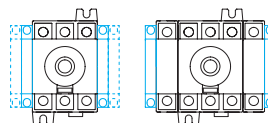

Auxiliary Contact Configurations

\* These part numbers are direct replacements for previous part numbers with a "-UL" suffix. They have identical technical specs, form, fit and function. There is no change in agency approvals, the UL mark, listing, or File number E173959.

Conversion Kit			
Part Number	Description	Switch Body Rating (A)	Price
<a href="#">22096009</a>	Front mount transfer switch (2/4 pole) conversion kit. Open center transition (I-O-II).	16 - 100	\$27.00
<a href="#">22696009</a>	Front mount multi-pole (6/8 pole) conversion kit.	16 - 100	\$24.00



22096009

Door Mounting Kit				
Part Number	Description	Switch Body Rating (A)	No. of Poles	Price
<a href="#">22993409</a>	This kit enables direct mounting of the switch on the panel door or on the right or left side of the panel. For use with S0 and S00 handles only.	16-100	3/4	\$5.75



22993409

# SIRCO M UL 508 Non-Fusible Disconnect Switches



## Technical Characteristics

Characteristics According to UL 508 / CSA 22.2#4								
	22003000	22003001	22003002	22003003	22003004	22003006	22003008	22003009
<b>General use rating (A)</b>	16	20	25	32	40	63	80	100
Short-circuit rating at 600VAC (kA) <sup>1</sup>	65	65	65	65	10 / 65	50 / 65	50 / 65	50 / 65
Type of fuse	J	J	J	J	J	J	J	J
Max fuse rating (A)	30	30	30	30	60 / 30	100 / 60	100 / 60	100 / 60
<b>Max. motor hp / FLA 3-phase motor max.</b>								
208VAC	3 / 10.6	5 / 16.7	7.5 / 24.2	7.5 / 24.2	7.5 / 24.2	15 / 46.2	15 / 46.2	15 / 46.2
220-240 VAC	5 / 15.2	5 / 15.2	7.5 / 22	7.5 / 22	7.5 / 22	20 / 54	20 / 54	20 / 54
440-480 VAC	10 / 14	10 / 14	15 / 21	20 / 27	20 / 27	40 / 52	40 / 52	40 / 52
600VAC	10 / 11	15 / 17	20 / 22	25 / 27	25 / 27	40 / 41	40 / 41	40 / 41
<b>Wire type / temperature</b>	Cu / 167°F (75°C)							
<b>Product weight – lb (kg)</b>	0.5 (0.2)					0.7 (0.32)		
<b>Wire range</b>								
Solid (AWG) - 1 wire	#14-10	#14-10	#14-10	#14-10	#14-10	#14-10	#14-10	#14-10
Torque - lb-in (N·m)	26.5 (3)	26.5 (3)	26.5 (3)	26.5 (3)	26.5 (3)	39.8 (4.5)	39.8 (4.5)	
Solid (AWG) - 2 wire	(2) #12	(2) #12	(2) #12	(2) #12	(2) #12	(2) #12	(2) #12	(2) #12
Torque - lb-in (N·m)	26.5 (3)	26.5 (3)	26.5 (3)	26.5 (3)	26.5 (3)	39.8 (4.5)	39.8 (4.5)	
Stranded (AWG) - 1 wire	#14-4	#14-4	#14-4	#14-4	#14-4	#14-1	#14-1	#14-1
Torque - lb-in (N·m)	26.5 (3)	26.5 (3)	26.5 (3)	26.5 (3)	26.5 (3)	39.8 (4.5)	39.8 (4.5)	
Stranded (AWG) - 2 wire	(2) #14-12	(2) #14-12	(2) #14-12	(2) #14-12	(2) #14-12	(2) #10-6	(2) #10-6	(2) #10-6
Torque - lb-in (N·m)	26.5 (3)	26.5 (3)	26.5 (3)	26.5 (3)	26.5 (3)	39.8 (4.5)	39.8 (4.5)	
<b>Environmental – switch body</b>								
Operating temperature <sup>2</sup>	-20°C to 70°C (-4°F to +158°F)							
Flammability rating	UL 94-V0							
<b>Mechanical characteristics</b>								
Endurance (# of operating cycles)	10,000	10,000	10,000	10,000	10,000	10,000	10,000	10,000
Operating torque (lb-in / N·m)	7 / 0.8	7 / 0.8	7 / 0.8	7 / 0.8	7 / 0.8	8.9 / 1	8.9 / 1	8.9 / 1
<b>Mounting</b>	DIN rail or panel mount							
<b>Auxiliary contacts</b>								
Electrical characteristics	A300	A300	A300	A300	A300	A300	A300	A300
<b>Agency approvals</b>								
UL file # E173959 (UL 508, C22.2 NO. 14) Manual motor controller "suitable as motor disconnect" CE2011/65/EU								

<sup>1</sup> Short-circuit rating achieved when used with corresponding fuse type and max fuse rating.

<sup>2</sup> At temperatures above 40°C, the current rating of the switch has to be de-rated 1% per °C over 40°C. Example: At 60°C a 100A switch is rated 80A.

Note: These part numbers are direct replacements for previous part numbers with a "-UL" suffix. They have identical technical specs, form, fit and function. There is no change in agency approvals, the UL mark, listing, or File number E173959.

To obtain the most current agency approval information, see the Agency Approval Checklist section on the specific part number's web page.

# SIRCO M UL 508 Non-Fusible Disconnect Switches



## Technical Characteristics

Characteristics According to IEC 60647-3									
	22003000	22003001	22003002	22003003	22003004	22003006	22003008	22003009	
<b>General use rating (A)</b>	16	20	25	32	40	63	80	100	
Thermal current I <sub>th</sub> at 40°C (A)	16	20	25	32	40	63	80	100	
Rated insulation voltage U <sub>i</sub> (V)	800	800	800	800	800	800	800	800	
Rated impulse withstand voltage U <sub>imp</sub> (kV)	8	8	8	8	8	8	8	8	
<b>Rated operational currents I<sub>e</sub></b>									
415VAC AC-23A / AC-23B utilization category (A/B) <sup>1</sup>	16 / 16	20 / 20	25 / 25	32 / 32	40 / 40	63 / 63	80 / 80	80 / 80	
500VAC AC-22A / AC-22B utilization category (A/B) <sup>1</sup>	16 / 16	20 / 20	25 / 25	32 / 32	40 / 40	63 / 63	80 / 80	-	
500VAC AC-23A / AC-23B utilization category (A/B) <sup>1</sup>	16 / 16	20 / 20	25 / 25	25 / 25	25 / 25	63 / 63	63 / 63	-	
690VAC AC-21A / AC-21B utilization category (A/B) <sup>1</sup>	16 / 16	20 / 20	25 / 25	32 / 32	40 / 40	63 / 63	80 / 80	100 / 100	
690VAC AC-22A / AC-22B utilization category (A/B) <sup>1</sup>	16 / 16	20 / 20	25 / 25	32 / 32	32 / 40	40 / 63	63 / 80	-	
690VAC AC-23A / AC-23B utilization category (A/B) <sup>1</sup>	16 / 16	20 / 20	25 / 25	25 / 25	25 / 25	40 / 40	40 / 40	-	
<b>Operational power in AC-23 (kW)</b>									
@ 400VAC without prebreak AC in AC-23 <sup>1/2</sup>	7.5	9	11	15	18.5	30	37	-	
@ 500VAC without prebreak AC in AC-23 <sup>1/2</sup>	7.5	9	11	15	15	30	37	-	
@ 690VAC without prebreak AC in AC-23 <sup>1/2</sup>	7.5	11	15	18.5	18.5	30	37	-	
<b>Fuse protected short-circuit withstand (kA rms prospective)</b>									
Prospective short-circuit current (kA rms) <sup>3</sup>	50	50	50	50	50	50	50	25	
Associated fuse rating (A) <sup>3</sup>	16	20	25	32	40	63	80	100	
<b>Overload capacity (U<sub>e</sub> 415VAC)</b>									
Rated short-time withstand current 0.3 s. I <sub>cw</sub> (kA rms) <sup>3</sup>	2.5	2.5	2.5	2.5	2.5	3	3	1.5	
Rated short-circuit making capacity I <sub>cm</sub> (kA peak) <sup>3</sup>	6	6	6	6	6	9	9	2.1	
<b>Connection</b>									
Minimum Cu cable cross section (mm <sup>2</sup> )	1.5	1.5	1.5	1.5	1.5	2.5	2.5	2.5	
Maximum Cu cable cross section (mm <sup>2</sup> )	16	16	16	16	16	35	35	35	
Tightening torque min/max (N·m)	2 / 2.2	2 / 2.2	2 / 2.2	2 / 2.2	2 / 2.2	3.5 / 3.85	3.5 / 3.85	3.5 / 3.85	

<sup>1</sup>A/B: Category with index A = frequent operation - Category with index B = infrequent operation.

<sup>2</sup>The power value is given for information only, the current values vary from one manufacturer to another.

<sup>3</sup>For a rated operating voltage U<sub>e</sub> = 400VAC

Note: These part numbers are direct replacements for previous part numbers with a "-UL" suffix. They have identical technical specs, form, fit and function. There is no change in agency approvals, the UL mark, listing, or File number E173959.

# SIRCO M UL 508 Non-Fusible Disconnect Switches



## Dimensions

Inches [mm]

Switch with direct handle

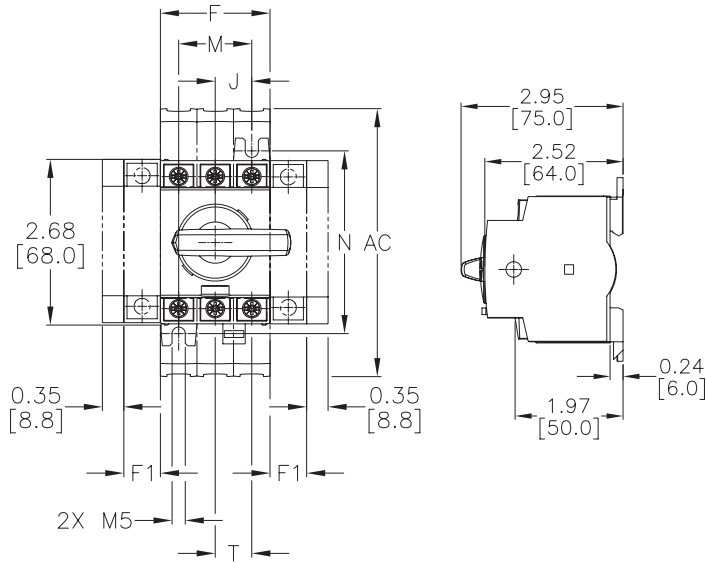

Switch with external handle side operation

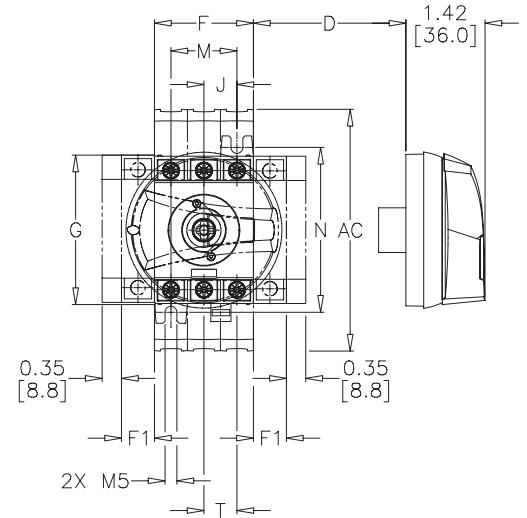

Switch with external handle front operation

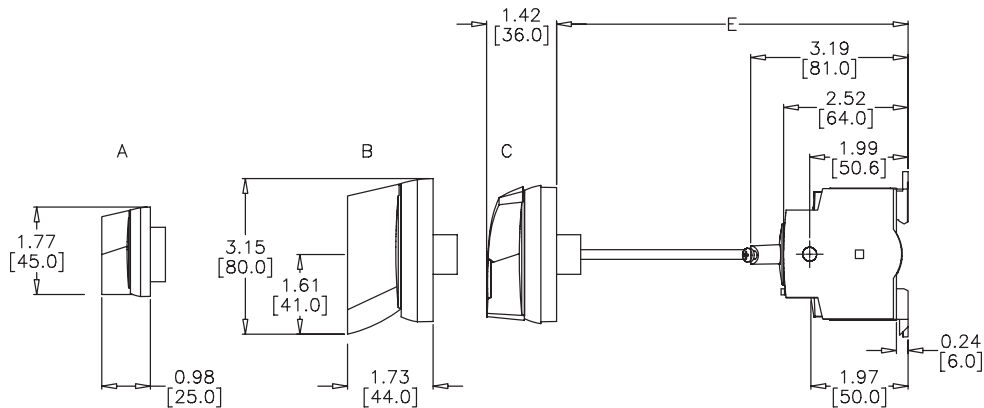

Dimensions													
Switch Body Rating (A)	Units	Overall Dimensions				Terminal Shrouds AC	Switch Body				Switch Mounting		Connection
		D min	D max	E min	E max		F	F1	G	J	M	N	
16 - 40	in	1.18	9.25	3.94	14.64	4.33	1.77	0.59	2.67	0.59	1.18	2.95	0.59
	mm	30	235	100	372	110	45	15	68	15	30	75	15
63 - 100	in	1.18	9.25	3.94	14.64	4.33	2.06	0.69	2.99	0.69	1.38	3.35	0.69
	mm	30	235	100	372	110	52.5	17.5	76	17.5	35	85	17.5

Please see our website [www.AutomationDirect.com](http://www.AutomationDirect.com) for complete engineering drawings.

# SIRCO M UL 508 Enclosed Non-Fusible Disconnect Switches



Our enclosed UL 508 switches allow for the safe control and disconnection of any motor application.

**General characteristics**

- Gray enclosure with red handle
- Equipped with a 3-pole SIRCO M
- 1 removable ground terminal
- Possibility of adding 1 power pole and 1 auxiliary contact
- Operating temperature -4° to +158°F (-20° to +70°C)
- Polycarbonate plastic
- Flammability rating UL94-5VA
- NEMA/UL Type 1, 3R, 4, 4X, 12

UL 508 Enclosed Non-Fusible Disconnect Switches						Accessories*		
Part Number	Enclosure Rating (A)	No. of Poles	Enclosure Size	Weight lb (kg)	Price	Switched 4th Pole Module	Auxiliary Contacts	Terminal Shrouds (Line & Load)
<a href="#">22143503</a>	30	3	1	1.25 (0.56)	\$90.00	1P <a href="#">22001003</a> \$16.50	1 NO / 1 NC <a href="#">22990001</a> \$18.50	1P <a href="#">22941005</a> \$3.00
<a href="#">22243503</a>			2	1.60 (0.72)	\$104.00			3P <a href="#">22943005</a> \$4.50
<a href="#">22243506</a>	60	3	2	1.80 (0.82)	\$124.00	-	2 NO <a href="#">22990011</a> \$20.00	1P <a href="#">22941009</a> \$3.50
								3P <a href="#">22943009</a> \$5.75

Note: 2294100x fits 4th pole module only.

\* These part numbers are direct replacements for previous part numbers with a "-UL" suffix. They have identical technical specs, form, fit and function. There is no change in agency approvals, the UL mark, listing, or File number E173959.

**Configuration of the Auxiliary Contacts**

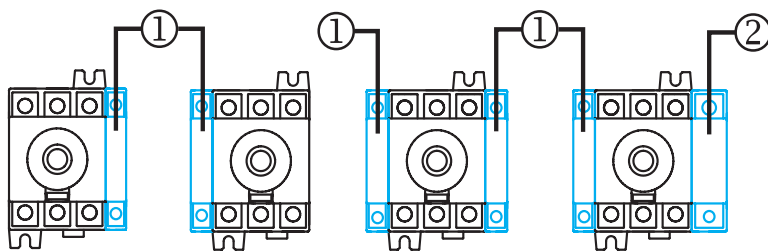

1. M Type auxiliary contacts  
2. Additional 4th pole

See switch body drawings for dimensions

**Dimensions**

Inches [mm]

Size 1

Size 2

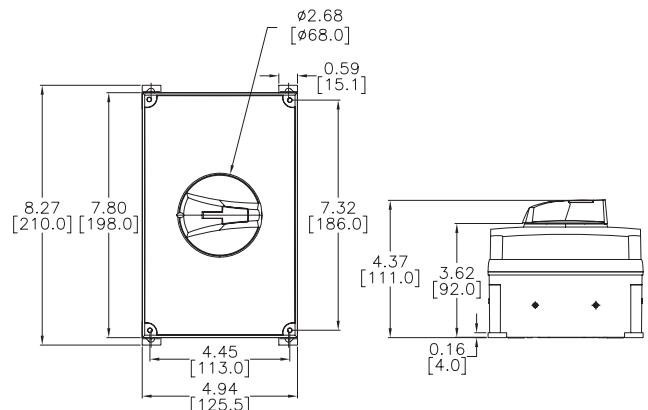
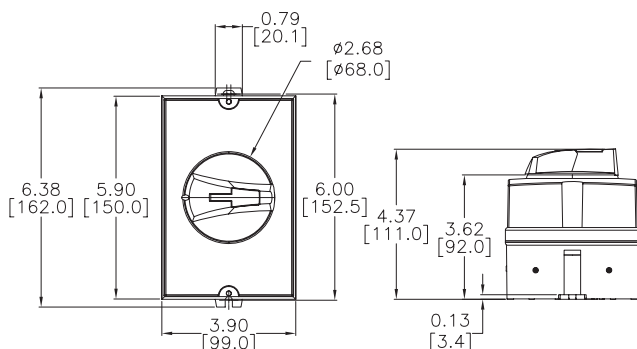

Please see our website [www.AutomationDirect.com](http://www.AutomationDirect.com) for complete engineering drawings.

# SIRCO M UL 508 Enclosed Non-Fusible Disconnect Switches



## Technical Characteristics

Characteristics According to UL 508 / CSA 22.2#4			
	22143503	22243503	22243506
<b>General use rating (A)</b>	30A	30A	60A
Max volts (VAC)	600VAC		
Short circuit rating at 600VAC (kA)	65kA	65kA	50kA
Type of fuse	J		
Max fuse rating (A)	30	100	100
<b>Max. motor 3-ph HP</b>			
240VAC	7.5	7.5	20
480VAC	20	20	40
600VAC	25	25	40
<b>Wire type/temperature</b>	Cu / 75°C (167°F)		
<b>Product weight – lb (kg)</b>	1.5 lb (0.68 kg)	1.9 lb (0.86 kg)	2.1 lb (0.95 kg)
<b>Wire range</b>			
Solid (AWG) - 1 wire	#14-10	#14-10	#14-10
Torque - lb-in (N-m)	26.5 (3)	26.5 (3)	38.9 (4.5)
Solid (AWG) - 2 wire	(2) #12	(2) #12	(2) #12
Torque - lb-in (N-m)	26.5 (3)	26.5 (3)	38.9 (4.5)
Stranded (AWG) - 1 wire	#14-4	#14-4	#14-1
Torque - lb-in (N-m)	26.5 (3)	26.5 (3)	38.9 (4.5)
Stranded (AWG) - 2 wire	(2) #14-12	(2) #14-12	(2) #10-6
Torque - lb-in (N-m)	26.5 (3)	26.5 (3)	38.9 (4.5)
<b>Environmental</b>			
Operating temperature <sup>1</sup>	-20°C to 70°C (-4°F to +158°F)		
Flammability rating	UL94-5VA		
Enclosure Material	Polycarbonate		
Enclosure NEMA/UL type	1, 3R, 12, 4, 4X		
<b>Mounting</b>	Wall		
<b>Auxiliary contacts</b>	A300		
<b>Agency approvals</b>			
UL file # E173959 (UL 508, C22.2 NO. 14) Manual motor controller "suitable as motor disconnect" CE 2011/65/EU, 2014/35/EU LVD and 2014/30/EU EMC			

<sup>1</sup>Temperatures above 40°C, the current rating of the switch has to be de-rated 1% per °C over 40°C. Example, at 60°C a 100A switch is rated 80A

Note: Short-circuit rating achieved when used with corresponding fuse type and max fuse rating.

To obtain the most current agency approval information, see the Agency Approval Checklist section on the specific part number's web page.

# Accessories Dimensions



## Handles

[inches/mm]

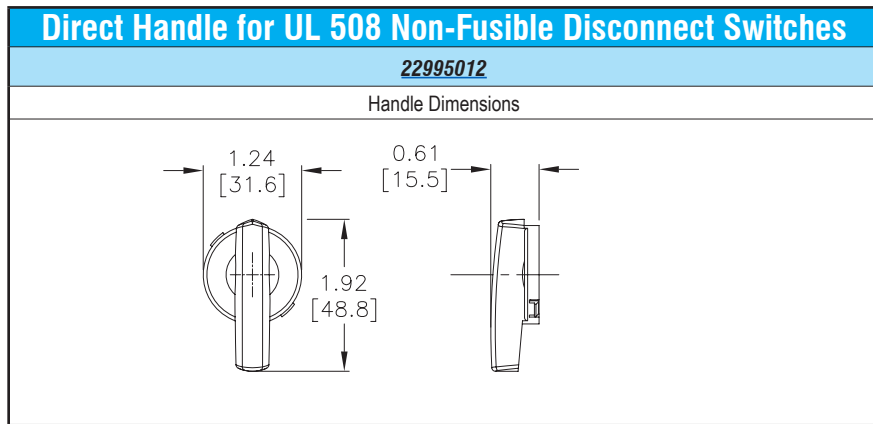

External Handles for UL 508 Non-Fusible Disconnect Switches		
S00 Type		
Handle Dimensions	Direction of Operation	Door Drilling
S0 Type		
Handle Dimensions	Direction of Operation	Door Drilling
S01 Type		
Handle Dimensions	Direction of Operation	Door Drilling

Please see our website [www.AutomationDirect.com](http://www.AutomationDirect.com) for complete engineering drawings.



# Accessories Dimensions



## Shafts for Non-Fusible Disconnect Switches

[inches/mm]

Shafts for Non-Fusible Disconnect Switches				
Shafts for S00, S0 Handle Type	Part Number	Switch Body Rating (A)	Length	
			in	mm
	<a href="#">14070515</a>	16 - 100	5.9	150
	<a href="#">14070520</a>		7.9	200
	<a href="#">14070532</a>		12.6	320
Shafts for S01 Handle Type	Part Number	Switch Body Rating (A)	Length	
	<a href="#">14040520</a>	16 - 100	7.9	200
	<a href="#">14040532</a>		12.6	320
	<a href="#">14040540</a>		15.7	400
Shafts for S1, S2 Handle Type	Part Number	Switch Body Rating (A)	Length	
	<a href="#">14001020</a>	100 - 400	7.9	200
	<a href="#">14001032</a>		12.6	320
	<a href="#">14001040</a>		15.7	400
Shafts for S3 Handle Type	Part Number	Switch Body Rating (A)	Length	
	<a href="#">14011520</a>	600	7.9	200
	<a href="#">14011532</a>		12.6	320
	<a href="#">14011540</a>		15.7	400

Please see our website [www.AutomationDirect.com](http://www.AutomationDirect.com) for complete engineering drawings.

Shaft Length Minimum Dimensions						
Use standard lengths: 7.9 in / 200mm – 12.6 in / 320mm – 15.7 in / 400mm						
Switch Body Rating (A)	Dimension X		Handle Type	Length		Part Number
	in	mm		in	mm	
100 - 400	5.31 - 10.43	135 - 265	S2	7.9	200	<a href="#">14001020</a>
100 - 400	5.31 - 15.16	135 - 385	S2	12.6	320	<a href="#">14001032</a>
100 - 400	5.31 - 18.31	135 - 465	S2	15.7	400	<a href="#">14001040</a>
600	8.70 - 13.50	221 - 343	S3	7.9	200	<a href="#">14011520</a>
600	8.70 - 18.23	221 - 463	S3	12.6	320	<a href="#">14011532</a>
600	8.70 - 21.38	221 - 543	S3	15.7	400	<a href="#">14011540</a>

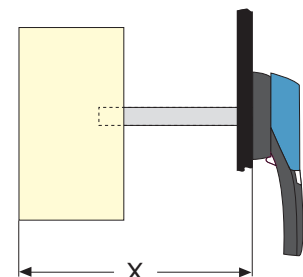

# Accessories Dimensions



## Auxiliary Contacts and Additional Poles

[inches/mm]

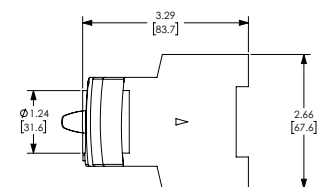
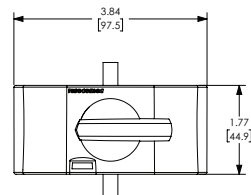
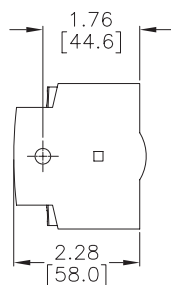
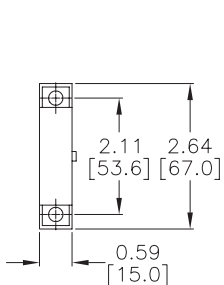
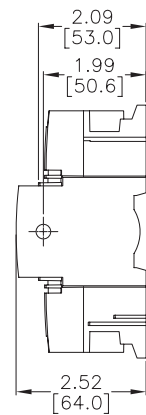
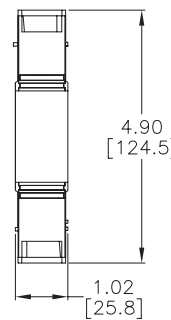
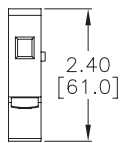
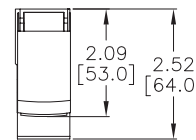
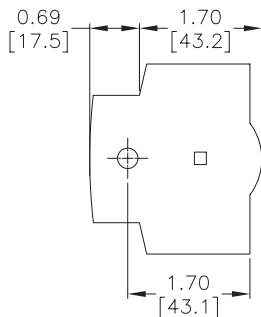
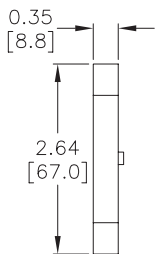
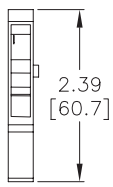
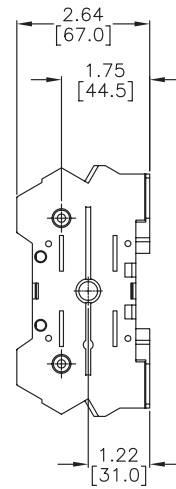
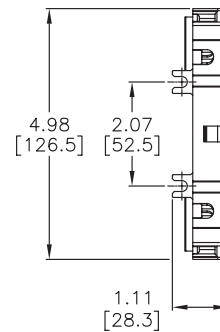
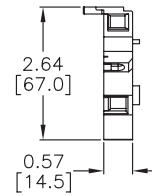
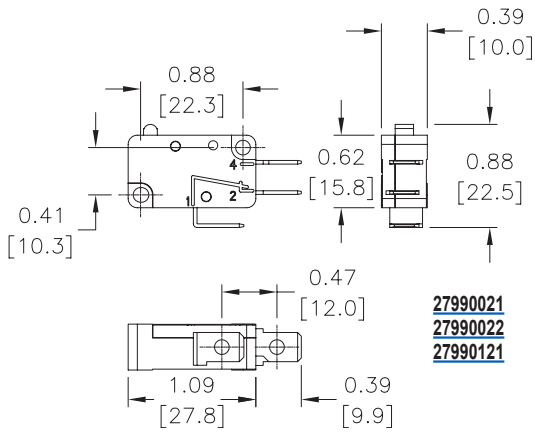

Please see our website [www.AutomationDirect.com](http://www.AutomationDirect.com) for complete engineering drawings.

# Disconnect Switches

## Introduction

### **UL®/CSA® Standards for Disconnect Switches**

#### **UL 98 – Enclosed and Deadfront Switches (CSA C22.2 No. 4)**

These requirements cover enclosed or deadfront switches, with or without provision for fuses, at 600V or less. These products are used as disconnecting means without restrictions; they are heavy-duty products requiring 2 inches (50mm) minimum of creepage distance between phases, which gives maximum safety for users and installation. The short-circuit withstand of these products goes up to 200kA.

#### **UL 489 – Molded Case Switches (CSA C22.22 No. 5)**

These requirements cover molded case circuit breakers, molded case switches and fused molded case switches, rated at 600V or less and 6000A or less.

### **NFPA® 79 Electrical Standard for Industrial Machinery**

The following types of machines are identified as industrial machinery:

- Metalworking machine tools, including machines that cut or form metal
- Plastics machinery
- Wood machinery, including woodworking, laminating and sawmill machines
- Assembly machines
- Material handling machines, including industrial robots and transfer machines
- Inspection and testing machines, including coordinate measuring and in-process gauging machines

### **UL® Standards for Electrical Machinery**

#### **UL 508 – Industrial Control Equipment (CSA C22.2 No. 14)**

These requirements cover manual, magnetic and solidstate starters and controllers, overload relays, pushbuttons, selector switches and control lights. These products are smaller, requiring only a creepage distance between phases of 0.50 inch (12.7 mm). Their use as a disconnecting means is limited to local disconnection of motors. These products can be used as a disconnect means only when they have been additionally tested "suitable as motor disconnect." This additional testing ensures that the switch has a proper closing capacity on a short circuit.

UL 508 devices **cannot** be used as main disconnect of an electrical panel, e.g., at the entrance of control panels. A manual motor controller marked "suitable as motor disconnect" shall be installed only on the load side of the branch circuit protective device [UL 508A 30.3.3 and NEC 430.109 (6)].

#### **Typical Control Panel**

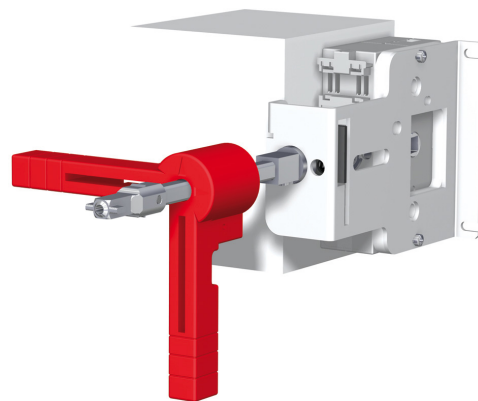
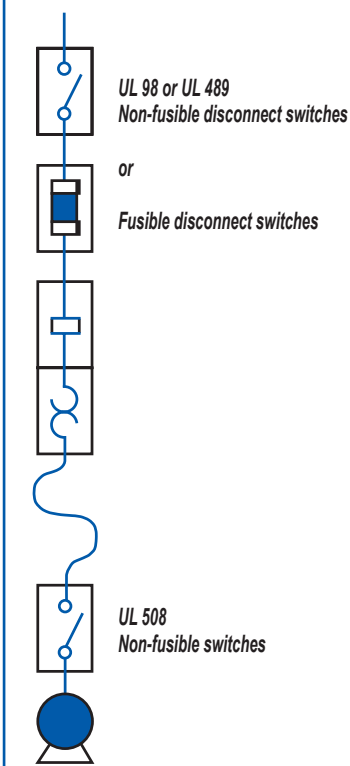

### **Meeting the requirements of UL508A and NFPA79**

#### **The disconnect shall be operable independent of the door position.**

The disconnect must be operable, by qualified persons, independent of the door position without the use of accessory tools or devices.

**Note:** NFPA 79; Paragraph 5.3.3.1 (5).

An operating mechanism for the disconnecting means shall be operable independent of the door position without the use of accessory tools or devices.





**Note:** UL 508A; Paragraph 66.6.3 c.

# Non-Fusible Disconnect Switches

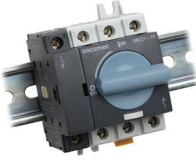

## Selection Guide

- Which application?
- Which function?
- Which operation handle?
- Which type of breaking?

Machine Control			Power Distribution	
UL 98 Compact Non-Fusible Disconnect Switches	UL 508 Non-Fusible Disconnect Switches*	UL 508 Non-Fusible Enclosed Disconnect Switches	UL 98 Non-Fusible Disconnect Switches	UL 98B DC Non-Fusible Disconnect Switches
				
<a href="#">22013003</a> <a href="#">22013006</a> <a href="#">22003010</a>	<a href="#">22003000</a> , <a href="#">22003001</a> <a href="#">22003002</a> , <a href="#">22003003</a> <a href="#">22003004</a> , <a href="#">22003006</a> <a href="#">22003008</a>	<a href="#">22143503</a> <a href="#">22243503</a> <a href="#">22243506</a>	<a href="#">27003011</a> , <a href="#">27004011</a> <a href="#">27003021</a> , <a href="#">27004021</a> <a href="#">27003041</a> , <a href="#">27003060</a>	<a href="#">27DC3011</a> <a href="#">27DC4011</a> <a href="#">27DC3021</a> <a href="#">27DC4021</a>

		Applications				
<b>Main switchboard</b>		✓	✓	✓	✓	✓
<b>Distribution panel</b>		✓	✓	✓	✓	✓
<b>Emergency disconnect</b>		✓	✓	✓	✓	✓
<b>Local safety disconnect (padlockable)</b>		✓	✓	✓	✓	✓
<b>Photovoltaic disconnect</b>						✓
<b>Enclosed switches</b>		✓	✓	✓	✓	✓
		Functions				
<b>3/4 pole non-fusible disconnect switch</b>		✓	✓	✓	✓	✓
		Characteristics				
<b>Operation</b>	<b>Manual (rotating)</b>	✓	✓	✓	✓	✓
<b>Direct operation handle</b>	<b>Front</b>	✓	✓	✓	✓	✓
<b>External operation handle</b>	<b>Front</b>	✓	✓	✓	✓	✓
	<b>Right side</b>	✓	✓	✓		
<b>Indication of breaking</b>	<b>Positive break indication</b>	✓	✓	✓	✓	✓
<b>Switch body</b>	<b>Modular</b>	✓	✓	✓		

\* Note: These part numbers are direct replacements for previous part numbers with a "-UL" suffix. They have identical technical specs, form, fit and function. There is no change in agency approvals, the UL mark, listing, or File numbers E173959 and E201138.

# Non-Fusible Disconnect Switches



## Assembly of Accessories

