



Nylon Cable Ties with Stainless Steel Tooth

Overview

The increased size of the hardened stainless steel tooth [with added Molybdenum] ensures extremely high mechanical strength and optimal resistance to corrosion. The classic rack has been replaced by a single central raised section, making the MET tie particularly flexible, while guaranteeing maximum strength at the same time. The special design of the MET cable tie enables smoother insertion of the steel tooth, reducing the required insertion force.



Features

- UL 94: V2 self-extinguishing nylon
- Designed for indoor applications
- Rounded edges to avoid cable damage
- Operating temperature:
-40 to +85°C [-40 to +185°F]

Agency Approvals

- UL Listed File E160935
- CE

Nylon Cable Ties with Stainless Steel Tooth

| Part Number | Pcs/ Bag | Price | Part Number | Pcs/ Bag | Price | Color | Length | | Width | | Min. Bundle Ø | | Max. Bundle Ø | | Tensile Strength | |
|-----------------------------|-------------|--------|-----------------------------|-------------|---------|---------|--------|-------|-------|------|------------------|------|------------------|------|---------------------|--------|
| | | | | | | | mm | in | mm | in | mm | in | mm | in | Kg | lb |
| MET.2.2102R | 100 | \$2.00 | MET.2.2302R | 1000 | \$19.50 | Natural | 100 | 3.94 | 2.5 | 0.10 | 2 | 0.08 | 24 | 0.94 | 18 | 39.68 |
| MET.3.2102R | 100 | \$2.00 | MET.3.2302R | 1000 | \$19.50 | Black | 100 | 3.94 | 2.5 | 0.10 | 2 | 0.08 | 24 | 0.94 | 18 | 39.68 |
| MET.2.2105R | 100 | \$4.75 | MET.2.2305R | 1000 | \$52.00 | Natural | 200 | 7.87 | 2.5 | 0.10 | 2 | 0.08 | 55 | 2.17 | 18 | 39.68 |
| MET.3.2105R | 100 | \$4.75 | MET.3.2305R | 1000 | \$52.00 | Black | 200 | 7.87 | 2.5 | 0.10 | 2 | 0.08 | 55 | 2.17 | 18 | 39.68 |
| MET.2.2110R | 100 | \$2.75 | MET.2.2310R | 1000 | \$27.00 | Natural | 140 | 5.51 | 3.5 | 0.14 | 3 | 0.12 | 36 | 1.42 | 28 | 61.73 |
| MET.3.2110R | 100 | \$2.75 | MET.3.2310R | 1000 | \$27.50 | Black | 140 | 5.51 | 3.5 | 0.14 | 3 | 0.12 | 36 | 1.42 | 28 | 61.73 |
| MET.2.2111R | 100 | \$4.75 | MET.2.2311R | 1000 | \$47.00 | Natural | 200 | 7.87 | 3.5 | 0.14 | 3 | 0.12 | 55 | 2.17 | 28 | 61.73 |
| MET.3.2111R | 100 | \$4.75 | MET.3.2311R | 1000 | \$49.50 | Black | 200 | 7.87 | 3.5 | 0.14 | 3 | 0.12 | 55 | 2.17 | 28 | 61.73 |
| MET.2.2112R | 100 | \$5.50 | MET.2.2312R | 1000 | \$58.00 | Natural | 280 | 11.02 | 3.5 | 0.14 | 3 | 0.12 | 80 | 3.15 | 28 | 61.73 |
| MET.3.2112R | 100 | \$5.75 | MET.3.2312R | 1000 | \$58.00 | Black | 280 | 11.02 | 3.5 | 0.14 | 3 | 0.12 | 80 | 3.15 | 28 | 61.73 |
| MET.2.2123R | 100 | \$5.25 | MET.2.2323R | 1000 | \$53.00 | Natural | 186 | 7.32 | 4.5 | 0.18 | 3 | 0.12 | 51 | 2.01 | 40 | 88.18 |
| MET.3.2123R | 100 | \$5.25 | MET.3.2323R | 1000 | \$53.00 | Black | 186 | 7.32 | 4.5 | 0.18 | 3 | 0.12 | 51 | 2.01 | 40 | 88.18 |
| MET.2.2140R | 100 | \$7.50 | MET.2.2340R | 1000 | \$76.00 | Natural | 290 | 11.42 | 4.5 | 0.18 | 3 | 0.12 | 80 | 3.15 | 40 | 88.18 |
| MET.3.2140R | 100 | \$7.75 | MET.3.2340R | 1000 | \$77.00 | Black | 290 | 11.42 | 4.5 | 0.18 | 3 | 0.12 | 80 | 3.15 | 40 | 88.18 |
| MET.2.2126R | 100 | \$9.25 | MET.2.2326R | 1000 | \$91.00 | Natural | 360 | 14.17 | 4.5 | 0.18 | 3 | 0.12 | 103 | 4.06 | 40 | 88.18 |
| MET.3.2126R | 100 | \$9.25 | MET.3.2326R | 1000 | \$91.00 | Black | 360 | 14.17 | 4.5 | 0.18 | 3 | 0.12 | 103 | 4.06 | 40 | 88.18 |
| MET.2.2548R | 50 | \$7.25 | MET.2.2748R | 500 | \$71.00 | Natural | 340 | 13.39 | 7 | 0.28 | 6 | 0.24 | 90 | 3.54 | 70 | 154.32 |
| MET.3.2548R | 50 | \$7.25 | MET.3.2748R | 500 | \$69.00 | Black | 340 | 13.39 | 7 | 0.28 | 6 | 0.24 | 90 | 3.54 | 70 | 154.32 |
| MET.2.2534R | 50 | \$9.75 | MET.2.2734R | 500 | \$95.00 | Natural | 360 | 14.17 | 7.5 | 0.30 | 6 | 0.24 | 101 | 3.98 | 80 | 176.37 |
| MET.3.2534R | 50 | \$9.25 | MET.3.2734R | 500 | \$88.00 | Black | 360 | 14.17 | 7.5 | 0.30 | 6 | 0.24 | 101 | 3.98 | 80 | 176.37 |



Tools and Accessories

Cable Tie Cutting Tool

The special angle of this cutter's tips enables clean cuts of the ties to sizes between 2.5 and 12.5 mm in width, maintaining the wired electric cables intact. The cutter can also be used for cutting cables.



Collar Fastening Metal Plier

This tool makes it easier to tighten and cut collars. Use with Double-headed Cable Ties. Leaves a short length of tail close to the head. For use with up to 9mm wide cable ties.



Cable Tie Gun Installation Tool

For use with cable ties up to 5mm wide. This tool helps to adjust the preload and cut the tie. Tightening torque of 2.5 kg to 12kg.



Bi-directional Nylon Square Bases



BAS.xMT.507



BAS.x.406

Note: Screw/mount not included

| Bi-directional Nylon Square Bases | | | | | | |
|-----------------------------------|-------------|--------|---------|------------------|-------------------|------------------|
| Part Number | Pcs/ Bag | Price | Color | Dual Adhesive | Dimensions | |
| | | | | | A | B |
| <u>BAS.2MT.507</u> | 100 | \$6.75 | Natural | Yes | 18.8 mm [0.74 in] | 4.4 mm [0.17 in] |
| <u>BAS.3MT.507</u> | 100 | \$6.75 | Black | Yes | | |
| <u>BAS.2MT.508</u> | 100 | \$9.25 | Natural | Yes | 26.5 mm [1.04 in] | 5.9 mm [0.23 in] |
| <u>BAS.3MT.508</u> | 100 | \$9.25 | Black | Yes | | |
| <u>BAS.2.406</u> | 100 | \$3.00 | Natural | No | | |
| <u>BAS.3.406</u> | 100 | \$3.00 | Black | No | | |

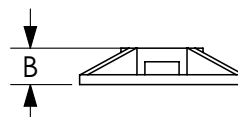
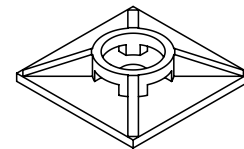
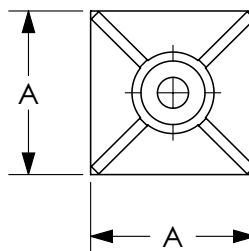



Cable Ties Family Overview

General Purpose Nylon Cable Ties



SapiSelco general purpose Nylon 6.6 cable ties are slotted and held in place by the resistance of the elastic tooth against the rack. These cable ties are resistant to solvents and reagents, oil, gasoline, and hydrocarbons when used at low temperatures, in low concentrations, and for short periods of time. Assortment Kit available.



These ties are low-cost, releasable, and reusable cable ties, suitable for lightweight loads.

The double-locking head enables securing two cable bundles with one tie. The body is completely rounded to eliminate all sharp edges guaranteeing reliable performance every time.

Colored Nylon Cable Ties



SapiSelco colored Nylon 6.6 cable ties are useful in applications that require distinct identifiers. These ties are colored with inorganic dyes and are resistant to solvents and reagents, oil, gasoline, and hydrocarbons when used at low temperatures, in low concentrations, and for short periods of time. Assortment Kit available.

Stainless Steel Tooth Ties



SapiSelco stainless steel tooth ties are forged from nylon and hardened stainless steel with added Molybdenum. This ensures extremely high mechanical strength and optimal resistance to corrosion. A single central raised section makes this tie particularly flexible, while guaranteeing maximum strength at the same time.

UV Resistant Cable Ties



Exposure to sun and ultraviolet rays causes deterioration in nylon. SapiSelco specialty Nylon UV Resistant cable ties can resist and endure the harsh conditions of outdoor applications for up to 10 years. These ties can withstand temperatures up to 125°C [257°F].

Metal Detector Readable Cable Ties



These ties are fabricated with a special composite of 6.6 polyamide and metal powder and are sensitive to electromagnetic fields. They are recommended in the food, pharmaceutical and chemical industry. They are useful in applications where, for safety reasons, it is necessary for a metal detector to be able to detect even very small fragments of these ties that may be mixed in with products.

Specialty Cable Ties



Nylon Releasable Tab



Screw Mount



Low Temp



Nylon Lashing Cable Tie



Identification Ties



Double-headed [Collars]

Tools and Accessories



Cable Tie Cutting Tool



Collar Fastening Metal Plier



Cable Tie Gun Installation Tool



Bi-directional Nylon Square Bases