

Enclosure Accessories

1/4-Turn Latches

Designed to replace black 1/4-turn latches when additional security is required.



SCE-DLSB

Slotted Door Latch				
Part Number	Price	Finish	Qty	Includes 28mm Cam
<u>SCE-DLSB</u>	\$25.00	Chrome	1	<u>SCE-102804</u>
<u>SCE-DLSBB</u>	\$25.00	Black	1	<u>SCE-102804</u>
<u>SCE-DLSSB</u>	\$61.00	Stainless	1	<u>SCE-102804</u>



SCE-DLWKC

Wing Knob Door Latch				
Part Number	Price	Finish	Qty	Includes 28mm Cam
<u>SCE-DLWKC</u>	\$25.00	chrome	1	<u>SCE-102804</u>
<u>SCE-DLWKF</u>	\$25.00	black matte	1	<u>SCE-102804</u>
<u>SCE-DLWKF-25</u>	\$457.00	black matte	25	<u>SCE-102804</u>



SCE-KLWN

Keylocking Wing Knob Door Latch				
Part Number	Price	Finish	Qty	Includes 28mm Cam
<u>SCE-KLWN</u>	\$50.00	chrome	1	<u>SCE-102804</u>
<u>SCE-KLWNB</u>	\$50.00	black matte	1	<u>SCE-102804</u>



SCE-PLWKB

Padlocking Wing Knob Door Latch				
Part Number	Price	Finish	Qty	Includes 28mm Cam
<u>SCE-PLWKB</u>	\$29.00	Black	1	<u>SCE-102804</u>
<u>SCE-PLWKB-50</u>	\$1,046.00	Black	50	<u>SCE-102804</u>
<u>SCE-PLWKSS</u>	\$69.00	Stainless	1	<u>SCE-102804</u>

Enclosure Accessories

1/4-Turn Latches

Designed to replace black 1/4-turn latches when additional security is required.



Padlocking Housing Latch

Part Number	Price	Finish	Includes 28mm Cam
<u>SCE-PLHG</u>	\$25.00	black matte	<u>SCE-102804</u>



Non-Locking "T" Handle

Part Number	Price	Finish	Includes 28mm Cam
<u>SCE-NLTH</u>	\$36.00	Chrome	<u>SCE-102804</u>



Keylocking "T" Handle

Part Number	Price	Finish	Includes 28mm Cam
<u>SCE-ELKLT</u>	\$57.00	Chrome	<u>SCE-102804</u>



Coinproof Door Latch

Part Number	Price	Finish	Includes 28mm Cam
<u>SCE-DLCA</u>	\$21.50	Chrome	<u>SCE-102804</u>



Sanitary Door Latch

Part Number	Price	Finish	Includes 28mm Cam
<u>SCE-SSQT</u>	\$184.00	Stainless	<u>SCE-102804</u>
Note: includes (1) key.			

Enclosure Accessories



Your Enclosure Source®

1/4-Turn Latches

Designed to replace black 1/4-turn latches when additional security is required.



[SCE-DLKLD](#)

Keylocking Door Latch					
Part Number	Price	Finish	Qty	Includes 28mm Cam	Includes Keys (2)
<u>SCE-DLKLD</u>	\$39.50	Chrome	1	<u>SCE-102804</u>	<u>SCE-K333</u>
<u>SCE-DLKLDB</u>	\$40.50	Black	1	<u>SCE-102804</u>	<u>SCE-K333</u>
<u>SCE-DLKLDB-25</u>	\$871.00	Black	25	<u>SCE-102804</u>	<u>SCE-K333</u>



[SCE-DL7SC](#)

7mm Square Door Latch with Key				
Part Number	Price	Finish	Includes 28mm Cam	Includes Keys (1)
<u>SCE-DL7SC</u>	\$25.00	Chrome	<u>SCE-102804</u>	<u>SCE-101695</u>



[SCE-DL8SB](#)

8mm Square Door Latch with Key				
Part Number	Price	Finish	Includes 28mm Cam	Includes Keys (1)
<u>SCE-DL8SB</u>	\$18.75	Black	<u>SCE-102804</u>	<u>SCE-101697</u>
<u>SCE-DL8SC</u>	\$18.75	Chrome	<u>SCE-102804</u>	<u>SCE-101697</u>



[SCE-DL7TE](#)

7mm Triangular Door Latch with Key				
Part Number	Price	Finish	Includes 28mm Cam	Includes Keys (1)
<u>SCE-DL7TE</u>	\$25.00	Chrome	<u>SCE-102804</u>	<u>SCE-107930</u>



[SCE-DL5MDB](#)

5mm Double-bit Door Latch with Key				
Part Number	Price	Finish	Includes 28mm Cam	Includes Keys (1)
<u>SCE-DL5MDB</u>	\$25.00	Chrome	<u>SCE-102804</u>	<u>SCE-110047</u>
<u>SCE-DL5MDBB</u>	\$25.00	Black	<u>SCE-102804</u>	<u>SCE-110047</u>

Enclosure Accessories



Your Enclosure Source®

Mini 1/4-Turn Latches

Designed for use on Econoline Junction Series (ELJ) enclosures and deep-hinged doors.



[SCE-MINQ](#)

Mini 1/4-Turn Latches				
Part Number	Price	Finish	Includes 35mm Cam	Includes Key
<u>SCE-MINQ</u>	\$14.50	Chrome	<u>SCE-105419</u>	No
<u>SCE-MINQB</u>	\$14.50	Black	<u>SCE-105419</u>	No
<u>SCE-MINQSS</u>	\$22.50	Stainless	No	No
<u>SCE-MINQK*</u>	\$29.50	Chrome	<u>SCE-105419</u>	<u>SCE-2233X</u>

*Keylocking



[SCE-L](#)

NEMA 1 1/4-Turn Latch	
Part Number	Price
<u>SCE-L</u>	\$16.50

- For use with NEMA 1 enclosures
- Keylocking
- Includes [SCE-105419](#) 35mm cam and (2) [SCE-2233X](#) keys



[SCE-MINQKLB](#)

Black Keylocking Lever Knob Latch		
Part Number	Price	Includes Key
<u>SCE-MINQKLB</u>	\$72.00	<u>SCE-2233X</u>

Note: Cam not included.



[SCE-MINQLB](#)

Black Lever Knob Latch		
Part Number	Price	Qty
<u>SCE-MINQLB</u>	\$41.50	1
<u>SCE-MINQLB-25</u>	\$917.00	25

Note: Cam not included.



[SCE-MINQ6MS](#)

Black 6mm Square Latch with Key	
Part Number	Price
<u>SCE-MINQ6MS</u>	\$49.50

Note: Cam not included.

Includes (1) 6mm square key.

Enclosure Accessories

Door Handles



Designed for use on custom and stock enclosures. Can be used as replacements for installed hardware when a different locking mechanism is desired. 7in and 5in lengths for different size enclosures. Latch cam not included. For 2- or 3-point latch, use SCE-ARK36 Aluminum Door Rod Kit.

Black Die-Cast Zinc Door Handles

Part Number	Price	Length	Description	Includes Key	Optional Cam	Price
SCE-PCH5	\$126.00	5in	Coinproof/Padlocking	—	SCE-3PTSMC	\$19.00
SCE-PH5	\$126.00	5in	Padlocking	—	SCE-3PTSMC	\$19.00
SCE-PKH5	\$126.00	5in	Keylocking/Padlocking	SCE-KC101 (2)	SCE-3PTSMC	\$19.00
SCE-PCH5-7SC	\$126.00	5in	7mm Square Insert	SCE-101695	SCE-3PTSMC	\$19.00
SCE-PH7	\$144.00	7in	Coinproof/Padlocking	—	SCE-102237	\$18.00
SCE-PCH7	\$144.00	7in	Padlocking	—	SCE-102237	\$18.00
SCE-PKH7	\$144.00	7in	Keylocking/Padlocking	SCE-KC101 (2)	SCE-102237	\$18.00
SCE-PCH7-7SC	\$144.00	7in	7mm Square Insert	SCE-101695	SCE-102237	\$18.00



[SCE-PKH7](#)



[SCE-PCH5](#)
[SCE-PH7](#)
[SCE-PKH5](#)

Stainless Steel Door Handles

Part Number	Price	Length	Description	Includes Key	Optional Cam	Price
SCE-PCH5SS	\$148.00	5in	Coinproof/Padlocking	—	SCE-3PTSMC	\$19.00
SCE-PH5SS	\$136.00	5in	Padlocking	—	SCE-3PTSMC	\$19.00
SCE-PKH5SS	\$145.00	5in	Keylocking/Padlocking	SCE-KC101 (2)	SCE-3PTSMC	\$19.00



[SCE-PCH5SS](#)

Enclosure Accessories

Door Handles



Enviroline Series Door Handles				
Part Number	Price	Description	Included Cam	Includes Keys (2)
<u>SCE-ELKL</u>	\$90.00	Keylocking Handle	<u>SCE-102804</u>	<u>SCE-K333</u>
<u>SCE-ELPL</u>	\$90.00	Padlocking Handle	<u>SCE-102804</u>	—

Designed for use in the Enviroline Series enclosures, for a quick and easy conversion from the standard 1/4-turn latch, with no added holes or cutouts necessary for installation. Not recommended for enclosures with greater than 36in. height.



[SCE-ELPL](#)
[SCE-ELKL](#)

Enclosure Accessories

Latch Rods and Cams



Enviroline Three-Point Latch Kit

Part Number	Price
SCE-3PTL	\$90.00

Designed for use with all Enviroline Series enclosures. This simple to install latch kit will add a two- or three-point latching system to the enclosure. The kit includes easy to cut 5/16-inch round rods with rollers and rod guides for a strong functioning latching system. No added holes or cutouts in the enclosure necessary for installation.



SCE-3PTL

Aluminum Rod Door Kit with Ramp Shoes

Part Number	Price	Rod Size
SCE-ARK36	\$167.00	0.375 x 0.625

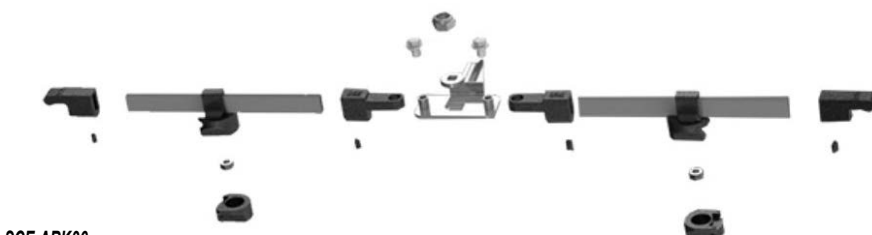

SCE-ARK36

35° Plated Steel Cam

Part Number	Price
SCE-112984	\$2.50

For use with Enviroline Junction series enclosures and window kits



28mm Plated Steel Cam

Part Number	Price
SCE-105419	\$3.00

For use with Series 14 Console Tops with mini 1/4-turn latches



28mm External Stop, Plated Steel Cam

Part Number	Price	Qty
SCE-102804	\$35.00	10



SCE-102804

Plated Steel Cams

Part Number	Price	Fits
SCE-3PTSMC	\$19.00	5in. door handles
SCE-102237	\$18.00	7in. door handles



Enclosure Accessories

Door Clamps



Quick Release Clamp Assembly			
Part Number	Price	Enclosure Type	Thread Type
<u>SCE-LPQR</u>	\$11.75	LP	1/4-20
<u>SCE-QRCH</u>	\$11.00	CHNF	10-24

Designed for quick access to an enclosure with standard screw clamps. Black zinc diecast with stainless steel fasteners.



[SCE-LPQR](#)

Padlock Kits

Padlock Kit for Junction Boxes		
Part Number	Price	Qty
<u>SCE-PLKJIC</u>	\$14.50	1

Designed for CHNF enclosures. Maintains water-tight and dust-tight seal. Made of plated steel.



304 SS Padlock Bracket	
Part Number	Price
<u>SCE-MINQPL</u>	\$12.25

Installs with SCE-MINQ mini 1/4-turn latches to allow additional security of a padlock.



Quick Release Clamp Assembly					
Part Number	Price	Enclosure Type	Thread Type	Finish	Qty
<u>SCE-LPCLAMP</u>	\$25.00	LP	1/4-20	Chrome	2
<u>SCE-LPCLAMPSS</u>	\$27.50	LP	1/4-20	Stainless	2
<u>SCE-CHCLAMP</u>	\$23.50	CHNF	10-24	Chrome	2
<u>SCE-CHCLAMPSS</u>	\$25.50	CHNF	10-24	Stainless	2

Designed as replacement clamps for SCE enclosures.



Enclosure Accessories

Keys



Replacement keys for standard and optional door hardware.

Keys			
Part Number	Price	Description	Qty
<u>SCE-110047</u>	\$16.75	5mm Double Bit	1
<u>SCE-101695</u>	\$16.75	7mm Square	1
<u>SCE-101697</u>	\$16.75	8mm Square	1
<u>SCE-107930</u>	\$16.75	7mm Triangular	1
<u>SCE-116398</u>	\$16.75	Sanitary 1/4-turn key	1
<u>SCE-K333</u>	\$9.50	Standard Key for 1/4-turn	2
<u>SCE-KC101</u>	\$9.50	Standard Key for SCE L-Handle	2
<u>SCE-2233X</u>	\$16.75	Standard Key for Mini 1/4-turn	1



[SCE-101695](#)
[SCE-110047](#)



[SCE-107930](#)



[SCE-116398](#)