

# Enclosure Accessories

## 1/4-Turn Latches

Designed to replace black 1/4-turn latches when additional security is required.



SCE-DLSB



SCE-DLWKC



SCE-KLWN



SCE-PLWKB

### Slotted Door Latch

Part Number	Price	Finish	Qty	Includes 28mm Cam
<u>SCE-DLSB</u>	\$23.00	Chrome	1	<u>SCE-102804</u>
<u>SCE-DLSBB</u>	\$23.00	Black	1	<u>SCE-102804</u>
<u>SCE-DLSSB</u>	\$56.00	Stainless	1	<u>SCE-102804</u>

### Wing Knob Door Latch

Part Number	Price	Finish	Qty	Includes 28mm Cam
<u>SCE-DLWKC</u>	\$23.00	chrome	1	<u>SCE-102804</u>
<u>SCE-DLWKF</u>	\$23.00	black matte	1	<u>SCE-102804</u>
<u>SCE-DLWKF-25</u>	\$423.00	black matte	25	<u>SCE-102804</u>

### Keylocking Wing Knob Door Latch

Part Number	Price	Finish	Qty	Includes 28mm Cam
<u>SCE-KLWN</u>	\$46.00	chrome	1	<u>SCE-102804</u>
<u>SCE-KLWNB</u>	\$46.00	black matte	1	<u>SCE-102804</u>

### Padlocking Wing Knob Door Latch

Part Number	Price	Finish	Qty	Includes 28mm Cam
<u>SCE-PLWKB</u>	\$26.50	Black	1	<u>SCE-102804</u>
<u>SCE-PLWKB-50</u>	\$968.00	Black	50	<u>SCE-102804</u>
<u>SCE-PLWKSS</u>	\$73.00	Stainless	1	<u>SCE-102804</u>

# Enclosure Accessories

## 1/4-Turn Latches



Designed to replace black 1/4-turn latches when additional security is required.



Padlocking Housing Latch			
Part Number	Price	Finish	Includes 28mm Cam
<b>SCE-PLHG</b>	\$23.00	black matte	<b>SCE-102804</b>



Non-Locking "T" Handle			
Part Number	Price	Finish	Includes 28mm Cam
<b>SCE-NLTH</b>	\$33.00	Chrome	<b>SCE-102804</b>



Keylocking "T" Handle			
Part Number	Price	Finish	Includes 28mm Cam
<b>SCE-ELKLT</b>	\$52.00	Chrome	<b>SCE-102804</b>



Coinproof Door Latch			
Part Number	Price	Finish	Includes 28mm Cam
<b>SCE-DLCA</b>	\$19.75	Chrome	<b>SCE-102804</b>



Sanitary Door Latch			
Part Number	Price	Finish	Includes 28mm Cam
<b>SCE-SSQT</b>	\$169.00	Stainless	<b>SCE-102804</b>
Note: includes (1) key.			

# Enclosure Accessories



Your Enclosure Source®

## 1/4-Turn Latches

Designed to replace black 1/4-turn latches when additional security is required.



[SCE-DLKLD](#)

Keylocking Door Latch					
Part Number	Price	Finish	Qty	Includes 28mm Cam	Includes Keys (2)
<a href="#">SCE-DLKLD</a>	\$36.50	Chrome	1	<a href="#">SCE-102804</a>	<a href="#">SCE-K333</a>
<a href="#">SCE-DLKLDB</a>	\$37.00	Black	1	<a href="#">SCE-102804</a>	<a href="#">SCE-K333</a>
<a href="#">SCE-DLKLDB-25</a>	\$807.00	Black	25	<a href="#">SCE-102804</a>	<a href="#">SCE-K333</a>



[SCE-DL7SC](#)

7mm Square Door Latch with Key				
Part Number	Price	Finish	Includes 28mm Cam	Includes Keys (1)
<a href="#">SCE-DL7SC</a>	\$23.00	Chrome	<a href="#">SCE-102804</a>	<a href="#">SCE-101695</a>



[SCE-DL8SB](#)

8mm Square Door Latch with Key				
Part Number	Price	Finish	Includes 28mm Cam	Includes Keys (1)
<a href="#">SCE-DL8SB</a>	\$17.25	Black	<a href="#">SCE-102804</a>	<a href="#">SCE-101697</a>
<a href="#">SCE-DL8SC</a>	\$17.25	Chrome	<a href="#">SCE-102804</a>	<a href="#">SCE-101697</a>



[SCE-DL7TE](#)

7mm Triangular Door Latch with Key				
Part Number	Price	Finish	Includes 28mm Cam	Includes Keys (1)
<a href="#">SCE-DL7TE</a>	\$23.00	Chrome	<a href="#">SCE-102804</a>	<a href="#">SCE-107930</a>



[SCE-DL5MDB](#)

5mm Double-bit Door Latch with Key				
Part Number	Price	Finish	Includes 28mm Cam	Includes Keys (1)
<a href="#">SCE-DL5MDB</a>	\$23.00	Chrome	<a href="#">SCE-102804</a>	<a href="#">SCE-110047</a>
<a href="#">SCE-DL5MDBB</a>	\$23.00	Black	<a href="#">SCE-102804</a>	<a href="#">SCE-110047</a>

# Enclosure Accessories



## Mini 1/4-Turn Latches

Designed for use on Econoline Junction Series (ELJ) enclosures and deep-hinged doors.



[SCE-MINQ](#)

Mini 1/4-Turn Latches				
Part Number	Price	Finish	Includes 35mm Cam	Includes Key
<a href="#">SCE-MINQ</a>	\$13.25	Chrome	<a href="#">SCE-105419</a>	No
<a href="#">SCE-MINQB</a>	\$13.25	Black	<a href="#">SCE-105419</a>	No
<a href="#">SCE-MINQSS</a>	\$20.50	Stainless	No	No
<a href="#">SCE-MINQK*</a>	\$31.00	Chrome	<a href="#">SCE-105419</a>	<a href="#">SCE-2233X</a>

\*Keylocking



[SCE-L](#)

NEMA 1 1/4-Turn Latch	
Part Number	Price
<a href="#">SCE-L</a>	\$15.25

- For use with NEMA 1 enclosures
- Keylocking
- Includes [SCE-105419](#) 35mm cam and (2) [SCE-2233X](#) keys



[SCE-MINQKLB](#)

Black Keylocking Lever Knob Latch		
Part Number	Price	Includes Key
<a href="#">SCE-MINQKLB</a>	\$66.00	<a href="#">SCE-2233X</a>

Note: Cam not included.



[SCE-MINQLB](#)

Black Lever Knob Latch		
Part Number	Price	Qty
<a href="#">SCE-MINQLB</a>	\$38.00	1
<a href="#">SCE-MINQLB-25</a>	\$849.00	25

Note: Cam not included.



[SCE-MINQ6MS](#)

Black 6mm Square Latch with Key	
Part Number	Price
<a href="#">SCE-MINQ6MS</a>	\$45.50

Note: Cam not included.  
Includes (1) 6mm square key.

# Enclosure Accessories

## Door Handles



Designed for use on custom and stock enclosures. Can be used as replacements for installed hardware when a different locking mechanism is desired. 7in and 5in lengths for different size enclosures. Latch cam not included. For 2- or 3-point latch, use SCE-ARK36 Aluminum Door Rod Kit.

Black Die-Cast Zinc Door Handles						
Part Number	Price	Length	Description	Includes Key	Optional Cam	Price
<a href="#">SCE-PCH5</a>	\$115.00	5in	Coinproof/Padlocking	—	<a href="#">SCE-3PTSMC</a>	\$17.50
<a href="#">SCE-PH5</a>	\$115.00	5in	Padlocking	—	<a href="#">SCE-3PTSMC</a>	\$17.50
<a href="#">SCE-PKH5</a>	\$115.00	5in	Keylocking/Padlocking	<a href="#">SCE-KC101 (2)</a>	<a href="#">SCE-3PTSMC</a>	\$17.50
<a href="#">SCE-PCH5-7SC</a>	\$115.00	5in	7mm Square Insert	<a href="#">SCE-101695</a>	<a href="#">SCE-3PTSMC</a>	\$17.50
<a href="#">SCE-PH7</a>	\$132.00	7in	Coinproof/Padlocking	—	<a href="#">SCE-102237</a>	\$16.50
<a href="#">SCE-PCH7</a>	\$132.00	7in	Padlocking	—	<a href="#">SCE-102237</a>	\$16.50
<a href="#">SCE-PKH7</a>	\$132.00	7in	Keylocking/Padlocking	<a href="#">SCE-KC101 (2)</a>	<a href="#">SCE-102237</a>	\$16.50
<a href="#">SCE-PCH7-7SC</a>	\$132.00	7in	7mm Square Insert	<a href="#">SCE-101695</a>	<a href="#">SCE-102237</a>	\$16.50



[SCE-PCH5-7SC](#)



[SCE-PKH7](#)



[SCE-PKH5](#)



[SCE-PCH5](#)



[SCE-PH7](#)

Stainless Steel Door Handles						
Part Number	Price	Length	Description	Includes Key	Optional Cam	Price
<a href="#">SCE-PCH5SS</a>	\$156.00	5in	Coinproof/Padlocking	—	<a href="#">SCE-3PTSMC</a>	\$17.50
<a href="#">SCE-PH5SS</a>	\$143.00	5in	Padlocking	—	<a href="#">SCE-3PTSMC</a>	\$17.50
<a href="#">SCE-PKH5SS</a>	\$152.00	5in	Keylocking/Padlocking	<a href="#">SCE-KC101 (2)</a>	<a href="#">SCE-3PTSMC</a>	\$17.50



[SCE-PCH5SS](#)

# Enclosure Accessories

## Door Handles



Enviroline Series Door Handles				
Part Number	Price	Description	Included Cam	Includes Keys (2)
<u><a href="#">SCE-ELKL</a></u>	\$82.00	Keylocking Handle	<u><a href="#">SCE-102804</a></u>	<u><a href="#">SCE-K333</a></u>
<u><a href="#">SCE-ELPL</a></u>	\$82.00	Padlocking Handle	<u><a href="#">SCE-102804</a></u>	—

Designed for use in the Enviroline Series enclosures, for a quick and easy conversion from the standard 1/4-turn latch, with no added holes or cutouts necessary for installation. Not recommended for enclosures with greater than 36in. height.



[SCE-ELPL](#)



[SCE-ELKL](#)

# Enclosure Accessories



## Latch Rods and Cams

Envioline Three-Point Latch Kit	
Part Number	Price
<b>SCE-3PTL</b>	\$82.00

Designed for use with all Envioline Series enclosures. This simple to install latch kit will add a two- or three-point latching system to the enclosure. The kit includes easy to cut 5/16-inch round rods with rollers and rod guides for a strong functioning latching system. No added holes or cutouts in the enclosure necessary for installation.



**SCE-3PTL**

Aluminum Rod Door Kit with Ramp Shoes		
Part Number	Price	Rod Size
<b>SCE-ARK36</b>	\$153.00	0.375 x 0.625

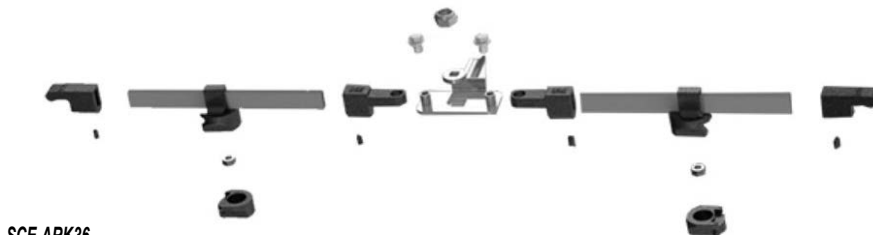

**SCE-ARK36**

35° Plated Steel Cam	
Part Number	Price
<b>SCE-112984</b>	\$2.25

For use with Envioline Junction series enclosures and window kits



28mm Plated Steel Cam	
Part Number	Price
<b>SCE-105419</b>	\$2.75

For use with Series 14 Console Tops with mini 1/4-turn latches



28mm External Stop, Plated Steel Cam		
Part Number	Price	Qty
<b>SCE-102804</b>	\$32.00	10



**SCE-102804**

Plated Steel Cams		
Part Number	Price	Fits
<b>SCE-3PTSMC</b>	\$17.50	5in. door handles
<b>SCE-102237</b>	\$16.50	7in. door handles



**SCE-3PTSMC**

**SCE-102237**

# Enclosure Accessories

## Door Clamps



### Quick Release Clamp Assembly

Part Number	Price	Enclosure Type	Thread Type
<a href="#"><u>SCE-LPQR</u></a>	\$10.75	LP	1/4-20
<a href="#"><u>SCE-QRCH</u></a>	\$10.25	CHNF	10-24

Designed for quick access to an enclosure with standard screw clamps. Black zinc diecast with stainless steel fasteners.



[SCE-LPQR](#)

## Padlock Kits

### Padlock Kit for Junction Boxes

Part Number	Price	Qty
<a href="#"><u>SCE-PLKJIC</u></a>	\$13.25	1

Designed for CHNF enclosures. Maintains water-tight and dust-tight seal. Made of plated steel.



### 304 SS Padlock Bracket

Part Number	Price
<a href="#"><u>SCE-MINQPL</u></a>	\$11.25

Installs with SCE-MINQ mini 1/4-turn latches to allow additional security of a padlock.



### Quick Release Clamp Assembly

Part Number	Price	Enclosure Type	Thread Type	Finish	Qty
<a href="#"><u>SCE-LPCLAMP</u></a>	\$23.00	LP	1/4-20	Chrome	2
<a href="#"><u>SCE-LPCLAMPSS</u></a>	\$29.00	LP	1/4-20	Stainless	2
<a href="#"><u>SCE-CHCLAMP</u></a>	\$22.00	CHNF	10-24	Chrome	2
<a href="#"><u>SCE-CHCLAMPSS</u></a>	\$26.50	CHNF	10-24	Stainless	2

Designed as replacement clamps for SCE enclosures.



[SCE-LPCLAMP](#)



[SCE-CHCLAMPSS](#)



# Enclosure Accessories

## Keys



Replacement keys for standard and optional door hardware.

Keys			
Part Number	Price	Description	Qty
<a href="#">SCE-110047</a>	\$15.25	5mm Double Bit	1
<a href="#">SCE-101695</a>	\$15.25	7mm Square	1
<a href="#">SCE-101697</a>	\$15.25	8mm Square	1
<a href="#">SCE-107930</a>	\$15.25	7mm Triangular	1
<a href="#">SCE-116398</a>	\$15.25	Sanitary 1/4-turn key	1
<a href="#">SCE-K333</a>	\$8.75	Standard Key for 1/4-turn	2
<a href="#">SCE-KC101</a>	\$8.75	Standard Key for SCE L-Handle	2
<a href="#">SCE-2233X</a>	\$15.25	Standard Key for Mini 1/4-turn	1



[SCE-110047](#)



[SCE-101695](#)



[SCE-101697](#)



[SCE-107930](#)



[SCE-116398](#)



[SCE-K333](#)