

Enclosure Accessories

Door Stops



| Door Stop | | |
|-----------------------------------|---------|-------------|
| Part Number | Price | Finish |
| <u>SCE-DSTOPK</u> | \$97.00 | Zinc Plated |

For use on most SCE Type 4, 4x and 12 enclosures to lock door in the open position. Door opening must be at least 12 inches and must open horizontally. Designed to be installed at the bottom of the door opening.

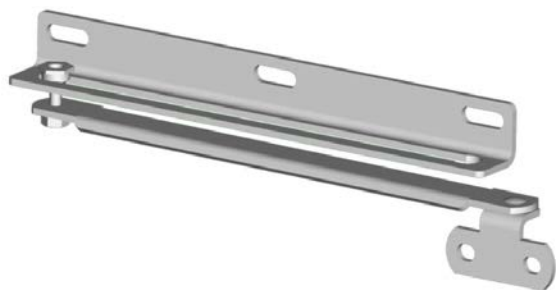

| Cable Door Stop | | | |
|----------------------------------|---------|--------------|----------------------------|
| Part Number | Price | For Use With | Drawing Link |
| <u>SCE-CBL15</u> | \$20.00 | SCE-8P8C | <u>PDF</u> |
| <u>SCE-CBL20</u> | \$20.50 | SCE-8P12C | <u>PDF</u> |

Cable door stops designed for use with Console Enclosures to limit door travel on upward or downward traveling doors.

