



# PxW2 Series Metal Face Inductive Proximity Sensors

## 316L Stainless Steel – DC



- 8mm, 12mm, 18mm, 30mm
- Complete overload protection
- IP65, IP66, IP67, IP68, IP69K rated
- Lock nuts included
- 316L Stainless Steel body
- Metal sensing face provides durable protection
- LED Status indicator
- Lifetime warranty

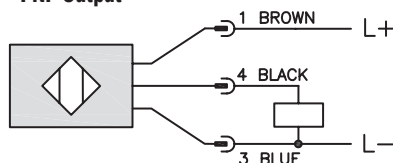


### Metal Face Inductive Proximity Sensors PxW2 Series Selection Chart

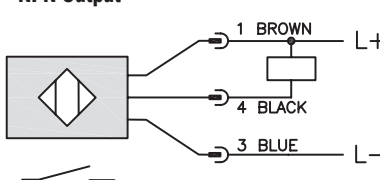
Part Number	Price	Sensing Range	Real Sensing Range (Sr)	Mounting	Switching Frequency	Output State	Logic	Connection	Wiring	Operating Temperature (UL)	Weight g [oz]	Drawing Link
M8 Proximity Sensors												
<a href="#">PEW2-AP-3F</a>	\$33.50	3mm	3 ± 10%	Semi-flush	250 Hz	N.O.	PNP	3-pin M8 quick-disconnect	Diagram 1	-25 to 85°C [-13 to 185°F]	15.8 [0.56]	<a href="#">PDF</a>
<a href="#">PEW2-AN-3F</a>	\$32.00	[0.12in]		Semi-flush		N.O.	NPN		Diagram 2		<a href="#">PDF</a>	
<a href="#">PEW2-AP-4F</a>	\$33.50	5mm	5 ± 10%	Non-flush	500 Hz	N.O.	PNP		Diagram 1		<a href="#">PDF</a>	
<a href="#">PEW2-AN-4F</a>	\$32.00	[0.20in]		Non-flush		N.O.	NPN		Diagram 2		15.3 [0.54]	<a href="#">PDF</a>
M12 Proximity Sensors												
<a href="#">PMW2-AP-3H</a>	\$34.00	4mm [0.16in]	4 ± 10%	Flush	100 Hz	N.O.	PNP	4-pin M12 quick-disconnect	Diagram 1	-25 to 70°C [-13 to 158°F]	25.8 [0.91]	<a href="#">PDF</a>
<a href="#">PMW2-AP-4H</a>	\$34.00	6mm [0.24in]	6 ± 10%	Non-flush	250 Hz	N.O.	PNP		Diagram 1	0 to 70°C [32 to 158°F]	23.9 [0.84]	<a href="#">PDF</a>
M18 Proximity Sensors												
<a href="#">PKW2-AP-3H</a>	\$36.00	8mm [0.31in]	8 ± 10%	Flush	100 Hz	N.O.	PNP	4-pin M12 quick-disconnect	Diagram 1	-25 to 70°C [-13 to 158°F]	44 [1.55]	<a href="#">PDF</a>
<a href="#">PKW2-AP-4H</a>	\$36.00	12mm [0.47in]	12 ± 10%	Non-flush	250 Hz	N.O.	PNP		Diagram 1	0 to 70°C [32 to 158°F]	38.6 [1.36]	<a href="#">PDF</a>
M30 Proximity Sensors												
<a href="#">PTW2-AP-3H</a>	\$44.50	15mm [0.59in]	15 ± 10%	Flush	50 Hz	N.O.	PNP	4-pin M12 quick-disconnect	Diagram 1	-25 to 70°C [-13 to 158°F]	115 [4.05]	<a href="#">PDF</a>
<a href="#">PTW2-AP-4H</a>	\$44.50	25mm [0.98in]	25 ± 10%	Non-flush	100 Hz	N.O.	PNP		Diagram 1	0 to 70°C [32 to 158°F]	106.8 [3.77]	<a href="#">PDF</a>

## Wiring Diagrams

**Diagram 1**  
PNP Output

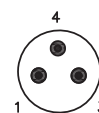


**Diagram 2**  
NPN Output

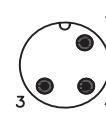


### Connectors

**M8 connector**



**M12 connector**

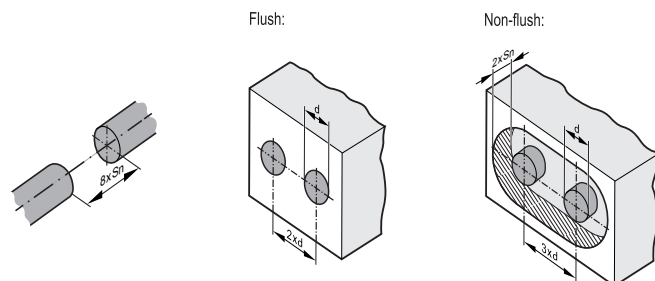


**Warning:** These products are not safety sensors and are not suitable for use in personal safety applications.

# PxW2 Series Metal Face Inductive Proximity Specifications

Metal Face Inductive Proximity Sensors PxW2 Series Specifications				
Sensor	PEW2	PMW2	PKW2	PTW2
Output Type	PNP or NPN, N.O.			
Operating Voltage	10-30 VDC			
No-load Supply Current	≤ 20 mA			
Operating (Load) Current	≤100 mA			
Off-state (Leakage) Current	≤ 0.1 mA			
Voltage Drop	2.5V			
Hysteresis (% of Sr)	3 to 15			
Switch-point Drift (% of Sr)	-10 to 10			
Pressure Rating (bar)	50 [725.19 psi]	100 [1450 psi]		
Protection Class	III			
Reverse Polarity Protection	Yes			
Short-Circuit Protection	Yes			
Protection Degree (DIN 40050)	IP65, IP66, IP67, IP68, IP69K (With IP69K Cable)			
Indication/Switch Status	Yellow LED, switching status, 4 x 90°			
Housing Material	316L stainless steel			
Sensing Face Material	316L stainless steel			
Material Correction Factors	<a href="#">See Material Influence Table</a>			
Shock/Vibration	Shock EN 60068-2-27, Vibration EN 60068-2-6			
Tightening Torque	5 N•m	15 N•m	50 N•m	80 N•m
Connection	3-pin M8 quick-disconnect	4-pin M12 quick-disconnect		
IO-Link	NA			
Agency Approvals	CE, cULus E328811			

To obtain the most current agency approval information, see the Agency Compliance & Certifications Checklist section on the specific part number's web page.



Minimum clearance for installing units of the same type (side-by-side installation). Applies to cylindrical and rectangular sensors. The minimum distance between units may only be disregarded for units with different oscillator frequencies or different sensing principles.

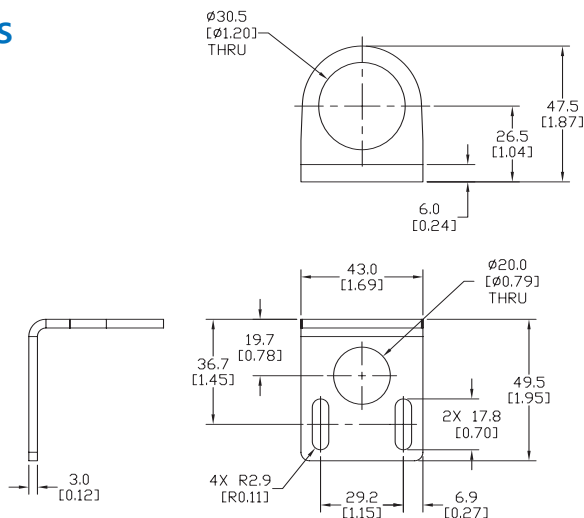
**Warning:** These products are not safety sensors and are not suitable for use in personal safety applications.

## Right-angle Mounting Bracket

Mounting bracket, right-angle, 304 stainless steel. For use with 30mm sensors.

Accessories for FW Series Sensors			
Part Number	Price	Description	Weight lb [g]
<u>ST30C6W</u>	\$5.50	AutomationDirect mounting bracket, right-angle, 304 stainless steel. For use with 30mm sensors.	0.15 (68.0)

## mm [inches]



## ST30C6W

Mounting bracket, right-angle swivel, 360 degree vertical and horizontal adjustment, 12mm rod mount. For use with 30mm sensors. Available in all 304 stainless steel or with an aluminum head with a 304 stainless steel mounting plate.

Accessories for 30mm Sensors						
Part Number	Price	Description	Mounting Head	Mounting Plate	Drawing Link	Weight lb [g]
<a href="#"><u>OPT2118</u></a>	\$11.50	Wenglor mounting bracket, right-angle swivel, 360 degree vertical and horizontal adjustment, aluminum, 12mm rod mount. For use with 30mm sensors.	Aluminum	304 Stainless steel	<a href="#"><u>PDF</u></a>	0.18 [81.7]
<a href="#"><u>OPT2119</u></a>	\$21.00	Wenglor mounting bracket, right-angle swivel, 360 degree vertical and horizontal adjustment, 304 stainless steel, 12mm rod mount. For use with 30mm sensors.	304 Stainless Steel	304 Stainless steel	<a href="#"><u>PDF</u></a>	0.18 [81.7]

Note: 304 Stainless steel mounting rods sold separately: [OPT2109](#) (200mm [7.87 in] length), [OPT2110](#) (300mm [11.81 in] length), and [OPT2111](#) (500mm [19.69 in] length).



## OPT2118, OPT2119