

pro^{sense} PPC5 Advanced Process Controller Accessories



The ProSense [PPC5-CBL1](#) is required to configure a PPC5-1x00 advanced process controller without RS-485 or Ethernet communications via a computer running the Parameter Setting Software (free download from www.automationdirect.com).

PPC5 series controller models with RS-485 (PPC5-1x01) or Ethernet (PPC5-1x02) communications can be configured using the [PPC5-CBL1](#) or via the controller's communication RS-485 terminals or Ethernet port.

All PPC5 series controllers can be configured using the controller's keypad and display.

PPC5 Advanced Process Controller Accessories			
Model	Description	Weight (lbs)	Price
PPC5-CBL1	ProSense configuration cable, USB to micro-USB and IR adapter. For use with all PPC5 Series advanced process controllers.	0.60	\$231.00
USB-485M	USB to RS-485 adapter. For use with PPC5-1x01 advanced process controllers.	0.40	\$60.00

Parameter Setting Software available for free download from www.automationdirect.com

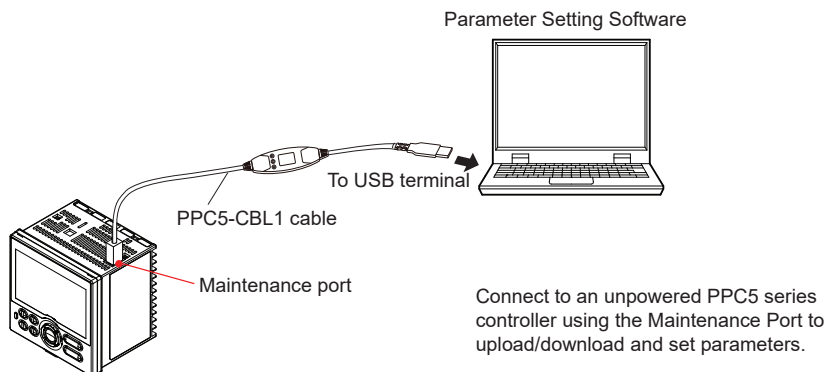

When using the maintenance port, power is provided from the USB port. Do not supply power to the controller through the terminals until disconnected from the maintenance port.

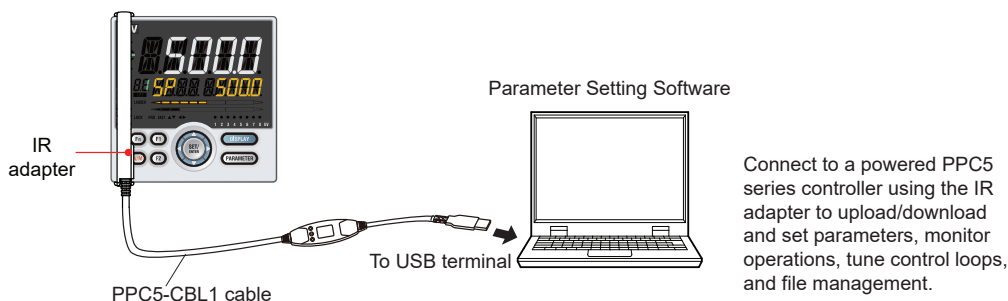

The IR adapter does not power the controller. When using the IR adapter power must be supplied to the controller.