

# APS Inductive Proximity Sensors



**Top Sensing**  
**APS4-12S-E-D**



**Front Sensing**  
**APS4-12M-E-D**



**Top Sensing**  
**APS25-8S-E-D**



**Front Sensing**  
**APS25-8M-E-D**

## Compact 12 x 27 / 8 x 26.5 mm plastic – DC

- Compact polycarbonate housing; comes with mounting plate
- High-frequency oscillation type
- Top or front sensing models
- DC 2-wire or 3-wire
- NPN, PNP, or NPN/PNP
- N.O. or N.C.
- Axial cable
- LED indicator
- IP67 rated
- Lifetime warranty

Compact Rectangular DC Proximity Selection Chart								
Part Number	Price	Sensing Range	Mounting	Output State	Logic	Connection	Wiring	Dimensions
<b>Top-Sensing</b>								
<u>APS25-8S-E-D</u>	\$22.50	2.5mm [0.098 in]	Non-flush	N.O.	NPN	2m [6.5 ft] axial cable	Diagram 1	Figure 1
<u>APS4-12S-E-D</u>	\$22.50	4mm [0.157 in]		N.O.				PNP
<u>APS4-12S-E1-D</u>	\$22.50			N.C.				
<u>APS4-12S-E2-D</u>	\$22.50			N.O.				
<u>APS4-12S-Z-D</u>	\$22.50			N.O.	NPN/ PNP		Diagram 3	
<b>Front-Sensing</b>								
<u>APS25-8M-E-D</u>	\$22.50	2.5mm [0.098 in]	Non-flush	N.O.	NPN	2m [6.5 ft] axial cable	Diagram 1	Figure 2
<u>APS4-12M-E-D</u>	\$22.50	4mm [0.157 in]		N.O.				PNP
<u>APS4-12M-E1-D</u>	\$22.50			N.C.				
<u>APS4-12M-E2-D</u>	\$22.50			N.O.				
<u>APS4-12M-Z-D</u>	\$22.50			N.O.	NPN/ PNP		Diagram 3	

## Wiring Diagrams

**Diagram 1**  
**NPN Output**

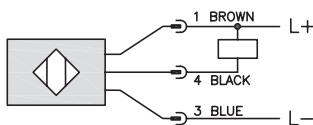

**Diagram 2**  
**PNP Output**

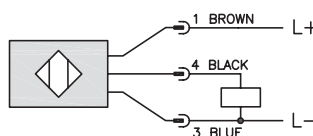

**Diagram 3**  
**NPN/PNP Output**

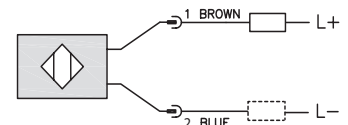

# APS Inductive Proximity Sensors

Compact Rectangular DC Proximity Specifications		
	APS25	APS4
<b>Mounting Type</b>	Non-flush	
<b>Nominal Distance</b>	2.5 mm [0.09 in]	4mm [0.157 in]
<b>Operating Distance</b>	NA	
<b>Material Correction Factor</b>	See the <a href="#">Material influence table</a>	
<b>Output Type</b>	See sensor selection chart	
<b>Operating Voltage</b>	10-30 VDC	
<b>No-load Supply Current</b>	≤ 20mA	≤ 20mA (NA for Z)
<b>Operating (Load) Current</b>	≤ 50mA	
<b>Off-state (Leakage) Current</b>	≤ 0.1 mA (≤ 1.0 mA for Z units)	
<b>Voltage Drop</b>	≤ 1.0 VDC (< 3V for Z models)	
<b>Switching Frequency</b>	500Hz	200Hz
<b>Differential Travel</b>	< 20%	
<b>Repeat Accuracy</b>	NA	
<b>Ripple</b>	NA	
<b>Time Delay Before Availability (tv)</b>	5ms	
<b>Reverse Polarity Protection</b>	NA	
<b>Short Circuit Protection</b>	NA	
<b>Operating Temperature</b>	-10 to +50°C [14 to 122°F]	
<b>Protection Degree (DIN 40050)</b>	IEC IP67	
<b>Indication/Switch Status</b>	Embedded red LED (illuminated when output is active)	
<b>Housing, Sensing Face Material</b>	Polycarbonate	
<b>Shock/Vibration</b>	See <a href="#">Proximity Sensor Terminology</a>	
<b>Tightening Torque</b>	< 0.4 Nm	
<b>Weight (cable/M8 connector)</b>	0.0816 lb	
<b>Connection</b>	2m [6.5 ft] axial cable	
<b>Agency Approvals</b>	CE, cURus [UR E198343]	

## Dimensions

mm [inches]

Figure 1

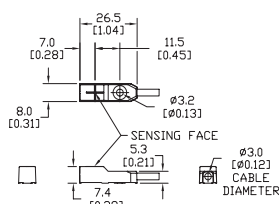

Figure 2

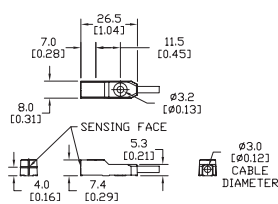

Figure 3

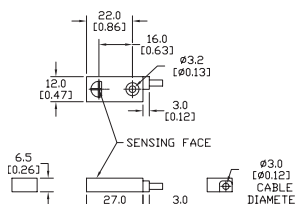
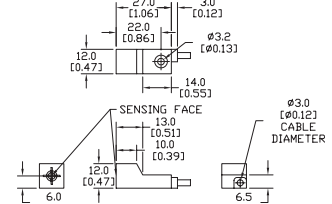
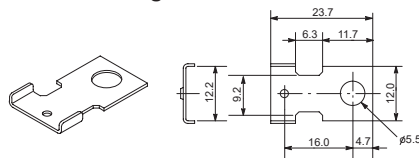

Figure 4



### Mounting Plate



Supplied with APS4x sensors

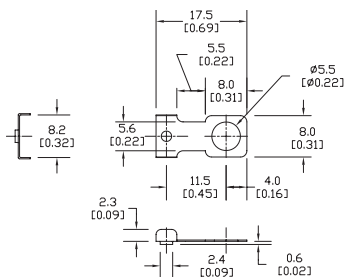

Supplied with APS25x sensors

