

prosense® Differential Pressure Gauges

Part No. DGA-30

Features

- Industrial grade black die-cast aluminum case
- High temperature tolerance
- Resistance-free movement
- 2% full scale accuracy
- Re-zero adjustment
- Mounting and connection hardware included. Other mounting accessories available.
- 5-year warranty

Applications

- Air and compatible non-combustible gasses
- Indicates positive, negative or differential pressure:
 - Filter status
 - Duct static pressure
 - Clean rooms
 - Paint booths
 - Fans or blowers
 - Dust collectors
 - Cabinet purging



ProSense Differential Pressure Gauges				
Part Number	Description	Pcs/Pkg	Wt(lb)	Price
<u>DGA-01</u>	ProSense differential pressure gauge, 0 to 1" water column range	1	1.43	\$67.00
<u>DGA-02</u>	ProSense differential pressure gauge, 0 to 2" water column range	1	1.43	\$67.00
<u>DGA-03</u>	ProSense differential pressure gauge, 0 to 3" water column range	1	1.43	\$67.00
<u>DGA-04</u>	ProSense differential pressure gauge, 0 to 4" water column range	1	1.43	\$67.00
<u>DGA-05</u>	ProSense differential pressure gauge, 0 to 5" water column range	1	1.43	\$67.00
<u>DGA-10</u>	ProSense differential pressure gauge, 0 to 10" water column range	1	1.43	\$72.00
<u>DGA-15</u>	ProSense differential pressure gauge, 0 to 15" water column range	1	1.43	\$72.00
<u>DGA-20</u>	ProSense differential pressure gauge, 0 to 20" water column range	1	1.43	\$72.00
<u>DGA-25</u>	ProSense differential pressure gauge, 0 to 25" water column range	1	1.43	\$72.00
<u>DGA-30</u>	ProSense differential pressure gauge, 0 to 30" water column range	1	1.43	\$72.00
<u>DGA-40</u>	ProSense differential pressure gauge, 0 to 40" water column range	1	1.43	\$72.00
<u>DGA-50</u>	ProSense differential pressure gauge, 0 to 50" water column range	1	1.43	\$72.00
<u>DGA-100</u>	ProSense differential pressure gauge, 0 to 100" water column range	1	1.43	\$72.00
<u>DGA-150</u>	ProSense differential pressure gauge, 0 to 150" water column range	1	1.43	\$72.00
<u>DGA-01B</u>	ProSense differential pressure gauge, -1 to 1" water column range	1	1.43	\$67.00
<u>DGA-02B</u>	ProSense differential pressure gauge, -2 to 2" water column range	1	1.43	\$67.00
<u>DGA-05B</u>	ProSense differential pressure gauge, -5 to 5" water column range	1	1.43	\$67.00
<u>DGA-10B</u>	ProSense differential pressure gauge, -10 to 10" water column range	1	1.43	\$72.00
<u>DGA-15B</u>	ProSense differential pressure gauge, -15 to 15" water column range	1	1.43	\$72.00

ProSense Differential Pressure Gauges Specifications	
Dial Size	4" (100mm), white aluminum with black markings
Case	Die-cast black aluminum
Lens	Polycarbonate
Ring	Threaded die-cast black aluminum
Connection	(2) high and (2) low pressure ports, 1/8" female NPT, located on side and back
Wetted Parts	Aluminum, silicone rubber
Mounting	Vertical position, flush or surface mount with included hardware
Movement	Resistance-free and magnetic
Pointer	Aluminum, anodized black
Media	Air and compatible non-combustible gases
Over Pressure Limit	14.5 psi / 100 kPa / 400 inH ₂ O maximum
Ambient Temperature	-40°F to 140°F (-40°C to 60°C)
Process Temperature	14°F to 140°F (-10°C to 60°C)
Accuracy	±2% of full scale
IP Rating	Unit IP67 - Enclosure rating dependent on installation method

prosense® Differential Pressure Gauges

Dimensions

inches [mm]

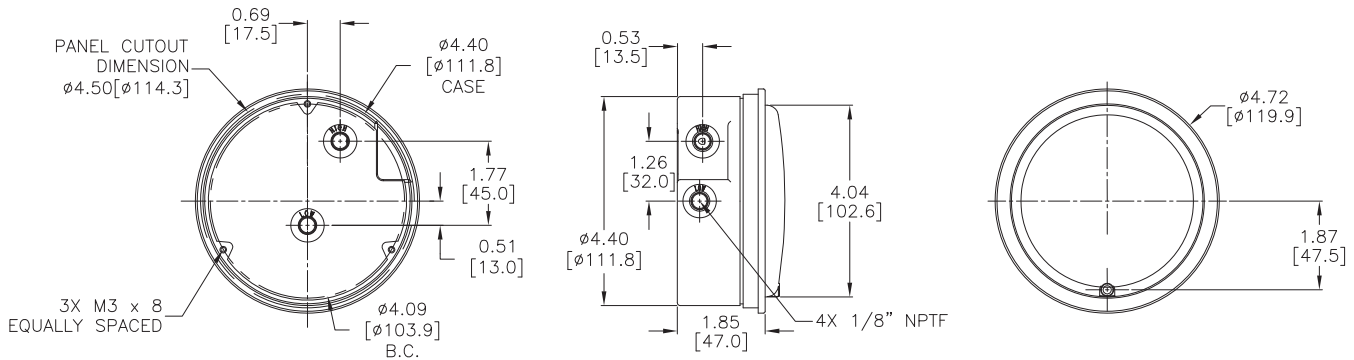

Panel Mounting

Cut a circular opening in the panel to allow a close fit of 4.41" (112mm) gauge case diameter. Refer to above drawing.

- Gauges include:
 - (3) angled mounting brackets with short and long screws
 - (2) brass hose barb connectors with 1/8" NPT threads*
 - (2) 1/8" NPT threaded plugs
- *Note: Plastic tubing with a minimum inside diameter of 0.170 inches and less than 0.275 inches can be used with the brass hose barb connectors.

See our website www.AutomationDirect.com for complete Engineering drawings.



DGA shown with included brackets, screws, fittings and plugs

Application Examples



Air/gas flow as a function of blower static pressure

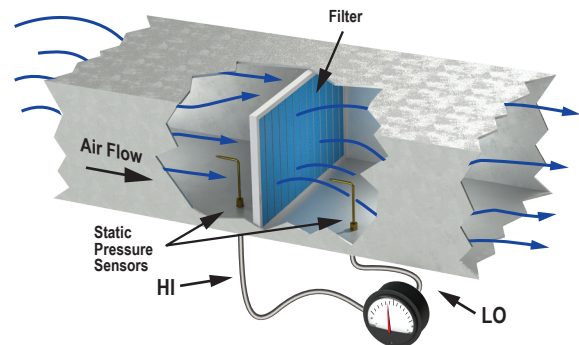

Filter condition monitoring

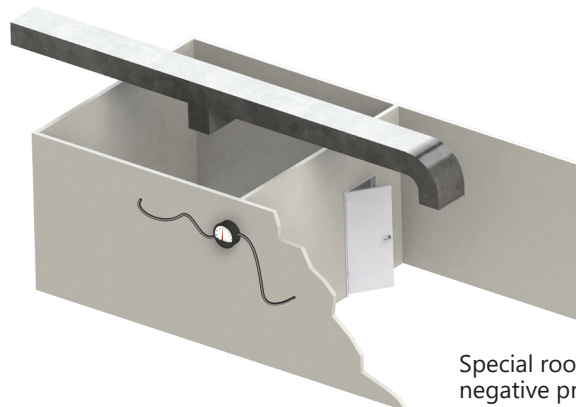

Special room positive or negative pressure indication

prosense® Differential Pressure Gauges

Accessories

Applications

- **DGA-T Static Pressure Tip:**
Use the **DGA-T** to sense static pressure in ducts, across filters, coils, fans, etc. The angled tip is brass, has a 4" insertion depth and four radial 0.04" sensing holes. The tip also has a compression fitting for use with 1/4" OD metal or plastic tubing.
- **DGA-B Surface Mount Bracket:**
Mount the DGA gauge to the pre-drilled holes in the metal **DGA-B** mounting bracket and then mount the bracket to any vertical flat surface.
- **DGA-R Panel Mount Flange:**
Secure the plastic flange to the DGA gauge with the three set screws in the flange. The DGA can now be mounted to a panel using the three mounting holes in the flange and the included mounting screws.

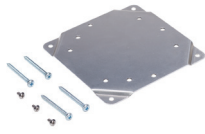
Part No. **DGA-B**Part No. **DGA-R**Part No. **DGA-T**Part **DGA-B** shown with
DGA Differential Pressure
GaugePart **DGA-R** shown with
DGA Differential Pressure
Gauge

ProSense Differential Pressure Gauges Accessories				
Part Number	Description	Pcs/Pkg	Wt(lb)	Price
DGA-T	ProSense static pressure tip with compression fitting, brass, for use with DGA series differential pressure gauges or DPTA series differential pressure transmitters.	1	0.07	\$18.00
DGA-B	ProSense surface mount bracket, aluminum, for use with DGA series differential pressure gauges. Hardware included.	1	0.1	\$11.50
DGA-R	ProSense panel mount flange, ABS plastic, for use with DGA series differential pressure gauges. Hardware included.	1	0.15	\$12.00

Dimensions

inches [mm]

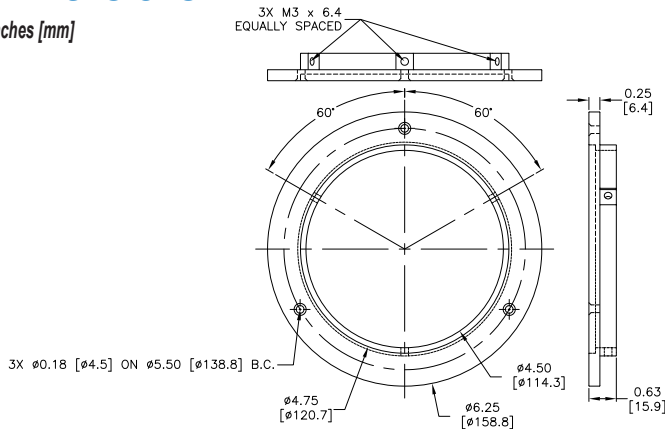
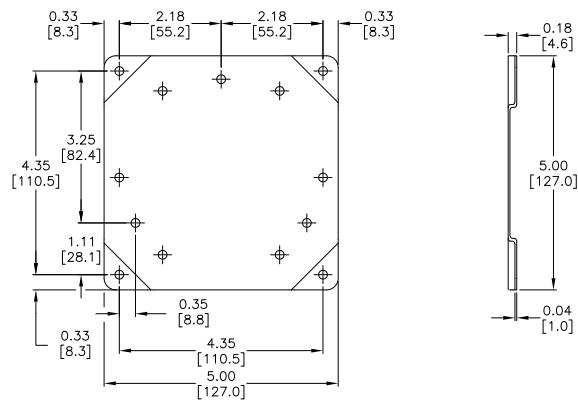
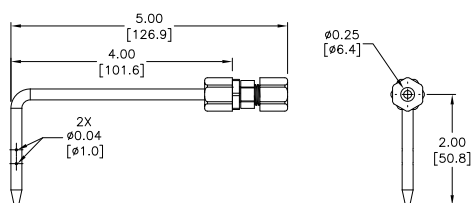
Part No. **DGA-R**Part No. **DGA-B**Part No. **DGA-T**See our website www.AutomationDirect.com for complete Engineering drawings.