



# D2-Series Heavy Duty Pneumatic Cylinders – Accessories

## Rod Clevis



Part no. [D2RC-2](#)



Note: Comes with Pivot Pin installed.

### D2-Series Heavy Duty Pneumatic Cylinder Accessories

Part Number	Description	Pcs/Pkg	Wt (lb)	Price	Drawing Link
<a href="#">D2RC-1</a>	NITRA rod clevis, 7/16-20 UNF thread, steel. For use with D2 series NFPA cylinders.	1	0.3	\$29.00	<a href="#">PDF</a>
<a href="#">D2RC-2</a>	NITRA rod clevis, 3/4-16 UNF thread, steel. For use with D2 series NFPA cylinders.	1	0.8	\$40.00	<a href="#">PDF</a>

## Rod Eye



Part no. [D2RE-2](#)

### D2-Series Heavy Duty Pneumatic Cylinder Accessories

Part Number	Description	Pcs/Pkg	Wt (lb)	Price	Drawing Link
<a href="#">D2RE-1</a>	NITRA rod eye, 7/16-20 UNF thread, steel. For use with D2 series NFPA cylinders.	1	0.4	\$33.50	<a href="#">PDF</a>
<a href="#">D2RE-2</a>	NITRA rod eye, 3/4-16 UNF thread, steel. For use with D2 series NFPA cylinders.	1	1.2	\$47.50	<a href="#">PDF</a>



# D2-Series Heavy Duty Pneumatic Cylinders – Accessories

## Rear Clevis

Part no. [D2PC-3](#)Part no. [D2SPC-3](#)

Note: Comes with pivot pin installed.

### D2-Series Heavy Duty Pneumatic Cylinder Accessories

Part Number	Description	Pcs/Pkg	Wt (lb)	Price	Drawing Link
<a href="#">D2PC-1</a>	NITRA cylinder rear clevis bracket, steel. For use with 1.5in bore D2 series NFPA cylinders. Mounting hardware included.	1	0.5	\$31.50	<a href="#">PDF</a>
<a href="#">D2PC-2</a>	NITRA cylinder rear clevis bracket, steel. For use with 2in bore D2 series NFPA cylinders. Mounting hardware included.	1	0.7	\$37.00	<a href="#">PDF</a>
<a href="#">D2PC-3</a>	NITRA cylinder rear clevis bracket, steel. For use with 2.5in bore D2 series NFPA cylinders. Mounting hardware included.	1	0.8	\$43.50	<a href="#">PDF</a>
<a href="#">D2PC-4</a>	NITRA cylinder rear clevis bracket, steel. For use with 3.25in bore D2 series NFPA cylinders. Mounting hardware included.	1	1.6	\$55.00	<a href="#">PDF</a>
<a href="#">D2PC-5</a>	NITRA cylinder rear clevis bracket, steel. For use with 4in bore D2 series NFPA cylinders. Mounting hardware included.	1	1.7	\$62.00	<a href="#">PDF</a>
<a href="#">D2SPC-1</a>	NITRA cylinder rear short clevis bracket, steel. For use with 1.5in bore D2 series NFPA cylinders. Mounting hardware included.	1	0.7	\$31.50	<a href="#">PDF</a>
<a href="#">D2SPC-2</a>	NITRA cylinder rear short clevis bracket, steel. For use with 2in bore D2 series NFPA cylinders. Mounting hardware included.	1	0.7	\$37.00	<a href="#">PDF</a>
<a href="#">D2SPC-3</a>	NITRA cylinder rear short clevis bracket, steel. For use with 2.5in bore D2 series NFPA cylinders. Mounting hardware included.	1	0.8	\$43.50	<a href="#">PDF</a>
<a href="#">D2SPC-4</a>	NITRA cylinder rear short clevis bracket, steel. For use with 3.25in bore D2 series NFPA cylinders. Mounting hardware included.	1	2.4	\$55.00	<a href="#">PDF</a>
<a href="#">D2SPC-5</a>	NITRA cylinder rear short clevis bracket, steel. For use with 4in bore D2 series NFPA cylinders. Mounting hardware included.	1	3.2	\$62.00	<a href="#">PDF</a>

## Rear Pivot Eye

Part no. [D2PA-3](#)

### D2-Series Heavy Duty Pneumatic Cylinder Accessories

Part Number	Description	Pcs/Pkg	Wt (lb)	Price	Drawing Link
<a href="#">D2PA-1</a>	NITRA rear pivot eye, steel. For use with 1.5in bore D2 series NFPA cylinders. Mounting hardware included.	1	0.4	\$31.50	<a href="#">PDF</a>
<a href="#">D2PA-2</a>	NITRA rear pivot eye, steel. For use with 2in bore D2 series NFPA cylinders. Mounting hardware included.	1	0.5	\$37.00	<a href="#">PDF</a>
<a href="#">D2PA-3</a>	NITRA rear pivot eye, steel. For use with 2.5in bore D2 series NFPA cylinders. Mounting hardware included.	1	0.7	\$43.50	<a href="#">PDF</a>
<a href="#">D2PA-4</a>	NITRA rear pivot eye, steel. For use with 3.25in bore D2 series NFPA cylinders. Mounting hardware included.	1	1.3	\$55.00	<a href="#">PDF</a>
<a href="#">D2PA-5</a>	NITRA rear pivot eye, steel. For use with 4in bore D2 series NFPA cylinders. Mounting hardware included.	1	1.4	\$62.00	<a href="#">PDF</a>



# D2-Series Heavy Duty Pneumatic Cylinders – Accessories

## Flange Attachment

Part no. [D2FM-2](#)

D2-Series Heavy Duty Pneumatic Cylinder Accessories						
Part Number	Description	Pcs/Pkg	Wt (lb)	Price	Drawing Link	
<a href="#">D2FM-1</a>	NITRA flange mount plate, steel. For use with 1.5in bore D2 series NFPA cylinders. Mounting hardware included.	1	0.3	\$31.50	<a href="#">PDF</a>	
<a href="#">D2FM-2</a>	NITRA flange mount plate, steel. For use with 2in bore D2 series NFPA cylinders. Mounting hardware included.	1	0.4	\$36.00	<a href="#">PDF</a>	
<a href="#">D2FM-3</a>	NITRA flange mount plate, steel. For use with 2.5in bore D2 series NFPA cylinders. Mounting hardware included.	1	0.5	\$41.00	<a href="#">PDF</a>	
<a href="#">D2FM-4</a>	NITRA flange mount plate, steel. For use with 3.25in bore D2 series NFPA cylinders. Mounting hardware included.	1	3.0	\$53.00	<a href="#">PDF</a>	
<a href="#">D2FM-5</a>	NITRA flange mount plate, steel. For use with 4in bore D2 series NFPA cylinders. Mounting hardware included.	1	4.3	\$59.00	<a href="#">PDF</a>	

## Rod Couplers

Part no. [D2RCP-2](#)

NITRA self-aligning rod couplers reduce cylinder alignment issues by compensating for  $\pm 1^\circ$  angular error and 1/16" lateral misalignment on both the extension and retraction strokes. Better reliability by reducing cylinder and component wear.

D2-Series Heavy Duty Pneumatic Cylinder Accessories						
Part Number	Description	Pcs/Pkg	Wt (lb)	Price	Drawing Link	
<a href="#">D2RCP-1</a>	NITRA self-aligning rod coupler, 7/16-20 UNF thread, steel. For use with D2 series NFPA cylinders.	1	0.5	\$45.00	<a href="#">PDF</a>	
<a href="#">D2RCP-2</a>	NITRA self-aligning rod coupler, 3/4-16 UNF thread, steel. For use with D2 series NFPA cylinders.	1	0.6	\$68.00	<a href="#">PDF</a>	

## Jam Nuts

Part no. [D2-34-16](#)

D2-Series Heavy Duty Pneumatic Cylinder Accessories						
Part Number	Description	Pcs/Pkg	Wt (lb)	Price	Drawing Link	
<a href="#">D2-716-20</a>	NITRA jam nut, 7/16-20 UNF thread, steel. For use with D2 series NFPA cylinders.	1	0.02	\$1.75	<a href="#">PDF</a>	
<a href="#">D2-34-16</a>	NITRA jam nut, 3/4-16 UNF thread, steel. For use with D2 series NFPA cylinders.	1	0.07	\$5.50	<a href="#">PDF</a>	



# D2-Series Heavy Duty Pneumatic Cylinders – Accessories

## Mount Brackets

Part no. **D2AM-3**Part no. **D2BB-3**

### D2-Series Heavy Duty Pneumatic Cylinder Accessories

Part Number	Description	Pcs/Pkg	Wt (lb)	Price	Drawing Link
<a href="#">D2AM-1</a>	NITRA angle mount bracket, steel. For use with 1.5in bore D2 series NFPA cylinders. Mounting hardware included.	1	0.5	\$29.50	<a href="#">PDF</a>
<a href="#">D2AM-2</a>	NITRA angle mount bracket, steel. For use with 2in bore D2 series NFPA cylinders. Mounting hardware included.	1	0.9	\$34.00	<a href="#">PDF</a>
<a href="#">D2AM-3</a>	NITRA angle mount bracket, steel. For use with 2.5in bore D2 series NFPA cylinders. Mounting hardware included.	1	0.9	\$39.50	<a href="#">PDF</a>
<a href="#">D2AM-4</a>	NITRA angle mount bracket, steel. For use with 3.25in bore D2 series NFPA cylinders. Mounting hardware included.	1	1.5	\$50.00	<a href="#">PDF</a>
<a href="#">D2AM-5</a>	NITRA angle mount bracket, steel. For use with 4in bore D2 series NFPA cylinders. Mounting hardware included.	1	2.2	\$56.00	<a href="#">PDF</a>
<a href="#">D2BB-1</a>	NITRA base mount bracket, anodized aluminum. For use with 1.5in bore D2 series NFPA cylinders. Mounting hardware included.	1	0.3	\$36.00	<a href="#">PDF</a>
<a href="#">D2BB-2</a>	NITRA base mount bracket, anodized aluminum. For use with 2in bore D2 series NFPA cylinders. Mounting hardware included.	1	0.4	\$41.50	<a href="#">PDF</a>
<a href="#">D2BB-3</a>	NITRA base mount bracket, anodized aluminum. For use with 2.5in bore D2 series NFPA cylinders. Mounting hardware included.	1	0.6	\$49.00	<a href="#">PDF</a>
<a href="#">D2BB-4</a>	NITRA base mount bracket, anodized aluminum. For use with 3.25in bore D2 series NFPA cylinders. Mounting hardware included.	1	1.1	\$59.00	<a href="#">PDF</a>
<a href="#">D2BB-5</a>	NITRA base mount bracket, anodized aluminum. For use with 4in bore D2 series NFPA cylinders. Mounting hardware included.	1	1.2	\$59.00	<a href="#">PDF</a>

## Seal Kits

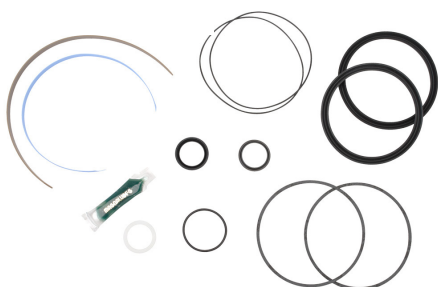

### D2-Series Heavy Duty Pneumatic Cylinder Replacement Seal Kit

Part Number	Description	Pcs/Pkg	Wt (lb)	Price
<a href="#">D2SK-24</a>	NITRA seal kit, for use with 1.5in bore NFPA cylinders. All wear parts for both D-series and D2-series NFPA cylinders included.	1	0.1	\$87.00
<a href="#">D2SK-32</a>	NITRA seal kit, for use with 2in bore NFPA cylinders. All wear parts for both D-series and D2-series NFPA cylinders included.	1	0.1	\$93.00
<a href="#">D2SK-40</a>	NITRA seal kit, for use with 2.5in bore NFPA cylinders. All wear parts for both D-series and D2-series NFPA cylinders included.	1	0.1	\$96.00
<a href="#">D2SK-52</a>	NITRA seal kit, for use with 3.25in bore NFPA cylinders. All wear parts for both D-series and D2-series NFPA cylinders included.	1	0.2	\$117.00
<a href="#">D2SK-64</a>	NITRA seal kit, for use with 4in bore NFPA cylinders. All wear parts for both D-series and D2-series NFPA cylinders included.	1	0.2	\$127.00