

# NEMA 1, 3R, and 3RX Stainless Steel Screw Cover Wall-Mount without Knockouts



## Applications

Designed for use as wiring boxes and junction boxes, these enclosures provide protection against rain, sleet and snow in outdoor applications, or against dripping water indoors. Can also be used in corrosive environments.

## Construction

- Body and cover fabricated from 304 stainless steel
- Slip-on reversible cover securely fastened with screws located along bottom edge
- Mounting holes located on back of enclosure
- Drip shield top and smooth seamless sides and front
- No gasket required
- Hasp for padlocking or meter seal provided, except as noted

## Finish

- Exterior surfaces have #3 intermediate polished finish

## Listings

- UL 50, 1, 3R, 3RX [UL file E23553]
- NEMA/EEMAC 1, 3R, and 3RX



Note: To remove cover, move down, then out. 4x 4 x 4 in [102 x 102 x 102 mm] only has 2 mounting holes centered horizontally. 4x 6 x 4 in [102 x 152 x 102 mm] only has 2 mounting holes centered vertically.

| NEMA 1, 3R, and 3RX Stainless Steel Screw Cover without Knockouts    |            |   |             |
|--|------------|---|-------------|
| Part Number  | Price      | Enclosure Size<br>H x W x D             | Steel Gauge |
| <a href="#"><u>RSC060604NKSS</u></a>                                 | \$86.00    | 6.06 x 6.30 x 4.41 [154 x 160 x 112]    | 16          |
| <a href="#"><u>RSC060606NKSS</u></a>                                 | \$89.00    | 6.06 x 6.30 x 6.41 [154 x 160 x 163]    |             |
| <a href="#"><u>RSC080804NKSS</u></a>                                 | \$106.00   | 8.06 x 8.30 x 4.41 [205 x 211 x 112]    |             |
| <a href="#"><u>RSC080806NKSS</u></a>                                 | \$113.00   | 8.06 x 8.30 x 6.41 [205 x 211 x 163]    |             |
| <a href="#"><u>RSC081004NKSS</u></a>                                 | \$117.00   | 10.06 x 8.30 x 4.41 [256 x 211 x 112]   |             |
| <a href="#"><u>RSC081006NKSS</u></a>                                 | \$128.00   | 10.06 x 8.30 x 6.41 [256 x 211 x 163]   |             |
| <a href="#"><u>RSC101004NKSS</u></a>                                 | \$139.00   | 10.06 x 10.30 x 4.41 [256 x 262 x 112]  |             |
| <a href="#"><u>RSC101006NKSS</u></a>                                 | \$145.00   | 10.06 x 10.30 x 6.41 [256 x 262 x 163]  |             |
| <a href="#"><u>RSC121204NKSS</u></a>                                 | \$156.00   | 12.06 x 12.30 x 4.41 [306 x 312 x 112]  |             |
| <a href="#"><u>RSC121206NKSS</u></a>                                 | \$181.00   | 12.06 x 12.30 x 6.41 [306 x 312 x 163]  |             |
| <a href="#"><u>RSC121208NKSS</u></a>                                 | \$209.00   | 12.06 x 12.30 x 8.41 [306 x 312 x 214]  |             |
| <a href="#"><u>RSC181804NKSS</u></a>                                 | \$318.00   | 18.06 x 18.30 x 4.41 [459 x 465 x 112]  |             |
| <a href="#"><u>RSC181808NKSS</u></a>                                 | \$407.00   | 18.06 x 18.30 x 8.41 [459 x 465 x 214]  | 14          |
| <a href="#"><u>RSC242406NKSS</u></a>                                 | \$546.00   | 24.07 x 24.36 x 6.47 [611 x 619 x 164]  |             |
| <a href="#"><u>RSC242412NKSS</u></a>                                 | \$730.00   | 24.07 x 24.36 x 12.47 [611 x 619 x 317] | 12          |
| <a href="#"><u>RSC303012NKSS</u></a>                                 | \$1,326.00 | 30.10 x 30.57 x 12.56 [765 x 776 x 319] |             |
| <a href="#"><u>RSC363612NKSS</u></a>                                 | \$1,983.00 | 36.10 x 36.57 x 12.56 [917 x 929 x 319] |             |
| Note: Dimensions in inches [millimeters].<br>*No hasp or meter seal. |            |   |             |

# NEMA 1, 3R, and 3RX Stainless Steel Screw Cover Wall-Mount without Knockouts



## Dimensions

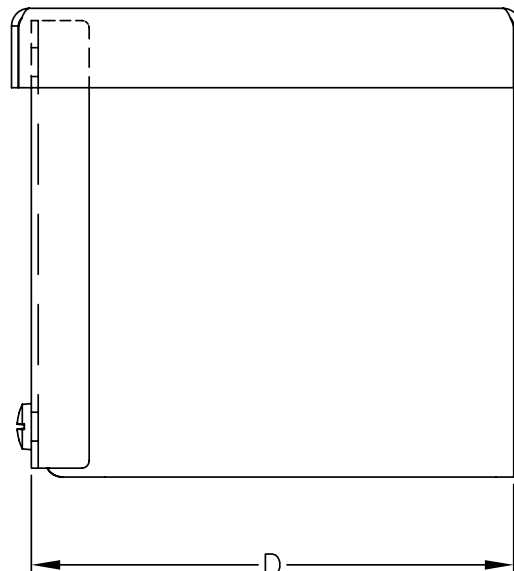
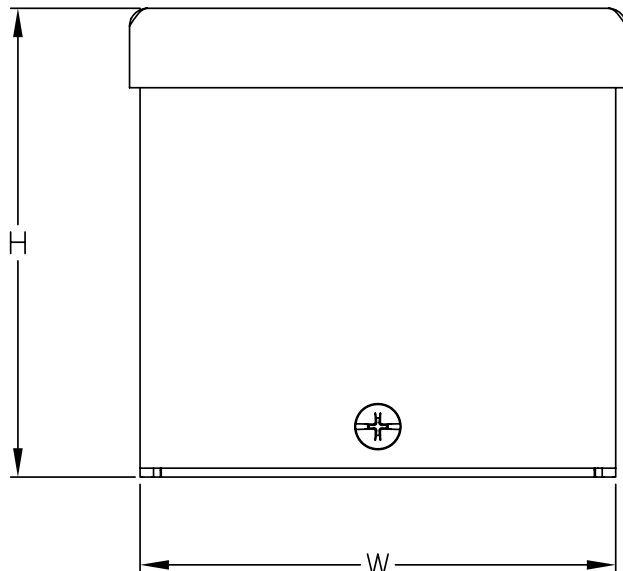

### Grounding Kit

| Part Number   | Description   | Price  |
|---------------|---------------|--------|
| <b>WGNDKT</b> | Grounding Kit | \$3.25 |

Note: Field grounding kit includes necessary parts to properly ground enclosure.