

NEMA 12 Two-Door Freestanding



Application

Designed to protect electrical and electronic controls, components, and instruments in typical industrial environments. Enclosures protect equipment from dust, dirt, oil and dripping water. These enclosures are used in machine tool applications for housing motor starters, drives, contactors, and PLCs, as well as a wide variety of other electrical and electronic equipment. The enclosures are found extensively in automotive, pulp and paper, wood products, textile and similar industries.



Construction

- Continuously-welded seams ground smooth
- Body stiffeners for extra rigidity
- Heavy-duty lifting eyes for easy handling
- Grounding provisions provided
- Heavy gauge continuous hinges support each door
- 3-point latching mechanism with oil-tight key-locking handle provided
- Doors sealed with a closed-cell neoprene gasket
- Stiffeners welded to back of two-door enclosures maintain flatness and increase rigidity
- "Uni-strut" mounting channels are welded horizontally to interior body sides and top, bottom and center to allow back panels to be positioned in enclosure
- Optional swing, half, full, and rack panels can be mounted anywhere along "uni-strut" channel
- Uses [WAL4 series handles](#) and [WAEMKA4 replacement key](#)

Finish

- ANSI 61 gray polyester powder light texture inside and out over phosphatized surfaces

Listings

- UL 50812 [UL File E64791]
- NEMA/EEMAC Type



Shipping Schedule

Same day	1 - 5 days	1 - 7 days	1 - 15 days	1 - 20 days
----------	------------	------------	-------------	-------------

Color indicates shipping lead time in business days.

NEMA 12 Two-Door Freestanding

Part Number	Price	Enclosure SizeHxWxD
WA604818FSD	\$3,124.00	60.12 x 48.12 x 19.23 [1527 x 1222 x 488]
WA724818FSD	\$3,345.00	72.12 x 48.12 x 19.16 [1832 x 1222 x 487]
WA727218FSD	\$4,292.00	72.12 x 72.13 x 19.16 [1832 x 1832 x 487]
WA727224FSD	\$4,634.00	72.12 x 72.13 x 25.16 [1832 x 1832 x 639]

Notes: Subpanels must be ordered separately.
Dimensions in inches [millimeters].
Letters in table correspond to letters on dimensional drawings.

NEMA 12 Two-Door Freestanding



Dimensions

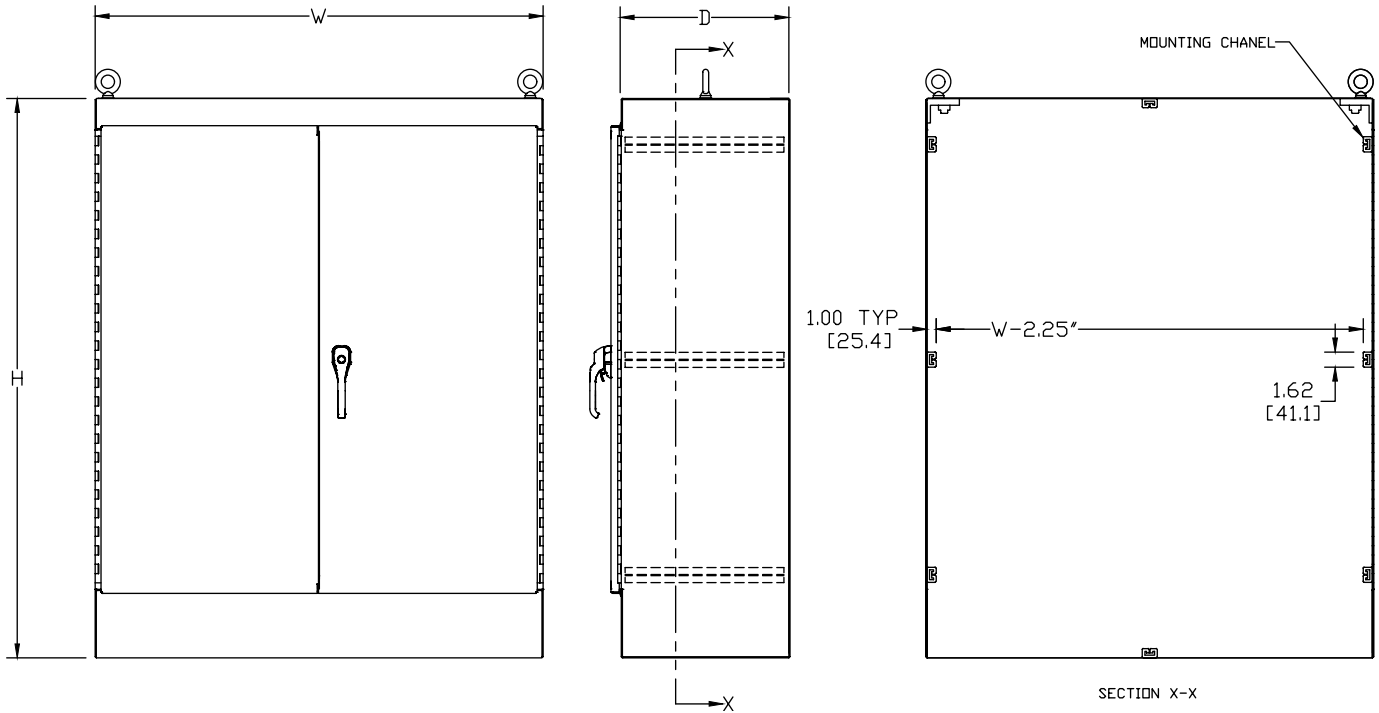

Standard Subpanels for Freestanding Enclosures



Shipping Schedule				
Same day	1 - 5 days	1 - 7 days	1 - 15 days	1 - 20 days
Color indicates shipping lead time in business days.				

Standard Subpanels for Freestanding Enclosures		
Enclosures	Standard Subpanels	
	Full Height	
	Painted Steel	Galvanized
<u>WA604818FSD</u>	<u>WA60P48F1</u>	<u>WA60P48F1G</u>
<u>WA724818FSD</u>	<u>WA72P48F1</u>	<u>WA72P48F1G</u>
<u>WA727218FSD</u>	<u>WA72P72F1</u>	—
<u>WA727224FSD</u>	<u>WA72P72F1</u>	—
<u>WA723024FSDA</u>	<u>WA72P30F1</u>	<u>WA72P30F1G</u>
<u>WA723624FSDA</u>	<u>WA72P36F1</u>	<u>WA72P36F1G</u>

Side-Mount Subpanels for Freestanding Enclosures



Shipping Schedule				
Same day	1 - 5 days	1 - 7 days	1 - 15 days	1 - 20 days
Color indicates shipping lead time in business days.				

Side-Mount Panels for Freestanding Enclosures		
Enclosures	Side-Mount Panels	
	Painted Steel	
<u>WA724818FSD</u>	<u>WA72SMP14</u>	
<u>WA727218FSD</u>	<u>WA72SMP14</u>	
<u>WA727224FSD</u>	<u>WA72SMP14</u>	<u>WA72SMP20</u>
<u>WA723024FSDA</u>	<u>WA72SMP14</u>	<u>WA72SMP20</u>
<u>WA723624FSDA</u>	<u>WA72SMP14</u>	<u>WA72SMP20</u>

Enclosure Accessories – Electrical Interlocks and Defeater



Electrical Interlocks

The WAEK115 is designed to be used with standard Wiegmann door latching mechanisms. When energized, this interlock will prevent the door handle from being turned. This interlock is designed to fit handles in the following enclosures:

- All two-door NEMA 12 enclosures
- Freestanding NEMA 12 enclosures
- All consoles
- All single-door NEMA 12 enclosures which have three-point handle mechanisms
- Multi-door NEMA 12 enclosures

The WAEK115NDH is designed to be used with standard Wiegmann enclosures that have no handles. This interlock requires drilling several holes in the cover and the body for mounting.

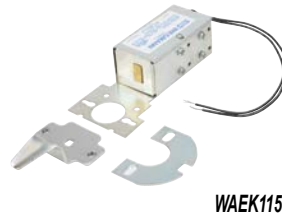

WAEK115



WAEK115NDH

Shipping Schedule				
Same day	1 - 5 days	1 - 7 days	1 - 15 days	1 - 20 days
Color indicates shipping lead time in business days.				

Interlocks	Price	Description	Volts/Hz	Wt. [lb]
WAEK115	\$233.00	Wiegmann enclosure interlock defeater. key-operated, to disengage interlocks WAEK115 / WAEK115NDH.	120/60	0.2
WAEK115NDH	\$290.00	Wiegmann enclosure electrical interlock, Prevents entry into energized enclosure that has no door handle.	120/60	0.2

Interlock Defeater

This defeater is key-operated and enables personnel to enter an enclosure while the enclosure's internal components are energized. Turning the key disengages the circuit to the electrical interlock.

Interlock Defeater	Price	Description	Wt. [lb]
WAEKDF	\$103.00	Wiegmann enclosure interlock defeater, key-operated, to disengage interlocks WAEK115 / WAEK115NDH	0.2



WA-F1/F2 Panels for Two-Door Freestanding Enclosures

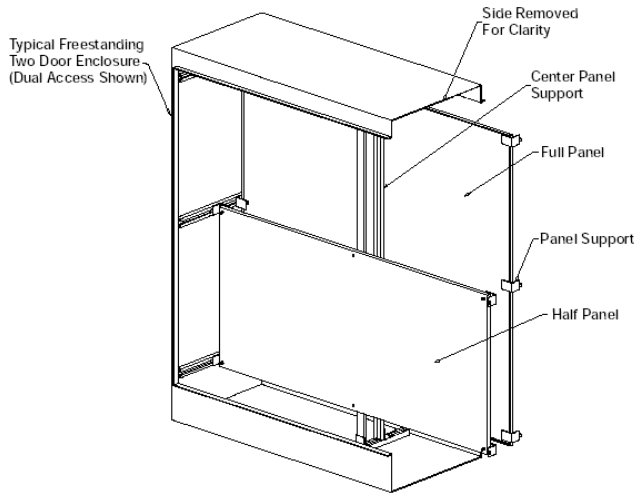

Description

- Panels for two-door single-access and two-door dual-access, freestanding NEMA 12 enclosures
- Manufactured of 10-gauge steel and can be positioned anywhere along horizontal depth-wise mounting channels
- Half-height panels can be located in the upper or lower portion of the enclosure
- Mounting hardware is furnished with each panel
- Painted steel subpanels are painted white polyester powder over phosphatized surfaces
- Galvanized subpanels have a conductive finish (no paint)

Shipping Schedule				
Same day	1 - 5 days	1 - 7 days	1 - 15 days	1 - 20 days

Color indicates shipping lead time in business days.

Painted Steel	Price	Galvanized	Price	Panel Size AxB	Subpanel Type
WA60P48F1	\$708.00	WA60P48F1G	\$708.00	48.00 x 44.00 [1219 x 1118]	Full
WA72P48F1	\$801.00	WA72P48F1G	\$801.00	60.00 x 44.00 [1524 x 1118]	Full
WA72P60F1	\$928.00	WA72P60F1G	\$928.00	60.00 x 56.00 [1524 x 1422]	Full
WA72P72F1	\$1,055.00	—	—	68.00 x 68.00 [1727 x 1727]	Full
WA90P48F1	\$942.00	WA90P48F1G	\$1,020.00	78.00 x 44.00 [1981 x 1118]	Full
WA90P72F1	\$1,272.00	—	—	78.00 x 68.00 [1981 x 1727]	Full

Notes: Dimensions in inches [millimeters].
 Letters in table correspond to letters on dimensional drawing.
 Suffix F1 = full panel, F2 = half panel

Dimensions

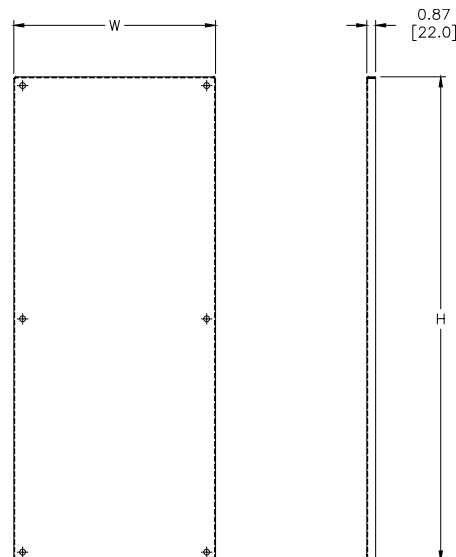

Note: Center panel support is supplied with a regular two-door enclosure panel. This support is used only as a brace. It is not intended to be used as a support for single-door subpanels, relay racks, etc. Use WA_FSCPS panel supports for this purpose.

WA-SMP Series Side-Mount Panels for Freestanding Enclosures

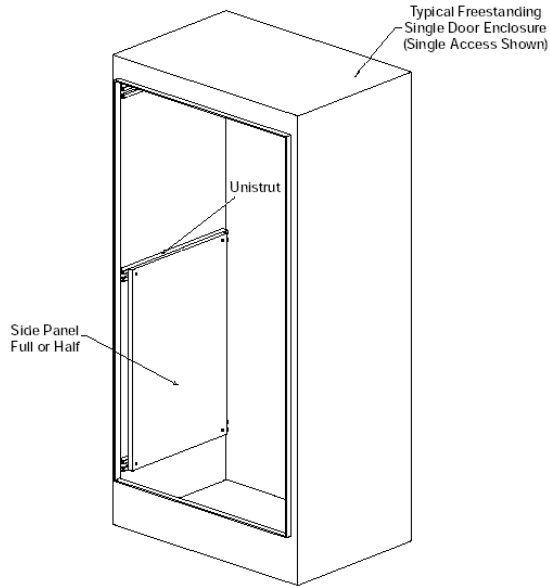

Description

- Panels for freestanding NEMA 4 and freestanding NEMA 12 enclosures
- Panels are fabricated from 12-gauge steel
- They provide extra mounting space on the sides of the enclosure
- Mounting hardware is furnished with each panel
- Painted steel subpanels are painted white polyester powder over phosphatized surfaces
- Galvanized subpanels have a conductive finish (no paint)
- Panels attach securely to mounting channels

Shipping Schedule				
Same day	1 - 5 days	1 - 7 days	1 - 15 days	1 - 20 days
Color indicates shipping lead time in business days.				

Painted Steel	Price	Panel Size AxB
WA72SMP14	\$236.00	60.00 x 14.00 [1524 x 356]
WA72SMP20	\$288.00	60.00 x 20.00 [1524 x 508]
Note: Dimensions in inches [millimeters].		

Dimensions

