

# 30mm Pushbutton NEMA 4, 12, and 13 Wall-Mount



## Applications

Designed to hold all standard 30mm [1.18 in] brands of pushbuttons, switches and pilot lights. Provides protection from dirt, dust, oil and water.

## Construction

- Bodies and doors fabricated from 14-gauge steel
- Closed-cell oil-resistant neoprene gasket
- Continuously-welded seams ground smooth
- External mounting feet, top and bottom of enclosure
- Captivated cover screws thread into sealed wells
- Standard "4-way" pushbutton holes accept all brands of oil-tight pushbuttons, switches and pilot lights
- Enclosures 9.50 x 6.25 x 3.09in [241 x 159 x 78mm] and larger have internal detachable hinges to hold cover open during wiring, yet permit quick removal
- Grounding provisions provided

## Finish

- ANSI 61 gray polyester powder inside and out over phosphatized surfaces

## Listings

- UL 508, 4, 12, and 13 [UL File E64791]
- NEMA/EEMAC 4, 12, and 13
- PB16(BC) and PB25(BC) meet NEMA 12 only



### 30mm Pushbutton NEMA 4, 12, and 13 Wall-Mount

Pushbutton Enclosure	Price	With Blank Cover	Price	# Holes	Enclosure Size HxWxD
<b>PB1</b>	\$76.00	<b>PB1BC</b>	\$76.00	1	3.76 x 3.56 x 3.14 [96 x 90 x 80]
<b>PB2</b>	\$87.00	<b>PB2BC</b>	\$89.00	2	6.01 x 3.56 x 3.10 [153 x 90 x 79]
<b>PB3</b>	\$97.00	<b>PB3BC</b>	\$100.00	3	8.26 x 3.56 x 3.10 [210 x 90 x 79]
<b>PB4</b>	\$110.00	<b>PB4BC</b>	\$110.00	4	10.51 x 3.56 x 3.10 [267 x 90 x 79]
<b>PB4S</b>	\$124.00	<b>PB4SBC</b>	\$107.00	4	7.51 x 6.56 x 3.38 [191 x 167 x 86]
<b>PB5</b>	\$120.00	<b>PB5BC</b>	\$120.00	5	12.76 x 3.56 x 3.10 [324 x 90 x 79]
<b>PB6</b>	\$149.00	<b>PB6BC</b>	\$141.00	6	9.76 x 6.56 x 3.38 [248 x 167 x 86]
<b>PB6VL</b>	\$134.00	<b>PB6VLBC</b>	\$133.00	6	15.01 x 3.56 x 3.10 [381 x 90 x 79]
<b>PB8</b>	\$161.00	<b>PB8BC</b>	\$157.00	8	20.51 x 3.56 x 3.10 [521 x 90 x 79]
<b>PB9</b>	\$165.00	<b>PB9BC</b>	\$146.00	9	9.76 x 8.81 x 3.38 [248 x 224 x 86]
<b>PB10</b>	\$183.00	<b>PB10BC</b>	\$170.00	10	25.01 x 3.56 x 3.14 [635 x 90 x 80]
<b>PB12</b>	\$186.00	<b>PB12BC</b>	\$186.00	12	12.01 x 8.81 x 3.38 [305 x 224 x 86]
<b>PB16</b>	\$213.00	<b>PB16BC</b>	\$209.00	16	12.01 x 11.06 x 3.38 [305 x 281 x 86]
<b>PB25</b>	\$263.00	<b>PB25BC</b>	\$263.00	25	14.26 x 13.31 x 3.38 [362 x 338 x 86]

Notes: Dimensions in inches [millimeters]. Letters in table correspond to letters on dimensional drawings. Letters in table correspond to letters on dimensional drawings.

\*Only meets N12.

# 30mm Pushbutton NEMA 4, 12, and 13 Wall-Mount



## Dimensions

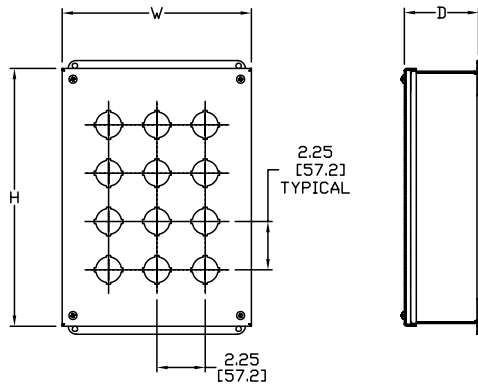

### PB HOLE ARRANGEMENTS

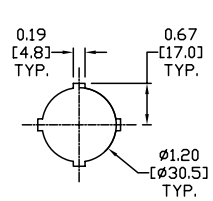
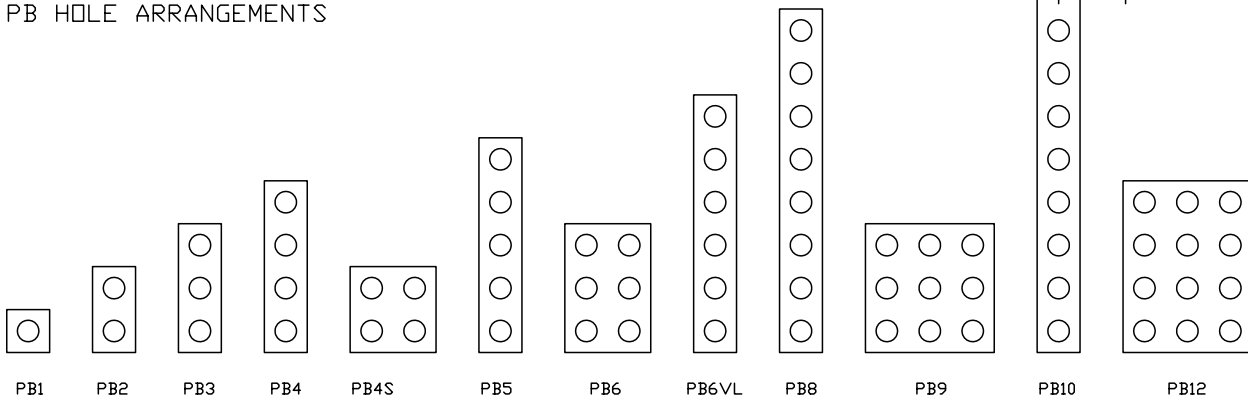

STANDARD 4-WAY  
PUSHBUTTON

