

Hazardous Area Thermostats



011850-00

Applications

Compact, small mechanical thermostat offering a high response accuracy, small switching difference, and a very long service life (switching cycles). This thermostat of temperature class T6 (185°F/85°C max.) is utilized for the regulation of heaters deployed in hazardous areas. High current performance allows direct control of a heater.

Features

- For use in hazardous areas
- High switching capacity
- Compact design
- "Pre-set" temperatures
- Ready to use with strain relief
- Temperature class T6
- DIN rail mounting



Dimensions

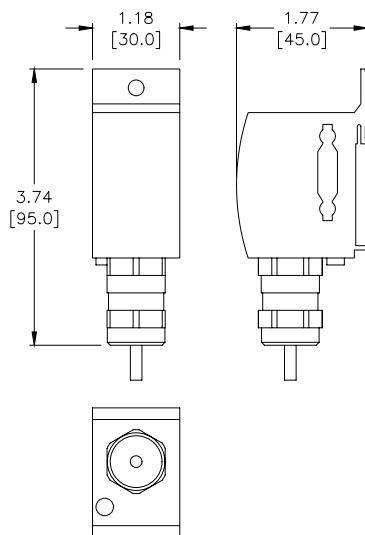

Hazardous Area Thermostat Specifications

Temperature Class	T6
Ex Protection Type Ex 11 2 GD Gases	Ex db IIC T6 Gb
Dusts	Ex tb IIIC T85 °C Db IP66
Ambient Temperature	-76 to 185°F [-60 to 85°C]
Sensor Element	Thermostatic bimetal
Service Life	> 100 000 cycles
Max. Switching Capacity	AC 250V 10A* DC 24V 1A
Min. Switching Capacity	DC 1.5V 5mA
Max. Inrush Current	AC 16A for 12 sec.
Connection	Silicone cable (halogen-free) 3 x 18 AWG (0.82 mm²), length 3ft [1m]
Housing	aluminum, silver anodized
Mounting	Clip for 35mm DIN rail, EN 60715 M5 screw mounting, optional sideways mounting
Mounting Position	Variable
Operating / Storage Humidity	max. 90 % RH (non-condensing)
Storage Temperature	-76 to 185°F [-60 to 85°C]
Weight	0.66 lb [300 g]
Protection Type / Protection Class	IP66 / I (grounded)
Approvals	EPS 16 ATEX 1 118 X IECEx EPS 16.0054X EAC, CE 0081 Ex 11 2 GD
Note: *Currents above 4 A affect the switching difference.	

Hazardous Area Thermostat

PartNumber	Price	Contact Type	Switch Temperature	Switching Difference (Hysteresis)
011850-00	\$126.00	Normally Closed	59°F ± 5°F [15°C ± 3K]	9°F ± 5°F / tolerance [5°C ± 3K]
011851-00	\$126.00	Normally Closed	77°F ± 5°F [25°C ± 3K]	9°F ± 5°F / tolerance [5°C ± 3K]