

NEMA 1 Single-Door Wall-Mount with Knockouts 1/4-Turn Latch



Applications

- Designed for general purpose indoor commercial use as a junction, pull or switch box.
- Hinged cover with latch provides easy access during installation and maintenance.

Construction

- Formed and spot welded from 16- or 14-gauge steel depending on size.
- Formed steel covers close by use of slotted 1/4-turn latch.
- Full swing door using butt hinges.
- Easily removed knockouts on all four sides. See drawings for sizes and locations.
- Through holes in back for wall-mounting.
- Grounding location embossed in body.
- Uses N1JLK 1/4 turn latch.

Finish

- Enclosure and cover are finished in ANSI 61 gray powder coating.

Listings

- UL-50 Type 1 [UL File 65324]
- CSA Type 1 [CSA File LR21001]
- Complies with
 - NEMA Type 1
 - IEC 60529, IP20



NEMA 1 Single-Door Wall-Mount with Knockouts 1/4-Turn Latch

Part Number	Price	Enclosure Size HxWxD	Drawing Link	Side Pattern	Top Pattern
CHKO644	\$14.25	6.38 x 4.30 x 4.12 [162 x 109 x 105]	PDF	Z-X	Z-X-Z
CHKO663	\$15.50	6.38 x 6.30 x 3.62 [162 x 160 x 92]	PDF	Z-X-Z	Z-X-Z
CHKO664	\$14.75	6.38 x 6.30 x 4.12 [162 x 160 x 105]	PDF	Z-X-Z	Z-X-Z
CHKO666	\$19.75	6.38 x 6.30 x 6.12 [162 x 160 x 155]	PDF	Z-X-Z	Z-X-Z
CHKO864	\$18.25	8.38 x 6.30 x 4.12 [213 x 160 x 105]	PDF	Z-X-Z-X	Z-X-Z-X
CHKO884	\$21.00	8.38 x 8.30 x 4.12 [213 x 211 x 105]	PDF	Z-X-Z-X	Z-X-Z-X
CHKO886	\$30.00	8.38 x 8.30 x 6.12 [213 x 211 x 155]	PDF	Z-X-Z-X	Z-X-Z-X
CHKO1084	\$26.00	10.38 x 8.30 x 4.12 [264 x 211 x 105]	PDF	Z-X-Z-X	Z-X-Z-X
CHKO1086	\$31.00	10.38 x 8.30 x 6.12 [264 x 211 x 155]	PDF	Z-X-Z-X	Z-X-Z-X
CHKO10104	\$28.50	10.38 x 10.30 x 4.12 [264 x 262 x 105]	PDF	X-Z-Y-Z-X	Z-X-Z-X
CHKO10106	\$35.50	10.38 x 10.30 x 6.12 [264 x 262 x 155]	PDF	X-Z-Y-Z-X	Z-X-Z-X
CHKO1284	\$30.00	12.38 x 8.30 x 4.12 [314 x 211 x 105]	PDF	Z-X-Z-X	X-Z-Y-Z-X
CHKO12104	\$36.00	12.38 x 10.30 x 4.12 [314 x 262 x 105]	PDF	X-Z-Y-Z-X	X-Z-Y-Z-X
CHKO12106	\$45.00	12.38 x 10.30 x 6.12 [314 x 262 x 155]	PDF	X-Z-Y-Z-X	X-Z-Y-Z-X
CHKO12124	\$35.00	12.38 x 12.30 x 4.11 [314 x 312 x 104]	PDF	X-Z-Y-Z-X	X-Z-Y-Z-X
CHKO12126	\$43.00	12.38 x 12.30 x 6.12 [314 x 312 x 155]	PDF	X-Z-Y-Z-X	Z-X-Z-Y-Z-X-Z
CHKO16124	\$43.50	16.38 x 12.30 x 4.11 [416 x 312 x 104]	PDF	X-Z-Y-Z-X	Z-X-Z-Y-Z-X-Z
CHKO16126	\$54.00	16.38 x 12.30 x 6.12 [416 x 312 x 155]	PDF	X-Z-Y-Z-X	X-Z-Y-Z-X
CHKO16166	\$61.00	16.38 x 16.30 x 6.12 [416 x 414 x 155]	PDF	Z-X-Z-Y-Z-X-Z	Z-X-Z-Y-Z-X-Z
CHKO18124	\$52.00	18.38 x 12.30 x 4.12 [467 x 312 x 105]	PDF	X-Z-Y-Z-X	X-Z-X-Z-Y-Z-X-Z-X
CHKO18126	\$61.00	18.38 x 12.30 x 6.12 [467 x 312 x 155]	PDF	X-Z-Y-Z-X	X-Z-X-Z-Y-Z-X-Z-X
CHKO18186	\$77.00	18.38 x 18.30 x 6.12 [467 x 465 x 155]	PDF	X-Z-X-Z-Y-Z-X-Z-X	X-Z-X-Z-Y-Z-X-Z-X
CHKO24186	\$142.00	24.38 x 18.30 x 6.12 [619 x 465 x 155]	PDF	X-Z-X-Z-Y-Z-X-Z-X	X-Z-X-Z-Y-Z-X-Z-X
CHKO24246	\$177.00	24.38 x 24.30 x 6.12 [619 x 617 x 155]	PDF	X-Z-X-Z-Y-Z-X-Z-X	X-Z-X-Z-Y-Z-X-Z-X
CHKO30246	\$212.00	30.38 x 24.30 x 6.12 [772 x 617 x 155]	PDF	X-Z-X-Z-Y-Z-X-Z-X	X-Z-X-Z-Y-Z-X-Z-X
CHKO36246	\$246.00	36.38 x 24.30 x 6.13 [924 x 617 x 156]	PDF	X-Z-X-Z-Y-Z-X-Z-X	X-Z-X-Z-Y-Z-X-Z-X
CHKO36248	\$265.00	36.38 x 24.30 x 8.13 [924 x 617 x 207]	PDF	X-Z-X-Z-Y-Z-X-Z-X	X-Z-X-Z-Y-Z-X-Z-X

Note: Dimensions in inches [millimeters].

NEMA 1 Single-Door Wall-Mount with Knockouts 1/4-Turn Latch



Dimensions

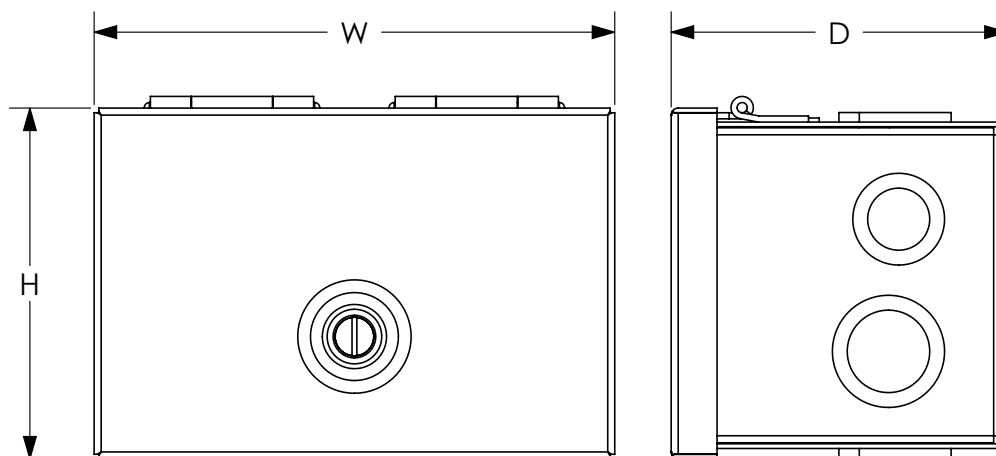

TYPICAL SIZES AND SPACING

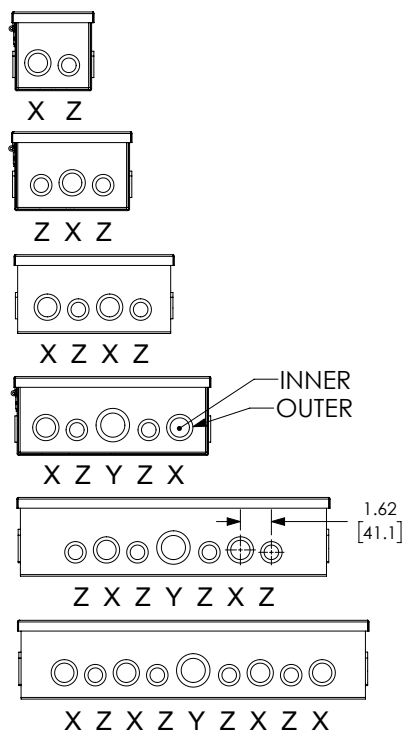

SIZE & DISTANCE INFORMATION			
ID	INNER KNOCK-OUT	OUTER KNOCK-OUT	☒ DISTANCE
X	1.00 Ø	1.38 Ø	1.62 TYPICAL
Y	1.23 Ø	1.75 Ø	
Z	0.73 Ø	1.13 Ø	

Enclosure Accessories

Locks and Latches



Padlock Kit



Features

- Field installed kit requires drilling of only 4 holes.
- Compatible with 1414 and HJ enclosures.
- Only available in 316 stainless steel.
- Includes mounting hardware.
- Sold Individually.
- Installation instructions provided.

Padlock Kit		
Part Number	Price	Drawing Link
14PLKS16	\$23.50	PDF

NEMA 1 Lock Kits



Features

- Keylocking, 1-point, 1/4-turn, flush-mount latch.
- Installs in place of the existing slotted latch, or in cutout hole provided.
- Reversible cam position for other applications.
- Maintains NEMA 1 rating.

NEMA 1 Lock Kit				
Part Number	Price	Fits Enclosures	Material	Drawing Link
1427LKN1	\$36.00	1420 and N1A	plated steel	PDF
N1JLK	\$9.50	N1J, CHKO, N1WS, N1WF, and SWB	polyamide	PDF

Padlock Adaptor

EJ Series



Features

- For use with Eclipse Junior (EJ) Series enclosures.
- Padlock adaptor fits directly over the slotted quarter turn preventing access.
- 2mm thick 14-gauge stainless steel.
- Stainless steel mounting hardware provided.
- Once installed, the bolts cannot be removed without the door open.
- Easy installed in the field.
- Padlock not included.
- Maintains UL/CSA Type 4, and 4X rating.

Padlock Adaptor Eclipse and Series 2000		
Part Number	Price	Drawing Link
EJPA	\$23.50	PDF

Padlock Adaptor

Eclipse and Series 2000



Features

- For use with EN4SD /S2000 Series Enclosures.
- Padlock adaptor fits directly over the slotted quarter turn preventing access.
- 14-gauge 304 stainless steel.
- Stainless steel mounting hardware provided.
- Once installed, the bolts cannot be removed without the door open.
- Easy installed in the field.
- Padlock not included.
- Maintains UL/CSA Type 4 and 4X rating.

Padlock Adaptor EJ Series		
Part Number	Price	Drawing Link
EPA	\$25.00	PDF