

What is Ergonomics About?

Physical discomfort such as backache and leg pains have a major impact on a person's quality of life. As a result, a person's ability to work may also suffer. These ailments can lead to a decline in productivity, a deterioration of work quality, and a rise in sick leave. The aim of ergonomics is to provide a workspace or environment that is tailored to a person's natural posture and position to reduce strain and injury. Ergoswiss lift systems accomplish this by adapting the height at which people work to their different body heights and activities as well as optimizing working conditions, work processes, and equipment. Perfectly equipped workstations reduce the worker's strain, movement and related injuries, while increasing productivity and efficiency. Ergonomic workstations promote employee motivation, thereby increasing productivity. Taking these factors into consideration, you can see how the Ergoswiss system can pay for itself in just a few months.

Why Height Adjustable?

Obviously, people in every workplace are not the same height. In some companies, different people may move from station to station in order to do their work or there might be multiple people using the same workstation but on different shifts. In either case, a workstation with a static height is only ergonomic for one type of person. If someone of another build were to use that workstation, they could strain or injure themselves over time due to having to adjust to the workstation. By having a height adjustable workstation, the employee can instead adjust the workstation to themselves, greatly decreasing the likelihood of strain or injury as a result of a poor working posture.

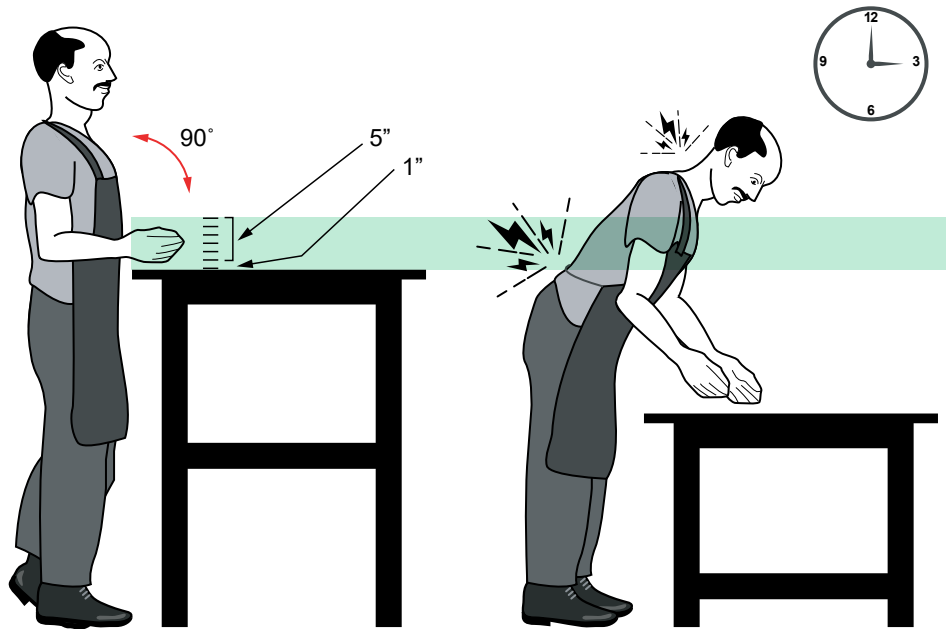

Application

The electrically driven lifting column is suitable for height adjustable tables, laboratory workstations and furniture. Up to 4 lifting columns can be connected to one control box and are operated synchronously. In synchronous operation with 2 control boxes, up to 8 lifting columns can be operated. Each lifting column has an internal motor that drives the threaded spindle. The T-slots on 2 sides (Slot Size 8 or 8 mm wide) allow the mounting of crossbars, shelves and other attachments along the entire length of the leg.

Features

- Stroke Length: 300mm [11.8"] or 400mm [15.7"]
- Leveling feet included
- Synchronous control of 1 to 8 Spindle Lifting Columns (See User Manual for complete details)
- Up/Down positioning with up to 3 memory positions
- Compatible with SureFrame™ rails and FATH® hardware/accessories
- Up to 1320lb weight capacity (using 4 Spindle Lifting Columns)
- Can be combined with multiple kits and linked for larger workspaces
- Spindle Lifting Legs Housing Material: Extruded Aluminum with clear anodize finish
- Spindle Lifting Legs have 2 extruded T-slot features, slot size 8**
- For use indoors in dry, non-explosive environments.
 - Ambient temperature is between +10°C [50°F] and +40°C [104°F].
 - Relative humidity range is between 30 % and 70 % (not condensed)
- The maximum continuous operating time is 2 minutes.***
- Versatile linear guide rail with internal drive unit
- Compressive force per lifting element 1500 N
- Tensile force per lifting element 1500 N
- Lifting speed: 9 mm/s [0.35in/s]
- Noise Level: <60 dBA
- Mb stat. = 200 Nm
- Mb dyn. = 80 Nm
- Product Life: 5000 cycles
- Integrated Tilt Sensing: > 2.5° inclination change STOPS lifting movement
- Required Input Power: 110 VAC, 60Hz, single phase

** Slots are shallower than most SureFrame profile slots. Please verify dimensions carefully before committing to design details.

***When this does occur the system will become inoperable for 18 minutes to allow cooldown of the motor drive components

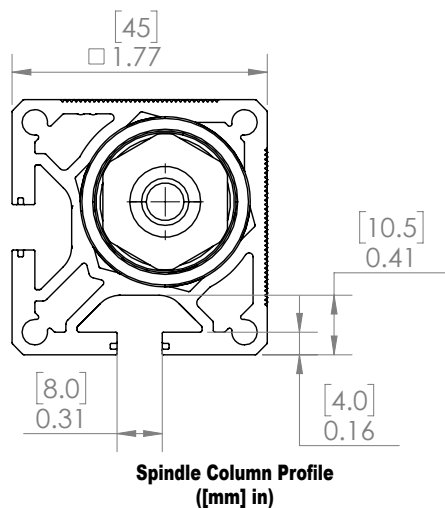
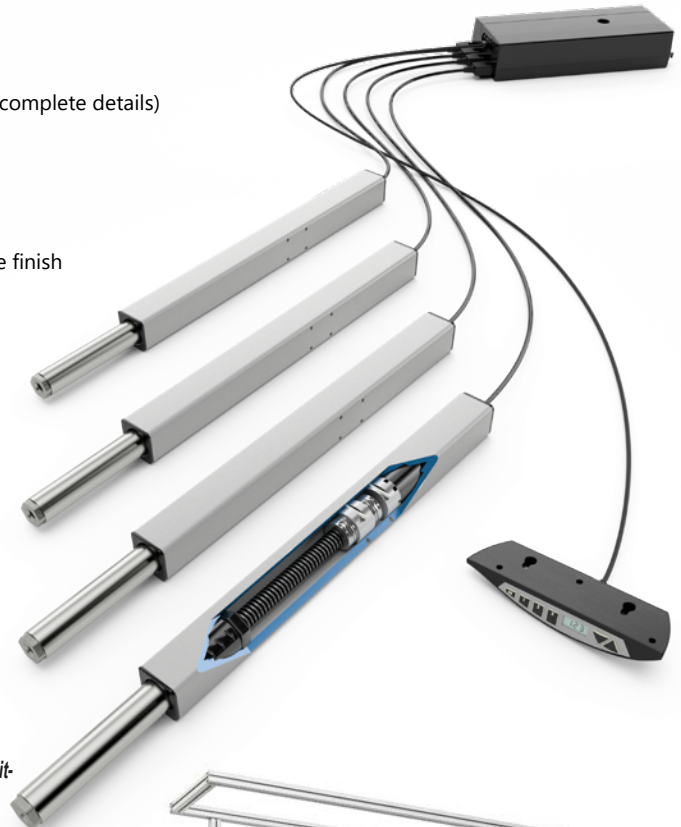

Custom Workstations

Ergoswiss lift systems work hand-in-hand with SureFrame T-slot rails and FATH accessories. You can combine the two products to build custom workstations to fit your specific needs.*

Recommended Parts

- 15 Series - [PDF](#)
- 40 Series - [PDF](#)

To the right is an example of a desk frame built with Ergoswiss, SureFrame, and FATH parts.

Included in the Ergoswiss Kit

SureFrame™ and FATH®
 Components
 (Sold Separately)

Sureframe™ **FATH**®

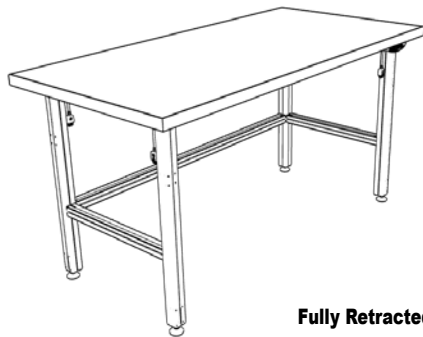
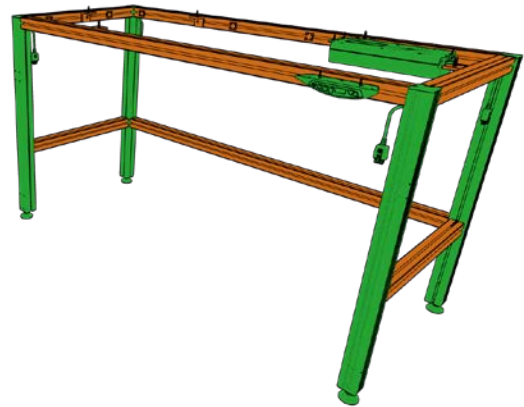

Fully Retracted

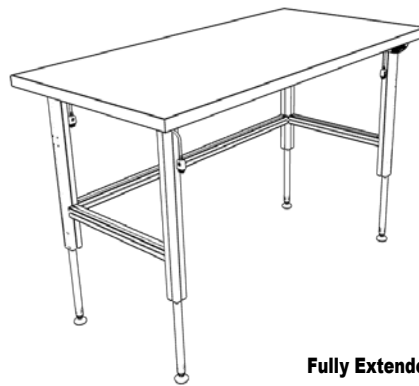

Fully Extended

Build an Ergonomic Table with SureFrame, FATH, and ErgoSwiss

1. Determine table top dimensions (Not sold by ADC)
 - e.g. 60" x 30" x 1"
2. Determine desired table top overhang
 - e.g. 1.5"
3. Calculate SureFrame cross member lengths
 - e.g. $CM_{Long} = TT_{Length} - 2 (\text{Overhang}) - 2 (45\text{mm, ErgoSwiss leg width}) = 60" - 2 (1.5") - 2 (45\text{mm}) = 53.46"$
 - e.g. $CM_{Short} = TT_{Width} - 2 (\text{Overhang}) - 2 (45\text{mm, ErgoSwiss leg width}) = 30" - 2 (1.5") - 2 (45\text{mm}) = 23.46"$
4. Choose desired FATH accessories for attaching the table top, cable management, shelving, etc.

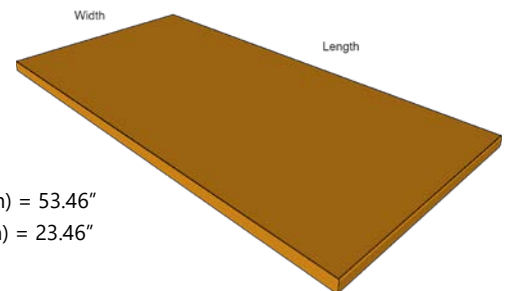

Recommended part for attaching SureFrame to Spindle Column:



Duo Connector (10 pack)
151102 \$23.50

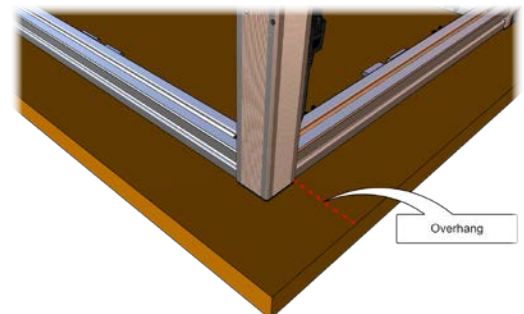
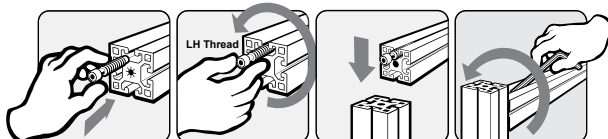

*PLEASE NOTE: Some FATH accessories are not directly compatible with Ergoswiss channels. Please check dimensional drawings to ensure proper fit. For example, FATH roll-in nuts do NOT fit the T-slot on the Spindle Column. Hammer nuts and Economy nuts, however, do fit.

Ergoswiss 300mm [11.8 in] Lift System

Ergoswiss 300mm [11.8 in] Lift Kit							
Part Number	Price	Stroke Length	Capacity	Includes			Image
				Qty	Description	Part Number	
<u>907.42236-PP000001</u>	\$1,955.00	300mm [11.8 in]	1320 lbs/600 kg	4	Spindle lifting columns	<u>907.02003-PP000001</u>	
				1	Control box	<u>124.43801-PP000001</u>	
				4	Leveling feet	<u>113.00006-PP000004</u>	
				1	SCT memory module	<u>124.00281-PP000001</u>	
				1	Power cable	<u>124.00145-PP000001</u>	

Hardware Included: (5) M3.5 x 20mm and (6) M5.5 x 25mm Phillips Round Head Screws

Features

- Protection class (DIN EN 60529): IP20
- Lifting speed: 9 mm/s (0.35 in/s)
- Voltage: 24V
- Electrical connection: Molex MiniFit plug 8-Pin, Cable length 2m (6.5')
 - Can be extended up to 6m (20').

Dimensions shown as: [mm] in

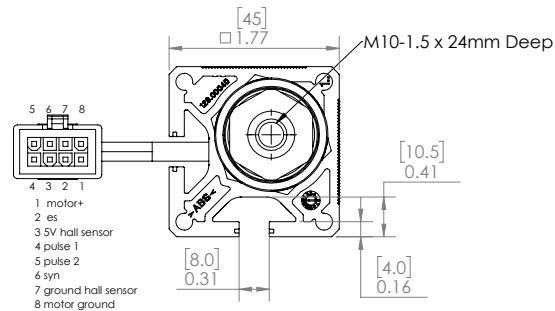

Spindle Lifting Column					
Part Number	Price	Stroke Length	Capacity	Image	Drawing Link
<u>907.02003-PP000001</u>	\$575.00	300mm [11.8 in]	330 lbs/150 kg		<u>PDF</u>

Control Box					
Part Number	Price	Description	For use with	Image	Drawing Link
<u>124.43801-PP000001</u>	\$450.00	Ergoswiss SQ series control box, 110 VAC nominal input, 24 VAC, IP20.	ONLY works with up to (4) 300mm Spindle Lifting Columns (PN: <u>907.02003-PP000001</u>)		<u>PDF</u>

Hardware Included: (3) M3.5 x 20mm Phillips Round Head Screws

Ergoswiss 400mm [15.7 in] Lift System

Ergoswiss 400mm [15.7 in] Lift Kit							
Part Number	Price	Stroke Length	Capacity	Includes			Image
				Qty	Description	Part Number	
907.42237-PP000001	\$1,995.00	400mm [15.7 in]	1320 lbs/600 kg	4	Spindle lifting columns	907.02004-PP000001	
				1	Control box	124.43800-PP000001	
				4	Leveling feet	113.00006-PP000004	
				1	SCT memory module	124.00281-PP000001	
				1	Power cable	124.00145-PP000001	

Hardware Included: (5) M3.5 x 20mm and (6) M5.5 x 25mm Phillips Round Head Screws

Features

- Protection class (DIN EN 60529): IP20
- Lifting speed: 9 mm/s (0.35 in/s)
- Voltage: 24V
- Electrical connection: Molex MiniFit plug 8-Pin, Cable length 2m (6.5')
 - Can be extended up to 6m (20').

Dimensions shown as: [mm] in

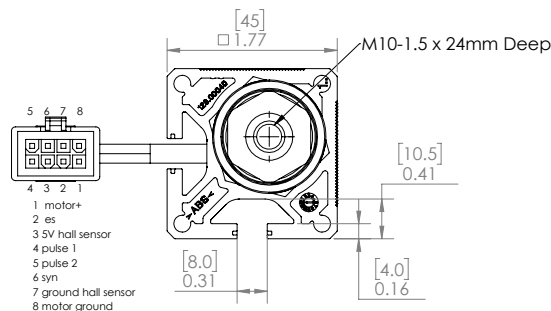

Spindle Lifting Column					
Part Number	Price	Stroke Length	Capacity	Image	Drawing Link
907.02004-PP000001	\$600.00	400mm [15.7 in]	330 lbs/150 kg		PDF

Control Box					
Part Number	Price	Description	For use with	Image	Drawing Link
124.43800-PP000001	\$450.00	Ergoswiss SQ series control box, 110 VAC nominal input, 24 VAC, IP20.	ONLY works with up to (4) 400mm Spindle Lifting Columns (PN: 907.02004-PP000001)		PDF

Hardware Included: (3) M3.5 x 20mm Phillips Round Head Screws

Ergoswiss Lift System

Universal Accessories



Features

- Electrical connection: RJ12 plug 6-Pin
- Cable length 2m (6.5')
- Protection class (DIN EN 60529): IP 30
- The cable can be extended up to 3m [9.8ft]

SCT Memory Module				
Part Number	Price	Description	Image	Drawing Link
<u>124.00281-PP000001</u>	\$90.00	Ergoswiss SQ series SCT memory module, manual switch, IP30. (1) 6.5ft/2m power cable included. Saves (3) intermediate positions in addition to up and down function.		<u>PDF</u>

Hardware Included: (2) M3.5 x 20mm Phillips Round Head Screws

Leveling Foot				
Part Number	Price	Description	Image	Drawing Link
<u>113.00006-PP000004</u>	\$40.00	Ergoswiss SQ series leveling foot, package of 4. (M10-1.5 x 25mm)		<u>PDF</u>

SQ Series Cables					
Part Number	Price	Cable Type	Cable Length	Image	Package Qty
<u>124.00137-PP000002</u>	\$55.00	Motor Extension Cable	3.9ft/1.2m		2
<u>124.00145-PP000001</u>	\$20.00	Power Cable	9.8ft/3m		1
<u>124.00183-PP000001</u>	\$45.00	Sync Cable	13.1ft/4m		1