

# What is a Cable Gland?

A cable gland, commonly known as a cable connector or fitting, is a device designed to attach and secure the end of a cable to electrical equipment. Cable glands provide strain relief and typically seal out dust, dirt and even liquids.

Cable glands are generally used throughout a number of industries in conjunction with cable and wiring used in electrical instrumentation and automation systems. They may be used on all types of electrical power, control, instrumentation, data and telecommunications cables. A key function of cable glands is to seal and terminate electrical equipment to ensure that the characteristics of the enclosure which the cable enters can be maintained.

## Typical Cable Gland Construction Materials:

- Plastic
- Brass
- Aluminium
- Stainless steel

Although cable glands are often called "connectors," a technical distinction can be made in the terminology, which differentiates them from quick-disconnect, conducting electrical connectors. The distinction is often not made.

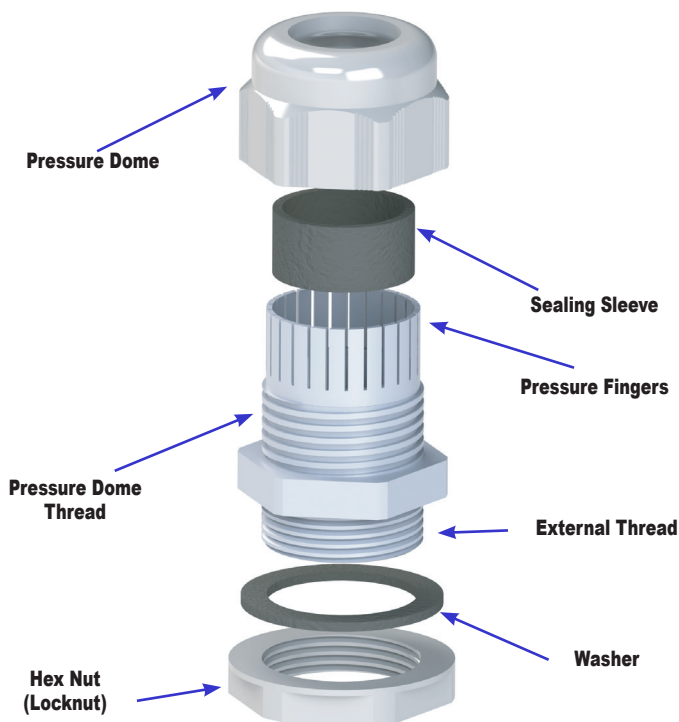

## Assembling with hex nut on non threaded enclosure

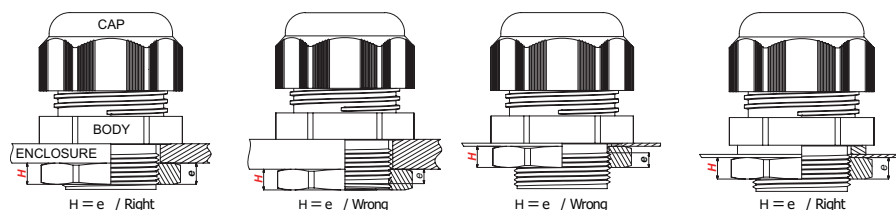

## Assembling with hex nut on threaded enclosure

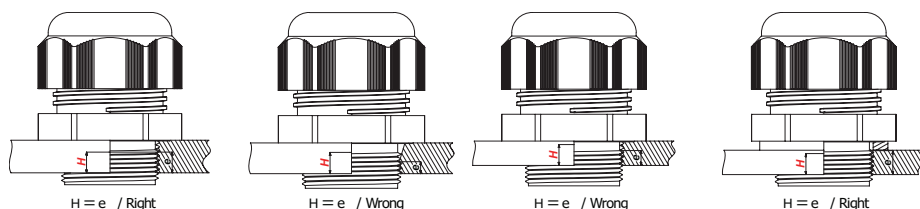

- The engaged thread length "e" must be equal or longer than relevant hex nut thickness "H"
- The thread dimensions and tolerances on threaded enclosures must coincide with the relevant thread standard.
- The gland body must be mounted to the enclosure.
- The body or the hex nut must be tightened according to the recommended torque.
- It is recommended that a double wrench be used for non-threaded enclosures.
- For cable assembly, the cap must be tightened according to the recommended torque.
- During cable assembly or disassembly, the gland body must be kept fixed. Utilize a double wrench for this purpose.

## NPT Thread Application

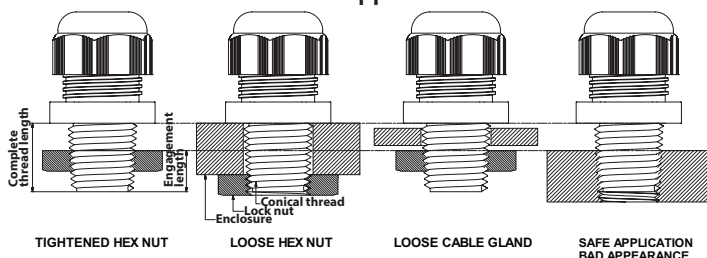

HEX NUT H

## Relevant Hex Nut Thickness (mm)

| Brass          | ±0.5 | Plastic        |
|----------------|------|----------------|
| M12            | 2.8  | —              |
| PG7 to PG9     | 2.8  | —              |
| M16            | 3    | —              |
| PG11 to PG16   | 3    | —              |
| M20            | 3.5  | —              |
| PG21           | 3.5  | —              |
| M25            | 4    | —              |
| PG29           | 4    | —              |
| M32 to M50     | 5    | M12 to M16     |
| PG36 to PG42   | 5    | PG7 to PG11    |
| NPT 3/8 to 1/2 | 5    | —              |
| PG48           | 5.5  | —              |
| M63            | 6    | M29 to M40     |
| NPT 3/4 to 1   | 6    | PG13.5 to PG16 |
| —              | 7    | M32 to M40     |
| —              | 7    | NPT 3/8 to 1"  |
| —              | 7    | PG21 to PG29   |
| —              | 8    | M50 to M63     |
| —              | 8    | PG36 to PG48   |

# bimed Standard Series Plastic Euro Metric Thread Cable Glands

## Material

- Body: PA 6 (Polyamide 6)
- Cap: PA 6 (Polyamide 6)
- Seal: CR (Chloroprene Rubber)

## Flammability

- V2 (According to UL 94)

## Protection Class

- IP68 - 5 Bar [72.5 psi]

## Operating Temperature

- Permanent: -20 to +100°C [-4 to +212°F]
- Intermittent: -30 to +150°C [-22 to +302°F]

## Attachment Thread

- EN 60423

## Body

- Manufactured according to the requirements of EN 50262

## Approvals

- UL Recognized or Listed File # E199260 \*
- CSA File # 190896
- CE



\*Note: To obtain the most current agency approval information, see the Agency Compliance & Certifications Checklist section on the specific part number's web page.



## Plastic Euro Metric Thread Cable Glands

| Light Gray                  | Price   | Black                       | Price   | Qty | Thread Size  | Clamping Range<br>mm [in]    | Recommended Tightening Torque |                 | Dimensions<br>mm [in] |                |                |                |                |
|-----------------------------|---------|-----------------------------|---------|-----|--------------|------------------------------|-------------------------------|-----------------|-----------------------|----------------|----------------|----------------|----------------|
|                             |         |                             |         |     |              |                              | N-m [lb-ft]                   | Tolerance       | SW                    | TL             | H              | D              | TD             |
| <a href="#">BM-ENX-1S-W</a> | \$2.75  | <a href="#">BM-ENX-2S-W</a> | \$2.75  | 5   | M12 x 1.5 mm | 3.0 - 6.5<br>[0.12 - 0.26]   | 2.0<br>[1.48]                 | ±0.5<br>[±0.37] | 15.0<br>[0.59]        | 8.0<br>[0.31]  | 22.0<br>[0.87] | 17.1<br>[0.67] | 12.0<br>[0.47] |
| <a href="#">BM-ENX-11-W</a> | \$2.75  | <a href="#">BM-ENX-21-W</a> | \$2.75  | 5   | M16 x 1.5 mm | 4.0 - 8.0<br>[0.16 - 0.31]   | 2.5<br>[1.84]                 | ±0.5<br>[±0.37] | 19.0<br>[0.75]        | 8.0<br>[0.31]  | 25.0<br>[0.98] | 21.6<br>[0.85] | 16.0<br>[0.63] |
| <a href="#">BM-ENX-12-W</a> | \$3.75  | <a href="#">BM-ENX-22-W</a> | \$3.75  | 5   | M20 x 1.5 mm | 6.0 - 12.0<br>[0.24 - 0.47]  | 5.0<br>[3.69]                 | ±0.5<br>[±0.37] | 24.0<br>[0.94]        | 10.0<br>[0.39] | 29.0<br>[1.14] | 27.7<br>[1.09] | 20.0<br>[0.79] |
| <a href="#">BM-ENX-13-W</a> | \$5.00  | <a href="#">BM-ENX-23-W</a> | \$5.00  | 5   | M25 x 1.5 mm | 11.0 - 17.0<br>[0.43 - 0.67] | 5.0<br>[3.69]                 | ±1.0<br>[±0.74] | 29.0<br>[1.14]        | 8.0<br>[0.31]  | 34.0<br>[1.34] | 32.5<br>[1.28] | 25.0<br>[0.98] |
| <a href="#">BM-ENX-14-W</a> | \$11.00 | <a href="#">BM-ENX-24-W</a> | \$11.00 | 5   | M32 x 1.5 mm | 15.0 - 21.0<br>[0.59 - 0.86] | 6.0<br>[4.43]                 | ±1.0<br>[±0.74] | 36.0<br>[1.42]        | 10.0<br>[0.39] | 41.0<br>[1.61] | 41.0<br>[1.61] | 32.0<br>[1.26] |
| <a href="#">BM-ENX-15-W</a> | \$7.75  | <a href="#">BM-ENX-25-W</a> | \$7.75  | 2   | M40 x 1.5 mm | 19.0 - 28.0<br>[0.74 - 1.10] | 5.0<br>[3.69]                 | ±1.0<br>[±0.74] | 46.0<br>[1.81]        | 10.0<br>[0.39] | 45.5<br>[1.79] | 52.4<br>[2.06] | 40.0<br>[1.57] |
| <a href="#">BM-ENX-16-W</a> | \$15.50 | <a href="#">BM-ENX-26-W</a> | \$15.50 | 2   | M50 x 1.5 mm | 30.0 - 38.0<br>[1.18 - 1.50] | 22<br>[16.23]                 | ±2.0<br>[±1.48] | 60.0<br>[2.36]        | 18.0<br>[0.71] | 49.0<br>[1.93] | 67.7<br>[2.67] | 50.0<br>[1.97] |
| <a href="#">BM-ENX-17-W</a> | \$16.00 | <a href="#">BM-ENX-27-W</a> | \$16.00 | 2   | M63 x 1.5 mm | 34.0 - 44.0<br>[1.34 - 1.73] | 23<br>[16.96]                 | ±2.5<br>[±1.84] | 65.0<br>[2.56]        | 18.0<br>[0.71] | 49.0<br>[1.93] | 72.2<br>[2.84] | 63.0<br>[2.48] |

Note: Hex nut and washer included.

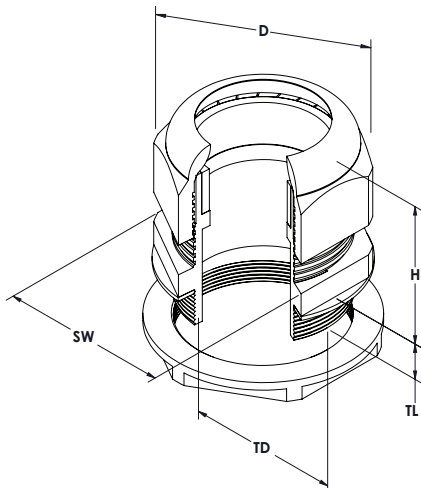

See our website: [www.AutomationDirect.com](http://www.AutomationDirect.com)  
for complete engineering drawings

## UL Part # Cross Reference

| UL Part Number | ADC Part Number             |
|----------------|-----------------------------|
| BM-EN-1S       | <a href="#">BM-ENX-1S-W</a> |
| BM-EN-11       | <a href="#">BM-ENX-11-W</a> |
| BM-EN-12       | <a href="#">BM-ENX-12-W</a> |
| BM-EN-13       | <a href="#">BM-ENX-13-W</a> |
| BM-EN-14       | <a href="#">BM-ENX-14-W</a> |
| BM-EN-15       | <a href="#">BM-ENX-15-W</a> |
| BM-EN-16       | <a href="#">BM-ENX-16-W</a> |
| BM-EN-17       | <a href="#">BM-ENX-17-W</a> |
| BM-EN-2S       | <a href="#">BM-ENX-2S-W</a> |
| BM-EN-21       | <a href="#">BM-ENX-21-W</a> |
| BM-EN-22       | <a href="#">BM-ENX-22-W</a> |
| BM-EN-23       | <a href="#">BM-ENX-23-W</a> |
| BM-EN-24       | <a href="#">BM-ENX-24-W</a> |
| BM-EN-25       | <a href="#">BM-ENX-25-W</a> |
| BM-EN-26       | <a href="#">BM-ENX-26-W</a> |
| BM-EN-27       | <a href="#">BM-ENX-27-W</a> |

# bimed Standard Series Plastic PG Thread Cable Glands

## Material

- Body: PA 6 (Polyamide 6)
- Cap: PA 6 (Polyamide 6)
- Seal: CR (Chloroprene Rubber)

## Flammability

- V2 (According to UL 94)

## Protection Class

- IP68 - 5 Bar [72.5 psi]

## Operating Temperature

- Permanent: -20 to +100°C [-4 to +212°F]
- Intermittent: -30 to +150°C [-22 to +302°F]

## Attachment Thread

- DIN 40430

## Body

- Manufactured according to the requirements of EN 50262

## Approvals

- UL Recognized or Listed File # E199260 \*
- CSA File # 190896
- CE



**\*Note: To obtain the most current agency approval information, see the Agency Compliance & Certifications Checklist section on the specific part number's web page.**

## Plastic PG Thread Cable Glands

| Light Gray               | Price   | Black                    | Price   | Qty | Thread Size | Clamping Range mm [in]       | Recommended Tightening Torque |                 | Dimensions – mm [in] |                |                |                |                |
|--------------------------|---------|--------------------------|---------|-----|-------------|------------------------------|-------------------------------|-----------------|----------------------|----------------|----------------|----------------|----------------|
|                          |         |                          |         |     |             |                              | N-m [lb-ft]                   | Tolerance       | SW                   | TL             | H              | D              | TD             |
| <a href="#">BMX-11-W</a> | \$2.75  | <a href="#">BMX-21-W</a> | \$2.75  | 5   | PG7         | 3.0 - 6.5<br>[0.12 - 0.26]   | 2.0<br>[1.48]                 | ±0.5<br>[±0.37] | 15.0<br>[0.59]       | 8.0<br>[0.31]  | 23.0<br>[0.91] | 17.2<br>[0.68] | 12.4<br>[0.49] |
| <a href="#">BMX-12-W</a> | \$2.75  | <a href="#">BMX-22-W</a> | \$2.75  | 5   | PG9         | 4.0 - 8.0<br>[0.16 - 0.31]   | 2.5<br>[1.84]                 | ±0.5<br>[±0.37] | 19.0<br>[0.75]       | 8.0<br>[0.31]  | 26.5<br>[1.04] | 21.9<br>[0.86] | 15.1<br>[0.59] |
| <a href="#">BMX-13-W</a> | \$2.75  | <a href="#">BMX-23-W</a> | \$2.75  | 5   | PG11        | 5.0 - 10.0<br>[0.20 - 0.39]  | 2.5<br>[1.84]                 | ±0.5<br>[±0.37] | 22.0<br>[0.87]       | 8.0<br>[0.31]  | 22.0<br>[0.87] | 25.2<br>[0.99] | 18.5<br>[0.73] |
| <a href="#">BMX-14-W</a> | \$3.75  | <a href="#">BMX-24-W</a> | \$3.75  | 5   | PG13.5      | 6.0 - 12.0<br>[0.24 - 0.47]  | 5.0<br>[3.69]                 | ±0.5<br>[±0.37] | 24.0<br>[0.94]       | 10.0<br>[0.39] | 29.5<br>[1.16] | 27.7<br>[1.09] | 20.3<br>[0.80] |
| <a href="#">BMX-15-W</a> | \$4.50  | <a href="#">BMX-25-W</a> | \$4.50  | 5   | PG16        | 10.0 - 14.0<br>[0.39 - 0.55] | 5.5<br>[4.06]                 | ±0.5<br>[±0.37] | 27.0<br>[1.06]       | 10.0<br>[0.39] | 32.5<br>[1.28] | 31.0<br>[1.22] | 22.5<br>[0.89] |
| <a href="#">BMX-16-W</a> | \$5.50  | <a href="#">BMX-26-W</a> | \$5.00  | 5   | PG21        | 13.0 - 18.0<br>[0.51 - 0.71] | 5.5<br>[4.06]                 | ±0.5<br>[±0.37] | 33.0<br>[1.30]       | 11.0<br>[0.43] | 35.0<br>[1.38] | 37.2<br>[1.46] | 28.1<br>[1.11] |
| <a href="#">BMX-17-W</a> | \$11.50 | <a href="#">BMX-27-W</a> | \$11.50 | 5   | PG29        | 18.0 - 25.0<br>[0.71 - 0.98] | 7.5<br>[5.53]                 | ±0.5<br>[±0.37] | 42.0<br>[1.65]       | 11.0<br>[0.43] | 42.0<br>[1.65] | 47.2<br>[1.86] | 37.0<br>[1.46] |
| <a href="#">BMX-18-W</a> | \$22.50 | <a href="#">BMX-28-W</a> | \$22.50 | 2   | PG36        | 22.0 - 32.0<br>[0.87 - 1.26] | 15.0<br>[11.06]               | ±0.5<br>[±0.37] | 53.0<br>[2.09]       | 13.0<br>[0.51] | 52.0<br>[2.05] | 60.0<br>[2.36] | 46.8<br>[1.84] |
| <a href="#">BMX-19-W</a> | \$15.50 | <a href="#">BMX-29-W</a> | \$15.50 | 2   | PG42        | 30.0 - 38.0<br>[1.18 - 1.50] | 18.0<br>[13.28]               | ±1.0<br>[±0.74] | 60.0<br>[2.36]       | 13.0<br>[0.51] | 54.5<br>[2.15] | 67.7<br>[2.67] | 54.0<br>[2.13] |
| <a href="#">BMX-20-W</a> | \$16.00 | <a href="#">BMX-30-W</a> | \$16.00 | 2   | PG48        | 34.0 - 44.0<br>[1.34 - 1.73] | 20.0<br>[14.75]               | ±1.0<br>[±0.74] | 65.0<br>[2.56]       | 14.0<br>[0.55] | 54.5<br>[2.15] | 72.2<br>[2.84] | 59.0<br>[2.32] |

Note: Hex nut and washer included.

## UL Part # Cross Reference

| UL Part Number | ADC Part Number          | UL Part Number | ADC Part Number          |
|----------------|--------------------------|----------------|--------------------------|
| BS-11          | <a href="#">BMX-11-W</a> | BS-21          | <a href="#">BMX-21-W</a> |
| BS-12          | <a href="#">BMX-12-W</a> | BS-22          | <a href="#">BMX-22-W</a> |
| BS-13          | <a href="#">BMX-13-W</a> | BS-23          | <a href="#">BMX-23-W</a> |
| BS-14          | <a href="#">BMX-14-W</a> | BS-24          | <a href="#">BMX-24-W</a> |
| BS-15          | <a href="#">BMX-15-W</a> | BS-25          | <a href="#">BMX-25-W</a> |
| BS-16          | <a href="#">BMX-16-W</a> | BS-26          | <a href="#">BMX-26-W</a> |
| BS-17          | <a href="#">BMX-17-W</a> | BS-27          | <a href="#">BMX-27-W</a> |
| BS-18          | <a href="#">BMX-18-W</a> | BS-28          | <a href="#">BMX-28-W</a> |
| BS-19          | <a href="#">BMX-19-W</a> | BS-29          | <a href="#">BMX-29-W</a> |
| BS-20          | <a href="#">BMX-20-W</a> | BS-30          | <a href="#">BMX-30-W</a> |

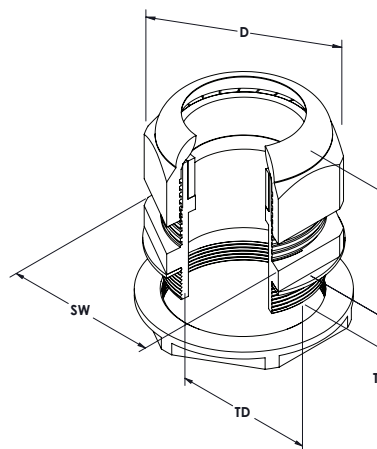

See our website: [www.AutomationDirect.com](http://www.AutomationDirect.com) for complete Engineering drawings

# bimed Standard Series Plastic NPT Thread Cable Glands

## Material

- Body: PA 6 (Polyamide 6)
- Cap: PA 6 ( Polyamide 6)
- Seal: CR (Chloroprene Rubber)

## Flammability

- V2 (According to UL 94)

## Protection Class

- IP68 - 5 Bar [72.5 psi]

## Operating Temperature

- Permanent: -20 to +100°C [-4 to +212°F]
- Intermittent: -30 to +150°C [-22 to +302°F]

## Attachment Thread

- ANSI B 1.20.1

## Body

- Manufactured according to the requirements of EN 50262

## Approvals

- UL Recognized or Listed File # E199260 \*
- CSA File # 190896
- CE



\*Note: To obtain the most current agency approval information, see the Agency Compliance & Certifications Checklist section on the specific part number's web page.



## Plastic NPT Thread Cable Glands

| Light Gray                        | Price   | Black                             | Price   | Qty | Thread Size | Clamping Range mm [in]       | Recommended Tightening Torque |                 | Dimensions mm [in] |                |                |                |                |
|-----------------------------------|---------|-----------------------------------|---------|-----|-------------|------------------------------|-------------------------------|-----------------|--------------------|----------------|----------------|----------------|----------------|
|                                   |         |                                   |         |     |             |                              | N-m [lb-ft]                   | Tolerance       | SW                 | TL             | H              | D              | TD             |
| <a href="#"><u>BSPAX-11-W</u></a> | \$5.00  | <a href="#"><u>BSPAX-21-W</u></a> | \$5.00  | 5   | NPT 3/8"    | 5.0 - 10.0<br>[0.20 - 0.39]  | 2.5<br>[1.84]                 | ±0.5<br>[±0.37] | 22.0<br>[0.87]     | 15.0<br>[0.59] | 29.0<br>[1.14] | 25.1<br>[0.99] | 17.1<br>[0.67] |
| <a href="#"><u>BSPBX-12-W</u></a> | \$6.25  | <a href="#"><u>BSPBX-22-W</u></a> | \$6.25  | 5   | NPT 1/2"    | 6.0 - 12.0<br>[0.24 - 0.47]  | 4.0<br>[2.95]                 | ±0.5<br>[±0.37] | 23.9<br>[0.94]     | 15.0<br>[0.59] | 30.5<br>[1.20] | 27.7<br>[1.09] | 21.3<br>[0.84] |
| <a href="#"><u>BSPCX-12-W</u></a> | \$8.50  | <a href="#"><u>BSPCX-22-W</u></a> | \$8.50  | 5   | NPT 1/2"    | 10.0 - 14.0<br>[0.39 - 0.55] | 5.0<br>[3.69]                 | ±0.5<br>[±0.37] | 27.0<br>[1.06]     | 15.0<br>[0.59] | 32.1<br>[1.26] | 31.0<br>[1.22] | 21.3<br>[0.84] |
| <a href="#"><u>BSPDX-13-W</u></a> | \$10.00 | <a href="#"><u>BSPDX-23-W</u></a> | \$10.00 | 5   | NPT 3/4"    | 13.0 - 18.0<br>[0.51 - 0.71] | 5.5<br>[4.06]                 | ±0.5<br>[±0.37] | 33.0<br>[1.30]     | 15.0<br>[0.59] | 35.4<br>[1.39] | 37.2<br>[1.46] | 26.7<br>[1.05] |
| <a href="#"><u>BSPX-14-W</u></a>  | \$20.00 | <a href="#"><u>BSPX-24-W</u></a>  | \$20.00 | 5   | NPT 1"      | 18.0 - 25.0<br>[0.71 - 0.98] | 7.5<br>[5.53]                 | ±0.5<br>[±0.37] | 41.9<br>[1.65]     | 18.0<br>[0.71] | 40.5<br>[1.59] | 47.5<br>[1.87] | 33.4<br>[1.31] |

Note: Hex nut and washer included.

## UL Part # Cross Reference

| UL Part Number | ADC Part Number                   |
|----------------|-----------------------------------|
| BSPA-11        | <a href="#"><u>BSPAX-11-W</u></a> |
| BSPB-12        | <a href="#"><u>BSPBX-12-W</u></a> |
| BSPC-12        | <a href="#"><u>BSPCX-12-W</u></a> |
| BSPD-13        | <a href="#"><u>BSPDX-13-W</u></a> |
| BSP-14         | <a href="#"><u>BSPX-14-W</u></a>  |
| BSPA-21        | <a href="#"><u>BSPAX-21-W</u></a> |
| BSPB-22        | <a href="#"><u>BSPBX-22-W</u></a> |
| BSPC-22        | <a href="#"><u>BSPCX-22-W</u></a> |
| BSPD-23        | <a href="#"><u>BSPDX-23-W</u></a> |
| BSP-24         | <a href="#"><u>BSPX-24-W</u></a>  |

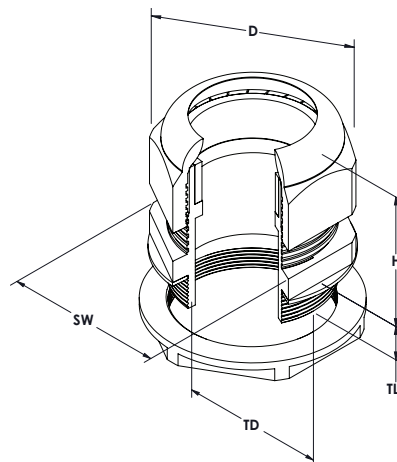

See our website: [www.AutomationDirect.com](http://www.AutomationDirect.com) for complete Engineering drawings

# bimed Protection Series Plastic Metric Thread Cable Glands

## Material

- Body: PA 6 (Polyamide 6)
- Cap: PA 6 (Polyamide 6)
- Seal: CR (Chloroprene Rubber)
- Locknut: PA 6 (Polyamide 6), 30% glass fiber reinforced

## Flammability

- V2 (According to UL 94)

## Protection Class

- IP68 - 5 Bar [72.5 psi]

## Operating Temperature

- Permanent: -20 to +100°C [-4 to +212°F]
- Intermittent: -30 to +150°C [-22 to +302°F]

## Attachment Thread

- EN 60423

## Body

- Manufactured according to the requirements of EN 50262

## Approvals

- UL Recognized or Listed File # E199260 \*
- CSA File # 190896
- CE



**\*Note: To obtain the most current agency approval information, see the Agency Compliance & Certifications Checklist section on the specific part number's web page.**



## Cable Protection Series Plastic Metric Thread Strain Relief Cable Glands

| Light Gray               | Price   | Black                    | Price   | Qty | Thread Size  | Clamping Range mm [in]       | Recommended Tightening Torque |                 | Dimensions mm [in] |                |                 |                |                |
|--------------------------|---------|--------------------------|---------|-----|--------------|------------------------------|-------------------------------|-----------------|--------------------|----------------|-----------------|----------------|----------------|
|                          |         |                          |         |     |              |                              | N-m [lb-ft]                   | Tolerance       | SW                 | TL             | H               | D              | TD             |
| <b><u>BMSPX-1S-W</u></b> | \$5.00  | <b><u>BMSPX-2S-W</u></b> | \$5.00  | 5   | M12 x 1.5 mm | 3.0 - 6.5<br>[0.12 - 0.26]   | 2.0<br>[1.48]                 | ±0.5<br>[±0.37] | 15.0<br>[0.59]     | 8.0<br>[0.31]  | 56.0<br>[2.20]  | 17.1<br>[0.67] | 12.0<br>[0.47] |
| <b><u>BMSPX-11-W</u></b> | \$5.50  | <b><u>BMSPX-21-W</u></b> | \$5.50  | 5   | M16 x 1.5 mm | 5.0 - 10.0<br>[0.20 - 0.39]  | 2.5<br>[1.84]                 | ±0.5<br>[±0.37] | 22.0<br>[0.87]     | 10.0<br>[0.39] | 81.5<br>[3.21]  | 25.0<br>[0.98] | 16.0<br>[0.63] |
| <b><u>BMSPX-13-W</u></b> | \$10.00 | <b><u>BMSPX-23-W</u></b> | \$10.00 | 5   | M20 x 1.5 mm | 10.0 - 14.0<br>[0.39 - 0.55] | 5.5<br>[4.06]                 | ±0.5<br>[±0.37] | 27.0<br>[1.06]     | 10.0<br>[0.39] | 106.5<br>[4.19] | 30.8<br>[1.21] | 20.0<br>[0.79] |
| <b><u>BMSPX-15-W</u></b> | \$13.50 | <b><u>BMSPX-25-W</u></b> | \$13.00 | 5   | M25 x 1.5 mm | 13.0 - 18.0<br>[0.51 - 0.71] | 8.0<br>[5.90]                 | ±0.5<br>[±0.37] | 33.0<br>[1.30]     | 10.0<br>[0.39] | 117.0<br>[4.61] | 37.8<br>[1.49] | 25.0<br>[0.98] |

Note: Hex nut and washer included.

## UL Part # Cross Reference

| UL Part Number | ADC Part Number            |
|----------------|----------------------------|
| BMSP-1S        | <a href="#">BMSPX-1S-W</a> |
| BMSP-11        | <a href="#">BMSPX-11-W</a> |
| BMSP-13        | <a href="#">BMSPX-13-W</a> |
| BMSP-15        | <a href="#">BMSPX-15-W</a> |
| BMSP-2S        | <a href="#">BMSPX-2S-W</a> |
| BMSP-21        | <a href="#">BMSPX-21-W</a> |
| BMSP-23        | <a href="#">BMSPX-23-W</a> |
| BMSP-25        | <a href="#">BMSPX-25-W</a> |

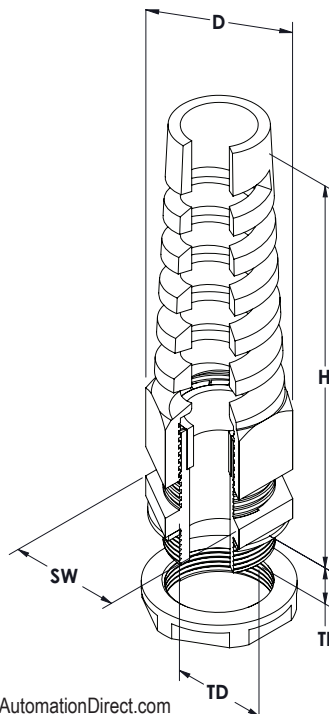

See our website: [www.AutomationDirect.com](http://www.AutomationDirect.com)  
for complete Engineering drawings



# bimed Protection Series Plastic PG Thread Cable Glands

## Material

- Body: PA 6 (Polyamide 6)
- Cap: PA 6 ( Polyamide 6)
- Seal: CR (Chloroprene Rubber)
- Locknut: PA 6 (Polyamide 6), 30% glass fiber reinforced

## Flammability

- V2 (According to UL 94)

## Protection Class

- IP68 - 5 Bar [72.5 psi]

## Operating Temperature

- Permanent: -20 to +100°C [-4 to +212°F]
- Intermittent: -30 to +150°C [-22 to +302°F]

## Attachment Thread

- EN 60423

## Body

- Manufactured according to the requirements of EN 50262

## Approvals

- UL Recognized or Listed File # E199260 \*
- CSA File # 190896
- CE



**\*Note: To obtain the most current agency approval information, see the Agency Compliance & Certifications Checklist section on the specific part number's web page.**



## Cable Protection Series Plastic PG Thread Strain Relief Cable Glands

| Light Gray                        | Price   | Black                             | Price   | Qty | Thread Size | Clamping Range mm [in]       | Recommended Tightening Torque |                 | Dimensions mm [in] |                |                 |                |                |
|-----------------------------------|---------|-----------------------------------|---------|-----|-------------|------------------------------|-------------------------------|-----------------|--------------------|----------------|-----------------|----------------|----------------|
|                                   |         |                                   |         |     |             |                              | N-m [lb-ft]                   | Tolerance       | SW                 | TL             | H               | D              | TD             |
| <a href="#"><u>BSSPX-11-W</u></a> | \$3.75  | <a href="#"><u>BSSPX-21-W</u></a> | \$3.75  | 5   | PG7         | 3.0 - 6.5<br>[0.12 - 0.26]   | 2.0<br>[1.48]                 | ±0.5<br>[±0.37] | 15.0<br>[0.59]     | 8.0<br>[0.31]  | 56.0<br>[2.20]  | 12.4<br>[0.49] | 12.4<br>[0.49] |
| <a href="#"><u>BSSPX-12-W</u></a> | \$4.25  | <a href="#"><u>BSSPX-22-W</u></a> | \$4.25  | 5   | PG9         | 4.0 - 8.0<br>[0.16 - 0.31]   | 2.5<br>[1.84]                 | ±0.5<br>[±0.37] | 19.0<br>[0.75]     | 8.0<br>[0.31]  | 69.0<br>[2.72]  | 15.1<br>[0.59] | 15.1<br>[0.59] |
| <a href="#"><u>BSSPX-13-W</u></a> | \$5.00  | <a href="#"><u>BSSPX-23-W</u></a> | \$4.75  | 5   | PG11        | 5.0 - 10.0<br>[0.20 - 0.39]  | 2.5<br>[1.84]                 | ±0.5<br>[±0.37] | 22.0<br>[0.87]     | 8.0<br>[0.31]  | 82.5<br>[3.25]  | 18.5<br>[0.73] | 18.5<br>[0.73] |
| <a href="#"><u>BSSPX-14-W</u></a> | \$5.50  | <a href="#"><u>BSSPX-24-W</u></a> | \$5.50  | 5   | PG13.5      | 6.0 - 12.0<br>[0.24 - 0.47]  | 5.0<br>[3.69]                 | ±0.5<br>[±0.37] | 24.0<br>[0.94]     | 9.0<br>[0.35]  | 94.0<br>[3.70]  | 27.8<br>[1.09] | 20.3<br>[0.80] |
| <a href="#"><u>BSSPX-15-W</u></a> | \$9.25  | <a href="#"><u>BSSPX-25-W</u></a> | \$9.00  | 5   | PG16        | 10.0 - 14.0<br>[0.39 - 0.55] | 5.5<br>[4.06]                 | ±0.5<br>[±0.37] | 27.0<br>[1.06]     | 10.0<br>[0.39] | 106.0<br>[4.17] | 31.1<br>[1.22] | 22.5<br>[0.89] |
| <a href="#"><u>BSSPX-16-W</u></a> | \$12.00 | <a href="#"><u>BSSPX-26-W</u></a> | \$12.00 | 5   | PG21        | 13.0 - 18.0<br>[0.51 - 0.71] | 5.5<br>[4.06]                 | ±0.5<br>[±0.37] | 33.0<br>[1.30]     | 11.0<br>[0.43] | 117.0<br>[4.61] | 37.8<br>[1.49] | 28.1<br>[1.11] |

Note: Hex nut and washer included.

## UL Part # Cross Reference

| UL Part Number | ADC Part Number                   |
|----------------|-----------------------------------|
| BSSP-11        | <a href="#"><u>BSSPX-11-W</u></a> |
| BSSP-12        | <a href="#"><u>BSSPX-12-W</u></a> |
| BSSP-13        | <a href="#"><u>BSSPX-13-W</u></a> |
| BSSP-14        | <a href="#"><u>BSSPX-14-W</u></a> |
| BSSP-15        | <a href="#"><u>BSSPX-15-W</u></a> |
| BSSP-16        | <a href="#"><u>BSSPX-16-W</u></a> |
| BSSP-21        | <a href="#"><u>BSSPX-11-W</u></a> |
| BSSP-22        | <a href="#"><u>BSSPX-12-W</u></a> |
| BSSP-23        | <a href="#"><u>BSSPX-13-W</u></a> |
| BSSP-24        | <a href="#"><u>BSSPX-14-W</u></a> |
| BSSP-25        | <a href="#"><u>BSSPX-15-W</u></a> |
| BSSP-26        | <a href="#"><u>BSSPX-16-W</u></a> |

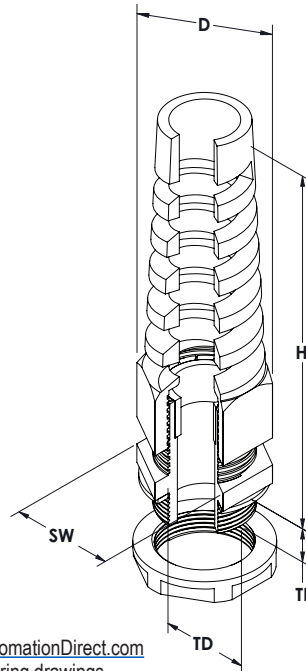

See our website: [www.AutomationDirect.com](http://www.AutomationDirect.com)  
for complete Engineering drawings

# bimed Protection Series Plastic NPT Thread Cable Glands

## Material

- Body: PA 6 (Polyamide 6)
- Cap: PA 6 (Polyamide 6)
- Seal: CR (Chloroprene Rubber)
- Locknut: PA 6 (Polyamide 6), 30% glass fiber reinforced

## Flammability

- V2 (According to UL 94)

## Protection Class

- IP68 - 5 Bar [72.5 psi]

## Operating Temperature

- Permanent: -20 to +100°C [-4 to +212°F]
- Intermittent: -30 to +150°C [-22 to +302°F]

## Attachment Thread

- ANSI B 1.20.1

## Body

- Manufactured according to the requirements of EN 50262

## Approvals

- Recognized or Listed File # E199260 \*
- CSA File # 190896
- CE



\*Note: To obtain the most current agency approval information, see the Agency Compliance & Certifications Checklist section on the specific part number's web page.



**Cable Protection Series Plastic NPT Thread Cable Glands**

| Light Gray                         | Price   | Black                              | Price   | Qty | Thread Size | Clamping Range<br>mm [in]    | Recommended Tightening Torque |                 | Dimensions<br>mm [in] |                |                 |                |                |
|------------------------------------|---------|------------------------------------|---------|-----|-------------|------------------------------|-------------------------------|-----------------|-----------------------|----------------|-----------------|----------------|----------------|
|                                    |         |                                    |         |     |             |                              | N-m [lb-ft]                   | Tolerance       | SW                    | TL             | H               | D              | TD             |
| <a href="#"><u>BNSPAX-11-W</u></a> | \$6.25  | <a href="#"><u>BNSPAX-21-W</u></a> | \$6.25  | 5   | NPT 3/8"    | 5.0 - 10.0<br>[0.20 - 0.39]  | 2.5<br>[1.84]                 | ±0.5<br>[±0.37] | 22.0<br>[0.87]        | 15.0<br>[0.59] | 80.4<br>[3.17]  | 25.3<br>[1.00] | 17.1<br>[0.67] |
| <a href="#"><u>BNSPBX-12-W</u></a> | \$9.25  | <a href="#"><u>BNSPBX-22-W</u></a> | \$9.25  | 5   | NPT 1/2"    | 6.0 - 12.0<br>[0.24 - 0.47]  | 4.0<br>[2.95]                 | ±0.5<br>[±0.37] | 24.0<br>[0.94]        | 15.0<br>[0.59] | 94.7<br>[3.73]  | 27.6<br>[1.09] | 21.3<br>[0.84] |
| <a href="#"><u>BNSPDX-13-W</u></a> | \$13.50 | <a href="#"><u>BNSPDX-23-W</u></a> | \$13.50 | 5   | NPT 3/4"    | 13.0 - 18.0<br>[0.51 - 0.71] | 5.5<br>[4.06]                 | ±0.5<br>[±0.37] | 33.0<br>[1.30]        | 15.0<br>[0.59] | 117.4<br>[4.62] | 37.8<br>[1.49] | 26.1<br>[1.03] |

Note: Hex nut and washer included.

## UL Part # Cross Reference

| UL Part Number | ADC Part Number                    |
|----------------|------------------------------------|
| BNSPA-11       | <a href="#"><u>BNSPAX-11-W</u></a> |
| BNSPB-12       | <a href="#"><u>BNSPBX-12-W</u></a> |
| BNSPD-13       | <a href="#"><u>BNSPDX-13-W</u></a> |
| BNSPA-21       | <a href="#"><u>BNSPAX-21-W</u></a> |
| BNSPB-22       | <a href="#"><u>BNSPBX-22-W</u></a> |
| BNSPD-23       | <a href="#"><u>BNSPDX-23-W</u></a> |

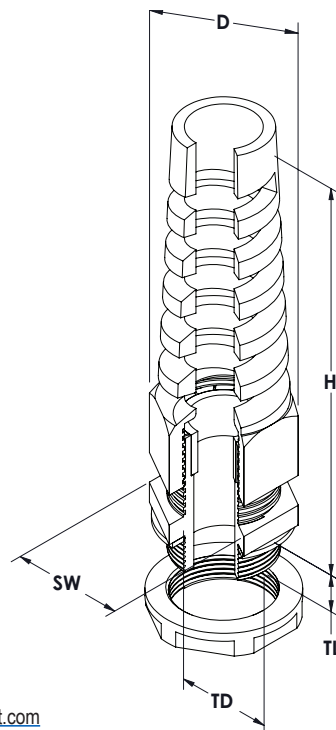

See our website: [www.AutomationDirect.com](http://www.AutomationDirect.com)  
for complete Engineering drawings

# bimed Brass Metric Thread Cable Glands

## Material

- Body: Brass nickel-plated
- Cap: Brass nickel-plated
- Seal: CR (Chloroprene Rubber)
- Clamp insert: PA 6 (Polyamide 6)
- O-ring: NBR

## Flammability

- V2 (According to UL 94)

## Protection Class

- IP68 - 5 Bar (72.5 psi)

## Operating Temperature

- Permanent: -20 to +100°C [-4 to +212°F]
- Intermittent: -40 to +150°C [-40 to +302°F]

## Attachment Thread

- EN 60423

## Body

- Manufactured according to the requirements of EN 50262

## Approvals

- UL Recognized or Listed File # E199260 \*
- CSA File # 190896
- CE



\*Note: To obtain the most current agency approval information, see the Agency Compliance & Certifications Checklist section on the specific part number's web page.



| Brass Metric Thread Cable Glands |         |     |              |                              |                                  |                 |                       |                |                |                |                |                |
|----------------------------------|---------|-----|--------------|------------------------------|----------------------------------|-----------------|-----------------------|----------------|----------------|----------------|----------------|----------------|
| Part Number                      | Price   | Qty | Thread Size  | Clamping Range<br>mm [in]    | Recommended<br>Tightening Torque |                 | Dimensions<br>mm [in] |                |                |                |                |                |
|                                  |         |     |              |                              | N·m [lb·ft]                      | Tolerance       | SW1                   | SW2            | TL             | H              | D              | TD             |
| <a href="#">BMBCX-ES</a>         | \$12.00 | 5   | M12 x 1.5 mm | 3.0 - 6.5<br>[0.12 - 0.26]   | 5.0<br>[3.69]                    | ±0.5<br>[±0.37] | 14.0<br>[0.55]        | 14.0<br>[0.55] | 6.0<br>[0.24]  | 21.5<br>[0.85] | 15.5<br>[0.61] | 12.0<br>[0.47] |
| <a href="#">BMBCX-E1</a>         | \$15.00 | 5   | M16 x 1.5 mm | 5.0 - 10.0<br>[0.20 - 0.39]  | 9.0<br>[6.64]                    | ±0.5<br>[±0.37] | 17.0<br>[0.67]        | 18.0<br>[0.71] | 7.0<br>[0.28]  | 23.0<br>[0.91] | 18.9<br>[0.74] | 16.0<br>[0.63] |
| <a href="#">BMBCX-E2</a>         | \$21.00 | 5   | M20 x 1.5 mm | 6.0 - 12.0<br>[0.24 - 0.47]  | 11.0<br>[8.11]                   | ±1.0<br>[±0.74] | 22.0<br>[0.87]        | 22.0<br>[0.87] | 8.0<br>[0.31]  | 25.0<br>[0.98] | 26.8<br>[1.06] | 20.0<br>[0.79] |
| <a href="#">BMBCX-E3</a>         | \$24.00 | 5   | M25 x 1.5 mm | 11.0 - 17.0<br>[0.43 - 0.67] | 14.0<br>[10.33]                  | ±1.0<br>[±0.74] | 24.0<br>[0.94]        | 27.0<br>[1.06] | 8.0<br>[0.31]  | 28.0<br>[1.10] | 26.8<br>[1.06] | 25.0<br>[0.98] |
| <a href="#">BMBCX-E4</a>         | \$39.50 | 5   | M32 x 1.5 mm | 15.0 - 21.0<br>[0.59 - 0.86] | 15.0<br>[11.06]                  | ±1.0<br>[±0.74] | 30.0<br>[1.18]        | 34.0<br>[1.34] | 9.0<br>[0.35]  | 33.0<br>[1.30] | 37.5<br>[1.48] | 32.0<br>[1.26] |
| <a href="#">BMBCX-E5</a>         | \$26.00 | 2   | M40 x 1.5 mm | 19.0 - 28.0<br>[0.74 - 1.10] | 17.0<br>[12.54]                  | ±1.0<br>[±0.74] | 40.0<br>[1.57]        | 43.0<br>[1.69] | 9.0<br>[0.35]  | 38.0<br>[1.50] | 48.5<br>[1.91] | 40.0<br>[1.57] |
| <a href="#">BMBCX-E6</a>         | \$47.00 | 2   | M50 x 1.5 mm | 27.0 - 38.0<br>[1.06 - 1.50] | 30.0<br>[22.13]                  | ±1.5<br>[±1.11] | 50.0<br>[1.97]        | 55.0<br>[2.17] | 9.0<br>[0.35]  | 48.0<br>[1.89] | 61.0<br>[2.40] | 50.0<br>[1.97] |
| <a href="#">BMBCX-E7</a>         | \$87.00 | 2   | M63 x 1.5 mm | 34.0 - 44.0<br>[1.34 - 1.73] | 55.0<br>[40.57]                  | ±2.0<br>[±1.48] | 64.0<br>[2.52]        | 68.0<br>[2.68] | 14.0<br>[0.55] | 54.0<br>[2.13] | 75.0<br>[2.95] | 63.0<br>[2.48] |

Note: Hex nut and washer included.

| UL Part # Cross Reference |                          |
|---------------------------|--------------------------|
| UL Part Number            | ADC Part Number          |
| BMBC-ES                   | <a href="#">BMBCX-ES</a> |
| BMBC-E1                   | <a href="#">BMBCX-E1</a> |
| BMBC-E2                   | <a href="#">BMBCX-E2</a> |
| BMBC-E3                   | <a href="#">BMBCX-E3</a> |
| BMBC-E4                   | <a href="#">BMBCX-E4</a> |
| BMBC-E5                   | <a href="#">BMBCX-E5</a> |
| BMBC-E6                   | <a href="#">BMBCX-E6</a> |
| BMBC-E7                   | <a href="#">BMBCX-E7</a> |

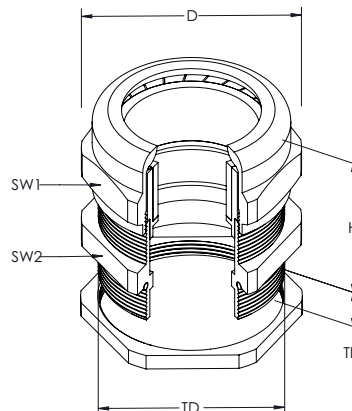

See our website: [www.AutomationDirect.com](http://www.AutomationDirect.com)  
for complete Engineering drawings



# bimed Brass PG Thread Cable Glands

## Material

- Body: Brass nickel-plated
- Cap: Brass nickel-plated
- Seal: CR (Chloroprene Rubber)
- Clamp insert: PA 6 (Polyamide 6)
- O-ring: NBR

## Flammability

- V2 (According to UL 94)

## Protection Class

- IP68 - 5 Bar (72.5 psi)

## Operating Temperature

- Permanent: -20 to +100°C [-4 to +212°F]
- Intermittent: -40 to +150°C [-40 to +302°F]

## Attachment Thread

- DIN 40430

## Body

- Manufactured according to the requirements of EN 50262

## Approvals

- UL Recognized or Listed File # E199260 \*
- CSA File # 190896
- CE



**\*Note: To obtain the most current agency approval information, see the Agency Compliance & Certifications Checklist section on the specific part number's web page.**



| Brass PG Thread Cable Glands |         |     |             |                              |                               |                 |                       |                |                |                |                |                |
|------------------------------|---------|-----|-------------|------------------------------|-------------------------------|-----------------|-----------------------|----------------|----------------|----------------|----------------|----------------|
| Part Number                  | Price   | Qty | Thread Size | Clamping Range<br>mm [in]    | Recommended Tightening Torque |                 | Dimensions<br>mm [in] |                |                |                |                |                |
|                              |         |     |             |                              | N·m [lb·ft]                   | Tolerance       | SW1                   | SW2            | TL             | H              | D              | TD             |
| <a href="#">BSBCX-01</a>     | \$12.00 | 5   | PG7         | 3.0 - 6.5<br>[0.12 - 0.26]   | 5.0<br>[3.69]                 | ±0.5<br>[±0.37] | 14.0<br>[0.55]        | 14.0<br>[0.55] | 6.0<br>[0.24]  | 22.0<br>[0.87] | 15.5<br>[0.61] | 12.5<br>[0.49] |
| <a href="#">BSBCX-02</a>     | \$13.00 | 5   | PG9         | 4.0 - 8.0<br>[0.16 - 0.31]   | 5.5<br>[4.06]                 | ±0.5<br>[±0.37] | 17.0<br>[0.67]        | 17.0<br>[0.67] | 6.0<br>[0.24]  | 23.5<br>[0.93] | 18.9<br>[0.74] | 15.2<br>[0.60] |
| <a href="#">BSBCX-03</a>     | \$16.00 | 5   | PG11        | 5.0 - 10.0<br>[0.20 - 0.39]  | 7.0<br>[5.16]                 | ±0.5<br>[±0.37] | 20.0<br>[0.79]        | 20.0<br>[0.79] | 6.0<br>[0.24]  | 26.0<br>[1.02] | 22.0<br>[0.87] | 18.6<br>[0.73] |
| <a href="#">BSBCX-04</a>     | \$18.50 | 5   | PG13.5      | 6.0 - 12.0<br>[0.24 - 0.47]  | 8.0<br>[5.90]                 | ±1.0<br>[±0.74] | 22.0<br>[0.87]        | 22.0<br>[0.87] | 6.5<br>[0.26]  | 24.5<br>[0.96] | 24.5<br>[0.96] | 20.4<br>[0.80] |
| <a href="#">BSBCX-05</a>     | \$21.00 | 5   | PG16        | 10.0 - 14.0<br>[0.39 - 0.55] | 11.0<br>[8.11]                | ±1.0<br>[±0.74] | 24.0<br>[0.94]        | 24.0<br>[0.94] | 6.5<br>[0.26]  | 28.0<br>[1.10] | 26.8<br>[1.06] | 22.5<br>[0.89] |
| <a href="#">BSBCX-06</a>     | \$33.00 | 5   | PG21        | 13.0 - 18.0<br>[0.51 - 0.71] | 17.0<br>[12.54]               | ±1.0<br>[±0.74] | 30.0<br>[1.18]        | 30.0<br>[1.18] | 7.2<br>[0.28]  | 32.5<br>[1.28] | 33.0<br>[1.30] | 28.3<br>[1.11] |
| <a href="#">BSBCX-07</a>     | \$54.00 | 5   | PG29        | 18.0 - 25.0<br>[0.71 - 0.98] | 22.0<br>[16.23]               | ±1.0<br>[±0.74] | 40.0<br>[1.57]        | 40.0<br>[1.57] | 8.0<br>[0.31]  | 38.5<br>[1.52] | 44.5<br>[1.75] | 37.0<br>[1.46] |
| <a href="#">BSBCX-08</a>     | \$39.50 | 2   | PG36        | 22.0 - 32.0<br>[0.87 - 1.26] | 40.0<br>[29.50]               | ±1.5<br>[±1.11] | 50.0<br>[1.97]        | 50.0<br>[1.97] | 9.0<br>[0.35]  | 48.0<br>[1.89] | 55.5<br>[2.19] | 47.0<br>[1.85] |
| <a href="#">BSBCX-09</a>     | \$64.00 | 1   | PG42        | 30.0 - 38.0<br>[1.18 - 1.50] | 45.0<br>[33.19]               | ±2.0<br>[±1.48] | 58.0<br>[2.28]        | 58.0<br>[2.28] | 12.0<br>[0.47] | 48.5<br>[1.91] | 64.0<br>[2.51] | 54.0<br>[2.13] |
| <a href="#">BSBCX-10</a>     | \$84.00 | 1   | PG48        | 34.0 - 44.0<br>[1.34 - 1.73] | 50.0<br>[36.88]               | ±2.0<br>[±1.48] | 64.0<br>[2.52]        | 64.0<br>[2.52] | 14.0<br>[0.55] | 53.0<br>[2.09] | 70.0<br>[2.76] | 59.3<br>[2.33] |

Note: Hex nut and washer included.

| UL Part # Cross Reference |                          |
|---------------------------|--------------------------|
| UL Part Number            | ADC Part Number          |
| BSBC-01                   | <a href="#">BSBCX-01</a> |
| BSBC-02                   | <a href="#">BSBCX-02</a> |
| BSBC-03                   | <a href="#">BSBCX-03</a> |
| BSBC-04                   | <a href="#">BSBCX-04</a> |
| BSBC-05                   | <a href="#">BSBCX-05</a> |
| BSBC-06                   | <a href="#">BSBCX-06</a> |
| BSBC-07                   | <a href="#">BSBCX-07</a> |
| BSBC-08                   | <a href="#">BSBCX-08</a> |
| BSBC-09                   | <a href="#">BSBCX-09</a> |
| BSBC-10                   | <a href="#">BSBCX-10</a> |

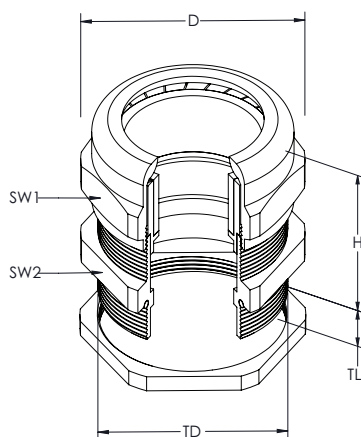

See our website: [www.AutomationDirect.com](http://www.AutomationDirect.com)  
for complete Engineering drawings

# bimed Brass NPT Thread Cable Glands

## Material

- Body: Brass nickel-plated
- Cap: Brass nickel-plated
- Seal: CR (Chloroprene Rubber)
- Clamp insert: PA 6 (Polyamide 6)
- O-ring: NBR

## Flammability

- V2 (According to UL 94)

## Protection Class

- IP68 - 5 Bar [72.5 psi]

## Operating Temperature

- Permanent: -20 to +100°C [-4 to +212°F]
- Intermittent: -40 to +150°C [-40 to +302°F]

## Attachment Thread

- ANSI B 1.20.1

## Body

- Manufactured according to the requirements of EN 50262

## Approvals

- UL Recognized or Listed File # E199260 \*
- CSA File # 190896
- CE



**\*Note: To obtain the most current agency approval information, see the Agency Compliance & Certifications Checklist section on the specific part number's web page.**



## Brass NPT Thread Cable Glands

| Part Number              | Price   | Qty | Thread Size | Clamping Range<br>mm [in]    | Recommended<br>Tightening Torque |                 | Dimensions<br>mm [in] |                |                |                |                |                |
|--------------------------|---------|-----|-------------|------------------------------|----------------------------------|-----------------|-----------------------|----------------|----------------|----------------|----------------|----------------|
|                          |         |     |             |                              | N·m [lb·ft]                      | Tolerance       | SW1                   | SW2            | TL             | H              | D              | TD             |
| <a href="#">BNBCX-01</a> | \$23.00 | 5   | NPT 3/8"    | 4.0 - 8.0<br>[0.16 - 0.31]   | 6.5<br>[4.79]                    | ±0.5<br>[±0.37] | 17.0<br>[0.67]        | 19.0<br>[0.75] | 11.5<br>[0.45] | 23.0<br>[0.91] | 21.0<br>[0.83] | 16.8<br>[0.66] |
| <a href="#">BNBCX-02</a> | \$28.00 | 5   | NPT 1/2"    | 6.0 -12.0<br>[0.24 - 0.47]   | 17.5<br>[12.91]                  | ±0.5<br>[±0.37] | 22.0<br>[0.87]        | 22.0<br>[0.87] | 13.0<br>[0.51] | 25.5<br>[1.00] | 24.5<br>[0.96] | 20.9<br>[0.82] |
| <a href="#">BNBCX-03</a> | \$46.50 | 5   | NPT 3/4"    | 13.0 - 18.0<br>[0.51 - 0.71] | 18.0<br>[13.28]                  | ±0.5<br>[±0.37] | 30.0<br>[1.18]        | 30.0<br>[1.18] | 13.0<br>[0.51] | 35.5<br>[1.40] | 33.0<br>[1.30] | 26.2<br>[1.03] |
| <a href="#">BNBCX-04</a> | \$96.00 | 5   | NPT 1"      | 18.0 - 25.0<br>[0.71 - 0.98] | 40.0<br>[29.50]                  | ±1.0<br>[±0.74] | 40.0<br>[1.57]        | 40.0<br>[1.57] | 13.0<br>[0.51] | 43.0<br>[1.69] | 44.5<br>[1.75] | 32.8<br>[1.29] |

Note: Hex nut and washer included.

## UL Part # Cross Reference

| UL Part Number | ADC Part Number          |
|----------------|--------------------------|
| BNBC-01        | <a href="#">BNBCX-01</a> |
| BNBC-02        | <a href="#">BNBCX-02</a> |
| BNBC-03        | <a href="#">BNBCX-03</a> |
| BNBC-04        | <a href="#">BNBCX-04</a> |

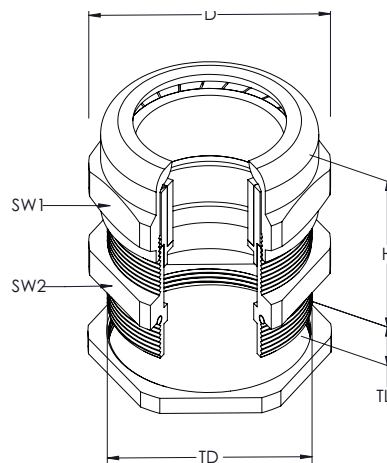

See our website: [www.AutomationDirect.com](http://www.AutomationDirect.com)  
for complete Engineering drawings

bimed

# Cable Glands Replacement Hex Nuts

## Replacement Hex Nuts for Plastic Cable Glands

| Type   | Light Gray                    | Price  | Black                         | Price  | Qty | Thread Size  | Dimensions – mm [in] |             |            |
|--------|-------------------------------|--------|-------------------------------|--------|-----|--------------|----------------------|-------------|------------|
|        |                               |        |                               |        |     |              | SW                   | D           | H          |
| Metric | <a href="#"><u>BML-1S</u></a> | \$1.75 | <a href="#"><u>BML-2S</u></a> | \$1.75 | 5   | M12 x 1.5 mm | 18.0 [0.71]          | 19.5 [0.77] | 5.0 [0.20] |
|        | <a href="#"><u>BML-11</u></a> | \$1.75 | <a href="#"><u>BML-21</u></a> | \$1.75 | 5   | M16 x 1.5 mm | 22.0 [0.87]          | 24.2 [0.95] | 5.0 [0.20] |
|        | <a href="#"><u>BML-12</u></a> | \$1.75 | <a href="#"><u>BML-22</u></a> | \$1.75 | 5   | M20 x 1.5 mm | 26.0 [1.02]          | 28.6 [1.13] | 6.0 [0.24] |
|        | <a href="#"><u>BML-13</u></a> | \$1.75 | <a href="#"><u>BML-23</u></a> | \$1.75 | 5   | M25 x 1.5 mm | 32.0 [1.26]          | 35.0 [1.38] | 6.0 [0.24] |
|        | <a href="#"><u>BML-14</u></a> | \$1.75 | <a href="#"><u>BML-24</u></a> | \$1.75 | 5   | M32 x 1.5 mm | 41.0 [1.61]          | 46.1 [1.81] | 7.0 [0.28] |
|        | <a href="#"><u>BML-15</u></a> | \$1.75 | <a href="#"><u>BML-25</u></a> | \$1.75 | 2   | M40 x 1.5 mm | 50.0 [1.97]          | 55.3 [2.18] | 7.0 [0.28] |
|        | <a href="#"><u>BML-16</u></a> | \$1.75 | <a href="#"><u>BML-26</u></a> | \$1.75 | 2   | M50 x 1.5 mm | 60.0 [2.36]          | 66.1 [2.60] | 8.0 [0.31] |
|        | <a href="#"><u>BML-17</u></a> | \$2.25 | <a href="#"><u>BML-27</u></a> | \$2.25 | 2   | M63 x 1.5 mm | 75.0 [2.95]          | 82.5 [3.25] | 8.0 [0.31] |
| PG     | <a href="#"><u>BL-11</u></a>  | \$1.75 | <a href="#"><u>BL-21</u></a>  | \$1.75 | 5   | PG 7         | 19.0 [0.75]          | 21.0 [0.83] | 5.0 [0.20] |
|        | <a href="#"><u>BL-12</u></a>  | \$1.75 | <a href="#"><u>BL-22</u></a>  | \$1.75 | 5   | PG 9         | 22.0 [0.87]          | 24.0 [0.94] | 5.0 [0.20] |
|        | <a href="#"><u>BL-13</u></a>  | \$1.75 | <a href="#"><u>BL-23</u></a>  | \$1.75 | 5   | PG11         | 24.0 [0.94]          | 26.0 [1.02] | 5.0 [0.20] |
|        | <a href="#"><u>BL-14</u></a>  | \$1.75 | <a href="#"><u>BL-24</u></a>  | \$1.75 | 5   | PG13.5       | 27.0 [1.06]          | 29.0 [1.14] | 6.0 [0.24] |
|        | <a href="#"><u>BL-15</u></a>  | \$1.75 | <a href="#"><u>BL-25</u></a>  | \$1.75 | 5   | PG16         | 30.0 [1.18]          | 33.0 [1.30] | 6.0 [0.24] |
|        | <a href="#"><u>BL-16</u></a>  | \$1.75 | <a href="#"><u>BL-26</u></a>  | \$1.75 | 5   | PG21         | 36.0 [1.42]          | 39.0 [1.54] | 7.0 [0.28] |
|        | <a href="#"><u>BL-17</u></a>  | \$1.75 | <a href="#"><u>BL-27</u></a>  | \$1.75 | 5   | PG29         | 46.0 [1.81]          | 50.0 [1.97] | 7.0 [0.28] |
|        | <a href="#"><u>BL-18</u></a>  | \$1.75 | <a href="#"><u>BL-28</u></a>  | \$1.75 | 2   | PG36         | 60.0 [2.36]          | 66.0 [2.60] | 8.0 [0.31] |
|        | <a href="#"><u>BL-19</u></a>  | \$2.00 | <a href="#"><u>BL-29</u></a>  | \$2.00 | 2   | PG42         | 65.0 [2.56]          | 73.0 [2.87] | 8.0 [0.31] |
|        | <a href="#"><u>BL-20</u></a>  | \$2.25 | <a href="#"><u>BL-30</u></a>  | \$2.25 | 2   | PG48         | 70.0 [2.78]          | 78.0 [3.07] | 8.0 [0.31] |
| NPT    | <a href="#"><u>BPL-11</u></a> | \$1.75 | <a href="#"><u>BPL-21</u></a> | \$1.75 | 5   | NPT 3/8"     | 22.0 [0.87]          | 25.0 [0.98] | 7.0 [0.28] |
|        | <a href="#"><u>BPL-12</u></a> | \$1.75 | <a href="#"><u>BPL-22</u></a> | \$1.75 | 5   | NPT 1/2"     | 27.0 [1.06]          | 30.5 [1.20] | 7.0 [0.28] |
|        | <a href="#"><u>BPL-13</u></a> | \$2.25 | <a href="#"><u>BPL-23</u></a> | \$2.25 | 5   | NPT 3/4"     | 33.0 [1.30]          | 37.5 [1.48] | 7.0 [0.28] |
|        | <a href="#"><u>BPL-14</u></a> | \$4.25 | <a href="#"><u>BPL-24</u></a> | \$4.25 | 5   | NPT 1"       | 41.0 [1.61]          | 46.5 [1.83] | 7.0 [0.28] |



## Replacement Hex Nuts for Brass Cable Glands

| Type   | Part Number                    | Price   | Qty | Thread Size  | Dimensions – mm [in] |             |            |
|--------|--------------------------------|---------|-----|--------------|----------------------|-------------|------------|
|        |                                |         |     |              | SW                   | D           | H          |
| Metric | <a href="#"><u>BMBL-01</u></a> | \$2.00  | 5   | M12 x 1.5 mm | 15.0 [0.59]          | 16.6 [0.65] | 2.8 [0.11] |
|        | <a href="#"><u>BMBL-02</u></a> | \$2.50  | 5   | M16 x 1.5 mm | 19.0 [0.75]          | 21.0 [0.83] | 3.0 [0.12] |
|        | <a href="#"><u>BMBL-03</u></a> | \$3.50  | 5   | M20 x 1.5 mm | 24.0 [0.94]          | 26.5 [1.04] | 3.5 [0.14] |
|        | <a href="#"><u>BMBL-04</u></a> | \$4.25  | 5   | M25 x 1.5 mm | 30.0 [1.18]          | 33.0 [1.30] | 4.0 [0.16] |
|        | <a href="#"><u>BMBL-05</u></a> | \$5.50  | 5   | M32 x 1.5 mm | 36.0 [1.42]          | 39.5 [1.56] | 5.0 [0.20] |
|        | <a href="#"><u>BMBL-06</u></a> | \$4.75  | 2   | M40 x 1.5 mm | 46.0 [1.81]          | 51.0 [2.01] | 5.0 [0.20] |
|        | <a href="#"><u>BMBL-07</u></a> | \$12.00 | 2   | M50 x 1.5 mm | 60.0 [2.36]          | 66.0 [2.60] | 5.0 [0.20] |
|        | <a href="#"><u>BMBL-08</u></a> | \$13.00 | 2   | M63 x 1.5 mm | 70.0 [2.76]          | 77.0 [3.03] | 6.0 [0.24] |
| PG     | <a href="#"><u>BSL-01</u></a>  | \$2.00  | 5   | PG 7         | 15.0 [0.59]          | 16.6 [0.65] | 2.8 [0.11] |
|        | <a href="#"><u>BSL-02</u></a>  | \$2.00  | 5   | PG 9         | 18.0 [0.71]          | 20.0 [0.79] | 2.8 [0.11] |
|        | <a href="#"><u>BSL-03</u></a>  | \$2.00  | 5   | PG11         | 21.0 [0.83]          | 23.5 [0.93] | 3.0 [0.12] |
|        | <a href="#"><u>BSL-04</u></a>  | \$2.50  | 5   | PG13.5       | 23.0 [0.91]          | 25.5 [1.00] | 3.0 [0.12] |
|        | <a href="#"><u>BSL-05</u></a>  | \$2.50  | 5   | PG16         | 26.0 [1.02]          | 29.0 [1.14] | 3.0 [0.12] |
|        | <a href="#"><u>BSL-06</u></a>  | \$4.75  | 5   | PG21         | 32.0 [1.26]          | 35.5 [1.40] | 3.5 [0.14] |
|        | <a href="#"><u>BSL-07</u></a>  | \$2.75  | 2   | PG29         | 41.0 [1.61]          | 45.0 [1.77] | 4.0 [0.16] |
|        | <a href="#"><u>BSL-08</u></a>  | \$4.25  | 2   | PG36         | 51.0 [2.01]          | 56.0 [2.20] | 5.0 [0.20] |
|        | <a href="#"><u>BSL-09</u></a>  | \$2.75  | 1   | PG42         | 60.0 [2.36]          | 66.0 [2.60] | 5.0 [0.20] |
|        | <a href="#"><u>BSL-10</u></a>  | \$3.75  | 1   | PG48         | 64.0 [2.52]          | 70.5 [2.78] | 5.5 [0.22] |
| NPT    | <a href="#"><u>BNLN-01</u></a> | \$6.00  | 5   | NPT 3/8"     | 24.0 [0.94]          | 26.5 [1.04] | 5.0 [0.20] |
|        | <a href="#"><u>BNLN-02</u></a> | \$7.50  | 5   | NPT 1/2"     | 24.0 [0.94]          | 26.5 [1.04] | 5.0 [0.20] |
|        | <a href="#"><u>BNLN-03</u></a> | \$10.50 | 5   | NPT 3/4"     | 34.0 [1.34]          | 37.5 [1.48] | 6.0 [0.24] |
|        | <a href="#"><u>BNLN-04</u></a> | \$12.00 | 5   | NPT 1"       | 42.0 [1.65]          | 46.4 [1.83] | 6.0 [0.24] |



See our website: [www.AutomationDirect.com](http://www.AutomationDirect.com)  
for complete Engineering drawings