

# prosense® PSD25 Series Pressure Switches

## Features



- Compact pressure switch features simple setup using mechanical adjustment dials
- Extremely durable housing with 316 stainless steel process connection
- No moving parts ensure long-term stability without setpoint drift
- LEDs indicate switching and operating status
- Complementary switching outputs (N.O./N.C.), DC
- Easy set-up dials
- Vibration and shock-resistant

## Agency Approvals

- cULus, File number E320431
- CE
- RoHS



## ProSense Series Pressure Sensors

Part Number	Description	Pcs/Pkg	Wt(lb)	Price	Cable Assemblies
<a href="#"><b><i>PSD25-0P-0145H</i></b></a>	Pressure switch, DC, PNP NO/NC, 7.5 to 145 psig range, 1/4" NPT male port	1	0.21	\$114.00	CD12L-0B-020-A0 CD12L-0B-020-C0 CD12M-0B-070-A1 CD12M-0B-070-C1 (order separately - see Proximity Sensor section for cable specs)
<a href="#"><b><i>PSD25-0P-1450H</i></b></a>	Pressure switch, DC, PNP NO/NC, 75 to 1450 psig range, 1/4" NPT male port	1	0.21	\$107.00	
<a href="#"><b><i>PSD25-0P-5800H</i></b></a>	Pressure switch, DC, PNP NO/NC, 290 to 5800 psig range, 1/4" NPT male port	1	0.21	\$114.00	
<b>Accessory</b>					
<a href="#"><b><i>PSD-CV</i></b></a>	Transparent plastic protective cap for PSD series	1	0.01	\$3.75	PSD Series Sensors

Note: Check the chemical compatibility of the sensor's wetted parts with the medium to be measured.

## ProSense PSD25 Series Technical Specifications

Operating Voltage	9.6 to 32 VDC
Connection Pin Material	Gold-plated
Output Maximum Load Current	500 mA - See Setting and Operation Guide on following page.
Current Consumption	< 25 mA
Switching Frequency	100 Hz
Setting Accuracy of Switch Points	< ± 2.5% of full range (limit point calibration)
Repeatability	< ± 0.5% of full range
Temperature Drift	< ± 0.5%, of full temperature range/10 K; 32 to 176°F (0 to 80°C).
Housing Material	PBT (Pocan); PC (Makrolon); FPM (Viton); stainless steel (316S12)
Materials (wetted parts)	Stainless steel (316S12)
Operating Temperature	-13 to 176°F (-25 to 80°C)
Medium Temperature	-13 to 176°F (-25 to 80°C)
Storage Temperature	-40 to 212°F (-40 to 100°C)
Protection	IP 67
Protection Class	Class III ⚡
Insulation Resistance	> 100 MΩ (500 VDC)
Shock Resistance	50g (DIN / IEC 68-2-27, 11ms)
Vibration Resistance	20g (DIN / IEC 68-2-6, 10 - 2000 Hz)
EMC	
EN 61000-4-2 ESD	4 kV/8 kV AD
EN 61000-4-3 HF Radiated	10 V/m
EN 61000-4-4 Burst	2 kV
EN 61000-4-6 HF Conducted	10 V

## Applications (Type of Pressure: Relative Pressure, Liquids and Gases)

Part Number	Setpoint Scale	Resetpoint Scale	Permissible Overload Pressure	Bursting Pressure
	Bar (Psig)	Bar (Psig)	Bar (Psig)	Bar (Psig)
<a href="#">PSD25-0P-5800H</a>	20 to 400 (290 to 5800)	12 to 392 (175 to 5685)	600 (8700)	1600 (23200)
<a href="#">PSD25-0P-1450H</a>	5 to 100 (75 to 1450)	3 to 98 (50 to 1420)	200 (2900)	1000 (14500)
<a href="#">PSD25-0P-0145H</a>	0.5 to 10 (7.5 to 145)	0.3 to 9.8 (5 to 142)	25 (362)	300 (4350)

Note: Full vacuum permissible



**WARNING! AVOID STATIC AND DYNAMIC OVERPRESSURE EXCEEDING THE GIVEN OVERLOAD PRESSURE.  
EXCEEDING THE BURSTING PRESSURE FOR EVEN A SHORT TIME CAN CAUSE DESTRUCTION OF THE UNIT AND POSSIBLE INJURIES!**

# prosense® PSD25 Series Pressure Switches

## Switch Dimensions

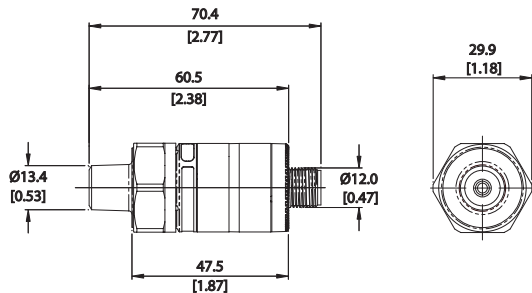

Note: tightening torque 25 Nm (18.4 lb-ft)

## Switch Cover Dimensions

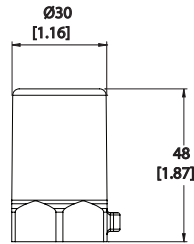

Dimensions shown mm [inches]

See our website [www.AutomationDirect.com](http://www.AutomationDirect.com) for complete Engineering drawings.

## PSD25 Wiring Diagrams

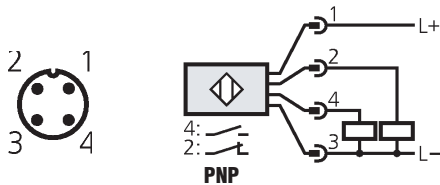

### Cable Assembly Wiring Colors:

Pin 1 - Brown

Pin 2 - White

Pin 3 - Blue

Pin 4 - Black

Note: wiring colors are based on AutomationDirect CD12L and CD12M 4-pole cable assemblies.

## Setting and Operation

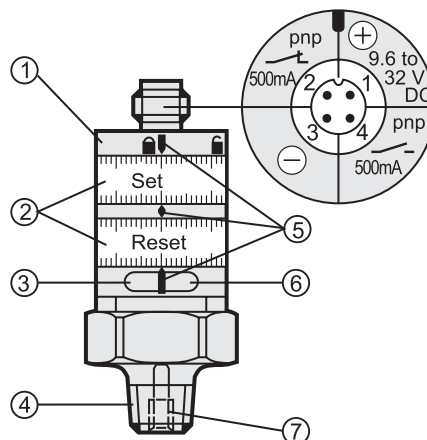

1. locking ring
  2. setting rings (manually adjustable after unlocking)
  3. LED green: supply voltage O. K.
  4. process connection 1/4" NPT; tightening torque 25 Nm
  5. setting marks
  6. LED yellow: Set value reached, OUT1 = ON / OUT2 = OFF
  7. internal thread M5
- Minimum distance between Set and Reset = 2% of the final value of the measuring range.
  - To obtain the setting accuracy: Set both rings to the minimum value, then set the requested values.

# prosense® MPS25 Series Mechanical Pressure Switches



The ProSense MPS25 series mechanical pressure switches are designed for the toughest applications where conventional pressure switch designs often don't measure up. These cost effective switches, depending on the pressure range, have either an all welded 316 stainless steel sealed diaphragm actuator design or a direct acting 316 stainless steel piston design with a Buna-N O-ring. The rugged 316 stainless steel enclosure provides uncompromising protection and long life in difficult environments. The robust design is resistant to vibration and shock, and provides reliable operation over a wide operating temperature range. Pressure ranges from vacuum to 7500 psig are available along with a 1/4 inch NPT male threaded process connection and a precision snap-acting SPDT, 3 Amp, mechanically operated switch output. Choose from either an integral 6-foot (1.5m) cable with 1/2 inch NPT male conduit connection or a DIN 175301-803C L-connector.

## Applications

- Process control & automation
- Pump & compressors
- Hydraulic systems
- Pneumatic systems
- Engine monitoring
- Presses
- Machine tools



#E320431

\* UL only applies to the MPS25 series units with integral cable

## Features

- Compact size
- 316 stainless steel enclosure
- All stainless welded diaphragm or stainless piston and Buna-N O-ring
- Pressure ranges from -15 psig vacuum to 7500 psig
- Tamper resistant field adjustment
- \*Integral 6-foot cable with 1/2 inch NPT male conduit connection or DIN form C electrical connections
- 1/4 inch NPT male process connection
- Wide operating temperature range
- Precision snap-acting SPDT, 3 Amp mechanically operated switch
- UL\*, CSA, CE and RoHS compliant
- 3-year warranty



## MPS25 Series Mechanical Pressure Switches

MPS25 Series Mechanical Pressure Switches						
Part Number	Description	Actuator Type	Electrical Connection	Pcs/ Pkg	Wt(lb)	Price
<a href="#">MPS25-1C-DV15A</a>	Pressure switch, -15 psig vacuum to 15 psig setpoint range, 1/4" NPT male port, 3A SPDT switch output	316 stainless steel welded diaphragm	1/2" NPT male conduit connection, integral 6-foot (1.5 meter) 4 conductor cable with 18AWG leads	1	0.9	\$148.00
<a href="#">MPS25-1C-D30A</a>	Pressure switch, 6 to 30 psig setpoint range, 1/4" NPT male port, 3A SPDT switch output			1	0.9	\$148.00
<a href="#">MPS25-1C-D60A</a>	Pressure switch, 8 to 60 psig setpoint range, 1/4" NPT male port, 3A SPDT switch output			1	0.9	\$148.00
<a href="#">MPS25-1C-D100A</a>	Pressure switch, 10 to 100 psig setpoint range, 1/4" NPT male port, 3A SPDT switch output			1	0.9	\$148.00
<a href="#">MPS25-1C-P200A</a>	Pressure switch, 40 to 200 psig setpoint range, 1/4" NPT male port, 3A SPDT switch output			1	0.9	\$147.00
<a href="#">MPS25-1C-P500A</a>	Pressure switch, 50 to 500 psig setpoint range, 1/4" NPT male port, 3A SPDT switch output	316 stainless steel piston with Buna-N O-ring		1	0.9	\$148.00
<a href="#">MPS25-1C-P1000A</a>	Pressure switch, 100 to 1000 psig setpoint range, 1/4" NPT male port, 3A SPDT switch output			1	0.9	\$148.00
<a href="#">MPS25-1C-P2000A</a>	Pressure switch, 200 to 2000 psig setpoint range, 1/4" NPT male port, 3A SPDT switch output			1	0.9	\$148.00
<a href="#">MPS25-1C-P5000A</a>	Pressure switch, 500 to 5000 psig setpoint range, 1/4" NPT male port, 3A SPDT switch output			1	0.9	\$148.00
<a href="#">MPS25-1C-P7500A</a>	Pressure switch, 750 to 7500 psig setpoint range, 1/4" NPT male port, 3A SPDT switch output			1	0.9	\$148.00
<a href="#">MPS25-1C-DV15D</a>	Pressure switch, -15 psig vacuum to 15 psig setpoint range, 1/4" NPT male port, 3A SPDT switch output	316 stainless steel welded diaphragm	DIN 175301-803C L-Connector (8mm)	1	0.5	\$133.00
<a href="#">MPS25-1C-D30D</a>	Pressure switch, 6 to 30 psig setpoint range, 1/4" NPT male port, 3A SPDT switch output			1	0.5	\$133.00
<a href="#">MPS25-1C-D60D</a>	Pressure switch, 8 to 60 psig setpoint range, 1/4" NPT male port, 3A SPDT switch output			1	0.5	\$133.00
<a href="#">MPS25-1C-D100D</a>	Pressure switch, 10 to 100 psig setpoint range, 1/4" NPT male port, 3A SPDT switch output			1	0.5	\$133.00
<a href="#">MPS25-1C-P200D</a>	Pressure switch, 40 to 200 psig setpoint range, 1/4" NPT male port, 3A SPDT switch output			1	0.5	\$133.00
<a href="#">MPS25-1C-P500D</a>	Pressure switch, 50 to 500 psig setpoint range, 1/4" NPT male port, 3A SPDT switch output	316 stainless steel piston with Buna-N O-ring		1	0.5	\$133.00
<a href="#">MPS25-1C-P1000D</a>	Pressure switch, 100 to 1000 psig setpoint range, 1/4" NPT male port, 3A SPDT switch output			1	0.5	\$133.00
<a href="#">MPS25-1C-P2000D</a>	Pressure switch, 200 to 2000 psig setpoint range, 1/4" NPT male port, 3A SPDT switch output			1	0.5	\$133.00
<a href="#">MPS25-1C-P5000D</a>	Pressure switch, 500 to 5000 psig setpoint range, 1/4" NPT male port, 3A SPDT switch output			1	0.5	\$133.00
<a href="#">MPS25-1C-P7500D</a>	Pressure switch, 750 to 7500 psig setpoint range, 1/4" NPT male port, 3A SPDT switch output			1	0.5	\$133.00

# prosense® MPS25 Series Mechanical Pressure Switches

## ProSense MPS25 Series General Specifications

<b>Setpoint</b>	Field adjustable (factory default 50% of full scale)
<b>Setpoint Repeatability</b>	±2% of range above 100 psig and ±5% for 100 psig and below (Additional setpoint shift of ±2% of range per 40°F from initial setpoint set at 70°F typical)
<b>Vibration</b>	Passed ML-STD-202G
<b>Shock</b>	75G's 10 milliseconds 3-axis
<b>Piston Actuator</b>	Stainless steel with Buna-N O-ring, 200 to 7500 psig
<b>Mechanical Life Piston Design</b>	> 1,000,000 operations typical
<b>Diaphragm Actuator</b>	316L SS, up to 100 psig
<b>Mechanical Life Diaphragm Design</b>	> 400,000 operations typical
<b>Enclosure Material</b>	316L SS
<b>Enclosure Rating</b>	NEMA 6, IP 67
<b>Pressure Connection</b>	1/4" NPT Male
<b>Electrical Output</b>	SPDT 3A @ 125 VAC / 2A @ 30VDC resistive
<b>Electrical Termination</b>	1/2" NPT Male conduit connection or Micro DIN 175301-803C with mating connector
<b>Agency Approvals</b>	UL (#E320431) cable version only, CSA, CE, RoHS

## MPS25 Series Mechanical Pressure Switch Performance Characteristics

Part Number	Setpoint Adjustability			Setpoint Repeatability			Deadband*		
	psig	bar, kg/cm2	kPa	psig	bar, kg/cm2	kPa	psig	bar, kg/cm2	kPa
MPS25-1C-DV15x	-15/15	-1/1	-100/100	±1.5	±0.1	±10	1-5	0.07-0.35	7-35
MPS25-1C-D30x	6-30	0.4-2	4-200	±1.5	±0.1	±10	1-5	0.07-0.35	7-35
MPS25-1C-D60x	8-60	0.6-4	60-400	±3	±0.2	±20	2-10	0.14-0.70	14-70
MPS25-1C-D100x	10-100	0.7-7	70-700	±5	±0.35	±35	3-15	0.2-1.0	20-100
MPS25-1C-P200x	40-200	2.8-14	280-1400	±4	±0.28	±28	3-30	0.2-2.0	20-200
MPS25-1C-P500x	50-500	3.5-35	350-3500	±10	±0.70	±70	20-100	1.4-7.0	140-700
MPS25-1C-P1000x	100-1000	7-70	700-7000	±20	±1.40	±140	25-150	1.7-10	170-1000
MPS25-1C-P2000x	200-2000	14-140	1400-14000	±40	±2.8	±280	30-300	2-20	200-2000
MPS25-1C-P5000x	500-5000	35-350	3500-35000	±100	±7.0	±700	75-750	5-50	500-5000
MPS25-1C-P7500x	750-7500	50-500	5000-50000	±150	±10.0	±1000	110-1100	7.5-75	750-7500

\* Due to the mechanical design of the MPS25 switch, the actual deadband will vary from one switch to another but will be within the specified deadband range. Generally, the expected deadband for a setpoint at the lower end of the range will trend towards the lower end for the deadband range. The deadband for a setpoint at the upper end of the range will trend towards the upper end for the deadband range.

## Material & Temperature

Ranges	Wetted Material	Temperature Range
Up to 100#	SS	-40-100°C (-40-212°F)
200#	SS, BUNA	-28-100°C (-18.4-212°F)
500# to 7500#	SS, BUNA	-40-100°C (-40-212°F)

## Proof Pressure

Ranges (listed in psig)	psig	bar, kg/cm2	kPa
Up to 100#	1000	70	7000
200#	2000	140	14000
500 to 2000#	8000	500	55000
5000 to 75000#	15000	1000	100000

## Burst Pressure

Ranges (listed in psig)	psig	bar, kg/cm2	kPa
Up to 100#	>9500	>655	>65500
200#	>10000	>700	>70000
500 to 2000#	>30000	>2100	>210000
5000 to 7500#	>50000	>3500	>350000

## Electrical Connections



1/2" NPT male conduit connector with 6-foot (1.5m) integral cable

Wire Color / Function	
Wire Color	Function
Red	Normally Closed
White	Common
Blue	Normally Open
Green	Ground



DIN 175301-803C L-Connector

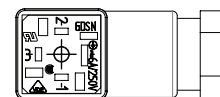

- 1 – COMMON
- 2 – NORMALLY CLOSED
- 3 – NORMALLY OPEN
- 4 – GROUND



# prosense® MPS25 Series Mechanical Pressure Switches

## Actuator Design

The MPS25 series actuator responds to changes in pressure and operates the internal micro switch in response to these changes. The actuator is normally exposed to the process media and must be chemically compatible with it. The MPS25 series is available with a welded stainless steel diaphragm (no O-ring) in pressure ranges up to 100 psig. A stainless steel piston with Buna-N O-ring is available for pressure ranges from 200 to 7500 psig.

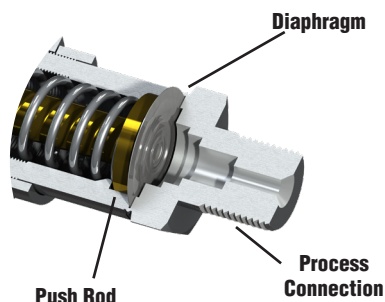

**Diaphragm Actuator Type**  
Up to 100 psig

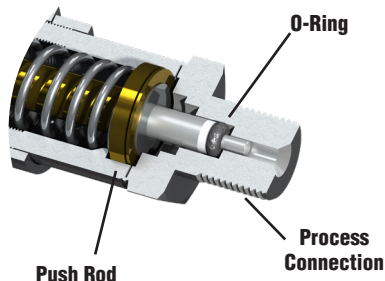

**Piston Actuator Type**  
200 to 7500 psig

## Dimensions

inches [mm]

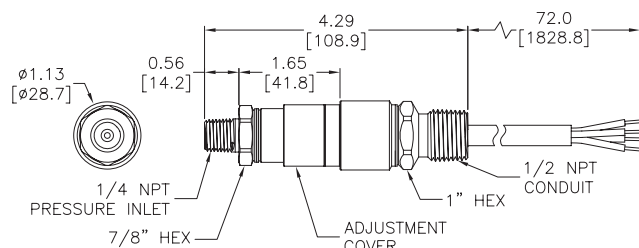

**MPS25 Cable Units**

See our website [www.AutomationDirect.com](http://www.AutomationDirect.com) for complete Engineering drawings.

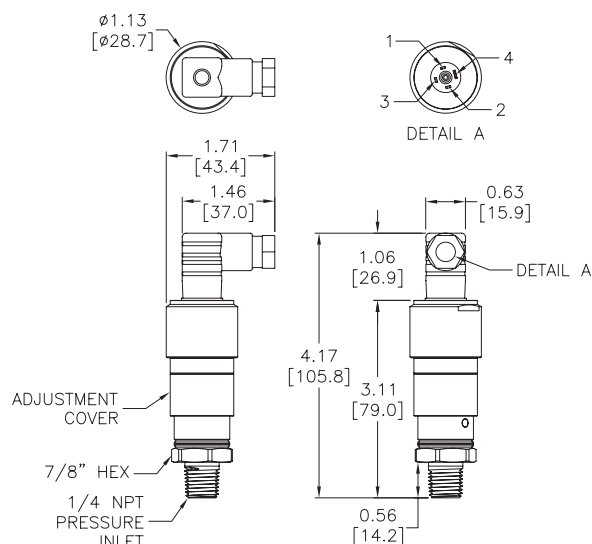

**MPS25 DIN Connector Units**

DIN Connector Specifications	
Number of contacts	3 + PE
Cable glands	PG 7
Conductor size max.	0.75 mm <sup>2</sup> / 18AWG
Type of termination	Screw
Suitable cables	4.5 mm to 6mm
Standard DIN	EN 175 301-803-C

# prosense® MPS25 Series Mechanical Pressure Switches

## Field Adjustable Setpoint

The MPS25 series switches have a field adjustable setpoint. To adjust the setpoint, follow the instructions in the diagram. The pressure switch operates as follows:

The Normally Open contact will close when the pressure is raised from 0 psig to the setpoint. The reset point is then measured from the setpoint, reducing the pressure until the Normally Open contact opens.

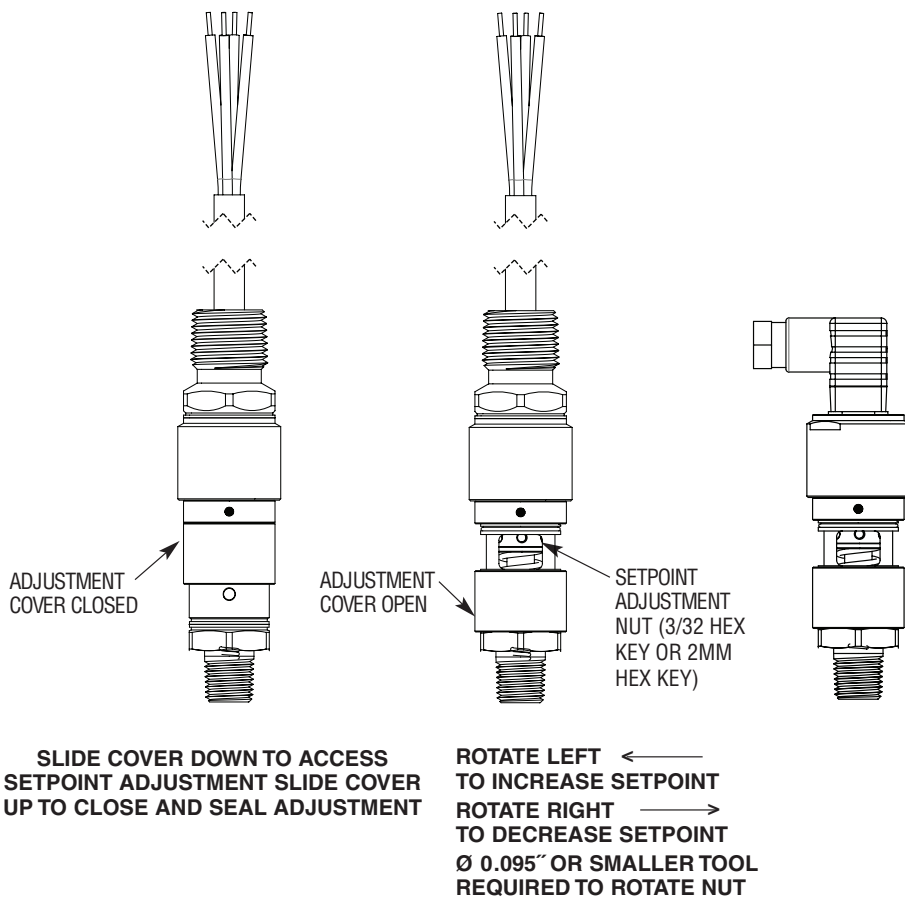

Click on the thumbnail or go to <https://www.automationdirect.com/VID-PR-0005> for a short video on How to Calibrate a MPS Series ProSense Pressure Switch

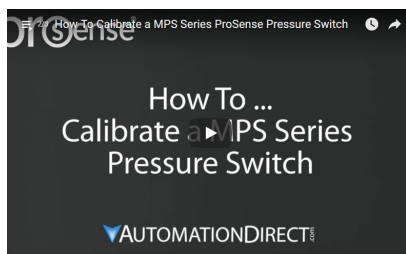

*Note: As with any instrument, it is recommended that regular inspections of operation and set points are performed.*

# prosense®PTD25 Series Pressure Transmitters



The ProSense PTD25 pressure transmitter series is engineered to meet many industrial, commercial, and OEM pressure measurement applications. The ceramic sensing element with Viton seals provides high over pressure ratings and can be used to sense any compatible media. With a robust design resistant to vibration, shock, and EMI/RFI, the PTD25 series provides high accuracy over a wide compensated temperature range. Pressure sensing ranges from vacuum to 5000 psig are available along with a 1/4 inch NPT male threaded process connection. Choose from linear outputs of 4-20 mA or 0-10VDC with a 4-pin M12 quick-disconnect plug electrical connection. The PTD25 series is UL508 listed, CE marked and comes with a 3 year warranty.

## Applications

- Process control & automation
- Pump & compressor control
- Hydraulic systems
- Pneumatic systems
- Engine monitoring
- Presses
- Machine tools

## Features

- Ceramic sensing element with Viton seals
- High over pressure ratings
- Pressure ranges from vacuum to 5000 psig
- 1/4 inch NPT male threaded process connection
- Output options: 4-20 mA or 0-10 VDC
- M12 quick disconnect electrical connection
- UL508 listed, CE marked
- CE marked
- 3-year warranty



**NOTE: CHECK THE CHEMICAL COMPATIBILITY OF THE SENSOR'S WETTED PARTS WITH THE MEDIUM TO BE MEASURED. FOR GASEOUS MEDIA, LIMIT THE PROCESS PRESSURE TO 363 PSIG (25 BAR) MAXIMUM.**

ProSense PTD25 Series Pressure Transmitters				
Part Number	Description	Pcs/Pkg	Wt(lb)	Price
<a href="#"><u>PTD25-10-VH</u></a>	Vacuum transmitter, 10 to 0 V output, -14.5 to 0 psig range vacuum, 1/4" NPT male port	1	0.48	\$151.00
<a href="#"><u>PTD25-10-0100WCH</u></a>	Pressure transmitter, 0 to 10 V output, 0 to 100 inches wc* range, 1/4" NPT male port	1	0.48	\$157.00
<a href="#"><u>PTD25-10-0015H</u></a>	Pressure transmitter, 0 to 10 V output, 0 to 15 psig range, 1/4" NPT male port	1	0.48	\$151.00
<a href="#"><u>PTD25-10-0030H</u></a>	Pressure transmitter, 0 to 10 V output, 0 to 30 psig range, 1/4" NPT male port	1	0.48	\$151.00
<a href="#"><u>PTD25-10-0100H</u></a>	Pressure transmitter, 0 to 10 V output, 0 to 100 psig range, 1/4" NPT male port	1	0.48	\$151.00
<a href="#"><u>PTD25-10-0200H</u></a>	Pressure transmitter, 0 to 10 V output, 0 to 200 psig range, 1/4" NPT male port	1	0.48	\$151.00
<a href="#"><u>PTD25-10-0500H</u></a>	Pressure transmitter, 0 to 10 V output, 0 to 500 psig range, 1/4" NPT male port	1	0.48	\$151.00
<a href="#"><u>PTD25-10-1000H</u></a>	Pressure transmitter, 0 to 10 V output, 0 to 1000 psig range, 1/4" NPT male port	1	0.48	\$151.00
<a href="#"><u>PTD25-10-3000H</u></a>	Pressure transmitter, 0 to 10 V output, 0 to 3000 psig range, 1/4" NPT male port	1	0.48	\$157.00
<a href="#"><u>PTD25-10-5000H</u></a>	Pressure transmitter, 0 to 10 V output, 0 to 5000 psig range, 1/4" NPT male port	1	0.48	\$157.00
<a href="#"><u>PTD25-20-VH</u></a>	Vacuum transmitter, 20 to 4 mA output, -14.5 to 0 psig range vacuum, 1/4" NPT male port	1	0.48	\$151.00
<a href="#"><u>PTD25-20-0100WCH</u></a>	Pressure transmitter, 4 to 20 mA output, 0 to 100 inches wc* range, 1/4" NPT male port	1	0.48	\$157.00
<a href="#"><u>PTD25-20-0015H</u></a>	Pressure transmitter, 4 to 20 mA output, 0 to 15 psig range, 1/4" NPT male port	1	0.48	\$151.00
<a href="#"><u>PTD25-20-0030H</u></a>	Pressure transmitter, 4 to 20 mA output, 0 to 30 psig range, 1/4" NPT male port	1	0.48	\$151.00
<a href="#"><u>PTD25-20-0100H</u></a>	Pressure transmitter, 4 to 20 mA output, 0 to 100 psig range, 1/4" NPT male port	1	0.48	\$151.00
<a href="#"><u>PTD25-20-0200H</u></a>	Pressure transmitter, 4 to 20 mA output, 0 to 200 psig range, 1/4" NPT male port	1	0.48	\$151.00
<a href="#"><u>PTD25-20-0500H</u></a>	Pressure transmitter, 4 to 20 mA output, 0 to 500 psig range, 1/4" NPT male port	1	0.48	\$151.00
<a href="#"><u>PTD25-20-1000H</u></a>	Pressure transmitter, 4 to 20 mA output, 0 to 1000 psig range, 1/4" NPT male port	1	0.48	\$151.00
<a href="#"><u>PTD25-20-3000H</u></a>	Pressure transmitter, 4 to 20 mA output, 0 to 3000 psig range, 1/4" NPT male port	1	0.48	\$157.00
<a href="#"><u>PTD25-20-5000H</u></a>	Pressure transmitter, 4 to 20 mA output, 0 to 5000 psig range, 1/4" NPT male port	1	0.48	\$157.00

\*wc = water column

# prosense® PTD25 Pressure Transmitters

ProSense PTD25 Series General Specifications	
<b>Housing Material</b>	Stainless steel (316S12); FPM (Viton); PA; EPDM/X (Santoprene)
<b>Materials (wetted parts)*</b>	Stainless steel (303S22); ceramics; FPM (Viton)
<b>Operating Temperature</b>	-13 to 176°F (-25 to 80°C)
<b>Medium Temperature</b>	-13 to 194°F (-25 to 90°C)
<b>Storage Temperature</b>	-40 to 212°F (-40 to 100°C)
<b>Protection</b>	IP 68 / IP 69K (Units with pressure range 1000 psig and higher)
<b>Protection</b>	IP 65 (Units with pressure range 500 psig and lower)
<b>Protection Class</b>	Class III 
<b>Accuracy</b>	< ± 0.75% of full range
<b>Repeatability</b>	< ± 0.15% of full range
<b>Insulation Resistance</b>	> 100 MΩ: (500V DC)
<b>Shock Resistance</b>	50g (DIN / IEC 68-2-27, 11ms)
<b>Vibration Resistance</b>	20g (DIN / IEC 68-2-6, 10 - 2000 Hz)
<b>EMC</b>	
<b>EN 61000-4-2 ESD</b>	4 kV / 8 kV AD
<b>EN 61000-4-3 HF Radiated</b>	30 V/m
<b>EN 61000-4-4 Burst</b>	2 kV
<b>EN 61000-4-6 HF Conducted</b>	10 V
<b>EMC (PTD25-20-xxxx)</b>	
<b>EN 61000-4-2 ESD</b>	4 kV / 8 kV AD
<b>EN 61000-4-3 HF Radiated</b>	30 V/m
<b>EN 61000-4-4 Burst</b>	2 kV
<b>EN 61000-4-6 HF Conducted</b>	10 V
<b>Radiation of Interference</b>	2004/104/EC / CISPR25, according to the road vehicle guideline
<b>Noise Immunity</b>	2004/104/EC / ISO 11452-2, according to the road vehicle guideline
<b>HF Conducted</b>	100 V/m
<b>Pulse Resistance</b>	According to ISO7637-2: Severity level 3
<b>Agency Approvals</b>	cULus (E320431), CE, RoHS
* Not cleaned for oxygen service	

ProSense PTD25 Series Technical Specifications	
Technical Specifications PTD25-10-xxxx	
<b>Operating Voltage PTD25-10-xxxx</b>	16 to 32 VDC <sup>1</sup>
<b>Current Consumption</b>	< 18 mA
<b>Analog Output</b>	0 to 10 V (min/max 0 to 10.5V)
<b>Minimum Load</b>	2000 Ω
<b>Step Response Time Analog Output</b>	3 ms
Technical Specifications PTD25-20-xxxx	
<b>Operating Voltage PTD25-20-xxxx</b>	9.6 to 32 VDC
<b>Analog Output</b>	4 to 20 mA (min/max 3.85 to 22 mA)
<b>Maximum Load</b>	[(supply voltage - 9.6) x 50]Ω For example: [(24 VDC - 9.6) x 50] = 720Ω
<b>Step Response Time Analog Output</b>	3 ms
<b>Radiation of Interference</b>	2004/104/EC / CISPR25, according to the road vehicle guideline
<b>Noise Immunity</b>	2004/104/EC / ISO 11452-2, according to the road vehicle guideline
<b>HF Conducted</b>	100 V/m
<b>Pulse Resistance</b>	According to ISO7637-2: Severity level 3
<sup>1</sup> ) per EN50178, SELV, PELV	
*Note: BFSL = Best Fit Straight Line / FR = Full Range	



**WARNING! AVOID STATIC AND DYNAMIC OVERPRESSURE EXCEEDING THE GIVEN OVERLOAD PRESSURE.**  
**EXCEEDING THE BURSTING PRESSURE FOR EVEN A SHORT TIME CAN CAUSE DESTRUCTION OF THE UNIT AND POSSIBLE INJURIES!**

# prosense® PTD25 Pressure Transmitters

## Applications (Type of Pressure: Relative Pressure, Liquids and Gases)

Part Number	Measuring Range	Permissible Overload Pressure	Bursting Pressure
	Psig	Psig	Psig
PTD25-10-5000H PTD25-20-5000H	0 to 5000	11600	17400
PTD25-10-3000H PTD25-20-3000H	0 to 3000	5800	12300
PTD25-10-1000H PTD25-20-1000H	0 to 1000	4350	9400
PTD25-10-0500H PTD25-20-0500H	0 to 500	2175	5075
PTD25-10-0200H PTD25-20-0200H	0 to 200	1087	2175
PTD25-10-0100H PTD25-20-0100H	0 to 100	1087	2175
PTD25-10-0030H PTD25-20-0030H	0 to 30	290	725
PTD25-10-0015H PTD25-20-0015H	0 to 15	145	450
PTD25-10-VH PTD25-20-VH	-14.5 to 0 (vacuum)	145	450
	inH <sub>2</sub> O	inH <sub>2</sub> O	inH <sub>2</sub> O
PTD25-10-0100WCH PTD25-20-0100WCH	0 to 100	2400	12043

inH<sub>2</sub>O = Inches of Water (represents Water Column)

All PTD25 series transmitters can withstand vacuum down to -14.5 psig

## Dimensions

mm [inches]

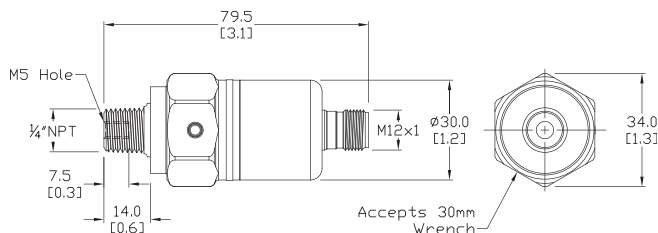

See our website [www.AutomationDirect.com](http://www.AutomationDirect.com) for complete Engineering drawings.

## PTD25-10 Wiring Diagrams

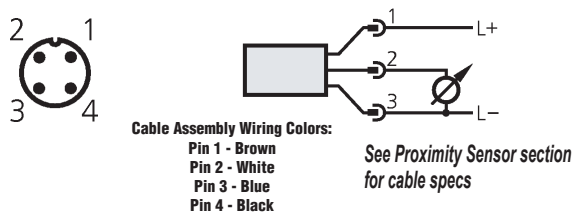

Note: Wiring colors are based on AutomationDirect CD12L and CD12M 4-pole cable assemblies.

## PTD25-20 Wiring Diagrams

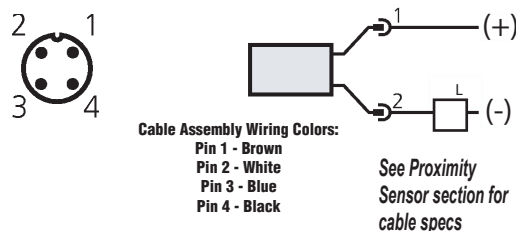

## Pressure Units Conversion Chart

Pressure Conversion Table: Multiplication Factors										
Desired Units	Known Units									
	Atmos	Bars	In of Hg (0°C)	In of H <sub>2</sub> O (4°C)	K grams/meter <sup>2</sup>	Lb/in <sup>2</sup> (psig)	Lb/ft <sup>2</sup>	mm of Hg torr	Pascals	
	Atmos	1	9.86923 x 10 <sup>-1</sup>	3.34207 x 10 <sup>-2</sup>	2.458 x 10 <sup>-3</sup>	9.678 x 10 <sup>-5</sup>	0.068046	4.7254 x 10 <sup>-4</sup>	1.316 x 10 <sup>-3</sup>	9.869 x 10 <sup>-6</sup>
	Bars	1.01325	1	3.3864 x 10 <sup>-2</sup>	2.491 x 10 <sup>-3</sup>	9.8067 x 10 <sup>-5</sup>	6.8948 x 10 <sup>-2</sup>	4.788 x 10 <sup>-4</sup>	1.333 x 10 <sup>-3</sup>	10 <sup>-5</sup>
	In of Hg (0°C)	29.9213	29.53	1	7.355 x 10 <sup>-2</sup>	2.896 x 10 <sup>-3</sup>	2.036	0.014139	3.937 x 10 <sup>-2</sup>	2.953 x 10 <sup>-4</sup>
	In of H <sub>2</sub> O (4°C)	406.8	401.46	13.60	1	3.937 x 10 <sup>-2</sup>	27.68	0.1922	0.5354	4.014 x 10 <sup>-3</sup>
	K grams/meter <sup>2</sup>	1.033227 x 10 <sup>4</sup>	1.0197 x 10 <sup>4</sup>	345.3	25.40	1	7.0306 x 10 <sup>2</sup>	4.882	13.59	1.019 x 10 <sup>-1</sup>
	Lb/in <sup>2</sup> (psig)	14.695595	14.504	0.4912	3.6126 x 10 <sup>-2</sup>	1.423 x 10 <sup>-3</sup>	1	6.9444 x 10 <sup>-3</sup>	1.934 x 10 <sup>-2</sup>	1.450 x 10 <sup>-4</sup>
	Lb/ft <sup>2</sup>	2116.22	2088.5	70.726	5.202	0.2048	144.0	1	2.7844	2.089 x 10 <sup>-2</sup>
	mm of Hg torr	760	750.06	25.400	1.868	7.3558 x 10 <sup>-2</sup>	51.715	0.35913	1	7.502 x 10 <sup>-3</sup>
	Pascals	1.01325 x 10 <sup>5</sup>	1 x 10 <sup>5</sup>	3.386 x 10 <sup>3</sup>	2.491 x 10 <sup>2</sup>	9.8067	6.8948 x 10 <sup>3</sup>	4.788 x 10 <sup>1</sup>	1.333 x 10 <sup>2</sup>	1

Example: To convert from 50 psig to "In of H<sub>2</sub>O", (50 psig) (27.68) = 1384 In of H<sub>2</sub>O



# prosense® SPTD25 Series Pressure Transmitters



Part No. SPTD25-20-0100H



The ProSense SPTD25 pressure transmitter series is engineered to meet many industrial, commercial, and OEM pressure measurement applications. The all-stainless steel thin film sensing element provides very fast response time and can be used to sense any compatible media. With a robust design resistant to vibration, shock, and EMI/RFI, the SPTD25 series provides high accuracy over a wide compensated temperature range. Pressure sensing ranges from 100 to 5000 psig are available with a 1/4 inch NPT male threaded process connection and a linear 4-20 mA output with an M12 quick-disconnect electrical connection.

## Applications

- Process control & automation
- Pump & compressor control
- Hydraulic systems
- Pneumatic systems
- Engine monitoring
- Presses
- Machine tools

## Features

- All-stainless steel sensing element
- Fast response time
- Pressure ranges from 100 to 5000 psig
- 1/4 inch NPT male threaded process connection
- 4-20 mA output
- M12 quick-disconnect electrical connection
- UL508 listed, CE marked
- 3-year warranty



**NOTE: CHECK THE CHEMICAL COMPATIBILITY OF THE SENSOR'S WETTED PARTS WITH THE MEDIUM TO BE MEASURED.**

## ProSense SPTD25 Series Pressure Transmitters

Part Number	Description	Pcs/Pkg	Wt (lb)	Price
<a href="#"><u>SPTD25-20-0100H</u></a>	Pressure transmitter, 4 to 20 mA output, 0 to 100 psig range, 1/4" NPT male port, M12 connector	1	0.1	\$119.00
<a href="#"><u>SPTD25-20-0200H</u></a>	Pressure transmitter, 4 to 20 mA output, 0 to 200 psig range, 1/4" NPT male port, M12 connector	1	0.1	\$119.00
<a href="#"><u>SPTD25-20-0300H</u></a>	Pressure transmitter, 4 to 20 mA output, 0 to 300 psig range, 1/4" NPT male port, M12 connector	1	0.1	\$119.00
<a href="#"><u>SPTD25-20-0500H</u></a>	Pressure transmitter, 4 to 20 mA output, 0 to 500 psig range, 1/4" NPT male port, M12 connector	1	0.1	\$119.00
<a href="#"><u>SPTD25-20-1000H</u></a>	Pressure transmitter, 4 to 20 mA output, 0 to 1000 psig range, 1/4" NPT male port, M12 connector	1	0.1	\$119.00
<a href="#"><u>SPTD25-20-3000H</u></a>	Pressure transmitter, 4 to 20 mA output, 0 to 3000 psig range, 1/4" NPT male port, M12 connector	1	0.1	\$119.00
<a href="#"><u>SPTD25-20-5000H</u></a>	Pressure transmitter, 4 to 20 mA output, 0 to 5000 psig range, 1/4" NPT male port, M12 connector	1	0.1	\$119.00

## ProSense SPTD25 Series General Specifications

<b>Housing Material</b>	Stainless steel 316L (DIN 1.4404); Stainless steel 17-4PH (DIN 1.4542); Polyamide (PA)
<b>Materials (wetted parts)*</b>	Stainless steel 17-4PH (DIN 1.4542)
<b>Operating Temperature</b>	-40 to 194°F (-40 to 90°C)
<b>Medium Temperature</b>	-40 to 194°F (-40 to 90°C)
<b>Storage Temperature</b>	-40 to 212°F (-40 to 100°C)
<b>Protection</b>	IP 67 / IP 69K
<b>Accuracy<sup>1</sup></b>	< ± 0.5% of full range
<b>Linearity<sup>2</sup></b>	< ± 0.1% (BFSL) / < ± 0.2% (LS)
<b>Hysteresis</b>	< ± 0.2%
<b>Repeatability<sup>3</sup></b>	< ± 0.05%
<b>Long-Term Stability<sup>4</sup></b>	< ± 0.1%
* Not cleaned for oxygen service	
<sup>1</sup> Zero point and span error, non-linearity, hysteresis	
<sup>2</sup> BFSL = Best fit straight line / LS = limit value setting	
<sup>3</sup> With temperature fluctuations <10°C	
<sup>4</sup> In % of the span / 6 months	

# prosense® SPTD25 Series Pressure Transmitters

## ProSense SPTD25 Series General Specifications Continued

<b>Operating Voltage</b>	8.5 to 36 VDC*
<b>Analog Output</b>	4 to 20 mA
<b>Maximum Load</b>	$[(\text{supply voltage} - 8.5) / 21.5 \text{ mA}]\Omega$   For example: $[(24\text{VDC} - 8.5) / 0.0215] = 720\Omega$
<b>IEC Protection Class</b>	Class III 
<b>Step Response Time Analog Output</b>	1 ms
<b>Short-Circuit Proof</b>	yes
<b>Overload Protection</b>	yes
<b>Reverse Polarity Protection</b>	yes
<b>Insulation Resistance</b>	> 100 MΩ: (500 VDC)
<b>Shock Resistance</b>	50g (DIN 60068-2-27, 11ms)
<b>Vibration Resistance</b>	20g (DIN 60068-2-6, 10 - 2000 Hz)
<b>EN 61000-4-2 ESD</b>	4 kV / 8 kV AD
<b>EN 61000-4-3 HF Radiated</b>	30 V/m
<b>EN 61000-4-4 Burst</b>	2kV
<b>EN 61000-4-6 HF Conducted</b>	10V
<b>EC Pressure Equipment Directive 97/23/EC</b>	Article 3, section 3: Group 2 Non-Hazardous, Non-flammable, Non-oxidizing
<b>EMC</b>	DIN EN 61000-6-2; DIN EN 61000-6-3
<b>MTTF (Years)</b>	784
<b>Min. Pressure Cycles</b>	60 million lifetime (at 1.2 times the nominal pressure)
<b>Agency Approvals</b>	cULus (E320431), CE, RoHS
* per EN50178, SELV, PELV	



**WARNING! AVOID STATIC AND DYNAMIC OVERPRESSURE EXCEEDING THE GIVEN OVERLOAD PRESSURE.**

**EXCEEDING THE BURSTING PRESSURE FOR EVEN A SHORT TIME CAN CAUSE DESTRUCTION OF THE UNIT AND POSSIBLE INJURIES!**

## Dimensions

mm [inches]

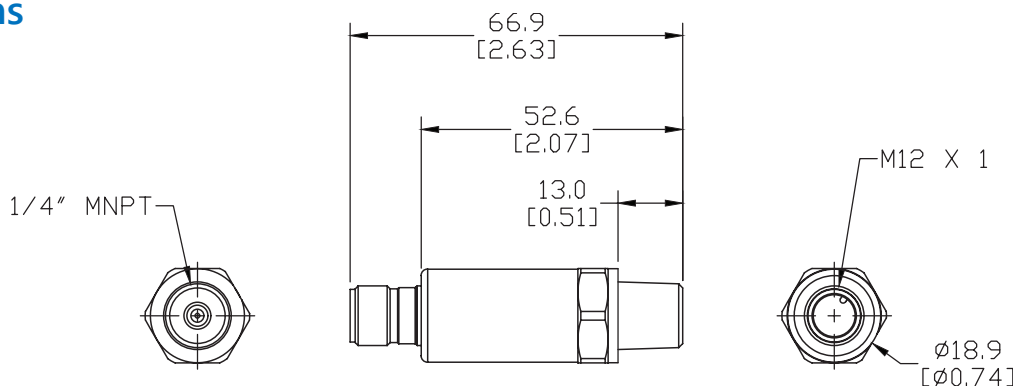

See our website [www.AutomationDirect.com](http://www.AutomationDirect.com) for complete Engineering drawings.

# pro<sup>ense</sup>® SPTD25 Series Pressure Transmitters

## Pressure Ratings

Applications (Type of Pressure: Gauge Pressure, Liquids and Gases)			
Part Number	Final Value of the Measuring Range	Static Proof Pressure Resistance (Max. Permissible Pressure)	Bursting Pressure
	Psig	Psig	Psig
<a href="#">SPTD25-20-0100H</a>	100	250	2900
<a href="#">SPTD25-20-0200H</a>	200	580	6525
<a href="#">SPTD25-20-0300H</a>	300	940	8700
<a href="#">SPTD25-20-0500H</a>	500	1450	11600
<a href="#">SPTD25-20-1000H</a>	1000	2500	13050
<a href="#">SPTD25-20-3000H</a>	3000	7250	14500
<a href="#">SPTD25-20-5000H</a>	5000	14500	24650

All SPTD25 series transmitters can withstand vacuum down to -14.5 psig



**WARNING! AVOID STATIC AND DYNAMIC OVERPRESSURE EXCEEDING THE GIVEN OVERLOAD PRESSURE.**

**EXCEEDING THE BURSTING PRESSURE FOR EVEN A SHORT TIME CAN CAUSE DESTRUCTION OF THE UNIT AND POSSIBLE INJURIES!**

## Current Output 4-20 mA

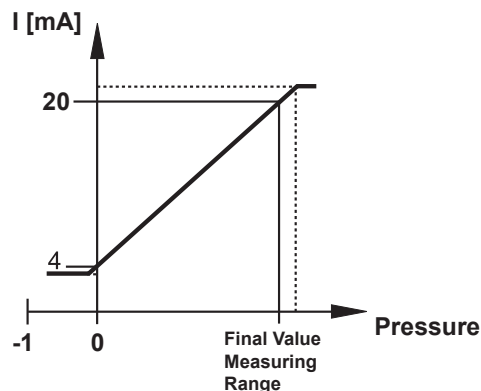

In the measuring range the output signal is between 4 and 20mA. If the system pressure is above or below the measuring range, the analog output performs as follows:

- System pressure above the measuring range: 20...25mA non-linear
- System pressure below the measuring range: 4...3mA non-linear

## SPTD25-20 Wiring Diagrams

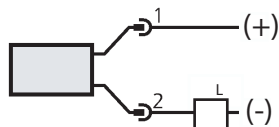

Cable Assembly Wiring Colors:

Pin 1 - Brown +

Pin 2 - White - Out

Pin 3 - Blue, not used

Pin 4 - Black, not used

See Proximity Sensor section for cable specs

Note: Wiring colors are based on AutomationDirect CD12L and CD12M 4-pole cable assemblies.

# prosense® SPT25 Series Pressure Transmitters



## Applications

- Process control & automation
- Pump & compressor control
- Hydraulic systems
- Pneumatic systems
- Engine monitoring
- Refrigeration equipment
- Presses
- Machine tools

The ProSense SPT25 pressure transmitter series is engineered to meet many industrial, commercial, and OEM pressure measurement applications. The all stainless steel welded thin film sensing element provides very fast response time and is compatible with many different media sensing applications. With a robust design resistant to vibration, shock, and EMI/RFI, the SPT25 series provides high accuracy over a wide compensated temperature range. Pressure sensing ranges from vacuum to 5000 psig are available along with a 1/4 inch NPT male threaded process connection. Choose from linear outputs of 4-20 mA or 0-10VDC with electrical connections of either a DIN 175301-803C L-connector or 6.6 foot (2 m) integral shielded cable.

## Features

- All stainless steel welded sensing element
- Fast response time
- Pressure sensing ranges from vacuum to 5000 psig
- 1/4 inch NPT male threaded process connection
- Output options: 4-20 mA or 0-10 VDC
- Integral 6.6 foot shielded cable or DIN form C electrical connections
- Made in the USA
- CE marked
- 3-year warranty



Click on the thumbnail or go to <https://www.automationdirect.com/VID-PR-0001> for a short video on ProSense Air Differential and Pressure Transmitters



ProSense SPT25 Series Pressure Transmitters (Shielded Cable)					
Part Number	Description	Electrical Connection	Input Voltage	Wt(lb)	Price
<a href="#">SPT25-20-V30A</a>	Pressure transmitter, 4 to 20 mA output, -14.7 vacuum to 30 psig range, 1/4" NPT male port	Integral 6.6 ft (2m) shielded cable	9 - 36 VDC	0.38	\$160.00
<a href="#">SPT25-20-0030A</a>	Pressure transmitter, 4 to 20 mA output, 0 to 30 psig range, 1/4" NPT male port				\$160.00
<a href="#">SPT25-20-0060A</a>	Pressure transmitter, 4 to 20 mA output, 0 to 60 psig range, 1/4" NPT male port				\$160.00
<a href="#">SPT25-20-0100A</a>	Pressure transmitter, 4 to 20 mA output, 0 to 100 psig range, 1/4" NPT male port				\$160.00
<a href="#">SPT25-20-0150A</a>	Pressure transmitter, 4 to 20 mA output, 0 to 150 psig range, 1/4" NPT male port				\$160.00
<a href="#">SPT25-20-0200A</a>	Pressure transmitter, 4 to 20 mA output, 0 to 200 psig range, 1/4" NPT male port				\$160.00
<a href="#">SPT25-20-0300A</a>	Pressure transmitter, 4 to 20 mA output, 0 to 300 psig range, 1/4" NPT male port				\$160.00
<a href="#">SPT25-20-0500A</a>	Pressure transmitter, 4 to 20 mA output, 0 to 500 psig range, 1/4" NPT male port				\$160.00
<a href="#">SPT25-20-1000A</a>	Pressure transmitter, 4 to 20 mA output, 0 to 1000 psig range, 1/4" NPT male port				\$160.00
<a href="#">SPT25-20-1500A</a>	Pressure transmitter, 4 to 20 mA output, 0 to 1500 psig range, 1/4" NPT male port				\$160.00
<a href="#">SPT25-20-2000A</a>	Pressure transmitter, 4 to 20 mA output, 0 to 2000 psig range, 1/4" NPT male port				\$160.00
<a href="#">SPT25-20-3000A</a>	Pressure transmitter, 4 to 20 mA output, 0 to 3000 psig range, 1/4" NPT male port				\$160.00
<a href="#">SPT25-20-5000A</a>	Pressure transmitter, 4 to 20 mA output, 0 to 5000 psig range, 1/4" NPT male port				\$160.00
<a href="#">SPT25-10-V30A</a>	Pressure transmitter, 0 to 10 V output, -14.7 vacuum to 30 psig range, 1/4" NPT male port		14 - 36 VDC		\$160.00
<a href="#">SPT25-10-0030A</a>	Pressure transmitter, 0 to 10 V output, 0 to 30 psig range, 1/4" NPT male port				\$160.00
<a href="#">SPT25-10-0060A</a>	Pressure transmitter, 0 to 10 V output, 0 to 60 psig range, 1/4" NPT male port				\$160.00
<a href="#">SPT25-10-0100A</a>	Pressure transmitter, 0 to 10 V output, 0 to 100 psig range, 1/4" NPT male port				\$160.00
<a href="#">SPT25-10-0150A</a>	Pressure transmitter, 0 to 10 V output, 0 to 150 psig range, 1/4" NPT male port				\$160.00
<a href="#">SPT25-10-0200A</a>	Pressure transmitter, 0 to 10 V output, 0 to 200 psig range, 1/4" NPT male port				\$160.00
<a href="#">SPT25-10-0300A</a>	Pressure transmitter, 0 to 10 V output, 0 to 300 psig range, 1/4" NPT male port				\$160.00
<a href="#">SPT25-10-0500A</a>	Pressure transmitter, 0 to 10 V output, 0 to 500 psig range, 1/4" NPT male port				\$160.00
<a href="#">SPT25-10-1000A</a>	Pressure transmitter, 0 to 10 V output, 0 to 1000 psig range, 1/4" NPT male port				\$160.00
<a href="#">SPT25-10-1500A</a>	Pressure transmitter, 0 to 10 V output, 0 to 1500 psig range, 1/4" NPT male port				\$160.00
<a href="#">SPT25-10-2000A</a>	Pressure transmitter, 0 to 10 V output, 0 to 2000 psig range, 1/4" NPT male port				\$160.00
<a href="#">SPT25-10-3000A</a>	Pressure transmitter, 0 to 10 V output, 0 to 3000 psig range, 1/4" NPT male port				\$160.00
<a href="#">SPT25-10-5000A</a>	Pressure transmitter, 0 to 10 V output, 0 to 5000 psig range, 1/4" NPT male port				\$160.00

# proSense® SPT25 Series Pressure Transmitters

## ProSense SPT25 Series Pressure Transmitters (DIN Connector)

Part Number	Description	Electrical Connection	Input Voltage	Wt(lb)	Price
<a href="#">SPT25-20-V30D</a>	Pressure transmitter, 4 to 20 mA output, -14.7 vacuum to 30 psig range, 1/4" NPT male port	DIN 175301-803C L-connector	9 - 36 VDC	0.30	\$154.00
<a href="#">SPT25-20-0030D</a>	Pressure transmitter, 4 to 20 mA output, 0 to 30 psig range, 1/4" NPT male port				\$154.00
<a href="#">SPT25-20-0060D</a>	Pressure transmitter, 4 to 20 mA output, 0 to 60 psig range, 1/4" NPT male port				\$154.00
<a href="#">SPT25-20-0100D</a>	Pressure transmitter, 4 to 20 mA output, 0 to 100 psig range, 1/4" NPT male port				\$154.00
<a href="#">SPT25-20-0150D</a>	Pressure transmitter, 4 to 20 mA output, 0 to 150 psig range, 1/4" NPT male port				\$154.00
<a href="#">SPT25-20-0200D</a>	Pressure transmitter, 4 to 20 mA output, 0 to 200 psig range, 1/4" NPT male port				\$154.00
<a href="#">SPT25-20-0300D</a>	Pressure transmitter, 4 to 20 mA output, 0 to 300 psig range, 1/4" NPT male port				\$154.00
<a href="#">SPT25-20-0500D</a>	Pressure transmitter, 4 to 20 mA output, 0 to 500 psig range, 1/4" NPT male port				\$154.00
<a href="#">SPT25-20-1000D</a>	Pressure transmitter, 4 to 20 mA output, 0 to 1000 psig range, 1/4" NPT male port				\$154.00
<a href="#">SPT25-20-1500D</a>	Pressure transmitter, 4 to 20 mA output, 0 to 1500 psig range, 1/4" NPT male port				\$154.00
<a href="#">SPT25-20-2000D</a>	Pressure transmitter, 4 to 20 mA output, 0 to 2000 psig range, 1/4" NPT male port				\$154.00
<a href="#">SPT25-20-3000D</a>	Pressure transmitter, 4 to 20 mA output, 0 to 3000 psig range, 1/4" NPT male port				\$154.00
<a href="#">SPT25-20-5000D</a>	Pressure transmitter, 4 to 20 mA output, 0 to 5000 psig range, 1/4" NPT male port				\$154.00
<a href="#">SPT25-10-V30D</a>	Pressure transmitter, 0 to 10 V output, -14.7 vacuum to 30 psig range, 1/4" NPT male port		14 - 36 VDC		\$154.00
<a href="#">SPT25-10-0030D</a>	Pressure transmitter, 0 to 10 V output, 0 to 30 psig range, 1/4" NPT male port				\$154.00
<a href="#">SPT25-10-0060D</a>	Pressure transmitter, 0 to 10 V output, 0 to 60 psig range, 1/4" NPT male port				\$154.00
<a href="#">SPT25-10-0100D</a>	Pressure transmitter, 0 to 10 V output, 0 to 100 psig range, 1/4" NPT male port				\$154.00
<a href="#">SPT25-10-0150D</a>	Pressure transmitter, 0 to 10 V output, 0 to 150 psig range, 1/4" NPT male port				\$154.00
<a href="#">SPT25-10-0200D</a>	Pressure transmitter, 0 to 10 V output, 0 to 200 psig range, 1/4" NPT male port				\$154.00
<a href="#">SPT25-10-0300D</a>	Pressure transmitter, 0 to 10 V output, 0 to 300 psig range, 1/4" NPT male port				\$154.00
<a href="#">SPT25-10-0500D</a>	Pressure transmitter, 0 to 10 V output, 0 to 500 psig range, 1/4" NPT male port				\$154.00
<a href="#">SPT25-10-1000D</a>	Pressure transmitter, 0 to 10 V output, 0 to 1000 psig range, 1/4" NPT male port				\$154.00
<a href="#">SPT25-10-1500D</a>	Pressure transmitter, 0 to 10 V output, 0 to 1500 psig range, 1/4" NPT male port				\$154.00
<a href="#">SPT25-10-2000D</a>	Pressure transmitter, 0 to 10 V output, 0 to 2000 psig range, 1/4" NPT male port				\$154.00
<a href="#">SPT25-10-3000D</a>	Pressure transmitter, 0 to 10 V output, 0 to 3000 psig range, 1/4" NPT male port				\$154.00
<a href="#">SPT25-10-5000D</a>	Pressure transmitter, 0 to 10 V output, 0 to 5000 psig range, 1/4" NPT male port				\$154.00

### 0 to 10 VDC Output Wiring Diagram

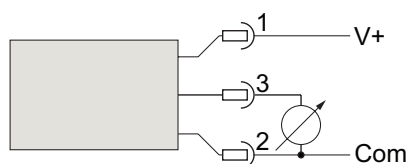

With DIN Connector

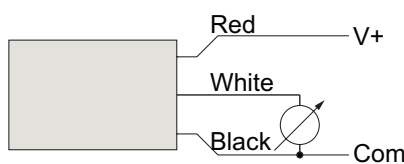

With Integral Cable

### 4 to 20 mA Output Wiring Diagrams

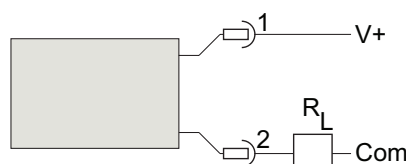

With DIN Connector

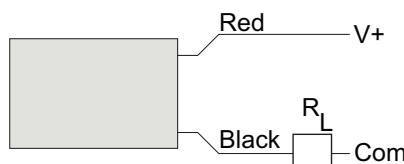

With Integral Cable

### Shielded Cable Models Wire Designation

Wire Color	0 - 10 VDC Output	4 - 20 mA Output
Red	V +	V +
Black	Com	Output
White	Output	None
Bare*	Shield Drain Wire	Shield Drain Wire

\* Where shielded wiring is being used; Connect the drain wire to the guard terminal on the read out device or measuring instrument if available. In all other cases connect to the power supply negative terminal.

### DIN Form C Models Pin Designation

Pin No.	0 - 10 VDC Output	4 - 20 mA Output
1	V+	V+
2	Com	Output
3	Output	None
4	Case Ground	Case Ground



# prosense® SPT25 Series Pressure Transmitters

## ProSense SPT25 Series General Specifications

<b>Housing Material</b>	20% Glass Reinforced Nylon, Fire retardant to UL94 V1 / 304 Series Stainless steel
<b>Materials (wetted parts)**</b>	304 Series Stainless steel / 17-4PH Stainless Steel
<b>Operating Temperature</b>	-40 to 257°F (-40 to 125°C)
<b>Medium Temperature</b>	-40 to 257°F (-40 to 125°C)
<b>Storage Temperature</b>	-40 to 257°F (-40 to 125°C)
<b>Protection</b>	IP 67 for cabled models IP 65 For DIN connector models
<b>Accuracy*</b>	± 0.50% of full range
<b>Temperature Coefficient</b>	0.15% of full range / 10°F (0.25% of full range / 10°C)
<b>Reference Temperature</b>	70°F ± 1°F (21°C ± 1°C)
<b>Compensated Temperature</b>	-4 to 185°F (-20 to 85°C)
<b>Insulation Resistance</b>	Greater than 100 megohms at 100 VDC
<b>Shock Resistance</b>	100 gs, 6 ms
<b>Vibration Resistance</b>	Random vibration (20 g) over temperature range (-40° to 125°C). Exceeds typical MIL-STD. requirements
<b>Drop Test</b>	Withstands 1 meter on concrete 3 axis
<b>Response Time</b>	Less than 1 msec
<b>Warm-up time</b>	Less than 500 msec
<b>Position Effect</b>	Less than ±0.01% span, typical
<b>Insulation Breakdown Voltage</b>	100 VAC
<b>Reverse Polarity &amp; Miswired Protected</b>	Yes
<b>Durability</b>	Tested to 50 million cycles
<b>Humidity</b>	0 to 100% R.H., no effect
<b>Stability</b>	Less than ±0.25% full range / year
<b>Agency Approvals</b>	CE
<i>*Note - Includes non-linearity, hysteresis &amp; non-repeatability.</i>	
<i>** Not cleaned for oxygen service</i>	

## DIN Connector Specifications

<b>Number of contacts</b>	3 + PE
<b>Cable glands</b>	PG 7
<b>Conductor size max.</b>	0.75 mm² / 18AWG
<b>Type of termination</b>	Screw
<b>Suitable cables</b>	4.5 mm to 6mm
<b>Standard DIN</b>	EN 175 301-803-C

## ProSense SPT25 Series Technical Specifications

Technical Specifications SPT25-20-xxxx	
<b>Operating Voltage</b>	9 – 36 VDC
<b>Analog Output</b>	4 – 20 mA
<b>Maximum Load</b>	Determine Maximum Loop Resistances $\frac{V_L - 9 \text{ VDC}}{0.022 \text{ amps}} = R_L$ For example $[(24 \text{ VDC} - 9 \text{ VDC}) / 0.022 \text{ amps}] = 681\Omega$
Technical Specifications SPT25-10-xxxx	
<b>Operating Voltage</b>	14 – 36 VDC
<b>Current Consumption</b>	4 mA
<b>Minimum Load</b>	10 kΩ

Power Supply Voltage vs Loop Resistance

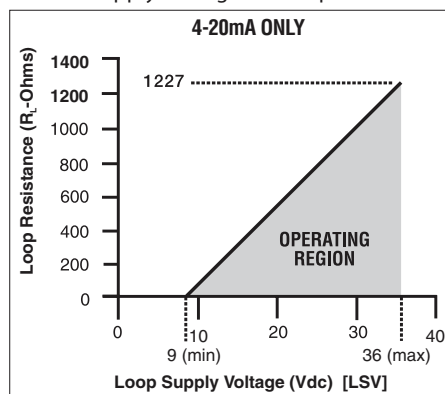

## ProSense SPT25 Proof & Burst Pressures

	Proof	Burst
<b>500 psig &amp; below</b>	200% full scale	1000% full scale
<b>1000 – 2000 psig</b>	200% full scale	500% full scale
<b>3000 psig</b>	200% full scale	500% full scale
<b>5000 psig</b>	150% full scale	500% full scale

See our website [www.AutomationDirect.com](http://www.AutomationDirect.com) for complete Engineering drawings.

## Dimensions

inches [mm]

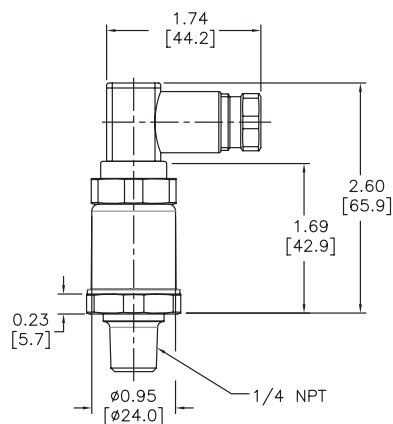

DIN Connector Models

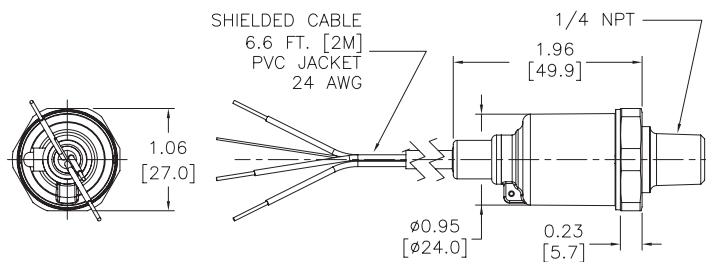

Shielded Cable Models



# DPTW Series Differential Pressure Transmitters

## Overview



The ProSense DPTW differential pressure transmitter series is precision engineered for accurate differential or gauge pressure measurement. The wet-wet design uses a silicon based variable capacitance sensor with stainless steel media isolation diaphragms and silicone pressure transmission fluid making it compatible with a wide variety of liquids, gases, and steam applied to both pressure sensing ports. The DPTW series is ideal for industrial, commercial, and OEM process measurement applications including differential, positive, or negative pressures; hydrostatic liquid level in pressurized or open tanks; and flow measurement using primary differential pressure flow elements such as an annular pitot tube, orifice plate or venturi tube. The DPTW series is available in pressure measurement ranges from 4 inches water column up to 400 inches water column with static (line) proof pressure of 300 psig and can easily be rescaled to a different linear pressure range and units of measure using display pushbuttons. An integral square root function also allows for the display and output of flow in instantaneous flow rate units of measure such as gallons/minute or display of integrated flow volume in units such as gallons. The integral pressure port manifold has 1/4-inch NPT female process pressure connections and includes a built-in equalizing valve used to open both ports to the line pressure during installation to prevent sensor damage or calibration shift due to overpressure. The DPTW series is powered with nominal 24VDC power and provides a two-wire, 4-20mA output signal proportional to the measured pressure. The very compact design of the DPTW series is up to 8-times smaller than conventional style DP transmitters and features a rugged NEMA 4X (IP65) rated aluminum die cast housing and rotatable 6-digit LCD display with bright LED backlight.

## Features

- Wet-wet design ideal for liquid, gas, and steam measurement of differential, positive, or negative pressures, hydrostatic liquid level, and flow
- Integral pressure port manifold with 1/4 inch female process connections and built-in equalizing valve
- Digital filter function to dampen pulsations and provide a more stable output and display
- Key lock function to prevent unauthorized changes to configuration settings
- Bright backlit 6-digit LCD display
- Scaling function allows display to indicate user defined units of measure
- Internal "pushbutton" configurability allows quick range changes
- "Loop check" function allows unit to output 4-20 mA without applying pressure
- Square root extraction function for display and output of linear flow rate or display of integrated flow volume
- Up to 8X smaller than a conventional style DP transmitter
- Easily rotatable display, 90° increments
- Rugged NEMA 4X (IP65) aluminum die cast housing
- 3 year warranty



## Applications

- Pressurized and non-pressurized tank levels
- Flow measurement (liquid / gas / steam)
- Pollution monitoring equipment
- Filter monitoring
- Pressure across flue gas duct
- Furnace combustion airflow rate
- Pump speed control
- Valve pressure drop monitoring

## DPTW Series Differential Pressure Transmitter

Part Number	Description	Measuring Range	Output	Process Connection	Operating Voltage	Wt(lb)	Price	Drawing Link
<a href="#"><u>DPTW-4</u></a>	ProSense differential pressure transmitter	0 to 4in of water column	4-20mA	1/4in female NPT process connection	12-32 VDC	1.0 lb	\$897.00	<a href="#"><u>PDF</u></a>
<a href="#"><u>DPTW-8</u></a>		0 to 8in of water column					\$897.00	<a href="#"><u>PDF</u></a>
<a href="#"><u>DPTW-20</u></a>		0 to 20in of water column					\$897.00	<a href="#"><u>PDF</u></a>
<a href="#"><u>DPTW-40</u></a>		0 to 40in of water column					\$897.00	<a href="#"><u>PDF</u></a>
<a href="#"><u>DPTW-80</u></a>		0 to 80in of water column					\$897.00	<a href="#"><u>PDF</u></a>
<a href="#"><u>DPTW-200</u></a>		0 to 200in of water column					\$897.00	<a href="#"><u>PDF</u></a>
<a href="#"><u>DPTW-400</u></a>		0 to 400in of water column					\$897.00	<a href="#"><u>PDF</u></a>



# DPTW Series Differential Pressure Transmitters

DPTW Series Specifications	
Performance Specifications	
Reference Temperature	73°F (23°C)
Accuracy	± 0.50% of span (URL*) Includes the effects of linearity, hysteresis, and repeatability
Display Accuracy	± 0.5% of span (URL) + 1 digit
Stability	± 0.25% of span (URL)/year
Output Resolution	0.1% of span (URL)
Temperature Effects	Temperature Effects: (–10°C to 60°C) ± 0.03% FS/C°
Memory	Permanently stored in EEPROM nonvolatile memory
Environmental Specifications	
Temperature Limits	Storage: 5°F to 150°F (–15°C to 65°C) Operating: 14°F to 140°F (–10°C to 60°C) Medium: 14°F to 140°F (–10°C to 60°C)** Compensated: 14°F to 140°F (–10°C to 60°C)
Functional Specifications	
Rangeability/Adjustment	Zero –10% to 110% Span Span –10% to 110% Span (Accuracy and output resolution based upon full scale (URL) value)
Unit of Measure	inH <sub>2</sub> O (IWC) or User defined
Static (Line) Pressure	Pressure Range: 4 inH <sub>2</sub> O to 400 inH <sub>2</sub> O Proof: 300 psi Burst: 800 psi
Single Side (Differential)	Pressure Range: ≤ 8 inH <sub>2</sub> O Proof: 30 psid Burst: 130 psid  Pressure Range: ≥ 20 inH <sub>2</sub> O Proof: 100 psid Burst: 130 psid
Static (Line) Pressure Effects	Pressure Range:      Effect: ≥ 20 inH <sub>2</sub> O            ± 0.3% Range/100 psi (URL) 8 inH <sub>2</sub> O                ± 0.7% Range/100 psi (URL) 4 inH <sub>2</sub> O                ± 1.5% Range/100 psi (URL)
Response Time	100ms (when Filter Function set to 0)
Filter Function	0, 2, 4, 8, or 16 seconds
Vibration	5g's 150Hz
Shock Effect	10g's 16ms
Electrical Specifications	
Output Signal	4-20 mA (2 Wire)
Load Impedance	545Ω @ 24VDC (refer to Load Limitations graph)
Supply Voltage	12-32 Vdc
Insulation Resistance	50Vdc (>100 MΩ)
EMC Compliance	EMC Directive 2014/30/EU EN 61326-1:2013 EN 61326-2-3:2013 (EMI Class A/EMS Table 2)

\* Upper Range Limit (URL)

\*\* For steam or other higher temperature processes, ensure that the temperature at the DPTW process connections do not exceed the Medium Temperature Limits. For steam use longer sensing lines and/or a siphon (pigtail) and fill with water to lower the medium temperature to acceptable limits.

# DPTW Series Differential Pressure Transmitters

DPTW Series Specifications	
Physical Specifications	
Environmental Rating	IP65 / NEMA 4X
Mounting	Mounting bracket included
Process Connections	Manifold with 1/4 NPT Female ports and equalizing valve
Display	6-digit LCD with LED backlight, 10mm character height
Display Update	500ms
Electrical Connection	1/2 NPT Female Preinstalled Cable Gland (Cable diameters 0.35" to 0.47") Terminal block: 14-22 AWG stranded or solid wire
Wetted Material	
Diaphragm	316 SS, Viton® & Alumina Ceramic
Process Connection	316 SS
Media Compatibility	Fluids and gases compatible with 316 SS, Viton® and Alumina Ceramic
Non-Wetted Material	
Enclosure	Aluminum, epoxy coated

## Wiring

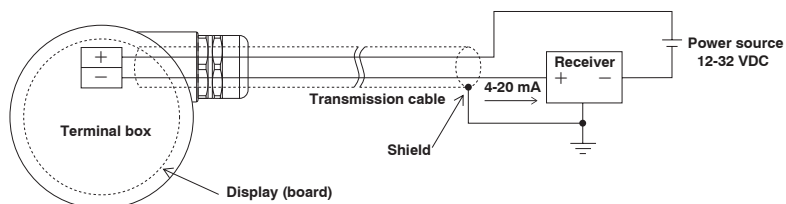

## Display and Keypad

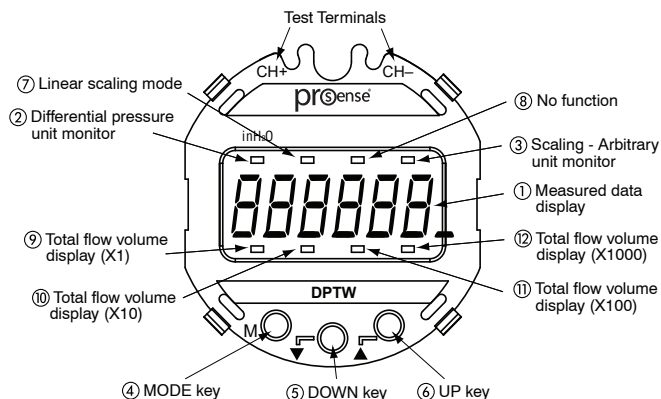

DESIGNATION	FUNCTION
① Measured data display	Differential pressure, linear scaling value are displayed.
② Differential pressure unit monitor	When this unit monitor is ON, the differential pressure (inH <sub>2</sub> O) is indicated on the measured data display.
③ Scaling; arbitrary unit monitor	When this unit monitor is ON, the scaling value of an arbitrary unit (linear scaling), is indicated on the measured data display.
④ MODE key (M)	This key is used to switch the setting mode and the measurement mode and to change the setting item.
⑤ DOWN key	This key is used to change (decrease) and select the set value.
⑥ UP key	This key is used to change (increase) and select the set value and to shift from the measurement mode to the zero adjustment mode.

DESIGNATION	FUNCTION
⑦ Linear scaling mode	Used to adjust zero/span values to 4-20mA output signal.
⑧ No function	None
⑨ to ⑫ Total flow volume display	Display multiplier, X1, X10, X100, X1000

## Load Limitations 4–20mA Output

Loop Resistance (Ω)

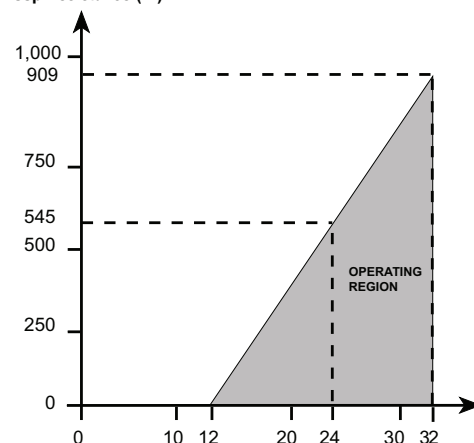

LOOP SUPPLY VOLTAGE

$$V_{\min} = 12V + [0.022A \cdot (R_L)]$$

(Includes a 10% safety factor)

$$R_L = R_S + R_W$$

$$R_L = \text{Loop Resistance (ohms)}$$

$$R_S = \text{Sense Resistance (ohms)}$$

$$R_W = \text{Wire Resistance (ohms)}$$



# DPTW Series Differential Pressure Transmitters

## Application Examples

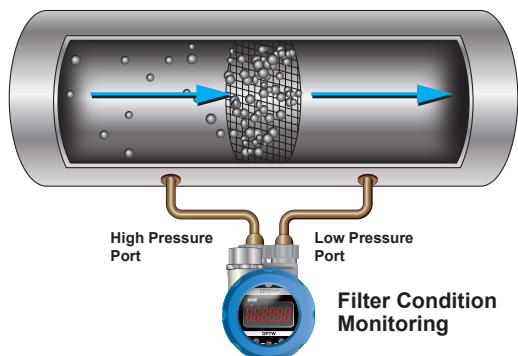
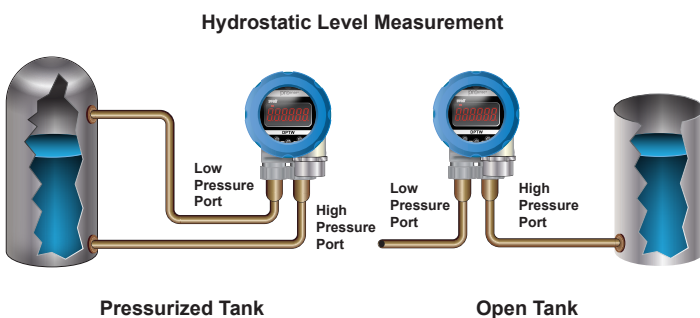
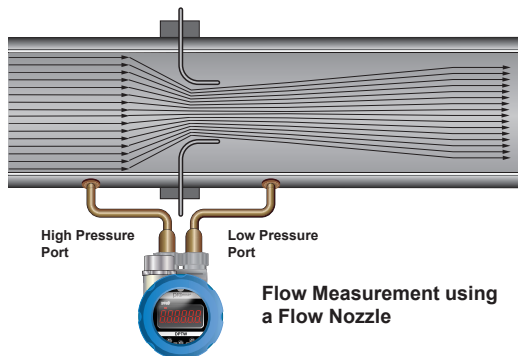
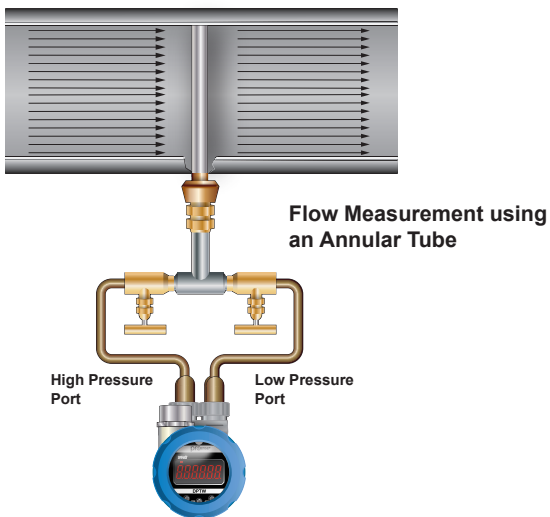
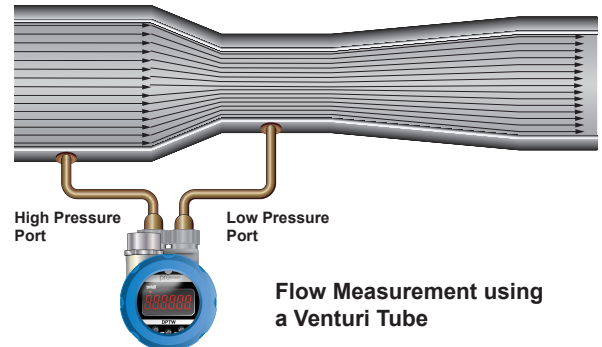
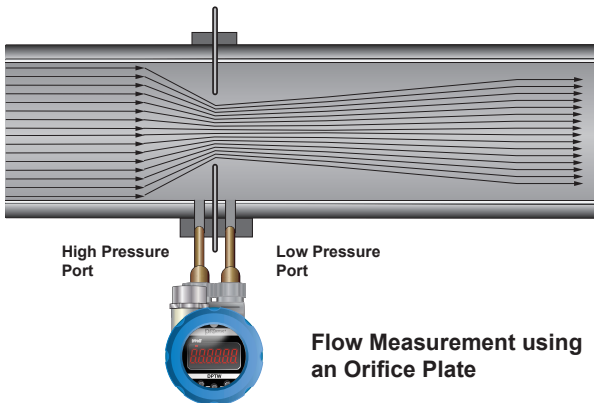

Click on the thumbnail or go to  
<https://www.automationdirect.com/VID-PR-0006> for a short video on the  
 DPTW ProSense Differential Pressure Transmitters

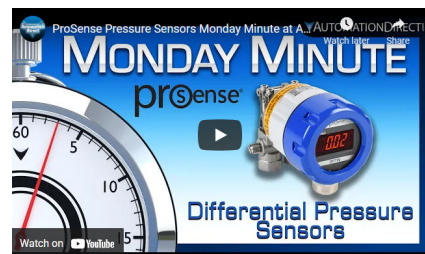



# prosense® DPTA Series Differential Air Pressure Transmitters



The ProSense DPTA differential pressure transmitter series is precision engineered for accurate low differential pressure measurement of air and non-condensing, non-corrosive gases in industrial, commercial, and OEM applications. Its highly reliable, ultra-thin single silicon crystal diaphragm capacitive sensor provides inherent repeatability and stability with no glues or other organics to contribute to drift or mechanical degradation over time. The DPTA series is available in ranges from 0.1 inches w.c. to 25 inches w.c. to measure positive, negative, and bi-directional pressures with the ability to withstand 15 psig overpressure without damage or calibration shift. The easily accessible brass barbed pressure ports, removable terminal blocks, and rugged ABS housing capable of 35 mm DIN rail or panel mounting make installation quick and easy.

## Applications

- HVAC duct static pressure
- Air filter monitoring
- Building pressurization
- Isolation and clean rooms
- Fume hoods
- Furnace, oven, dryer draft pressure
- Air flow measurement

## Features

- Highly stable capacitive sensing element
- Positive, negative, and bi-directional pressure measurement
- Pressure ranges from 0.1" w.c. to 25" w.c.
- Accuracy is +/-1% of full range maximum
- High overpressure rating of 15 psig without damage or calibration shift
- Rugged ABS housing capable of DIN rail or panel mounting
- LED loop power status indicator
- Made in the USA
- CE marked
- 3-year warranty



Click on the thumbnail or go to <https://www.automationdirect.com/VID-PR-0001> for a short video on ProSense Air Differential and Pressure Transmitters



ProSense DPTA Series Differential Air Pressure Transmitters					
Part Number	Description	Electrical Connection	Input Voltage	Wt(lb)	Price
<a href="#">DPTA-20-P1</a>	Differential Pressure transmitter, 4 to 20 mA output, 0 to 0.1 in. water column range, 1/4" brass barbed connections	Screw Terminals	12 - 36 VDC	0.16	\$156.00
<a href="#">DPTA-20-P1B</a>	Differential Pressure transmitter, 4 to 20 mA output, -0.1 to +0.1 water column range, 1/4" brass barbed connections				\$156.00
<a href="#">DPTA-20-P25</a>	Differential Pressure transmitter, 4 to 20 mA output, 0 to 0.25 in. water column range, 1/4" brass barbed connections				\$156.00
<a href="#">DPTA-20-P25B</a>	Differential Pressure transmitter, 4 to 20 mA output, -0.25 to +0.25 in. water column range, 1/4" brass barbed connections				\$156.00
<a href="#">DPTA-20-P5</a>	Differential Pressure transmitter, 4 to 20 mA output, 0 to 0.5 in. water column range, 1/4" brass barbed connections				\$156.00
<a href="#">DPTA-20-P5B</a>	Differential Pressure transmitter, 4 to 20 mA output, -0.5 to +0.5 in. water column range, 1/4" brass barbed connections				\$156.00
<a href="#">DPTA-20-01</a>	Differential Pressure transmitter, 4 to 20 mA output, 0 to 1.0 in. water column range, 1/4" brass barbed connections				\$155.00
<a href="#">DPTA-20-01B</a>	Differential Pressure transmitter, 4 to 20 mA output, -1.0 to +1.0 in. water column range, 1/4" brass barbed connections				\$155.00
<a href="#">DPTA-20-02</a>	Differential Pressure transmitter, 4 to 20 mA output, 0 to 2.0 in. water column range, 1/4" brass barbed connections				\$155.00
<a href="#">DPTA-20-02B</a>	Differential Pressure transmitter, 4 to 20 mA output, -2.0 to +2.0 in. water column range, 1/4" brass barbed connections				\$151.00
<a href="#">DPTA-20-03</a>	Differential Pressure transmitter, 4 to 20 mA output, 0 to 3.0 in. water column range, 1/4" brass barbed connections				\$151.00
<a href="#">DPTA-20-03B</a>	Differential Pressure transmitter, 4 to 20 mA output, -3.0 to +3.0 in. water column range, 1/4" brass barbed connections				\$151.00
<a href="#">DPTA-20-05</a>	Differential Pressure transmitter, 4 to 20 mA output, 0 to 5.0 in. water column range, 1/4" brass barbed connections				\$151.00
<a href="#">DPTA-20-05B</a>	Differential Pressure transmitter, 4 to 20 mA output, -5.0 to +5.0 in. water column range, 1/4" brass barbed connections				\$151.00
<a href="#">DPTA-20-10</a>	Differential Pressure transmitter, 4 to 20 mA output, 0 to 10.0 in. water column range, 1/4" brass barbed connections				\$151.00
<a href="#">DPTA-20-10B</a>	Differential Pressure transmitter, 4 to 20 mA output, -10.0 to +10.0 in. water column range, 1/4" brass barbed connections				\$151.00
<a href="#">DPTA-20-15</a>	Differential Pressure transmitter, 4 to 20 mA output, 0 to 15.0 in. water column range, 1/4" brass barbed connections				\$151.00
<a href="#">DPTA-20-15B</a>	Differential Pressure transmitter, 4 to 20 mA output, -15.0 to +15.0 in. water column range, 1/4" brass barbed connections				\$151.00
<a href="#">DPTA-20-25</a>	Differential Pressure transmitter, 4 to 20 mA output, 0 to 25.0 in. water column range, 1/4" brass barbed connections				\$151.00



# DPTA Series Differential Air Pressure Transmitters

ProSense DPTA Series Specifications	
<b>Operating Voltage</b>	12 - 36 VDC
<b>Output Range*</b>	4 - 20 mA (2-wire)
<b>Supply Current*</b>	21.5 mA Max.
<b>Maximum Load</b>	$\frac{V_L - 12 \text{ VDC}}{0.022 \text{ amps}} = R_L$ <p>For example  <math display="block">[(24 \text{ VDC} - 12 \text{ VDC}) / 0.022 \text{ amps}] = 545\Omega</math> </p>
<b>Enclosure</b>	NEMA Type 1 Fire-retardant ABS (meets UL 95-5VA)
<b>Pressure Connections</b>	1/4" brass barbed fittings
<b>Weight</b>	0.16 lb
<b>Media</b>	Clean, dry and non-corrosive gas
<b>Mounting</b>	Threaded fastener and 35mm DIN rail mount
<b>Reference Temperature</b>	70°F ± 2°F (21°C ± 1°C)
<b>Temperature Coefficients</b>	±0.03% full range / °F
<b>Zero &amp; Span</b>	
<b>Compensated Range</b>	35 to 130°F (2 to 54°C)
<b>Operating Temperature</b>	0 to 160°F (-18 to 71°C)
<b>Storage Temperature</b>	-40 to 180°F (-40 to 82°C)
<b>Humidity</b>	10 to 95% R.H., non-condensing
<b>Stability</b>	Less than ≤0.25% full range / year
<b>Accuracy</b>	±1% maximum. Includes non-linearity, hysteresis, nonrepeatability, zero offset and span setting errors.
<b>Response Time</b>	250 msec
<b>Proof Pressure</b>	15 psig
<b>Burst Pressure</b>	25 psig
<b>Max. Static Line Pressure</b>	15 psig
<b>Electrical Connection</b>	Euro style pluggable terminal block accepts 12-26 gauge wire
<b>Terminal Screw Torque</b>	4 lbs in (0.5 Nm)
<b>Reverse Wiring Protected</b>	Yes
<b>External Zero Adjustment</b>	±5% full range
<b>External Span Adjustment</b>	±5% full range
<b>Agency Approvals</b>	CE, RoHS

\* Output signal is independent of power supply changes.

Load Limitations 4–20mA Output

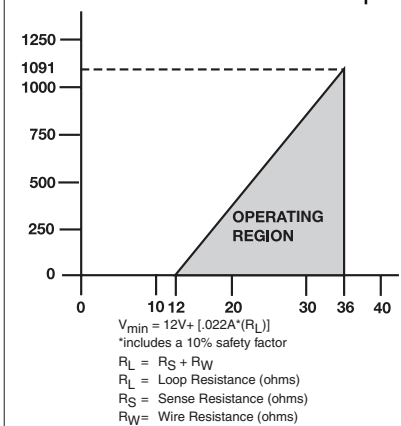

## Mounting Options

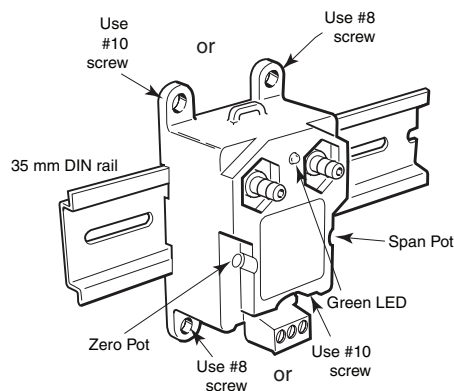

**NOTE: PROSENSE DPTA SERIES TRANSMITTER SHOULD BE MOUNTED IN A VERTICAL AND UPRIGHT POSITION AS SHOWN ABOVE.**

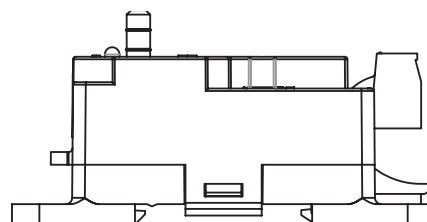

**MOUNTING HORIZONTALLY MAY AFFECT ACCURACY BY AN ADDITIONAL 1%.**

## Wiring Diagram

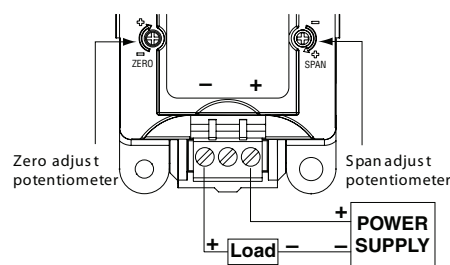

DN-3PLUGMN can be used as a replacement terminal block.

See our website [www.AutomationDirect.com](http://www.AutomationDirect.com) for complete Engineering drawings.

## Dimensions inches [mm]

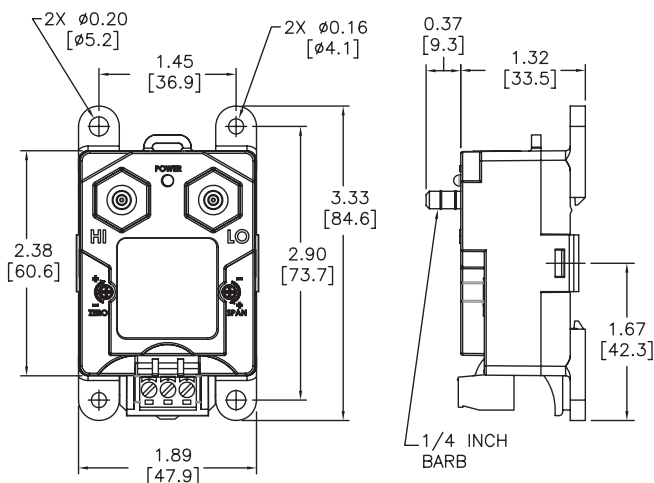

# prosense® EPS Series Digital Pressure Sensors

## Overview



AutomationDirect's ProSense EPS Series of Digital Pressure Sensors is ideal for industrial pressure measurement and indication in both gas and liquid applications. Measuring ranges are available from vacuum up to 5800 psig as well as other selectable engineering units such as bar, mbar, kPa, MPa, inches of water column, and inches of mercury. The standard 1/4" NPT male process connection allows for direct installation without requiring extra fittings. With no moving parts such as pistons or springs that can stick or break, the two solid state switch outputs provide a reliable alternative to mechanical pressure switches. Models are also available that allow the second output to be configured as a scalable analog signal turning the unit into a combination pressure switch and transmitter. The built-in two-color digital display is easy to read from a distance and provides indication of measured pressure and switch setpoints. It can be set to change

color between red and green based on measured value or output status and rotated 180° for installation flexibility. Two large bright LEDs indicate output status. For optimum visibility the sensor housing can be rotated 345° after installation. Simple pushbutton setup allows the EPS to be easily and quickly configured prior to installation without the need for a separate pressure reference gauge. Encased in a stainless steel housing the EPS allows for a high IP67 ingress protection rating achieving its atmospheric pressure reference via the 4-pin M12 electrical connection. A protective cover and mounting bracket are available accessories. The compact and robust design and construction of the ProSense EPS series withstands extreme shock and vibration, provides high accuracy and reliability, and incorporates the best combination of over pressure, burst pressure and long term stability for each measuring range.

## ProSense EPS Digital Pressure Sensors Selection Guide

Part Number	Price	Pressure Range	Selectable Engineering Units	Process Connection	Electrical Connection	Operating Voltage	Outputs
<a href="#">EPS25-V14-1001</a>	\$322.00	-14.5 to 14.5 psig	psig, mbar, kPa, inH <sub>2</sub> O, inHg	1/4" NPT male	4-pin M12 quick-disconnect	18 to 30 VDC	OUT 1: Switch (selectable N.O. or N.C. / PNP or NPN)  OUT 2: Switch (selectable N.O. or N.C. / PNP or NPN) or Analog (selectable 4-20 mA or 0-10 VDC)
<a href="#">EPS25-100WC-1001</a>	\$322.00	-5 to 100.4 inH <sub>2</sub> O	inH <sub>2</sub> O, mbar, kPa, mmWS				
<a href="#">EPS25-14-1001</a>	\$322.00	-0.72 to 14.5 psig	psig, mbar, kPa, inH <sub>2</sub> O				
<a href="#">EPS25-36-1001</a>	\$322.00	-1.8 to 36.25 psig	psig, bar, kPa				
<a href="#">EPS25-V145-1001*</a>	\$322.00	-14.6 to 145 psig	psig, bar, MPa				
<a href="#">EPS25-360-1001*</a>	\$322.00	-14.5 to 362.5 psig	psig, bar, MPa				
<a href="#">EPS25-1450-1001*</a>	\$322.00	0 to 1450 psig	psig, bar, MPa				
<a href="#">EPS25-3620-1001</a>	\$322.00	0 to 3625 psig	psig, bar, MPa				
<a href="#">EPS25-5800-1001</a>	\$322.00	0 to 5800 psig	psig, bar, MPa				
<a href="#">EPS25-V14-1003</a>	\$283.00	-14.5 to 14.5 psig	psig, mbar, kPa, inHg				OUT 1: Switch (selectable N.O. or N.C. / PNP or NPN)  OUT 2: Switch (selectable N.O. or N.C. / PNP or NPN)
<a href="#">EPS25-14-1003</a>	\$283.00	0 to 14.5 psig	psig, mbar, kPa, inHg				
<a href="#">EPS25-36-1003</a>	\$283.00	0 to 36.2 psig	psig, bar, kPa				
<a href="#">EPS25-V145-1003*</a>	\$283.00	-14.5 to 145 psig	psig, bar, MPa				
<a href="#">EPS25-360-1003*</a>	\$283.00	0 to 362 psig	psig, bar, MPa				
<a href="#">EPS25-1450-1003*</a>	\$283.00	0 to 1450 psig	psig, bar, MPa				
<a href="#">EPS25-3620-1003</a>	\$283.00	0 to 3620 psig	psig, bar, MPa				
<a href="#">EPS25-5800-1003</a>	\$283.00	0 to 5800 psig	psig, bar, MPa				

\* For gas applications 362 psig (25bar) maximum pressure!



# EPS Series (-1001) Digital Pressure Sensors



## Features

- Ideal for industrial pressure measurement and indication in both gas and liquid applications
- Measuring ranges from vacuum up to 5800 psig
- Selectable engineering units include psig, bar, mbar, kPa, MPa, inH<sub>2</sub>O, and inHg
- 1/4" NPT male process connection allows for direct installation without requiring extra fittings
- 2 solid state switch outputs provide a reliable alternative to mechanical pressure switches
- Output 2 can be configured as a scalable analog signal turning the unit into a combination pressure switch and transmitter
- Built-in two-color 4-digit display is easy to read from a distance and provides indication of measured pressure and switch setpoints
- Display can be set to change color between red and green based on measured value or output status and rotated 180° for installation flexibility
- 2 large bright LEDs indicate output status
- Sensor housing can be rotated 345° for optimum visibility after installation
- Simple pushbutton setup for easy and quick configuration prior to installation without the need for a separate pressure reference gauge
- Stainless steel housing allows for a high IP67 ingress protection rating
- 4-pin M12 electrical connection
- Protective cover and mounting bracket are available accessories
- Compact and robust design and construction withstands extreme shock and vibration, provides high accuracy and reliability, and incorporates the best combination of over pressure, burst pressure and long term stability for each measuring range
- 3-year warranty



## EPS Series (-1001) Digital Pressure Sensors

Part Number	Description	Pcs/Pkg	Wt (lb)	Price
<a href="#"><u>EPS25-V14-1001</u></a>	ProSense digital pressure sensor, -14.5 to 14.5 psig range, output 1: switch (N.O./N.C.), PNP/NPN selectable, output 2: switch (N.O./N.C.), PNP/NPN selectable or 4-20 mA/0-10 VDC, 1/4in male NPT process connection, 4-pin M12 quick-disconnect, 18-30 VDC operating voltage, 4-digit, two-color LED display, for use with compatible liquids or gases. Purchase cable separately.	1	0.5	\$322.00
<a href="#"><u>EPS25-100WC-1001</u></a>	ProSense digital pressure sensor, -5 to 100.4 inches of water column range, output 1: switch (N.O./N.C.), PNP/NPN selectable, output 2: switch (N.O./N.C.), PNP/NPN selectable or 4-20 mA/0-10 VDC, 1/4in male NPT process connection, 4-pin M12 quick-disconnect, 18-30 VDC operating voltage, 4-digit, two-color LED display, for use with compatible liquids or gases. Purchase cable separately.	1	0.5	\$322.00
<a href="#"><u>EPS25-14-1001</u></a>	ProSense digital pressure sensor, -0.72 to 14.5 psig range, output 1: switch (N.O./N.C.), PNP/NPN selectable, output 2: switch (N.O./N.C.), PNP/NPN selectable or 4-20 mA/0-10 VDC, 1/4in male NPT process connection, 4-pin M12 quick-disconnect, 18-30 VDC operating voltage, 4-digit, two-color LED display, for use with compatible liquids or gases. Purchase cable separately.	1	0.5	\$322.00
<a href="#"><u>EPS25-36-1001</u></a>	ProSense digital pressure sensor, -1.8 to 36.25 psig range, output 1: switch (N.O./N.C.), PNP/NPN selectable, output 2: switch (N.O./N.C.), PNP/NPN selectable or 4-20 mA/0-10 VDC, 1/4in male NPT process connection, 4-pin M12 quick-disconnect, 18-30 VDC operating voltage, 4-digit, two-color LED display, for use with compatible liquids or gases. Purchase cable separately.	1	0.5	\$322.00
<a href="#"><u>EPS25-V145-1001*</u></a>	ProSense digital pressure sensor, -14.6 to 145 psig range, output 1: switch (N.O./N.C.), PNP/NPN selectable, output 2: switch (N.O./N.C.), PNP/NPN selectable or 4-20 mA/0-10 VDC, 1/4in male NPT process connection, 4-pin M12 quick-disconnect, 18-30 VDC operating voltage, 4-digit, two-color LED display, for use with compatible liquids or gases. Purchase cable separately.	1	0.5	\$322.00
<a href="#"><u>EPS25-360-1001*</u></a>	ProSense digital pressure sensor, -14.5 to 362.5 psig range, output 1: switch (N.O./N.C.), PNP/NPN selectable, output 2: switch (N.O./N.C.), PNP/NPN selectable or 4-20 mA/0-10 VDC, 1/4in male NPT process connection, 4-pin M12 quick-disconnect, 18-30 VDC operating voltage, 4-digit, two-color LED display, for use with compatible liquids or gases. Purchase cable separately.	1	0.5	\$322.00
<a href="#"><u>EPS25-1450-1001*</u></a>	ProSense digital pressure sensor, 0 to 1450 psig range, output 1: switch (N.O./N.C.), PNP/NPN selectable, output 2: switch (N.O./N.C.), PNP/NPN selectable or 4-20 mA/0-10 VDC, 1/4in male NPT process connection, 4-pin M12 quick-disconnect, 18-30 VDC operating voltage, 4-digit, two-color LED display, for use with compatible liquids or gases. Purchase cable separately.	1	0.5	\$322.00
<a href="#"><u>EPS25-3620-1001</u></a>	ProSense digital pressure sensor, 0 to 3625 psig range, output 1: switch (N.O./N.C.), PNP/NPN selectable, output 2: switch (N.O./N.C.), PNP/NPN selectable or 4-20 mA/0-10 VDC, 1/4in male NPT process connection, 4-pin M12 quick-disconnect, 18-30 VDC operating voltage, 4-digit, two-color LED display, for use with compatible liquids or gases. Purchase cable separately.	1	0.5	\$322.00
<a href="#"><u>EPS25-5800-1001</u></a>	ProSense digital pressure sensor, 0 to 5800 psig range, output 1: switch (N.O./N.C.), PNP/NPN selectable, output 2: switch (N.O./N.C.), PNP/NPN selectable or 4-20 mA/0-10 VDC, 1/4in male NPT process connection, 4-pin M12 quick-disconnect, 18-30 VDC operating voltage, 4-digit, two-color LED display, for use with compatible liquids or gases. Purchase cable separately.	1	0.5	\$322.00

\* For gas applications 362 psig (25bar) maximum pressure!



NOTE: CHECK THE CHEMICAL COMPATIBILITY OF THE SENSOR'S WETTED PARTS WITH THE MEDIUM TO BE MEASURED





# EPS Series (-1001) Digital Pressure Sensors

EPS Series (-1001) Digital Pressure Sensors									
Part Number	Measuring Range	Setting Range Set Point, SP	Reset Point, rP	Analog Start Point, ASP	Analog End Point, AEP	Steps	Proof Pressure	Bursting Pressure	Vacuum Resistance
<a href="#"><u>EPS25-V14-1001</u></a>	-14.5 to 14.5 psig -1000 to 1000 mbar -100 to 100 kPa -402 to 402 inH2O -29.5 to 29.5 inHg	-14.3 to 14.5 psig -985 to 1000 mbar -98.5 to 100 kPa -396 to 402 inH2O -29.2 to 29.5 inHg	-14.45 to 14.4 psig -995 to 990 mbar -99.5 to 99 kPa -400 to 398 inH2O -29.4 to 29.3 inHg	-14.5 to 8.7 psig -1000 to 600 mbar -100 to 60 kPa -402 to 240 inH2O -29.5 to 17.7 inHg	-8.7 to 14.5 psig -600 to 1000 mbar -60 to 100 kPa -240 to 402 inH2O -17.7 to 29.5 inHg	0.05 psig 5 mbar 0.5 kPa 2 inH2O 0.1 inHg	290 psig 20000 mbar 2000 kPa 8030 inH2O 590 inHg	725 psig 50000 mbar 5000 kPa 20068 inH2O 1476 inHg	-14.5 psig -1000 mbar
<a href="#"><u>EPS25-100WC-1001</u></a>	-5 to 100.4 inH2O -12.5 to 250 mbar -1.25 to 25 kPa -125 to 2550 mmWS	-4.4 to 100.4 inH2O -11 to 250 mbar -1.1 to 25 kPa -110 to 2550 mmWS	-4.8 to 100 inH2O -12 to 249 mbar -1.2 to 24.9 kPa -120 to 2540 mmWS	-5 to 80.2 inH2O -12.5 to 200 mbar -1.25 to 20 kPa -125 to 2040 mmWS	15 to 100.4 inH2O 37.5 to 250 mbar 3.75 to 25 kPa 385 to 2550 mmWS	0.2 inH2O 0.5 mbar 0.05 kPa 5mmWS	2400 inH2O 6000 mbar 600 kPa 61000 mmWS	12000 inH2O 30000 mbar 3000 kPa 306000 mmWS	-120 inH2O -300 mbar
<a href="#"><u>EPS25-14-1001</u></a>	-0.72 to 14.50 psig -50 to 1000 mbar -5 to 100 kPa -20 to 401.5 inH2O	-0.64 to 14.5 psig -44 to 1000 mbar -4.4 to 100 kPa -17.5 to 401.5 inH2O	-0.7 to 14.44 psig -48 to 996 mbar -4.8 to 99.6 kPa -19 to 400 inH2O	-0.72 to 11.6 psig -50 to 800 mbar -5 to 80 kPa -20 to 321 inH2O	2.18 to 14.5 psig 150 to 1000 mbar 15 to 100 kPa 60.5 to 401.5 inH2O	0.02 psig 2 mbar 0.2 kPa 0.5 inH2O	145 psig 10000 mbar 1000 kPa 4000 inH2O	450 psig 30000 mbar 3000 kPa 12040 inH2O	-14.5 psig -1000 mbar
<a href="#"><u>EPS25-36-1001</u></a>	-1.8 to 36.25 psig -0.125 to 2.5 bar -12.5 to 250 kPa	-1.6 to 36.25 psig -0.11 to 2.5 bar -11 to 250 kPa	-1.75 to 36.1 psig -0.12 to 2.49 bar -12 to 249 kPa	-1.8 to 29.0 psig -0.125 to 2.0 bar -12.5 to 200 kPa	5.45 to 36.25 psig 0.375 to 2.5 bar 37.5 to 250 kPa	0.05 psig 0.005 bar 0.5 kPa	290 psig 20 bar 2000 kPa	725 psig 50 bar 5000 kPa	
<a href="#"><u>EPS25-V145-1001*</u></a>	-14.6 to 145 psig -1 to 10 bar -0.1 to 1 MPa	-13.6 to 145 psig -0.94 to 10 bar -0.094 to 1 MPa	-14.2 to 144.4 psig -0.98 to 9.96 bar -0.098 to 0.996 MPa	-14.6 to 116 psig -1 to 8 bar -0.1 to 0.8 MPa	14.6 to 145 psig 1 to 10 bar 0.1 to 1 MPa	0.2 psig 0.02 bar 0.002 MPa	1087 psig 75 bar 7.5 MPa	2715 psig 150 bar 15 MPa	
<a href="#"><u>EPS25-360-1001*</u></a>	-14.5 to 362.5 psig -1 to 25 bar -0.1 to 2.5 MPa	-12 to 362.5 psig -0.85 to 25 bar -0.085 to 2.5 MPa	-13.5 to 361 psig -0.95 to 24.9 bar -0.095 to 2.49 MPa	-14.5 to 290 psig -1 to 20 bar -0.1 to 2 MPa	58 to 362.5 psig 4 to 25 bar 0.4 to 2.5 MPa	0.5 psig 0.05 bar 0.005 MPa	2175 psig 150 bar 15 MPa	5075 psig 350 bar 35 MPa	
<a href="#"><u>EPS25-1450-1001*</u></a>	0 to 1450 psig 0 to 100 bar 0 to 10 MPa	10 to 1450 psig 0.6 to 100 bar 0.06 to 10 MPa	4 to 1444 psig 0.2 to 99.6 bar 0.02 to 9.96 MPa	0 to 1160 psig 0 to 80 bar 0 to 8 MPa	290 to 1450 psig 20 to 100 bar 2 to 10 MPa	2 psig 0.2 bar 0.02 MPa	4350 psig 300 bar 30 MPa	9400 psig 650 bar 65 MPa	
<a href="#"><u>EPS25-3620-1001</u></a>	0 to 3625 psig 0 to 250 bar 0 to 25 MPa	25 to 3625 psig 1.5 to 250 bar 0.15 to 25 MPa	10 to 3610 psig 0.5 to 249 bar 0.05 to 24.9 MPa	0 to 2900 psig 0 to 200 bar 0 to 20 MPa	725 to 3625 psig 50 to 250 bar 5 to 25 MPa	5 psig 0.5 bar 0.05 MPa	7250 psig 500 bar 50 MPa	17400 psig 1200 bar 120 MPa	
<a href="#"><u>EPS25-5800-1001</u></a>	0 to 5800 psig 0 to 400 bar 0 to 40 MPa	40 to 5800 psig 2.5 to 400 bar 0.25 to 40 MPa	10 to 5780 psig 1 to 398.5 bar 0.1 to 39.85 MPa	0 to 4640 psig 0 to 320 bar 0 to 32 MPa	1160 to 5800 psig 80 to 400 bar 8 to 40 MPa	10 psig 0.5 bar 0.05 MPa	11580 psig 800 bar 80 MPa	24650 psig 1700 bar 170 MPa	

inH2O = Inches of Water Column

\* For gas applications 362 psig (25 bar) maximum pressure!

**WARNING! AVOID STATIC AND DYNAMIC OVERPRESSURE EXCEEDING THE SPECIFIED PROOF PRESSURE.****EXCEEDING THE BURSTING PRESSURE FOR EVEN A SHORT TIME CAN CAUSE DESTRUCTION OF THE UNIT AND POSSIBLE INJURIES!**





# EPS Series (-1001) Digital Pressure Sensors

ProSense EPS (-1001) Series General Specifications	
Electrical	
Operating Voltage <sup>1</sup>	18 to 30 VDC
Current Consumption	< 35mA
Insulation Resistance	> 100M $\Omega$ (500VDC)
IEC Protection Class	Class III
Reverse Polarity Protection	yes
Outputs	
OUT1	switch
OUT2	switch or analog
Switch Outputs	
Type	PNP or NPN selectable
Action	N.O. or N.C. selectable
Current Rating	250mA resistive
Voltage Drop	< 2V
Short Circuit Protection	Yes (non-latching)
Overload Protection	Yes
Switching Frequency	$\leq$ 500Hz
Function	Hysteresis or window
Analog Output	
Type	4-20 mA or 0-10 VDC selectable
Load	500 $\Omega$ max (4-20 mA), 2000 $\Omega$ min (0-10VDC)
Accuracy / Deviations (in % of the span) Turn down 1:1	
Switch Point Accuracy	< $\pm$ 0.4% of the span
Characteristics Deviation*	< $\pm$ 0.25 (BFSL) / < $\pm$ 0.5 (LS)
Hysteresis	< $\pm$ 0.1
Repeatability**	< $\pm$ 0.1
Long-term Stability***	< $\pm$ 0.05
Temperature Coefficients (TEMPCO) in the temperature range -25 to 80°C (in % of the span per 10°C)	
Greatest TEMPCO of the zero point	0.2
Greatest TEMPCO of the span	0.2
Reaction Times	
Power-on Delay Time	0.3 s
Min. Response Time Switching Output	< 1.5 ms
Delay Time Programmable (dS, dr)	0 to 50s
Damping for the Switching Output (dAP)	0 to 4s
Damping for the Analog Output (dAA)	0 to 4s
Response Time Analog Output	< 3ms
Integrated Watchdog	yes



# EPS Series (-1001) Digital Pressure Sensors

ProSense EPS (-1001) Series General Specifications Continued	
Environment	
Ambient Temperature	-13 to 176°F [-25 to 80°C]
Medium Temperature	-13 to 176°F [-25 to 80°C]
Storage Temperature	-40 to 212°F [-40 to 100°C]
Protection	IP65 / IP67
Mechanical	
Process Connection	1/4" NPT male
Materials (wetted parts) <sup>2</sup>	<div style="display: flex; justify-content: space-between;"> <div style="width: 45%;">           &lt; 3600 psig measuring range            Stainless steel 316L (DIN 1.4404)         </div> <div style="width: 45%;">           &gt; 3600 psig measuring range            Stainless steel 17-4 / 630 (DIN 1.4542)            Ceramics            FKM         </div> </div>
Housing Materials	Stainless steel 17-4 PH / 630 (DIN 1.4542); stainless steel 316L (DIN 1.4404); PBT+PC-GF 30; PBT-GF 20; PC
Min. Pressure Cycles	100 million
Tightening Torque	50Nm (depends on lubrication, seal and pressure rating)
Restrictor Element Integrated	no
Displays	
Engineering Units	3, 4 or 5 x LED green (depending on model), 10mm character height
Switching Status	2 x LED yellow
Measured Values	4-digit alphanumeric display / alternating indication of red and green
Electrical Connection	
Connection	4-pin M12 quick-disconnect; gold-plated contacts
Tests / Approvals	
Pressure Equipment Directive	97/23/EG: Group 2 (Non-Hazardous, Nonflammable, Non-Oxidizing fluids or gases) in accordance with sound engineering practice
EMC	DIN EN 61000-6-2 DIN EN 61000-6-3
Shock Resistance	DIN EN 60068-2-27 (50g 11ms)
Vibration Resistance	DIN EN 60068-2-6 (20g 10 to 2000 Hz)
Agency Approvals	UL file # E320431, CE, RoHS

\* BFSL = Best fit straight line / LS = Limit value setting

\*\* With temperature fluctuations < 10°C

\*\*\* in % of the span / 6 months

<sup>1</sup> To EN50178, SELV, PELV

<sup>2</sup> Not cleaned for oxygen service

# prosense® EPS Series (-1001) Digital Pressure Sensors

## EPS Wiring Diagram

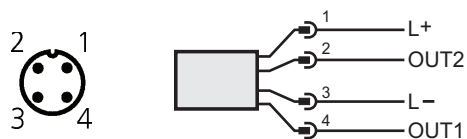

### Cable Assembly Wiring Colors:

Pin 1 - Brown  
Pin 2 - White  
Pin 3 - Blue  
Pin 4 - Black

Note: Wiring colors are based on AutomationDirect CD12L and CD12M 4-pole cable assemblies.

## EPS 1001 Series Wiring Examples

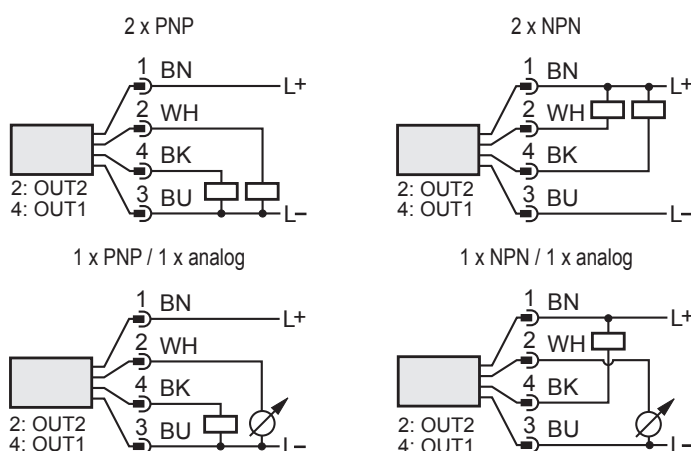

## Dimensions

mm [inches]

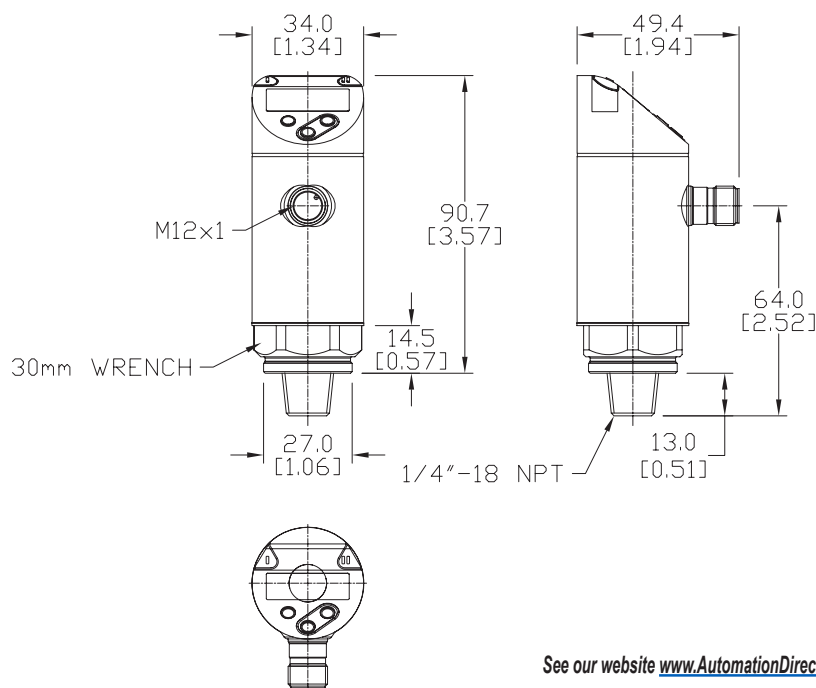

See our website [www.AutomationDirect.com](http://www.AutomationDirect.com) for complete Engineering drawings.



# EPS Series (-1003) Digital Pressure Sensors

## Features



- Ideal for industrial pressure measurement and indication in both gas and liquid applications
- Measuring ranges from vacuum up to 5800 psig
- Selectable engineering units include psig, bar, mbar, kPa, MPa, and inHg
- 1/4" NPT male process connection allows for direct installation without requiring extra fittings
- 2 solid state switch outputs provide a reliable alternative to mechanical pressure switches
- Built-in two-color 4-digit display is easy to read from a distance and provides indication of measured pressure and switch setpoints
- Display can be set to change color between red and green based on measured value or output status and rotated 180° for installation flexibility
- 2 large bright LEDs indicate output status
- Sensor housing can be rotated 345° for optimum visibility after installation
- Simple pushbutton setup for easy and quick configuration prior to installation without the need for a separate pressure reference gauge
- Stainless steel housing allows for a high IP67 ingress protection rating
- 4-pin M12 electrical connection
- Protective cover and mounting bracket are available accessories
- Compact and robust design and construction withstands extreme shock and vibration, provides high accuracy and reliability, and incorporates the best combination of over pressure, burst pressure and long term stability for each measuring range
- 3-year warranty



## EPS Series (-1003) Digital Pressure Sensors

Part Number	Description	Pcs/Pkg	Wt (lb)	Price
<a href="#"><u>EPS25-V14-1003</u></a>	ProSense digital pressure sensor, -14.5 to 14.5 psig range, output 1: switch (N.O./N.C.), PNP/NPN selectable, output 2: switch (N.O./N.C.), PNP/NPN selectable, 1/4in male NPT process connection, 4-pin M12 quick-disconnect, 18-30 VDC operating voltage, 4-digit, two-color LED display, for use with compatible liquids or gases. Purchase cable separately.	1	0.5	\$283.00
<a href="#"><u>EPS25-14-1003</u></a>	ProSense digital pressure sensor, 0 to 14.5 psig range, output 1: switch (N.O./N.C.), PNP/NPN selectable, output 2: switch (N.O./N.C.), PNP/NPN selectable, 1/4in male NPT process connection, 4-pin M12 quick-disconnect, 18-30 VDC operating voltage, 4-digit, two-color LED display, for use with compatible liquids or gases. Purchase cable separately.	1	0.5	\$283.00
<a href="#"><u>EPS25-36-1003</u></a>	ProSense digital pressure sensor, 0 to 36.2 psig range, output 1: switch (N.O./N.C.), PNP/NPN selectable, output 2: switch (N.O./N.C.), PNP/NPN selectable, 1/4in male NPT process connection, 4-pin M12 quick-disconnect, 18-30 VDC operating voltage, 4-digit, two-color LED display, for use with compatible liquids or gases. Purchase cable separately.	1	0.5	\$283.00
<a href="#"><u>EPS25-V145-1003*</u></a>	ProSense digital pressure sensor, -14.5 to 145 psig range, output 1: switch (N.O./N.C.), PNP/NPN selectable, output 2: switch (N.O./N.C.), PNP/NPN selectable, 1/4in male NPT process connection, 4-pin M12 quick-disconnect, 18-30 VDC operating voltage, 4-digit, two-color LED display, for use with compatible liquids or gases. Purchase cable separately.	1	0.5	\$283.00
<a href="#"><u>EPS25-360-1003*</u></a>	ProSense digital pressure sensor, 0 to 362 psig range, output 1: switch (N.O./N.C.), PNP/NPN selectable, output 2: switch (N.O./N.C.), PNP/NPN selectable, 1/4in male NPT process connection, 4-pin M12 quick-disconnect, 18-30 VDC operating voltage, 4-digit, two-color LED display, for use with compatible liquids or gases. Purchase cable separately.	1	0.5	\$283.00
<a href="#"><u>EPS25-1450-1003*</u></a>	ProSense digital pressure sensor, 0 to 1450 psig range, output 1: switch (N.O./N.C.), PNP/NPN selectable, output 2: switch (N.O./N.C.), PNP/NPN selectable, 1/4in male NPT process connection, 4-pin M12 quick-disconnect, 18-30 VDC operating voltage, 4-digit, two-color LED display, for use with compatible liquids or gases. Purchase cable separately.	1	0.5	\$283.00
<a href="#"><u>EPS25-3620-1003</u></a>	ProSense digital pressure sensor, 0 to 3620 psig range, output 1: switch (N.O./N.C.), PNP/NPN selectable, output 2: switch (N.O./N.C.), PNP/NPN selectable, 1/4in male NPT process connection, 4-pin M12 quick-disconnect, 18-30 VDC operating voltage, 4-digit, two-color LED display, for use with compatible liquids or gases. Purchase cable separately.	1	0.5	\$283.00
<a href="#"><u>EPS25-5800-1003</u></a>	ProSense digital pressure sensor, 0 to 5800 psig range, output 1: switch (N.O./N.C.), PNP/NPN selectable, output 2: switch (N.O./N.C.), PNP/NPN selectable, 1/4in male NPT process connection, 4-pin M12 quick-disconnect, 18-30 VDC operating voltage, 4-digit, two-color LED display, for use with compatible liquids or gases. Purchase cable separately.	1	0.5	\$283.00

\* For gas applications 362 psig (25bar) maximum pressure!



NOTE: CHECK THE CHEMICAL COMPATIBILITY OF THE SENSOR'S WETTED PARTS WITH THE MEDIUM TO BE MEASURED

# prosense® EPS Series (-1003) Digital Pressure Sensors

EPS Series (-1003) Digital Pressure Sensors							
Part Number	Measuring Range	Setting Range Set Point, SP	Reset Point, rP	Steps	Proof Pressure	Bursting Pressure	Vacuum Resistance
<a href="#"><u>EPS25-V14-1003</u></a>	-14.5 to 14.5 psig -1000 to 1000 mbar -100 to 100 kPa -29.6 to 29.6 inHg	-14.3 to 14.5 psig -980 to 1000 mbar -98 to 100 kPa -29.0 to 29.6 inHg	-14.4 to 14.4 psig -990 to 990 mbar -99 to 99 kPa -29.2 to 29.4 inHg	0.1 psig 10 mbar 1 kPa 0.2 inHg	290 psig 20000 mbar 2000 kPa 590 inHg	725 psig 50000 mbar 5000 kPa 1450 inHg	-14.5 psig -1000 mbar
<a href="#"><u>EPS25-14-1003</u></a>	0 to 14.5 psig 0 to 1000 mbar 0 to 100 kPa 0 to 29.5 inHg	0.1 to 14.5 psig 10 to 1000 mbar 1 to 100 kPa 0.2 to 29.5 inHg	0.05 to 14.45 psig 5 to 995 mbar 0.5 to 99.5 kPa 0.1 to 29.4 inHg	0.05 psig 5 mbar 0.5 kPa 0.1 inHg	145 psig 10000 mbar 1000 kPa 290 inHg	450 psig 30000 mbar 3000 kPa 880 inHg	
<a href="#"><u>EPS25-36-1003</u></a>	0 to 36.2 psig 0 to 2.5 bar 0 to 250 kPa	0.4 to 36.2 psig 0.02 to 2.5 bar 2 to 250 kPa	0.2 to 36 psig 0.01 to 2.49 bar 1 to 249 kPa	0.2 psig 0.01 bar 1kPa	290 psig 20 bar 2000 kPa	725 psig 50 bar 5000 kPa	
<a href="#"><u>EPS25-V145-1003*</u></a>	-14.5 to 145 psig -1 to 10 bar -0.1 to 1 MPa	-13.5 to 145 psig -0.90 to 10 bar -0.09 to 1 MPa	-14 to 144.5 psig -0.95 to 9.95 bar -0.095 to 0.995 MPa	0.5 psig 0.05 bar 0.005 MPa	1087 psig 75 bar 7.5 MPa	2715 psig 150 bar 15 MPa	
<a href="#"><u>EPS25-360-1003*</u></a>	0 to 362 psig 0 to 25 bar 0 to 2.5 MPa	4 to 362 psig 0.2 to 25 bar 0.02 to 2.5 MPa	2 to 360 psig 0.1 to 24.9 bar 0.01 to 2.49 MPa	2 psig 0.1 bar 0.01 MPa	2175 psig 150 bar 15 MPa	5075 psig 350 bar 35 MPa	
<a href="#"><u>EPS25-1450-1003*</u></a>	0 to 1450 psig 0 to 100 bar 0 to 10 MPa	10 to 1450 psig 1.0 to 100 bar 0.10 to 10 MPa	5 to 1445 psig 0.5 to 99.5 bar 0.05 to 9.95 MPa	5 psig 0.5 bar 0.05 MPa	4350 psig 300 bar 30 MPa	9400 psig 650 bar 65 MPa	
<a href="#"><u>EPS25-3620-1003</u></a>	0 to 3620 psig 0 to 250 bar 0 to 25 MPa	40 to 3620 psig 2 to 250 bar 0.2 to 25.0 MPa	20 to 3600 psig 1 to 249 bar 0.1 to 24.9 MPa	20 psig 1 bar 0.1 MPa	7250 psig 500 bar 50 MPa	15950 psig 1100 bar 110 MPa	
<a href="#"><u>EPS25-5800-1003</u></a>	0 to 5800 psig 0 to 400 bar 0 to 40 MPa	40 to 5800 psig 4 to 400 bar 0.4 to 40 MPa	20 to 5780 psig 2 to 398 bar 0.2 to 39.8 MPa	20 psig 2 bar 0.2 MPa	11580 psig 800 bar 80 MPa	24650 psig 1700 bar 170 MPa	

inH2O = Inches of Water Column

\* For gas applications 362 psig (25 bar) maximum pressure!



WARNING! AVOID STATIC AND DYNAMIC OVERPRESSURE EXCEEDING THE SPECIFIED PROOF PRESSURE.

EXCEEDING THE BURSTING PRESSURE FOR EVEN A SHORT TIME CAN CAUSE DESTRUCTION OF THE UNIT AND POSSIBLE INJURIES!

# prosense® EPS Series (-1003) Digital Pressure Sensors

ProSense EPS25 (-1003) Series General Specifications	
Electrical	
Operating Voltage <sup>1</sup>	18 to 30 VDC
Current Consumption	< 35mA
Insulation Resistance	> 100MΩ (500VDC)
IEC Protection Class	Class III
Reverse Polarity Protection	yes
Outputs	
OUT1	switch
OUT2	switch
Switch Outputs	
Type	PNP or NPN selectable
Action	N.O. or N.C. selectable
Current Rating	150mA resistive
Voltage Drop	< 2.5 V
Short Circuit Protection	Yes (non-latching)
Overload Protection	Yes
Switching Frequency	≤ 170Hz
Function	Hysteresis or window
Accuracy / Deviations (in % of the span) Turn down 1:1	
Switch Point Accuracy	< ± 0.5% of the span
Characteristics Deviation*	< ± 0.25 (BFS) / < ± 0.5 (LS)
Hysteresis	< ± 0.25
Repeatability**	< ± 0.1
Long-term Stability***	< ± 0.05
Temperature Coefficients (TEMPCO) in the temperature range -25 to 80°C (in % of the span per 10°C)	
Greatest TEMPCO of the zero point	0.2
Greatest TEMPCO of the span	0.2
Reaction Times	
Power-on Delay Time	0.3 s
Min. Response Time Switching Output	< 3ms
Delay Time Programmable (dS, dr)	0 to 50s
Damping for the Switching Output (dAP)	0 to 4s
Integrated Watchdog	yes
Environment	
Ambient Temperature	-13 to 176°F [-25 to 80°C]
Medium Temperature	-13 to 176°F [-25 to 80°C]
Storage Temperature	-40 to 212°F [-40 to 100°C]
Protection	IP 65 / IP 67





# EPS Series (-1003) Digital Pressure Sensors

ProSense EPS (-1003) Series General Specifications Continued	
Mechanical	
Process Connection	1/4" NPT male
Materials (wetted parts) <sup>2</sup>	<div> <div>&lt; 3600 psig measuring range Stainless steel 316L (DIN 1.4404)</div> <div>&gt; 3600 psig measuring range Stainless steel 17-4 / 630 (DIN 1.4542) Ceramics FKM</div> </div>
Housing Materials	Stainless steel 17-4 PH / 630 (DIN 1.4542); stainless steel 316L (DIN 1.4404); PBT+PC-GF 30; PBT-GF 20; PC
Min. Pressure Cycles	100 million
Tightening Torque	50Nm (depends on lubrication, seal and pressure rating)
Restrictor Element Integrated	no
Displays	
Engineering Units	3 or 4 x LED green (depending on model), 10mm character height
Switching Status	2 x LED yellow
Measured Values	4-digit alphanumeric display / alternating indication of red and green
Electrical Connection	
Connection	4-pin M12 quick-disconnect; gold-plated contacts
Tests / Approvals	
Pressure Equipment Directive	97/23/EG: Group 2 (Non-Hazardous, Nonflammable, Non-Oxidizing fluids or gases) in accordance with sound engineering practice
EMC	DIN EN 61000-6-2 DIN EN 61000-6-3
Shock Resistance	DIN EN 60068-2-27 (50g 11ms)
Vibration Resistance	DIN EN 60068-2-6 (20g 10 to 2000 Hz)
Agency Approvals	UL file # E320431, CE, RoHS

\* BFSL = Best fit straight line / LS = Limit value setting

\*\* With temperature fluctuations < 10°C

\*\*\* in % of the span / 6 months

<sup>1</sup> To EN50178, SELV, PELV

<sup>2</sup> Not cleaned for oxygen service

# prosense® EPS Series (-1003) Digital Pressure Sensors

## EPS Wiring Diagram

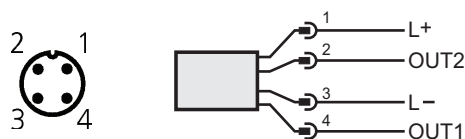

### Cable Assembly Wiring Colors:

Pin 1 - Brown  
Pin 2 - White  
Pin 3 - Blue  
Pin 4 - Black

Note: Wiring colors are based on AutomationDirect CD12L and CD12M 4-pole cable assemblies.

## EPS 1003 Series Wiring Examples

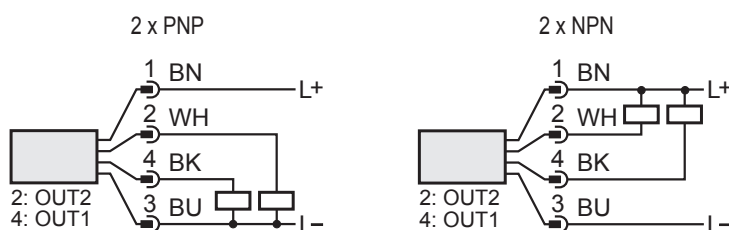

## Dimensions

mm [inches]

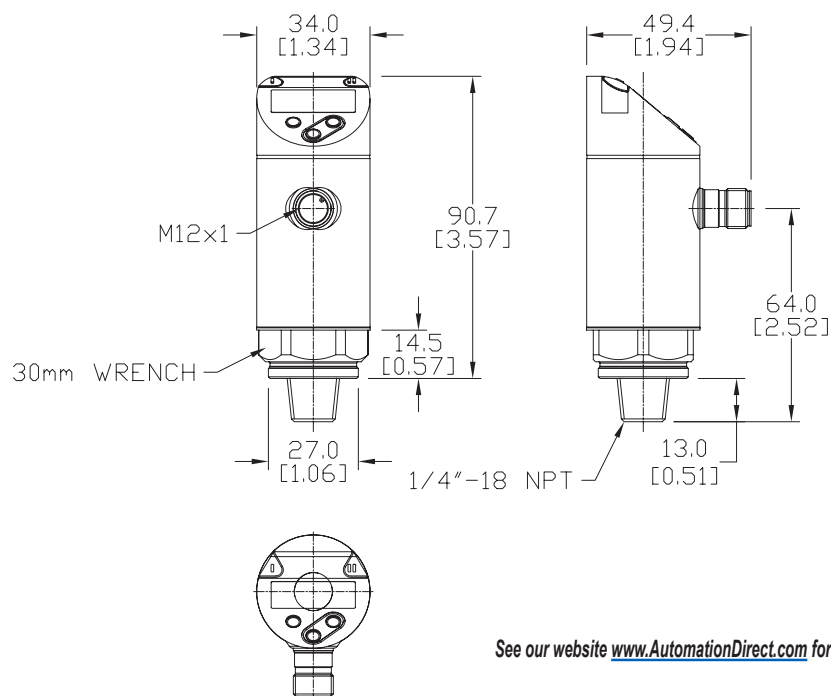

See our website [www.AutomationDirect.com](http://www.AutomationDirect.com) for complete Engineering drawings.



# EPS Series Digital Pressure Sensors - Accessories

Part No. [EPS-CV](#)Part No. [EPS-BKT1](#)

EPS Series Digital Pressure Sensors - Accessories			
Part No.	Description	Price	Wt (lb)
<a href="#">EPS-CV</a>	ProSense protective cover, for use with ProSense EPS series digital pressure sensors.	\$6.25	0.1
<a href="#">EPS-BKT1</a>	ProSense mounting bracket, for use with ProSense EPS series digital pressure sensors.	\$9.50	0.1

EPS Series Digital Pressure Sensor Accessory Specifications	
Part No.	Material
<a href="#">EPS-CV</a>	PP (polypropylene)
<a href="#">EPS-BKT1</a>	Fiber and mineral reinforced polyamide

## Dimensions

mm [inches]

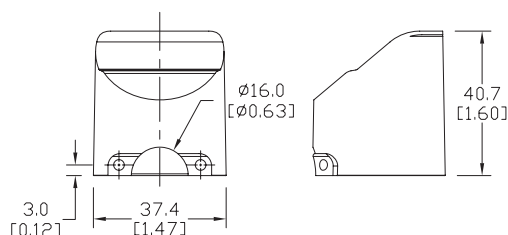
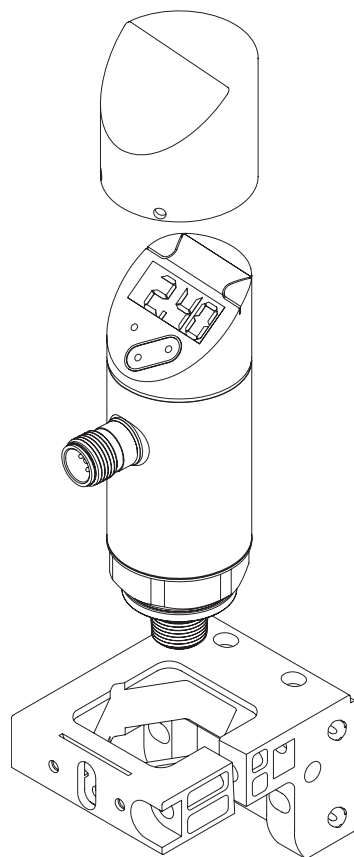
Part No. [EPS-CV](#)

Assembly Example

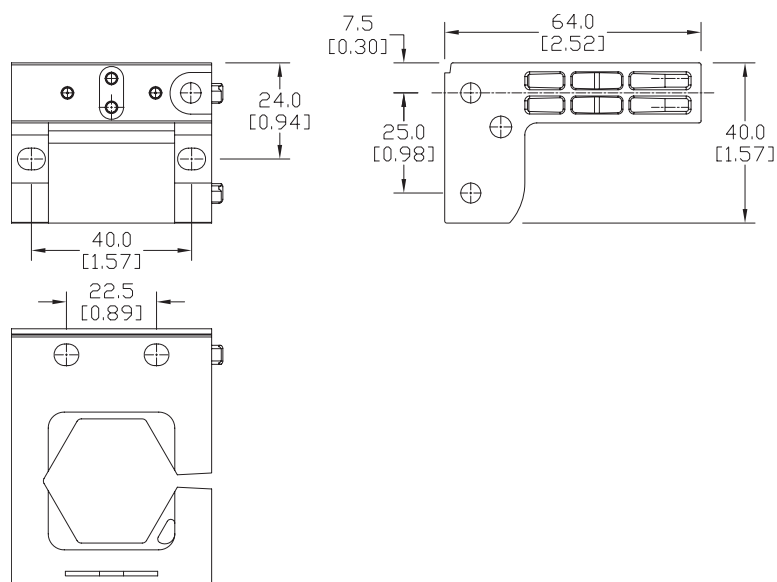
Part No. [EPS-BKT1](#)

See our website [www.AutomationDirect.com](http://www.AutomationDirect.com) for complete Engineering drawings.

# prosense® Digital Pressure Switch / Transmitter



## Overview

- Precision digital pressure switch/transmitter with 2 meter cable
- Two digital outputs (NPN or PNP) which may be set individually and a 4-20 mA analog output
- Two vacuum to pressure ranges (-14.5 to 14.5 and -14.5 psig to 145 psig)
- Air, non-corrosive/non-flammable gases only
- Three operation modes: Easy, Window and Hysteresis
- 3-color digital LCD display
- 6 pressure unit conversions
- Lockable keypad
- Unit parameters are easily copied to other units
- Selectable response times to eliminate output chattering
- Fast zero reset
- Optional panel mount and bracket kits
- 2-year warranty



E157382

## ProSense QPS Digital Pressure Switch / Transmitter

Part Number	Description	Pcs/Pkg	Wt (lb)	Price
<b>QPSL-AP-42</b>	Digital pressure switch/transmitter -14.5 to 14.5 psig, 2 PNP out, 4-20 mA out, cable included	1	0.24	\$87.00
<b>QPSL-AN-42</b>	Digital pressure switch/transmitter -14.5 to 14.5 psig, 2 NPN out, 4-20 mA out, cable included	1	0.24	\$87.00
<b>QPSH-AP-42</b>	Digital pressure switch/transmitter -14.5 to 145 psig, 2 PNP out, 4-20 mA out, cable included	1	0.24	\$87.00
<b>QPSH-AN-42</b>	Digital pressure switch/transmitter -14.5 to 145 psig, 2 NPN out, 4-20 mA out, cable included	1	0.24	\$87.00

## ProSense QPS Digital Pressure Switch / Transmitter Specifications

Model		QPSL-AP-42		QPSL-AN-42		QPSH-AP-42		QPSH-AN-42	
Pressure Range		-14.5 to +14.5 psig				-14.5 to +145 psig			
Maximum Pressure (Proof)		29 psig				217 psig			
Maximum Vacuum		-14.5 psig							
Pressure Accuracy		± 3% of full scale							
Temperature Influence @ 25°C		± 2% of full scale							
Fluid Measured		Air, Non-corrosive gas, Non-flammable gas							
Input Power		10.8 to 26.4 VDC							
Power Consumption		260mA maximum							
Digital Outputs	Output Type	2-PNP		2-NPN		2-PNP		2-NPN	
	Maximum Current	100mA							
	Response Time	2ms, 4ms, 10ms, 30ms, 50ms, 100ms, 250ms, 500ms, 1,000ms, 5,000ms selectable							
	Residual Voltage	1.5 VDC							
Analog Outputs	Output Type	4-20 mA							
	Maximum Output Load Resistance	400Ω							
	Linear Accuracy	< ± 2% of full scale							
Process Connection		1/8" NPT outer / M5 inner bore (Nickel Plated Brass)							
Cable		Included with each unit, 2 meter (6.6 feet), 5 conductor, 26AWG, PVC jacket, and 50mm pigtail leads Replacement cable : QPS-CBL							
IP Rating		IP 40							
Case Materials		Case = ABS Plastic, Lens = Polycarbonate							
Shock Immunity		10 ~ 500 Hz, 10mm 3 axes for 2 hours							
Vibration Immunity		Max. 100m / s2 3 axes 6 directions, 3 times each							
Operating Temperature		0°C to +50°C (32°F to 122°F)							
Storage Temperature		-20°C to +65°C (-4°F to 149°F)							
Altitude		< 2,000m							
Ambient Humidity		35% to 80% (non-condensing)							
Approvals		cULus (E157382), CE, RoHS							

# prosense® Digital Pressure Switch / Transmitter

## Display, Keypad, Connections

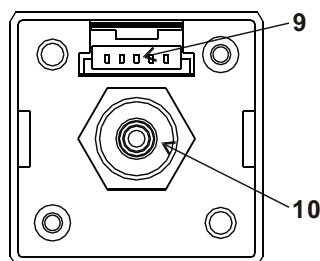
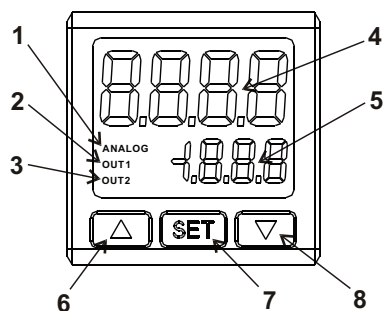

- 1 - Analog output indicator
- 2 - Digital output 1 indicator
- 3 - Digital output 2 indicator
- 4 - Pressure Value (PV)/parameter display (8 mm digits)
- 5 - Setpoint Value (SV)/setup item display (4 mm digits)
- 6 - Increment UP button
- 7 - SET or Enter button
- 8 - Decrement DOWN button
- 9 - Cable connection
- 10 - Pressure connection

## Dimensions

mm [inches]

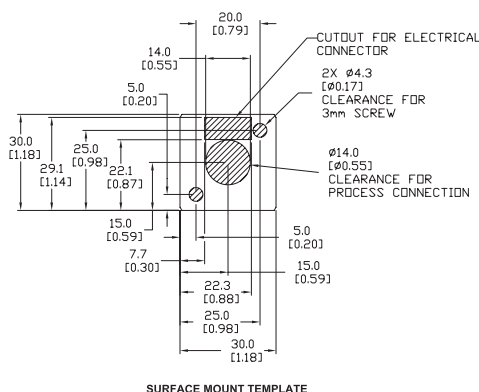
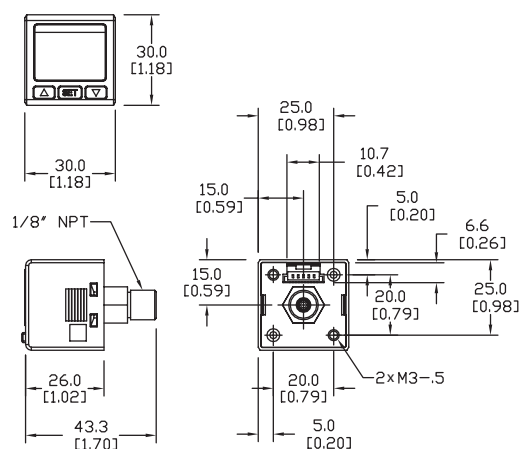

## Cable Connection Terminals

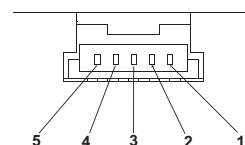

- 1 - Positive power supply input (brown)
- 2 - Digital output 1 signal (black)
- 3 - Digital output 2 signal (white)
- 4 - Analog output signal (orange)
- 5 - Negative power supply input (blue)

See our website [www.AutomationDirect.com](http://www.AutomationDirect.com) for complete Engineering drawings.

## Wiring

### QPSL-AN-42 QPSH-AN-42

Outputs:  
NPN discrete  
4-20mA analog

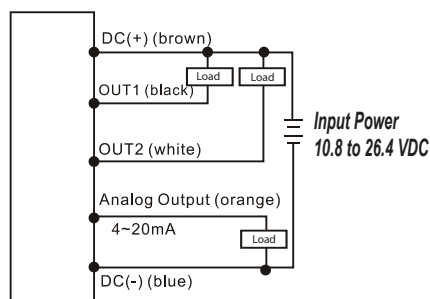

### QPSL-AP-42 QPSH-AP-42

Outputs:  
PNP discrete  
4-20mA analog

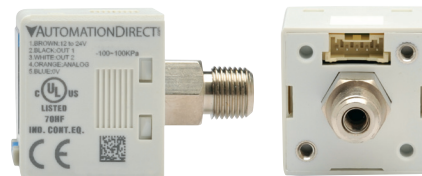
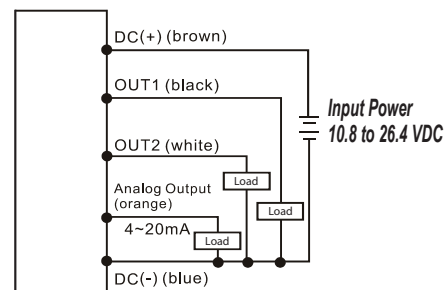

# prosense® Digital Pressure Switch / Transmitter

## Operating Modes:

**Easy Mode:** When the measured pressure is greater than pressure setpoint plus the hysteresis setting ( $SV + \text{hysteresis}$ ), the output will change state. When the measured pressure is less than the pressure setpoint ( $<SV$ ), the output will change state. Each digital output can be individually set.

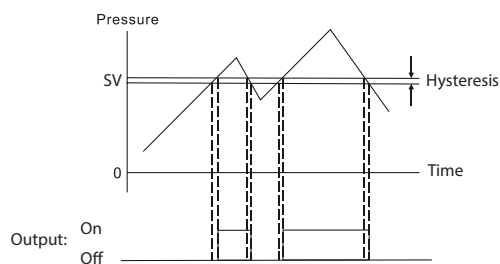

**Hysteresis Mode:** When the measured pressure is greater than the Hi setpoint, the output will change state. When the measured pressure is less than the Lo setpoint, the output will change state. Each digital output can be individually set.

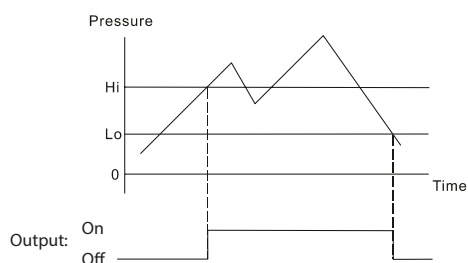

**Window Mode:** The output will change state when the measured pressure increases to the Lo setpoint plus the hysteresis setting ( $Lo + \text{hysteresis}$ ) and will change state again when the pressure increases to the Hi setpoint plus the hysteresis setting ( $Hi + \text{hysteresis}$ ). When the pressure decreases to the Hi setpoint the output will change state and will change state again when the pressure decreases to the Lo setpoint.

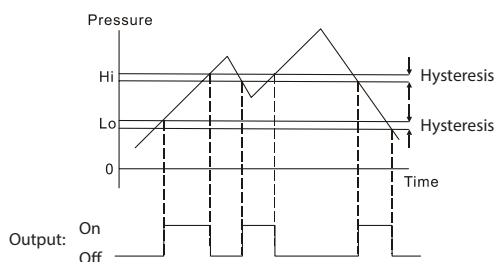

**Analog Output (4-20mA):** The analog output is directly proportional to the process pressure over the full range of the device. For example if the process pressure is 0 psig the 4-20 mA output of a QPSL will be approximately 12 mA or for the QPSH the pressure at 12 mA would be 65.3 psig and for 0 psig the output would be 5.45mA. The analog output is enabled as the factory default. It can be disabled with the "Analog Output Enable" parameter in Pro Setup Mode.

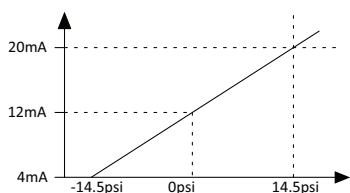

QPSL-xx-42

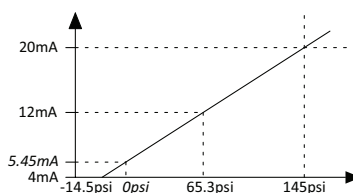

QPSH-xx-42



# prosense® Digital Pressure Switch / Transmitter Accessories

ProSense QPS Digital Pressure Switch / Transmitter Accessories				
Part Number	Description	Pcs/Pkg	Wt (lb)	Price
<b>QPS-PMK</b>	Panel mount kit for QPS series	1	0.1	\$2.00
<b>QPS-FMK</b>	Bracket mount kit for QPS series	1	0.1	\$2.00
<b>QPS-CBL</b>	Replacement cable for QPS series digital pressure switch and transmitter, 2 meters (6.6 feet)	1	0.1	\$29.00

**QPS-PMK****QPS-FMK****QPS-CBL**

## Dimensions

mm [inches]

### QPS-PMK - Optional Panel Mount Kit

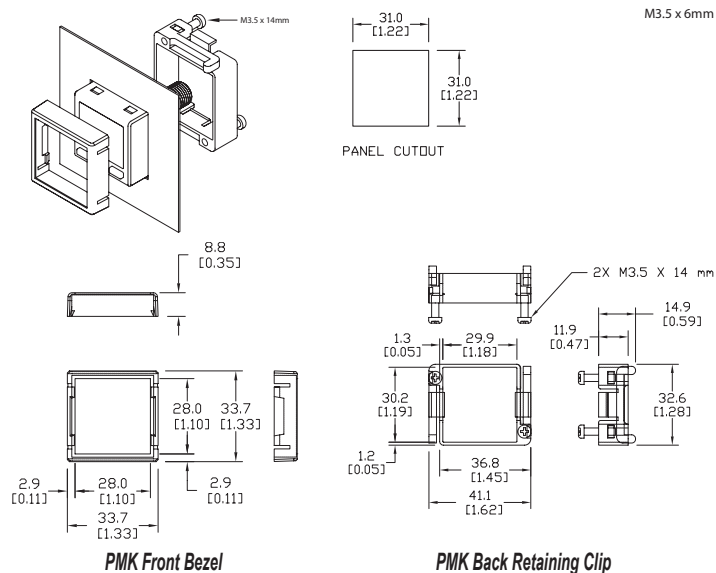

### QPS-FMK - Optional Frame Mount Kit

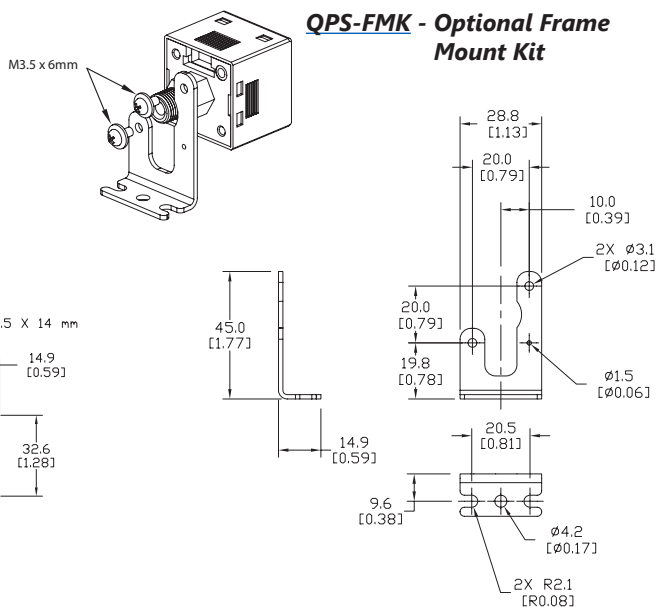

**Note: See the NITRA Pneumatics section for Push-to-Connect fittings and tubing**

### QPS-CBL

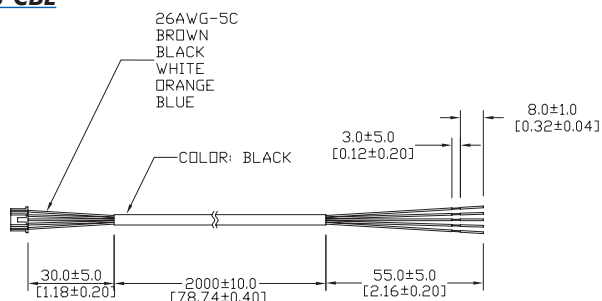

**Note: Cable included with each QPS series switch/transmitter**

# prosense® DPG1 Series Digital Pressure Gauges



ProSense DPG1 digital pressure gauges are ideal for industrial and general purpose applications requiring an accurate and reliable device with easy to read digital display.

## Features

- $\pm 0.5\%$  accuracy
- 2-button operation
- Backlight display turns on when on/off button is pressed
- Option for continuous peak pressure indication
- Continuous on display option or timeout to save battery life
- Wide variety of pressure unit selections
- Reset to zero feature
- Powered via 2 x AAA batteries (included)
- Rubber boot for added protection (included)
- 316L welded diaphragm seal
- ASME B40.100 compliant

## DPG1 Series Digital Pressure Gauges

Part Number	Scale	Pcs/Pkg	Wt (lb)	Price
<a href="#">DPG1-15</a>	0 to 15 psig	1	0.7	\$151.00
<a href="#">DPG1-30</a>	0 to 30 psig	1	0.7	\$151.00
<a href="#">DPG1-60</a>	0 to 60 psig	1	0.7	\$151.00
<a href="#">DPG1-100</a>	0 to 100 psig	1	0.7	\$151.00
<a href="#">DPG1-200</a>	0 to 200 psig	1	0.7	\$151.00
<a href="#">DPG1-300</a>	0 to 300 psig	1	0.7	\$151.00
<a href="#">DPG1-600</a>	0 to 600 psig	1	0.7	\$151.00
<a href="#">DPG1-1000</a>	0 to 1000 psig	1	0.7	\$151.00
<a href="#">DPG1-3000</a>	0 to 3000 psig	1	0.7	\$151.00
<a href="#">DPG1-5000</a>	0 to 5000 psig	1	0.7	\$151.00



**NOTE: CHECK THE CHEMICAL COMPATIBILITY OF THE SENSOR'S WETTED PARTS WITH THE MEDIUM TO BE MEASURED**

## DPG1 Series Digital Pressure Gauges

Part Number	Operating Pressure	Proof Pressure	Burst Pressure
<a href="#">DPG1-15</a>	0 to 15 psig	30 psig	45 psig
<a href="#">DPG1-30</a>	0 to 30 psig	60 psig	90 psig
<a href="#">DPG1-60</a>	0 to 60 psig	120 psig	180 psig
<a href="#">DPG1-100</a>	0 to 100 psig	200 psig	300 psig
<a href="#">DPG1-200</a>	0 to 200 psig	400 psig	600 psig
<a href="#">DPG1-300</a>	0 to 300 psig	600 psig	900 psig
<a href="#">DPG1-600</a>	0 to 600 psig	1200 psig	1800 psig
<a href="#">DPG1-1000</a>	0 to 1000 psig	2000 psig	3000 psig
<a href="#">DPG1-3000</a>	0 to 3000 psig	6000 psig	9000 psig
<a href="#">DPG1-5000</a>	0 to 5000 psig	10000 psig	15000 psig



**WARNING! AVOID STATIC AND DYNAMIC OVERPRESSURE EXCEEDING THE SPECIFIED PROOF PRESSURE. EXCEEDING THE BURSTING PRESSURE FOR EVEN A SHORT TIME CAN CAUSE DESTRUCTION OF THE UNIT AND POSSIBLE INJURIES! NOT FOR USE IN VACUUM APPLICATIONS. NEGATIVE PRESSURE CAN DAMAGE GAUGE.**

## DPG1 Series Digital Pressure Gauge Specifications

<b>Case Size</b>	2.5" (63mm)
<b>Case Material</b>	ABS (acrylonitrile butadiene styrene)
<b>Rubber Boot</b>	Silicone rubber
<b>LCD Display</b>	2" x 3/4" (48mm x 16mm)
<b>Process Connection</b>	1/4" NPT
<b>Sensor</b>	Piezo, welded
<b>Wetted Parts</b>	304SS, 316L
<b>Operating Life</b>	1 million cycles
<b>Power Supply</b>	2 x AAA battery (1.5V) - included/installed
<b>Battery Life</b>	2 years (auto shut-off mode), 2 weeks if on continuously
<b>Power Mode</b>	Auto or manual shut-off
<b>Display Digits</b>	4-digits, 12.5 mm character height
<b>Pressure Unit Selection</b>	psi, mH <sub>2</sub> O, mmHg, mbar, kPa range $\leq 100$ psig psi, bar, kg/cm <sup>2</sup> , MPa, atm ranges $\geq 200$ psig
<b>Response Time</b>	$\leq 3$ Hz display refresh rate
<b>Proof / Burst Pressure</b>	200% / 300% of full scale
<b>Operating Temperature</b>	14°F to 122°F (-10°C to 50°C)
<b>Storage Temperature</b>	-4°F to 167°F (-20°C to 75°C)
<b>Accuracy</b>	$\pm 0.5\%$ of full scale
<b>Enclosure Rating</b>	IP60
<b>Approvals*</b>	None

\* To obtain the most current agency approval information, see the Agency Approval Checklist section on the specific part number's web page

# prosense® DPG1 Series Digital Pressure Gauges

## Dimensions

mm [inches]

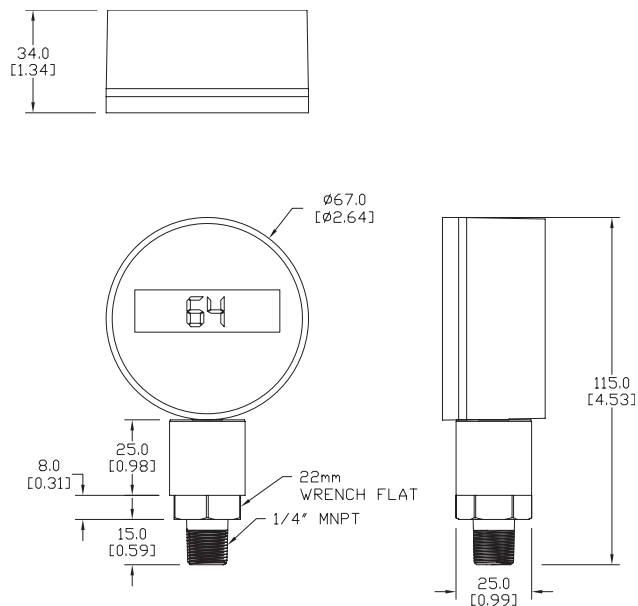

DPG1 Gauges without Rubber Boot Installed

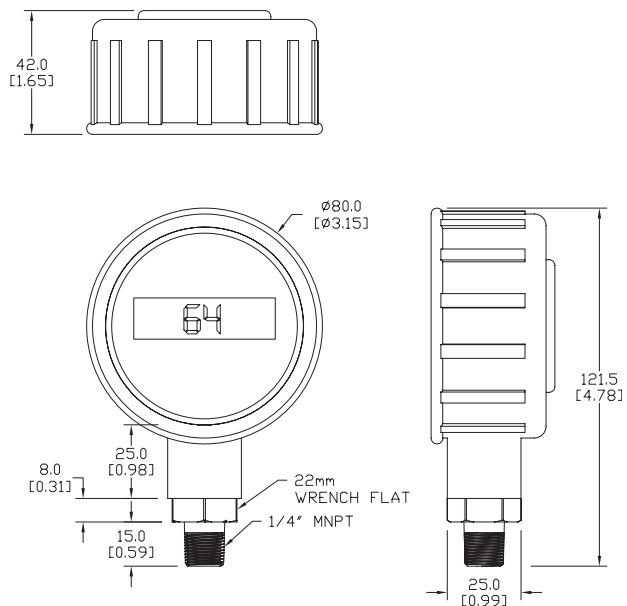

DPG1 Gauges with Rubber Boot Installed

See our website [www.AutomationDirect.com](http://www.AutomationDirect.com) for complete Engineering drawings.

# proSense® Pressure Gauges



## Bourdon Tube Pressure Gauges

ProSense mechanical dial pressure gauges are available in a variety of configurations for use in most pneumatic, hydraulic, HVAC, plumbing, industrial and commercial applications. These high quality gauges use Bourdon tube sensing elements and do not require any external power sources to operate other than the media being sensed. Cases are available in durable steel or stainless steel and in either dry or liquid filled to dampen vibration and pulsations. Brass wetted parts are suitable for air, oil, or water applications while stainless steel wetted parts are available for corrosive applications. Dual marked dial faces (psig/kPa or inHg/kPa) are available in pressure ranges from vacuum up to 6000 psig.

The Bourdon tube pressure gauge applies the principle that a flattened tube will change to a more circular cross-section when pressurized. These tubes are then bent into a C-shape with one end crimped close and the other connected to the process. When the pressure inside the tube becomes greater than the ambient pressure the tube tries to straighten; this elongation is converted to a rotational motion with the use of a pinion gear attached to the pointer.



The bourdon tubes are calibrated at the factory for a specific range known as gauge pressure\*. This pressure is relative to ambient atmospheric pressure.

## Pressure Gauge Terms:

- **Atmospheric Pressure:** The weight of a column of air measuring one square inch from sea level to the top of the atmosphere. Sea level pressure = 29.92 inHg / 101.325 kPa / 14.696 psig / 1.0132 bar
- **Absolute Pressure:** Zero (0) in reference to a perfect vacuum  
"Absolute Pressure" = gauge pressure (+) atmospheric pressure.
- **\*Gauge Pressure:** Zero (0) in reference to "Atmospheric Pressure".  
"Gauge Pressure" = absolute pressure (-) atmospheric pressure.
- **Differential Pressure:** Is the difference in pressure between two measuring points.

## Gauge Accuracy and Grade

Gauge accuracy and grade categorized by ASME (ANSI) Standard B40.1	
Gauge Accuracy	ANSI Grade
±5% Full Scale	D
±3% lower ¼ Scale; ±2% middle ½ scale; ±3% upper ¼ scale	B
±2% lower ¼ Scale; ±1% middle ½ scale; ±2% upper ¼ scale	A
±1% Full Scale	1A
±0.5% Full Scale	2A
±0.25% Full Scale	3A

## Gauge Selection Considerations

### Environment and Application

As the Bourdon tube is in direct contact with the medium being measured, the characteristics of the medium must be considered. If the medium is corrosive, stainless steel internals and casing should be chosen over brass. Brass is more suitable for general applications. The effects of moisture and weather conditions may also be harmful to the gauge and should be considered when selecting a gauge. Liquid filled gauges help prevent moisture build-up. Medium that will leave a deposit, clog or solidify in the Bourdon tube should be avoided.

For applications that produce harmful pulsation, vibration or pressure spikes, a liquid filled gauge will minimize the effects of vibration and provide a more accurate pressure reading.

### Gauge Size

ProSense gauges are available with dial sizes of 1.5, 2 or 2.5 inches.

### Connection

ProSense gauges offer lower and center back connections. The standard threads are 1/8" and 1/4" NPT.

### Accuracy

The degree of accuracy required should be determined to ensure that the proper gauge is used. ProSense gauges offer accuracies of +/- 1.5% or +/- 3-2-3% (ANSI/ASME Grade B). Generally, the more critical the application, the higher the accuracy required.

### Gauge Mounting

ProSense pressure gauges can be mounted in a variety of ways. For direct stem mount, we offer lower and center back connections. Bear in mind that if a piece of equipment produces heavy vibration making pressure reading difficult due to needle fluctuations, consider a liquid-filled gauge or remote mounting.

### Pressure Range

It is important to select a pressure range that is approximately twice the normal operating pressure of the media. The maximum operating pressure should not exceed 75% of the full scale range. If a gauge is not selected considering these criteria, it may result in fatigue of the Bourdon tube.

### Temperature Range

The normal temperature ranges for dry gauges are between -40°C to 65°C (-40°F to 150°F). The normal temperature ranges for glycerin-filled gauges are -20°C to 65°C (-4°F to 150°F). It is important to know the normal operating temperature of the environment for proper gauge use.

Click on the thumbnail or go to <https://www.automationdirect.com/VID-PR-0002> for a short video on ProSense Dial Pressure Gauges

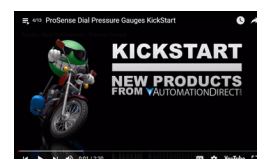

# prosense® Steel Case / Brass Wetted Pressure Gauges

Lower Mount



Center Back Mount



## Features

- Economical, all-purpose pressure gauge
- Friction bezel rings
- Dual scale (psig/kPa)
- Brass wetted parts for use with air, oil, water and non-corrosive liquids
- $\pm 3$ -2-3% accuracy - ASME/ANSI Grade B
- 5 year warranty

## Applications

- Plumbing, heating, air conditioning, pneumatic, hydraulic, water tanks, air compressors, OEM, general purpose

### ProSense 1.5" Steel Case / Brass Wetted Pressure Gauges

Part Number	Description	Pcs/Pkg	Wt(lb)	Price
<a href="#"><u>G15-BDV-8LB</u></a>	Gauge, 1.5 in., steel case, dry, -30 to 0 inHg/-100 to 0 kPa vacuum, brass-1/8 NPT, lower mount	1	0.20	\$10.50
<a href="#"><u>G15-BD30-8LB</u></a>	Gauge, 1.5 in., steel case, dry, 0:30 psig/0-200 kPa, brass-1/8 NPT, lower mount	1	0.20	\$10.50
<a href="#"><u>G15-BD60-8LB</u></a>	Gauge, 1.5 in., steel case, dry, 0:60 psig/0-400 kPa, brass-1/8 NPT, lower mount	1	0.20	\$10.50
<a href="#"><u>G15-BD100-8LB</u></a>	Gauge, 1.5 in., steel case, dry, 0:100 psig/0-700 kPa, brass-1/8 NPT, lower mount	1	0.20	\$10.50
<a href="#"><u>G15-BD160-8LB</u></a>	Gauge, 1.5 in., steel case, dry, 0:160 psig/0-1,100 kPa, brass-1/8 NPT, lower mount	1	0.20	\$10.50
<a href="#"><u>G15-BD200-8LB</u></a>	Gauge, 1.5 in., steel case, dry, 0:200 psig/0-1,400 kPa, brass-1/8 NPT, lower mount	1	0.20	\$10.50
<a href="#"><u>G15-BDV-8CB</u></a>	Gauge, 1.5 in., steel case, dry, -30 to 0 inHg/-100 to 0 kPa vacuum, brass-1/8 NPT, center back mount	1	0.20	\$10.50
<a href="#"><u>G15-BD30-8CB</u></a>	Gauge, 1.5 in., steel case, dry, 0:30 psig/0-200 kPa, brass-1/8 NPT, center back mount	1	0.20	\$10.50
<a href="#"><u>G15-BD60-8CB</u></a>	Gauge, 1.5 in., steel case, dry, 0:60 psig/0-400 kPa, brass-1/8 NPT, center back mount	1	0.20	\$10.50
<a href="#"><u>G15-BD100-8CB</u></a>	Gauge, 1.5 in., steel case, dry, 0:100 psig/0-700 kPa, brass-1/8 NPT, center back mount	1	0.20	\$10.50
<a href="#"><u>G15-BD160-8CB</u></a>	Gauge, 1.5 in., steel case, dry, 0:160 psig/0-1,100 kPa, brass-1/8 NPT, center back mount	1	0.20	\$10.50
<a href="#"><u>G15-BD200-8CB</u></a>	Gauge, 1.5 in., steel case, dry, 0:200 psig/0-1,400 kPa, brass-1/8 NPT, center back mount	1	0.20	\$10.50

### ProSense 2" Steel Case / Brass Wetted Pressure Gauges

Part Number	Description	Pcs/Pkg	Wt(lb)	Price
<a href="#"><u>G20-BDV-4LB</u></a>	Gauge, 2.0 in., steel case, dry, -30 to 0 inHg/-100 to 0 kPa vacuum, brass-1/4 NPT, lower mount	1	0.20	\$11.00
<a href="#"><u>G20-BD30-4LB</u></a>	Gauge, 2.0 in., steel case, dry, 0:30 psig/0-200 kPa, brass-1/4 NPT, lower mount	1	0.20	\$11.00
<a href="#"><u>G20-BD60-4LB</u></a>	Gauge, 2.0 in., steel case, dry, 0:60 psig/0-400 kPa, brass-1/4 NPT, lower mount	1	0.20	\$11.00
<a href="#"><u>G20-BD100-4LB</u></a>	Gauge, 2.0 in., steel case, dry, 0:100 psig/0-700 kPa, brass-1/4 NPT, lower mount	1	0.20	\$11.00
<a href="#"><u>G20-BD160-4LB</u></a>	Gauge, 2.0 in., steel case, dry, 0:160 psig/0-1,100 kPa, brass-1/4 NPT, lower mount	1	0.20	\$11.00
<a href="#"><u>G20-BD200-4LB</u></a>	Gauge, 2.0 in., steel case, dry, 0:200 psig/0-1,400 kPa, brass-1/4 NPT, lower mount	1	0.20	\$11.00
<a href="#"><u>G20-BDV-4CB</u></a>	Gauge, 2.0 in., steel case, dry, -30 to 0 inHg/-100 to 0 kPa vacuum, brass-1/4 NPT, center back mount	1	0.20	\$11.00
<a href="#"><u>G20-BD30-4CB</u></a>	Gauge, 2.0 in., steel case, dry, 0:30 psig/0-200 kPa, brass-1/4 NPT, center back mount	1	0.20	\$11.00
<a href="#"><u>G20-BD60-4CB</u></a>	Gauge, 2.0 in., steel case, dry, 0:60 psig/0-400 kPa, brass-1/4 NPT, center back mount	1	0.20	\$11.00
<a href="#"><u>G20-BD100-4CB</u></a>	Gauge, 2.0 in., steel case, dry, 0:100 psig/0-700 kPa, brass-1/4 NPT, center back mount	1	0.20	\$11.00
<a href="#"><u>G20-BD160-4CB</u></a>	Gauge, 2.0 in., steel case, dry, 0:160 psig/0-1,100 kPa, brass-1/4 NPT, center back mount	1	0.20	\$11.00
<a href="#"><u>G20-BD200-4CB</u></a>	Gauge, 2.0 in., steel case, dry, 0:200 psig/0-1,400 kPa, brass-1/4 NPT, center back mount	1	0.20	\$11.00

### ProSense 2.5" Steel Case / Brass Wetted Pressure Gauges

Part Number	Description	Pcs/Pkg	Wt(lb)	Price
<a href="#"><u>G25-BDV-4LB</u></a>	Gauge, 2.5 in., steel case, dry, -30 to 0 inHg/-100 to 0 kPa vacuum, brass-1/4 NPT, lower mount	1	0.30	\$11.00
<a href="#"><u>G25-BD30-4LB</u></a>	Gauge, 2.5 in., steel case, dry, 0:30 psig/0-200 kPa, brass-1/4 NPT, lower mount	1	0.30	\$11.00
<a href="#"><u>G25-BD60-4LB</u></a>	Gauge, 2.5 in., steel case, dry, 0:60 psig/0-400 kPa, brass-1/4 NPT, lower mount	1	0.30	\$11.00
<a href="#"><u>G25-BD100-4LB</u></a>	Gauge, 2.5 in., steel case, dry, 0:100 psig/0-700 kPa, brass-1/4 NPT, lower mount	1	0.30	\$11.00
<a href="#"><u>G25-BD160-4LB</u></a>	Gauge, 2.5 in., steel case, dry, 0:160 psig/0-1,100 kPa, brass-1/4 NPT, lower mount	1	0.30	\$11.00
<a href="#"><u>G25-BD200-4LB</u></a>	Gauge, 2.5 in., steel case, dry, 0:200 psig/0-1,400 kPa, brass-1/4 NPT, lower mount	1	0.30	\$11.00
<a href="#"><u>G25-BD300-4LB</u></a>	Gauge, 2.5 in., steel case, dry, 0:300 psig/0-2,000 kPa, brass-1/4 NPT, lower mount	1	0.30	\$11.00
<a href="#"><u>G25-BD600-4LB</u></a>	Gauge, 2.5 in., steel case, dry, 0:600 psig/0-4,200 kPa, brass-1/4 NPT, lower mount	1	0.30	\$11.00
<a href="#"><u>G25-BD1000-4LB</u></a>	Gauge, 2.5 in., steel case, dry, 0:1000 psig/0-7,000 kPa, brass-1/4 NPT, lower mount	1	0.30	\$11.00
<a href="#"><u>G25-BDV-4CB</u></a>	Gauge, 2.5 in., steel case, dry, -30 to 0 inHg/-100 to 0 kPa vacuum, brass-1/4 NPT, center back mount	1	0.30	\$11.00
<a href="#"><u>G25-BD30-4CB</u></a>	Gauge, 2.5 in., steel case, dry, 0:30 psig/0-200 kPa, brass-1/4 NPT, center back mount	1	0.30	\$11.00
<a href="#"><u>G25-BD60-4CB</u></a>	Gauge, 2.5 in., steel case, dry, 0:60 psig/0-400 kPa, brass-1/4 NPT, center back mount	1	0.30	\$11.00
<a href="#"><u>G25-BD100-4CB</u></a>	Gauge, 2.5 in., steel case, dry, 0:100 psig/0-700 kPa, brass-1/4 NPT, center back mount	1	0.30	\$11.00
<a href="#"><u>G25-BD160-4CB</u></a>	Gauge, 2.5 in., steel case, dry, 0:160 psig/0-1,100 kPa, brass-1/4 NPT, center back mount	1	0.30	\$11.00
<a href="#"><u>G25-BD200-4CB</u></a>	Gauge, 2.5 in., steel case, dry, 0:200 psig/0-1,400 kPa, brass-1/4 NPT, center back mount	1	0.30	\$11.00



# prosense® Steel Case / Brass Wetted Pressure Gauges

ProSense Steel Case / Brass Wetted Gauges Specifications			
Dial Size	1.5" [40 mm]	2.0" [50 mm]	2.5" [63 mm]
Case	Steel, Painted Black		
Lens	Polycarbonate		
Ring	Steel, Painted Black		
Socket	Brass*		
Connection	1/8" NPT	1/4" NPT	1/4" NPT
Fill Liquid	None		
Bourdon Tube	Phosphor Bronze		
Movement	Brass*		
Wetted Parts	Brass, Phosphor Bronze		
Pointer	Aluminum, Painted Black		
Welding	Silver Alloy		
Over Pressure Limit	125% of full scale		
Working Pressure	Maximum 75% of full scale value		
Ambient/Process Temperature	-40 °F to 150 °F (-40 °C to 65 °C)		
Accuracy	±3-2.3% ANSI/ASME Grade B		
Enclosure Rating	IP52		

\*Leaded Brass not suitable for use in drinking water or other food & beverage applications.



**WARNING: CHECK THE CHEMICAL COMPATIBILITY OF THE GAUGE'S WETTED PARTS WITH THE MEDIUM TO BE MEASURED. USE A SUITABLE THREAD SEALANT SUCH AS TEFLON® TAPE. ALWAYS TIGHTEN WITH AN OPEN END OR ADJUSTABLE WRENCH ON THE WRENCH FLATS. NEVER USE ANY PART OF THE PRESSURE GAUGE TO TIGHTEN OTHER THAN THE WRENCH FLATS THAT ARE ON THE GAUGE SOCKET. FAILURE TO DO SO WILL SEVERELY DAMAGE THE PRESSURE GAUGE.**

## Dimensions

### Lower Mount

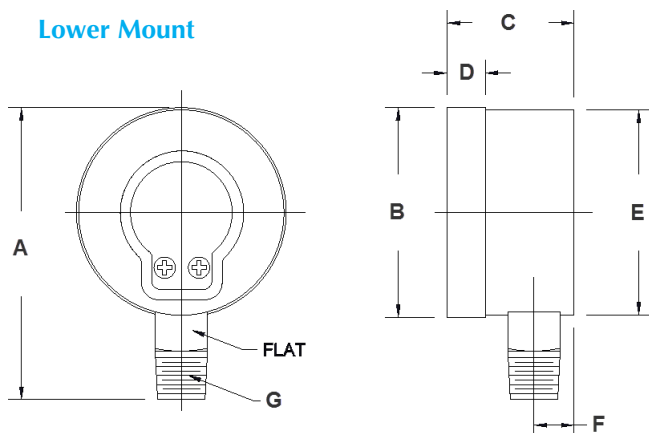

Dimensions - Lower Mount Gauges			
Dial	1.5" [40 mm]	2.0" [50 mm]	2.5" [63 mm]
A	2.300" [58.4 mm]	2.992" [76.0 mm]	3.189" [81.0 mm]
B	1.653" [42.0 mm]	2.190" [55.6 mm]	2.488" [63.2 mm]
C	1.000" [25.4 mm]	1.161" [29.5 mm]	1.102" [28.0 mm]
D	0.300" [7.6 mm]	0.378" [9.6 mm]	0.394" [10.0 mm]
E	1.617" [41.0 mm]	2.126" [54.0 mm]	2.441" [62.0 mm]
F	0.315" [8.0 mm]	0.394" [10.0 mm]	0.433" [11.0 mm]
G	1/8" NPT	1/4" NPT	1/4" NPT

### Center Back Mount

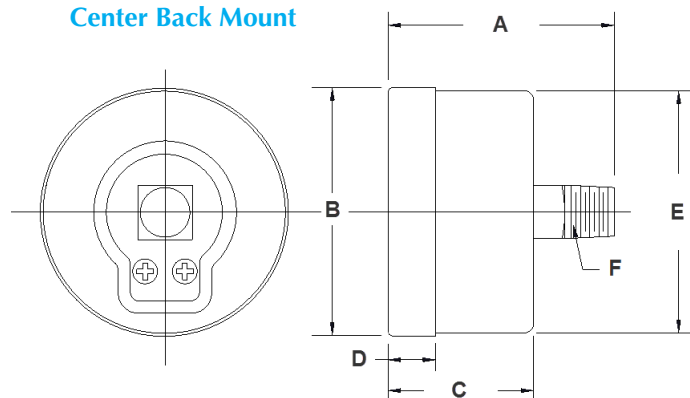

Dimensions - Center Back Mount Gauges			
Dial	1.5" [40 mm]	2.0" [50 mm]	2.5" [63 mm]
A	1.515" [38.5 mm]	1.850" [47.0 mm]	1.850" [47.0 mm]
B	1.660" [42.1 mm]	2.070" [52.5 mm]	2.500" [63.4 mm]
C	0.975" [24.6 mm]	1.079" [27.4 mm]	1.079" [27.4 mm]
D	0.320" [8.1 mm]	0.394" [10 mm]	0.394" [10.0 mm]
E	1.620" [41.1 mm]	2.008" [51.0 mm]	2.421" [61.5 mm]
F	1/8" NPT	1/4" NPT	1/4" NPT

See our website [www.AutomationDirect.com](http://www.AutomationDirect.com) for complete Engineering drawings.

# prosense® Stainless Steel Case / Brass Wetted Pressure Gauges

**Liquid Filled Case  
Lower Mount**



**Liquid Filled Case  
Center Back Mount**



## Features

- Brass wetted parts for use with air, oil, water and non-corrosive liquids
- Restricted orifice to dampen pressure surges
- Crimp-on bezel
- Dual scale (psig/kPa)
- Glycerin filled case to reduce needle fluctuations due to vibration
- $\pm 1.5\%$  of full scale value accuracy
- 5 year warranty

## Applications

- Ideal for pumps, compressors, hydraulic presses, machinery, pneumatic equipment and motors in harsh environments

### ProSense 2.5" Stainless Steel Case / Brass Wetted Glycerin Filled Pressure Gauges

Part Number	Description	Pcs/Pkg	Wt(lb)	Price
<a href="#"><u>G25-SLV-4LB</u></a>	Gauge, 2.5 in., SS Case, liquid fill, -30 to 0 inHg vacuum/-100 to 0 kPa vacuum, brass-1/4 NPT, lower mount	1	0.5	\$19.50
<a href="#"><u>G25-SL30-4LB</u></a>	Gauge, 2.5 in., SS Case, liquid fill, 0-30 psig/0-200 kPa, brass-1/4 NPT, lower mount	1	0.5	\$19.50
<a href="#"><u>G25-SL60-4LB</u></a>	Gauge, 2.5 in., SS Case, liquid fill, 0-60 psig/0-420 kPa, brass-1/4 NPT, lower mount	1	0.5	\$19.50
<a href="#"><u>G25-SL100-4LB</u></a>	Gauge, 2.5 in., SS Case, liquid fill, 0-100 psig/0-700 kPa, brass-1/4 NPT, lower mount	1	0.5	\$19.50
<a href="#"><u>G25-SL160-4LB</u></a>	Gauge, 2.5 in., SS Case, liquid fill, 0-160 psig/0-1,100 kPa, brass-1/4 NPT, lower mount	1	0.5	\$19.50
<a href="#"><u>G25-SL200-4LB</u></a>	Gauge, 2.5 in., SS Case, liquid fill, 0-200 psig/0-1,400 kPa, brass-1/4 NPT, lower mount	1	0.5	\$19.50
<a href="#"><u>G25-SL300-4LB</u></a>	Gauge, 2.5 in., SS Case, liquid fill, 0-300 psig/0-2,000 kPa, brass-1/4 NPT, lower mount	1	0.5	\$19.50
<a href="#"><u>G25-SL600-4LB</u></a>	Gauge, 2.5 in., SS Case, liquid fill, 0-600 psig/0-4,200 kPa, brass-1/4 NPT, lower mount	1	0.5	\$19.50
<a href="#"><u>G25-SL1000-4LB</u></a>	Gauge, 2.5 in., SS Case, liquid fill, 0-1000 psig/0-7,000 kPa, brass-1/4 NPT, lower mount	1	0.5	\$19.50
<a href="#"><u>G25-SL1500-4LB</u></a>	Gauge, 2.5 in., SS Case, liquid fill, 0-1500 psig/0-10,000 kPa, brass-1/4 NPT, lower mount	1	0.5	\$19.50
<a href="#"><u>G25-SL2000-4LB</u></a>	Gauge, 2.5 in., SS Case, liquid fill, 0-2000 psig/0-14,000 kPa, brass-1/4 NPT, lower mount	1	0.5	\$19.50
<a href="#"><u>G25-SL3000-4LB</u></a>	Gauge, 2.5 in., SS Case, liquid fill, 0-3000 psig/0-21,000 kPa, brass-1/4 NPT, lower mount	1	0.5	\$19.50
<a href="#"><u>G25-SL6000-4LB</u></a>	Gauge, 2.5 in., SS Case, liquid fill, 0-6000 psig/0-42,000 kPa, brass-1/4 NPT, lower mount	1	0.5	\$19.50
<a href="#"><u>G25-SLV-4CB</u></a>	Gauge, 2.5 in., SS Case, liquid fill, -30 to 0 inHg vacuum/-100 to 0 kPa vacuum, brass-1/4 NPT, center back mount	1	0.5	\$19.50
<a href="#"><u>G25-SL30-4CB</u></a>	Gauge, 2.5 in., SS Case, liquid fill, 0-30 psig/0-200 kPa, brass-1/4 NPT, center back mount	1	0.5	\$19.50
<a href="#"><u>G25-SL60-4CB</u></a>	Gauge, 2.5 in., SS Case, liquid fill, 0-60 psig/0-420 kPa, brass-1/4 NPT, center back mount	1	0.5	\$19.50
<a href="#"><u>G25-SL100-4CB</u></a>	Gauge, 2.5 in., SS Case, liquid fill, 0-100 psig/0-700 kPa, brass-1/4 NPT, center back mount	1	0.5	\$19.50
<a href="#"><u>G25-SL160-4CB</u></a>	Gauge, 2.5 in., SS Case, liquid fill, 0-160 psig/0-1,100 kPa, brass-1/4 NPT, center back mount	1	0.5	\$19.50
<a href="#"><u>G25-SL200-4CB</u></a>	Gauge, 2.5 in., SS Case, liquid fill, 0-200 psig/0-1,400 kPa, brass-1/4 NPT, center back mount	1	0.5	\$19.50
<a href="#"><u>G25-SL300-4CB</u></a>	Gauge, 2.5 in., SS Case, liquid fill, 0-300 psig/0-2,000 kPa, brass-1/4 NPT, center back mount	1	0.5	\$19.50
<a href="#"><u>G25-SL600-4CB</u></a>	Gauge, 2.5 in., SS Case, liquid fill, 0-600 psig/0-4,200 kPa, brass-1/4 NPT, center back mount	1	0.5	\$19.50
<a href="#"><u>G25-SL1000-4CB</u></a>	Gauge, 2.5 in., SS Case, liquid fill, 0-1000 psig/0-7,000 kPa, brass-1/4 NPT, center back mount	1	0.5	\$19.50
<a href="#"><u>G25-SL1500-4CB</u></a>	Gauge, 2.5 in., SS Case, liquid fill, 0-1500 psig/0-10,000 kPa, brass-1/4 NPT, center back mount	1	0.5	\$19.50
<a href="#"><u>G25-SL2000-4CB</u></a>	Gauge, 2.5 in., SS Case, liquid fill, 0-2000 psig/0-14,000 kPa, brass-1/4 NPT, center back mount	1	0.5	\$19.50
<a href="#"><u>G25-SL3000-4CB</u></a>	Gauge, 2.5 in., SS Case, liquid fill, 0-3000 psig/0-21,000 kPa, brass-1/4 NPT, center back mount	1	0.5	\$19.50
<a href="#"><u>G25-SL6000-4CB</u></a>	Gauge, 2.5 in., SS Case, liquid fill, 0-6000 psig/0-42,000 kPa, brass-1/4 NPT, center back mount	1	0.5	\$19.50

# prosense® Stainless Steel Case / Brass Wetted Pressure Gauges

ProSense Stainless Steel Case / Brass Wetted Glycerin-filled Gauges Specifications	
Dial Size	2.5" [63.5 mm]
Case	AISI 304 SS
Lens	Polycarbonate
Ring	AISI 304 SS, Crimp-On
Socket	Brass*
Connection	1/4" NPT
Fill Liquid	Glycerin
Bourdon Tube	Phosphor Bronze C-shaped for pressures up to and including 600 psig (4,147 kPa), AISI 316 SS C-shaped for 1000 psig (6,895 kPa), AISI 316 SS spiral for pressures above 1000 psig (6,895 kPa)
Movement	OT 59 brass
Wetted Parts	Brass, Phosphor Bronze
Pointer	Aluminum, anodized black
Welding	Tin/cooper alloy for pressures up to 600 psig (4,147 kPa), 316 SS TIG Argon arc for pressures 600 psig (4,147 kPa) and above
Over Pressure Limit	125% of full scale up to 1,400 psig (9,653 kPa), 115% of full scale over 1,400 psig (9,653 kPa)
Gasket Material	Silicone rubber for socket; EPDM for lens, filling plug and blow-out vent
Working Pressure	Maximum 75% of full scale value
Ambient/Process Temperature	-4 °F to 150 °F (-20 °C to 65 °C)
Accuracy	±1.5% of full scale value
Enclosure Rating	IP65

\* Leaded Brass not suitable for use in drinking water or other food & beverage applications.



**WARNING: CHECK THE CHEMICAL COMPATIBILITY OF THE GAUGE'S WETTED PARTS WITH THE MEDIUM TO BE MEASURED. USE A SUITABLE THREAD SEALANT SUCH AS TEFLON® TAPE. ALWAYS TIGHTEN WITH AN OPEN END OR ADJUSTABLE WRENCH ON THE WRENCH FLATS. NEVER USE ANY PART OF THE PRESSURE GAUGE TO TIGHTEN OTHER THAN THE WRENCH FLATS THAT ARE ON THE GAUGE SOCKET. FAILURE TO DO SO WILL SEVERELY DAMAGE THE PRESSURE GAUGE.**

**DUE TO PRESSURE BUILDUP, SOME GAUGES (USUALLY LOWER PRESSURE RANGES SUCH AS VACUUM, UP TO 100 PSIG) MAY REFLECT A READING THAT IS SLIGHTLY "OFF ZERO". TO PROPERLY "VENT" THE PRESSURE GAUGE TO ATMOSPHERE, MAKE A SMALL HOLE IN THE FILL PLUG AFTER YOU HAVE INSTALLED THE INSTRUMENT.**

## Dimensions

### Lower Mount

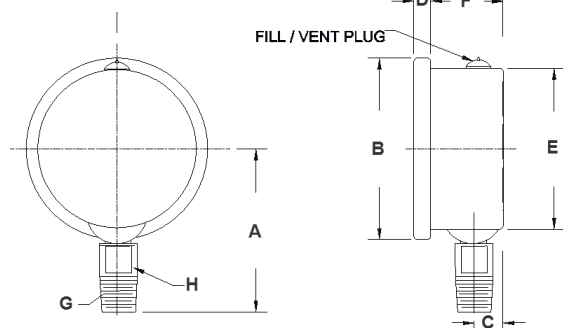

### Dimensions - Lower Mount Gauge

A	2.190" [55.6 mm]
B	2.700" [68.5 mm]
C	0.433" [11.0 mm]
D	0.250" [6.3 mm]
E	2.440" [61.9 mm]
F	1.035" [26.3 mm]
G	1/4" NPT
H	0.551" [14.0 mm]

### Center Back Mount

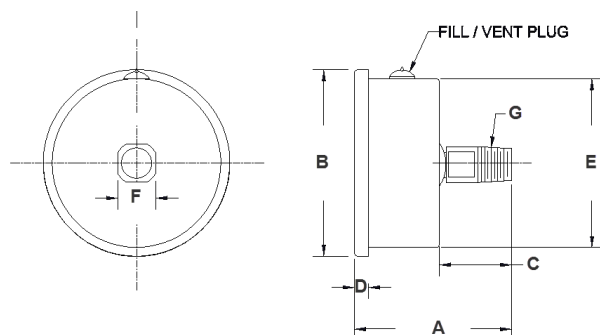

### Dimensions - Center Back Mount Gauge

A	2.264" [57.5 mm]
B	2.7" [68.5 mm]
C	1.175" [29.8 mm]
D	0.210" [5.3 mm]
E	2.445" [62 mm]
F	0.551" [14.0 mm]
G	1/4" NPT

See our website [www.AutomationDirect.com](http://www.AutomationDirect.com) for complete Engineering drawings.

# prosense® Stainless Steel Case / Stainless Steel Wetted Pressure Gauges

## Dry and Liquid Filled Cases

### Lower Mount



### Center Back Mount



## Features

- Stainless steel wetted parts for use with air, oil, water and corrosive liquids
- Restricted orifice to dampen pressure surges
- Crimp-on bezel
- Dual scale (psig/kPa)
- Dry or glycerin filled case to reduce needle fluctuations due to vibration
- $\pm 1.5\%$  of full scale value accuracy
- 5 year warranty

## Applications

- Ideal for pumps, compressors, hydraulic presses, machinery, pneumatic equipment and motors in harsh environments



## ProSense 2.5" All Stainless Steel Pressure Gauges

Part Number	Description	Pcs/Pkg	Wt(lb)	Price
<a href="#"><u>G25-SDV-4LS</u></a>	Gauge, 2.5 in., SS Case, dry, -30 to 0 inHg/-100 to 0 kPa vacuum, SS-1/4 NPT, lower mount	1	0.4	\$39.00
<a href="#"><u>G25-SD30-4LS</u></a>	Gauge, 2.5 in., SS Case, dry, 0-30 psig/0-200 kPa, SS-1/4 NPT, lower mount	1	0.4	\$39.00
<a href="#"><u>G25-SD60-4LS</u></a>	Gauge, 2.5 in., SS Case, dry, 0-60 psig/0-420 kPa, SS-1/4 NPT, lower mount	1	0.4	\$39.00
<a href="#"><u>G25-SD100-4LS</u></a>	Gauge, 2.5 in., SS Case, dry, 0-100 psig/0-700 kPa, SS-1/4 NPT, lower mount	1	0.4	\$39.00
<a href="#"><u>G25-SD160-4LS</u></a>	Gauge, 2.5 in., SS Case, dry, 0-160 psig/0-1,100 kPa, SS-1/4 NPT, lower mount	1	0.4	\$39.00
<a href="#"><u>G25-SD200-4LS</u></a>	Gauge, 2.5 in., SS Case, dry, 0-200 psig/0-1,400 kPa, SS-1/4 NPT, lower mount	1	0.4	\$39.00
<a href="#"><u>G25-SD300-4LS</u></a>	Gauge, 2.5 in., SS Case, dry, 0-300 psig/0-2,000 kPa, SS-1/4 NPT, lower mount	1	0.4	\$39.00
<a href="#"><u>G25-SD600-4LS</u></a>	Gauge, 2.5 in., SS Case, dry, 0-600 psig/0-4,200 kPa, SS-1/4 NPT, lower mount	1	0.4	\$39.00
<a href="#"><u>G25-SD1000-4LS</u></a>	Gauge, 2.5 in., SS Case, dry, 0-1000 psig/0-7,000 kPa, SS-1/4 NPT, lower mount	1	0.4	\$39.00
<a href="#"><u>G25-SDV-4CS</u></a>	Gauge, 2.5 in., SS Case, dry, -30 to 0 inHg/-100 to 0 kPa vacuum, SS-1/4 NPT, center back mount	1	0.4	\$39.00
<a href="#"><u>G25-SD30-4CS</u></a>	Gauge, 2.5 in., SS Case, dry, 0-30 psig/0-200 kPa, SS-1/4 NPT, center back mount	1	0.4	\$39.00
<a href="#"><u>G25-SD60-4CS</u></a>	Gauge, 2.5 in., SS Case, dry, 0-60 psig/0-420 kPa, SS-1/4 NPT, center back mount	1	0.4	\$39.00
<a href="#"><u>G25-SD100-4CS</u></a>	Gauge, 2.5 in., SS Case, dry, 0-100 psig/0-700 kPa, SS-1/4 NPT, center back mount	1	0.4	\$39.00
<a href="#"><u>G25-SD160-4CS</u></a>	Gauge, 2.5 in., SS Case, dry, 0-160 psig/0-1,100 kPa, SS-1/4 NPT, center back mount	1	0.4	\$39.00
<a href="#"><u>G25-SD200-4CS</u></a>	Gauge, 2.5 in., SS Case, dry, 0-200 psig/0-1,400 kPa, SS-1/4 NPT, center back mount	1	0.4	\$39.00

## ProSense 2.5" All Stainless Steel Steel Glycerin Filled Pressure Gauges

Part Number	Description	Pcs/Pkg	Wt(lb)	Price
<a href="#"><u>G25-SLV-4LS</u></a>	Gauge, 2.5 in., SS Case, liquid fill, -30 to 0 inHg/-100 to 0 kPa vacuum, SS-1/4 NPT, lower mount	1	0.5	\$42.00
<a href="#"><u>G25-SL30-4LS</u></a>	Gauge, 2.5 in., SS Case, liquid fill, 0-30 psig/0-200 kPa, SS-1/4 NPT, lower mount	1	0.5	\$42.00
<a href="#"><u>G25-SL60-4LS</u></a>	Gauge, 2.5 in., SS Case, liquid fill, 0-60 psig/0-420 kPa, SS-1/4 NPT, lower mount	1	0.5	\$42.00
<a href="#"><u>G25-SL100-4LS</u></a>	Gauge, 2.5 in., SS Case, liquid fill, 0-100 psig/0-700 kPa, SS-1/4 NPT, lower mount	1	0.5	\$42.00
<a href="#"><u>G25-SL160-4LS</u></a>	Gauge, 2.5 in., SS Case, liquid fill, 0-160 psig/0-1,100 kPa, SS-1/4 NPT, lower mount	1	0.5	\$42.00
<a href="#"><u>G25-SL200-4LS</u></a>	Gauge, 2.5 in., SS Case, liquid fill, 0-200 psig/0-1,400 kPa, SS-1/4 NPT, lower mount	1	0.5	\$42.00
<a href="#"><u>G25-SL300-4LS</u></a>	Gauge, 2.5 in., SS Case, liquid fill, 0-300 psig/0-2,000 kPa, SS-1/4 NPT, lower mount	1	0.5	\$42.00
<a href="#"><u>G25-SL600-4LS</u></a>	Gauge, 2.5 in., SS Case, liquid fill, 0-600 psig/0-4,200 kPa, SS-1/4 NPT, lower mount	1	0.5	\$42.00
<a href="#"><u>G25-SL1000-4LS</u></a>	Gauge, 2.5 in., SS Case, liquid fill, 0-1000 psig/0-7,000 kPa, SS-1/4 NPT, lower mount	1	0.5	\$42.00
<a href="#"><u>G25-SLV-4CS</u></a>	Gauge, 2.5 in., SS Case, liquid fill, -30 to 0 inHg/-100 to 0 kPa vacuum, SS-1/4 NPT, center back mount	1	0.5	\$42.00
<a href="#"><u>G25-SL30-4CS</u></a>	Gauge, 2.5 in., SS Case, liquid fill, 0-30 psig/0-200 kPa, SS-1/4 NPT, center back mount	1	0.5	\$42.00
<a href="#"><u>G25-SL60-4CS</u></a>	Gauge, 2.5 in., SS Case, liquid fill, 0-60 psig/0-420 kPa, SS-1/4 NPT, center back mount	1	0.5	\$42.00
<a href="#"><u>G25-SL100-4CS</u></a>	Gauge, 2.5 in., SS Case, liquid fill, 0-100 psig/0-700 kPa, SS-1/4 NPT, center back mount	1	0.5	\$42.00
<a href="#"><u>G25-SL160-4CS</u></a>	Gauge, 2.5 in., SS Case, liquid fill, 0-160 psig/0-1,100 kPa, SS-1/4 NPT, center back mount	1	0.5	\$42.00
<a href="#"><u>G25-SL200-4CS</u></a>	Gauge, 2.5 in., SS Case, liquid fill, 0-200 psig/0-1,400 kPa, SS-1/4 NPT, center back mount	1	0.5	\$42.00

# pro<sup>sense</sup>® Stainless Steel Case / Stainless Steel Wetted Pressure Gauges

ProSense All Stainless Steel Gauges Specifications	
Dial Size	2.5" [63 mm]
Case	AISI 304 SS
Lens	Polycarbonate
Ring	AISI 304 SS, Crimp-On
Socket	AISI 316 SS
Connection	1/4" NPT
Fill Liquid	Dry = None / Liquid Fill = Glycerin
Bourdon Tube	AISI 316 SS C-shaped for pressures up to 1000 psig (6,895 kPa)
Movement	Brass
Wetted Parts	AISI 316 SS
Pointer	Aluminum, anodized black
Welding	316 SS TIG Argon arc
Over Pressure Limit	125% of full scale
Gasket Material	Silicone rubber for socket; EPDM for lens, filling plug and blow-out vent (Liquid fill models)
Working Pressure	Maximum 75% of full scale value
Ambient/Process Temperature	-4 °F to 150 °F (-20 °C to 65 °C)
Accuracy	±1.5% of full scale value
Enclosure Rating	IP65



**WARNING: CHECK THE CHEMICAL COMPATIBILITY OF THE GAUGE'S WETTED PARTS WITH THE MEDIUM TO BE MEASURED. USE A SUITABLE THREAD SEALANT SUCH AS TEFLON® TAPE. ALWAYS TIGHTEN WITH AN OPEN END OR ADJUSTABLE WRENCH ON THE WRENCH FLATS. NEVER USE ANY PART OF THE PRESSURE GAUGE TO TIGHTEN OTHER THAN THE WRENCH FLATS THAT ARE ON THE GAUGE SOCKET. FAILURE TO DO SO WILL SEVERELY DAMAGE THE PRESSURE GAUGE.**

**DUE TO PRESSURE BUILDUP, SOME GAUGES (USUALLY LOWER PRESSURE RANGES SUCH AS VACUUM, UP TO 100 PSIG) MAY REFLECT A READING THAT IS SLIGHTLY "OFF ZERO". TO PROPERLY "VENT" THE PRESSURE GAUGE TO ATMOSPHERE, MAKE A SMALL HOLE IN THE FILL PLUG AFTER YOU HAVE INSTALLED THE INSTRUMENT.**

## Dimensions

### Lower Mount

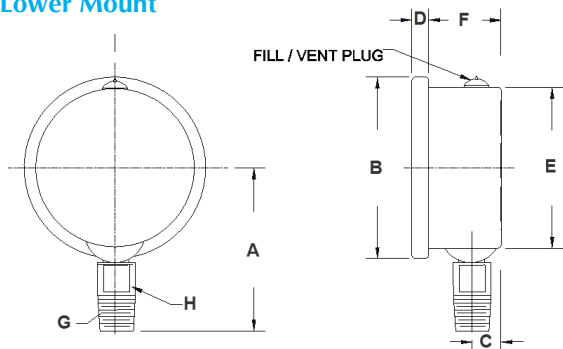

### Dimensions - Lower Mount Gauge

A	2.190" [55.6 mm]
B	2.700" [68.5 mm]
C	0.433" [11.0 mm]
D	0.250" [6.3 mm]
E	2.440" [61.9 mm]
F	1.035" [26.3 mm]
G	1/4" NPT
H	0.551" [14.0 mm]

### Center Back Mount

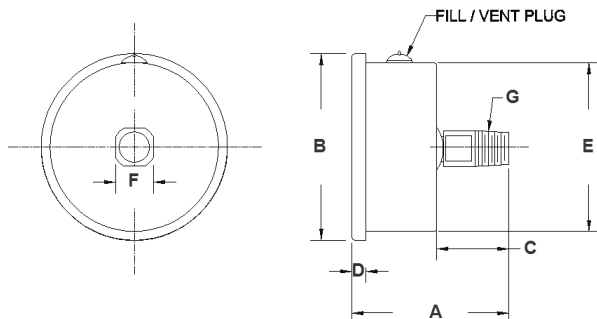

### Dimensions - Center Back Mount Gauge

A	2.264" [57.5 mm]
B	2.7" [68.5 mm]
C	1.175" [29.8 mm]
D	0.210" [5.3 mm]
E	2.445" [62 mm]
F	0.551" [14.0 mm]
G	1/4" NPT

See our website [www.AutomationDirect.com](http://www.AutomationDirect.com) for complete Engineering drawings.



# proSense® Differential Pressure Gauges

Part No. DGA-30

## Features

- Industrial grade black die-cast aluminum case
- High temperature tolerance
- Resistance-free movement
- 2% full scale accuracy
- Re-zero adjustment
- Mounting and connection hardware included. Other mounting accessories available.
- 5-year warranty

## Applications

- Air and compatible non-combustible gasses
- Indicates positive, negative or differential pressure:
  - Filter status
  - Duct static pressure
  - Clean rooms
- Paint booths
- Fans or blowers
- Dust collectors
- Cabinet purging



ProSense Differential Pressure Gauges				
Part Number	Description	Pcs/Pkg	Wt(lb)	Price
<u>DGA-01</u>	ProSense differential pressure gauge, 0 to 1" water column range	1	1.43	\$67.00
<u>DGA-02</u>	ProSense differential pressure gauge, 0 to 2" water column range	1	1.43	\$67.00
<u>DGA-03</u>	ProSense differential pressure gauge, 0 to 3" water column range	1	1.43	\$67.00
<u>DGA-04</u>	ProSense differential pressure gauge, 0 to 4" water column range	1	1.43	\$67.00
<u>DGA-05</u>	ProSense differential pressure gauge, 0 to 5" water column range	1	1.43	\$67.00
<u>DGA-10</u>	ProSense differential pressure gauge, 0 to 10" water column range	1	1.43	\$72.00
<u>DGA-15</u>	ProSense differential pressure gauge, 0 to 15" water column range	1	1.43	\$72.00
<u>DGA-20</u>	ProSense differential pressure gauge, 0 to 20" water column range	1	1.43	\$72.00
<u>DGA-25</u>	ProSense differential pressure gauge, 0 to 25" water column range	1	1.43	\$72.00
<u>DGA-30</u>	ProSense differential pressure gauge, 0 to 30" water column range	1	1.43	\$72.00
<u>DGA-40</u>	ProSense differential pressure gauge, 0 to 40" water column range	1	1.43	\$72.00
<u>DGA-50</u>	ProSense differential pressure gauge, 0 to 50" water column range	1	1.43	\$72.00
<u>DGA-100</u>	ProSense differential pressure gauge, 0 to 100" water column range	1	1.43	\$72.00
<u>DGA-150</u>	ProSense differential pressure gauge, 0 to 150" water column range	1	1.43	\$72.00
<u>DGA-01B</u>	ProSense differential pressure gauge, -1 to 1" water column range	1	1.43	\$67.00
<u>DGA-02B</u>	ProSense differential pressure gauge, -2 to 2" water column range	1	1.43	\$67.00
<u>DGA-05B</u>	ProSense differential pressure gauge, -5 to 5" water column range	1	1.43	\$67.00
<u>DGA-10B</u>	ProSense differential pressure gauge, -10 to 10" water column range	1	1.43	\$72.00
<u>DGA-15B</u>	ProSense differential pressure gauge, -15 to 15" water column range	1	1.43	\$72.00

ProSense Differential Pressure Gauges Specifications	
Dial Size	4" (100mm), white aluminum with black markings
Case	Die-cast black aluminum
Lens	Polycarbonate
Ring	Threaded die-cast black aluminum
Connection	(2) high and (2) low pressure ports, 1/8" female NPT, located on side and back
Wetted Parts	Aluminum, silicone rubber
Mounting	Vertical position, flush or surface mount with included hardware
Movement	Resistance-free and magnetic
Pointer	Aluminum, anodized black
Media	Air and compatible non-combustible gases
Over Pressure Limit	14.5 psi / 100 kPa / 400 inH <sub>2</sub> O maximum
Ambient Temperature	-40°F to 140°F (-40°C to 60°C)
Process Temperature	14°F to 140°F (-10°C to 60°C)
Accuracy	±2% of full scale
IP Rating	Unit IP67 - Enclosure rating dependent on installation method

# prosense® Differential Pressure Gauges

## Dimensions

inches [mm]

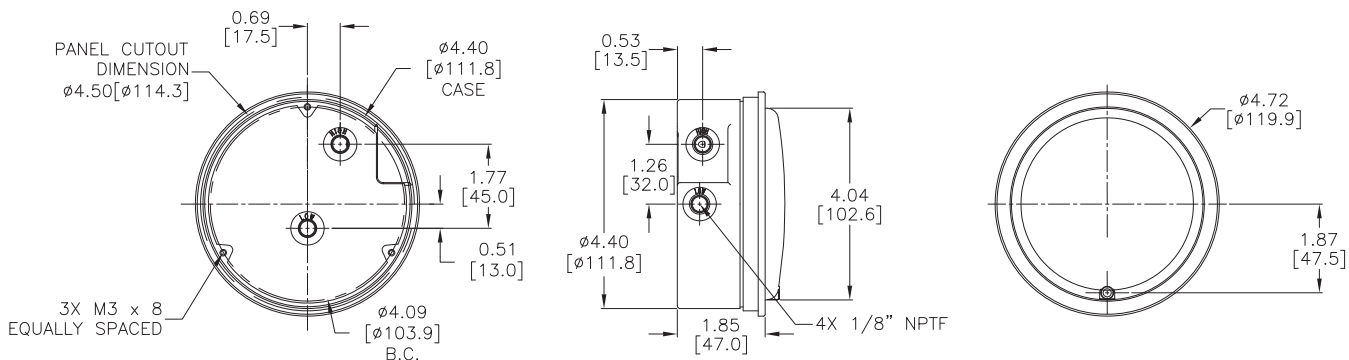

### Panel Mounting

Cut a circular opening in the panel to allow a close fit of 4.41" (112mm) gauge case diameter. Refer to above drawing.

- Gauges include:
  - (3) angled mounting brackets with short and long screws
  - (2) brass hose barb connectors with 1/8" NPT threads\*
  - (2) 1/8" NPT threaded plugs
- \*Note: Plastic tubing with a minimum inside diameter of 0.170 inches and less than 0.275 inches can be used with the brass hose barb connectors.

See our website [www.AutomationDirect.com](http://www.AutomationDirect.com) for complete Engineering drawings.



DGA shown with included brackets, screws, fittings and plugs

## Application Examples



Air/gas flow as a function of blower static pressure

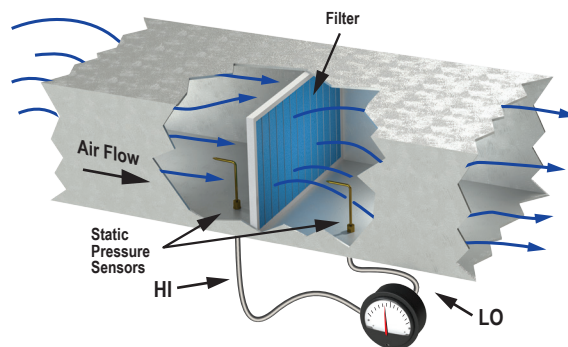

Filter condition monitoring

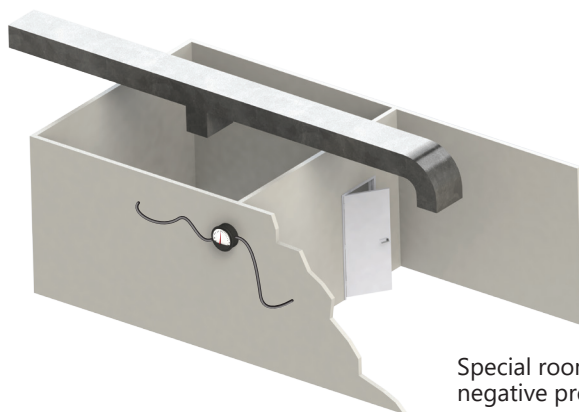

Special room positive or negative pressure indication

# prosense® Differential Pressure Gauges

## Accessories

### Applications

- **DGA-T Static Pressure Tip:**  
Use the **DGA-T** to sense static pressure in ducts, across filters, coils, fans, etc. The angled tip is brass, has a 4" insertion depth and four radial 0.04" sensing holes. The tip also has a compression fitting for use with 1/4" OD metal or plastic tubing.
- **DGA-B Surface Mount Bracket:**  
Mount the DGA gauge to the pre-drilled holes in the metal **DGA-B** mounting bracket and then mount the bracket to any vertical flat surface.
- **DGA-R Panel Mount Flange:**  
Secure the plastic flange to the DGA gauge with the three set screws in the flange. The DGA can now be mounted to a panel using the three mounting holes in the flange and the included mounting screws.

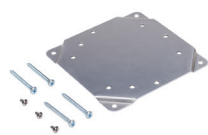
Part No. **DGA-B**Part No. **DGA-R**Part **DGA-B** shown with  
DGA Differential Pressure  
GaugePart **DGA-R** shown with  
DGA Differential Pressure  
GaugePart No. **DGA-T**

ProSense Differential Pressure Gauges Accessories				
Part Number	Description	Pcs/Pkg	Wt(lb)	Price
<b>DGA-T</b>	ProSense static pressure tip with compression fitting, brass, for use with DGA series differential pressure gauges or DPTA series differential pressure transmitters.	1	0.07	\$18.00
<b>DGA-B</b>	ProSense surface mount bracket, aluminum, for use with DGA series differential pressure gauges. Hardware included.	1	0.1	\$11.50
<b>DGA-R</b>	ProSense panel mount flange, ABS plastic, for use with DGA series differential pressure gauges. Hardware included.	1	0.15	\$12.00

### Dimensions

inc

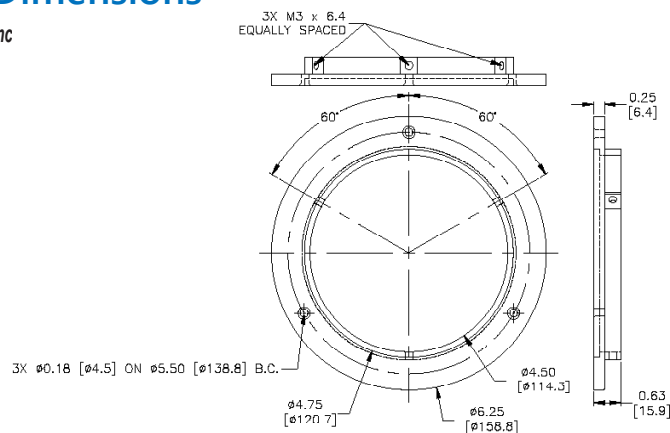
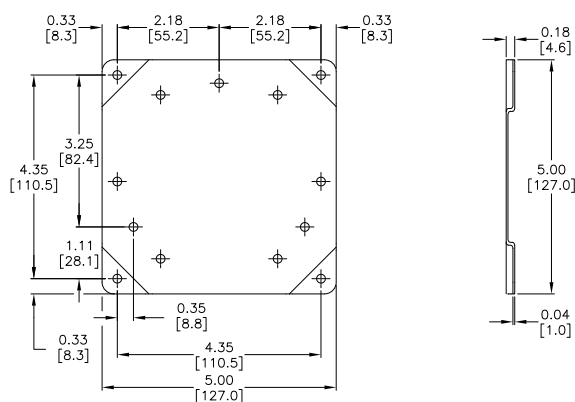
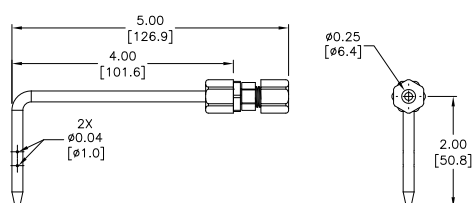
Part No. **DGA-R**Part No. **DGA-B**Part No. **DGA-T**See our website [www.AutomationDirect.com](http://www.AutomationDirect.com) for complete Engineering drawings.



# Siphons



Part No. SSP545-ADC



Part No. SSP556-ADC



Part No. SSP595-ADC

## Description

Siphons, also called pigtails, are used to protect pressure gauges, transmitters, transducers, and switches from the effect of high-temperature pressure media such as steam. Inside the coil or pigtail portion of the siphon, the pressure media forms condensate that is lower in temperature than the media. The condensate prevents the higher temperature media from coming in direct contact with the pressure instrument. When the siphon is first installed, it should be filled with water or any other suitable separating liquid.

## Features

- Ideal for protecting pressure instruments from hot media temperatures in steam pressure applications
- Available in brass, carbon steel, or stainless steel for compatibility with different media
- 1/4in male NPT process connections
- 5-year warranty



Example assembly of SSP series siphon, NVA series isolation valve, and G25 series pressure gauge. The female coupling is not available from AutomationDirect.

Siphon Selection					
Part Number	Description	Pcs/Pkg	Wt(lb)	Price	Drawing Link
<a href="#">SSP545-ADC</a>	Winters siphon, brass body, 1/4in male NPT x 1/4in male NPT.	1	0.45	\$12.50	<a href="#">PDF</a>
<a href="#">SSP556-ADC</a>	Winters siphon, carbon steel body, 1/4in male NPT x 1/4in male NPT.	1	0.45	\$8.50	<a href="#">PDF</a>
<a href="#">SSP595-ADC</a>	Winters siphon, stainless steel body, 1/4in male NPT x 1/4in male NPT.	1	0.45	\$41.50	<a href="#">PDF</a>

Siphon Specifications	
<b>Material*</b>	Schedule 40 brass, schedule 80 carbon steel or schedule 80 304 SS (all types seamless)
<b>Style</b>	180° coil
<b>Connection</b>	1/4in male NPT x 1/4in male NPT
<b>Maximum Operating Pressure</b>	Schedule 40: Brass, 500 psi at 680°F (360°C) Schedule 80: Carbon steel, 304 SS, 1,650 psi at 630°F (332°C)
<b>Maximum Operating Temperature</b>	Schedule 40: Brass, 680°F (360°C) Schedule 80: Carbon steel, 304 SS, 630°F (332°C) Recommended for applications above 100°F (37°C)
<b>Warning (brass siphons only)</b>	<b>WARNING:</b> This product can expose you to chemicals, including lead, which is known to the State of California to cause cancer and birth defects or other reproductive harm. For more information go to <a href="http://www.P65Warnings.ca.gov">www.P65Warnings.ca.gov</a> .

\* To avoid the possibility of galvanic corrosion, it is recommended not to use dissimilar metals together.



# Pressure Snubbers

## Description

Pressure Snubbers are used to protect pressure measurement instruments such as gauges, transmitters, transducers and switches by suppressing the effect of pressure pulsations and spikes commonly found in harsh applications involving reciprocating pumps and compressors, hydraulic presses or fluid power systems. The SSN series of pressure snubbers incorporates a sintered, porous 316 stainless steel snubbing element with a large surface area to slow rapid pressure changes and surges, thereby improving readability and preventing wear and damage to delicate instrument mechanisms. These pressure snubbers are available with brass or stainless steel bodies and porous snubbing elements designed for water, air or heavy oil viscosity applications.



Example assembly of SSN series snubber and G25 series pressure gauge.



Part No. SSN515-ADC



Part No. SSN518-ADC

## Features

- Incorporates a sintered, porous 316 stainless steel snubbing element with a large surface area to ensure long term effectiveness
- Available in the three standard viscosity classifications of heavy oil, water and air
- Brass or stainless steel bodies depending upon pressure media and operating pressure
- 1/4in male NPT x 1/4in female NPT process connections
- ASME B40.100 compliant
- 5-year warranty



## Pressure Snubber Selection

Part Number	Description	Pcs/Pkg	Wt(lb)	Price	Drawing Link
<a href="#">SSN515-ADC</a>	Winters water snubber, porous brass element, brass body, 1/4in male NPT x 1/4in female NPT.	1	0.17	\$11.00	<a href="#">PDF</a>
<a href="#">SSN516-ADC</a>	Winters air snubber, porous brass element, brass body, 1/4in male NPT x 1/4in female NPT.	1	0.17	\$11.00	<a href="#">PDF</a>
<a href="#">SSN517-ADC</a>	Winters heavy oil snubber, porous brass element, brass body, 1/4in male NPT x 1/4in female NPT.	1	0.17	\$11.00	<a href="#">PDF</a>
<a href="#">SSN518-ADC</a>	Winters water snubber, porous stainless steel element, stainless steel body, 1/4in male NPT x 1/4in female NPT.	1	0.17	\$14.50	<a href="#">PDF</a>
<a href="#">SSN519-ADC</a>	Winters air snubber, porous stainless steel element, stainless steel body, 1/4in male NPT x 1/4in female NPT.	1	0.17	\$19.00	<a href="#">PDF</a>
<a href="#">SSN520-ADC</a>	Winters heavy oil snubber, porous stainless steel element, stainless steel body, 1/4in male NPT x 1/4in female NPT.	1	0.17	\$18.00	<a href="#">PDF</a>

## Pressure Snubber Specifications

Body*	316 Stainless Steel	Brass
Connection	1/4in male NPT x 1/4in female NPT process connections	
Operating Temperature	-320°F to 1,500°F (-195°C to 815°C)	-65°F to 650°F (-53°C to 343°C)
Operating Pressure	Maximum 20,000 psi (137,900 kPa)	Maximum 10,000 psi (68,950 kPa)
Burst Pressure	60,000 psi (413,700 kPa)	30,000 psi (206,850 kPa)
Snubbing Element	Sintered, porous type 316 SS	Sintered, porous brass
Retainer	300 series SS	300 series SS
Warning (brass internals only)	N/A	<b>WARNING:</b> This product can expose you to chemicals, including lead, which is known to the State of California to cause cancer and birth defects or other reproductive harm. For more information go to <a href="http://www.P65Warnings.ca.gov">www.P65Warnings.ca.gov</a> .

\* To avoid the possibility of galvanic corrosion, it is recommended not to use dissimilar metals together.





# Adjustable Pressure Snubbers

## Description

Adjustable pressure snubbers are used to protect pressure measurement instruments such as gauges, transmitters, transducers and switches by suppressing the effect of pressure pulsations and spikes commonly found in harsh applications involving reciprocating pumps and compressors, hydraulic presses or fluid power systems. The SAS series of pressure snubbers incorporates an adjustable stem snubbing element to slow rapid pressure changes and surges, thereby improving readability and preventing wear and damage to delicate instrument mechanisms. These pressure snubbers are available with brass or stainless steel bodies and adjustable stem snubbing element to meet a wide variety of media viscosity applications.



Part No. SAS540-ADC



Part No. SAS542-ADC

## Features

- Adjustable stem snubbing element to meet a wide variety of media viscosity applications.
- Brass or stainless steel bodies depending upon pressure media
- 1/4in male NPT x 1/4in female NPT process connections
- ASME B40.100 compliant
- 5-year warranty



Example assembly of SAS series adjustable snubber and G25 series pressure gauge.

## Adjustable Pressure Snubber Selection

Part Number	Description	Pcs/Pkg	Wt(lb)	Price	Drawing Link
<a href="#">SAS540-ADC</a>	Winters snubber, adjustable brass stem and PTFE seal element, brass body, 1/4in male NPT x 1/4in female NPT.	1	1.10	\$28.00	<a href="#">PDF</a>
<a href="#">SAS542-ADC</a>	Winters snubber, adjustable stainless steel stem and PTFE seal element, stainless steel body, 1/4in male NPT x 1/4in female NPT.	1	1.10	\$44.50	<a href="#">PDF</a>

## Adjustable Pressure Snubber Specifications

<b>Body*</b>		316 Stainless Steel	Brass
<b>Connection</b>		1/4in male NPT x 1/4in female NPT process connections	
<b>Operating Temperature</b>		-40°F to 248°F (-40°C to 120°C)	
<b>Operating Pressure</b>		6,000 psi maximum	
<b>Materials (reference chart below)</b>	<b>1 - Gland Washer</b>	316 SS	316 SS
	<b>2 - Gland Seal</b>	PTFE (Polytetrafluoroethylene)/Graphite	PTFE (Polytetrafluoroethylene)/Graphite
	<b>3 - Gland</b>	316 SS	Brass
	<b>4 - Stem</b>	316 SS	Brass
<b>Warning</b>		N/A	<b>WARNING:</b> This product can expose you to chemicals, including lead, which is known to the State of California to cause cancer and birth defects or other reproductive harm. For more information go to <a href="http://www.P65Warnings.ca.gov">www.P65Warnings.ca.gov</a> .

\* To avoid the possibility of galvanic corrosion, it is recommended not to use dissimilar metals together.

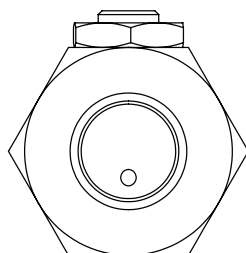
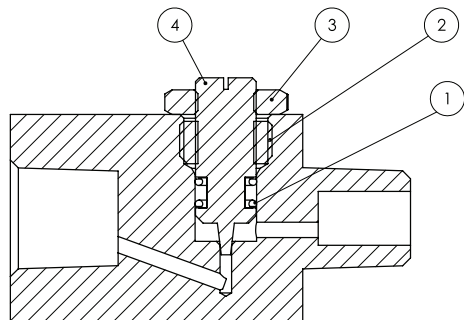





# Manual Isolation and Throttling Needle Valves

## Description

Manual isolation and throttling needle valves are commonly used to block and isolate pressure instruments such as gauges, transmitters, transducers and switches from the sensed media pressure allowing for quick and easy removal and maintenance of the instruments without shutting down the process. The one-piece, weld-free stainless steel body provides strength, safety, and corrosion resistance for a wide variety of process fluids and gases. Available in either a soft seat or hard seat version, these valves provide leak-tight shut-off. Needle valves are also used in flow-metering applications, especially when a constant, calibrated, low flow rate must be maintained. The needle shaped plunger, small orifice and tapered seat allow for precise manual regulation of flow rate.

## Features

- Excellent flow regulation and leak tight
- The one-piece body construction (no welding) provides strength, safety and corrosion resistance
- "Slow opening" prevents sudden pressure surge and instrument damage
- Materials include carbon steel and stainless steel
- Available in Soft and Hard Seat (6,000 psi)
- ASME B1.20.1 compliant
- 5-year warranty



Part No. NVA1000-ADC



Example assembly of NVA series isolation valve and G25 series pressure gauge.

## Manual Isolation and Throttling Needle Valve Selection

Part Number	Description	Pcs/Pkg	Wt(lb)	Price	Drawing Link
<b>NVA1000-ADC</b>	Winters manual isolation and throttling needle valve, straight body soft seat, single handle, stainless steel body, 1/4in male NPT inlet(s), 1/4in female NPT outlet(s).	1	1.10	\$47.50	<a href="#">PDF</a>
<b>NVA2000-ADC</b>	Winters manual isolation and throttling needle valve, straight body hard seat, single handle, stainless steel body, 1/4in male NPT inlet(s), 1/4in female NPT outlet(s).	1	1.10	\$51.00	<a href="#">PDF</a>

## Manual Isolation and Throttling Needle Valve Specifications

<b>Connection</b>	1/4in male NPT x 1/4in female NPT process connections
<b>Maximum Pressure</b>	6,000 psi @ 212°F (100°C)
<b>Operating Temperature</b>	32°F to 977°F (0°C to 525°C)

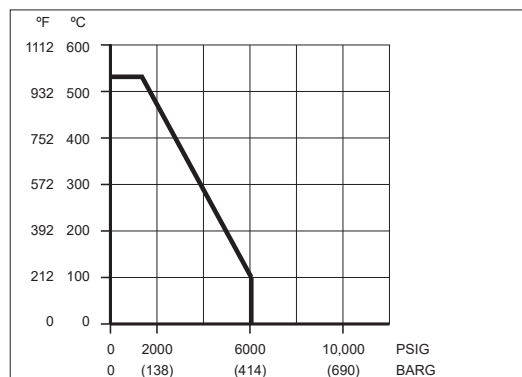

The maximum pressure and temperature are directly related for the NVA series valves. This derating chart should be used to find the maximum pressure allowed at the operating temperature.



# Manual Isolation and Throttling Needle Valves

## Soft Seat Manual Isolation and Throttling Needle Valve Materials

Description	Component Number	Component Material
Body*	1	316 SS
Bonnet	2	316 SS
Dustcap	3	Nylon
Needle / Needle Tip	4	316 SS
Handle	5	304 SS
Screw	6	304 SS
Fastening Screw	7	304 SS
O-ring	8	FKM (Viton®)
Seat	9	Delrin
Slotted Spring Pin	10	304 SS

\* To avoid the possibility of galvanic corrosion, it is recommended not to use dissimilar metals together.

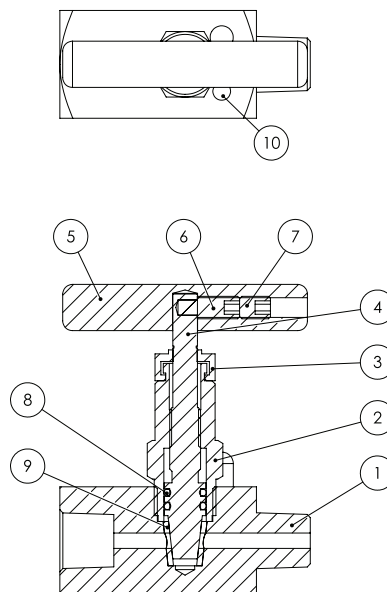

## Hard Seat Manual Isolation and Throttling Needle Valve Materials

	Component Number	Component Material
Body*	1	316 SS
Bonnet	2	316 SS
Adapter Locknut	3	304 SS
Adapter	4	316 SS
Dustcap	5	Nylon
Handle	6	304 SS
Screw	7	304 SS
Fastening Screw	8	304 SS
Needle / Needle Tip	9	316 SS
Gland Washer	10	304 SS
Gland Packing	11	PTFE (Polytetrafluoroethylene)/ Graphite
Dwell Pin	12	304 SS
Gland Packing	13	PTFE/Graphite

\* To avoid the possibility of galvanic corrosion, it is recommended not to use dissimilar metals together.

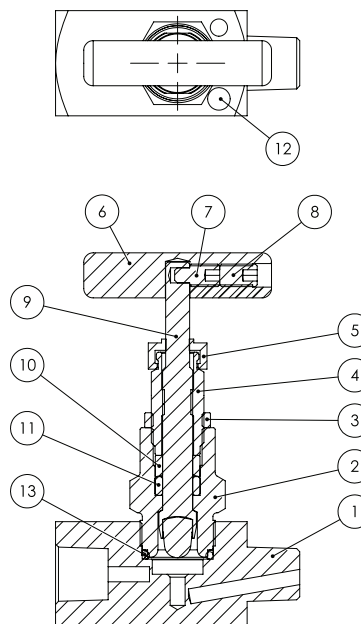



# Manual Block and Bleed Needle Valves

## Description

Manual block and bleed needle valves are commonly used to block and isolate pressure instruments such as gauges, transmitters, transducers and switches from the sensed media pressure. They allow for easy removal and maintenance of the instruments without shutting down the process. Additionally, the 1/4" NPT bleed port allows pressure in the sensed line to be bled off without disturbing the permanent piping installation. The one-piece, weld-free stainless steel body provides strength, safety, and corrosion resistance for a wide variety of process fluids and gases. Available in either a soft seat or hard seat version, these valves provide leak-tight shut-off. Needle valves are also used in flow-metering applications, especially when a constant, calibrated, low flow rate must be maintained. The needle-shaped plunger, small orifice and tapered seat allow for precise manual regulation of flow rate.



Part No. BBV1200-ADC



Example assembly of BBV series block and bleed valve and G25 series pressure gauge.

## Features

- The one-piece body construction (no welding) provides strength and corrosion resistance
- Block & bleed design allows pressure to be bled off without disturbing the permanent piping installation, allowing quick and easy removal or replacement of instruments
- Available in Soft Seat (6,000 psi) and Hard Seat (10,000 psi)
- All stems are 316 stainless steel
- 5-year warranty



## Manual Block and Bleed Needle Valve Selection

Part Number	Description	Pcs/Pkg	Wt(lb)	Price	Drawing Link
<b>BBV1200-ADC</b>	Winters manual block and bleed needle valve, straight body soft seat, double handles, stainless steel body, 1/4in male NPT inlet(s), 1/4in female NPT outlet(s).	1	2.20	\$117.00	<a href="#">PDF</a>
<b>BBV3200-ADC</b>	Winters manual block and bleed needle valve, straight body hard seat, double handles, stainless steel body, 1/4in male NPT inlet(s), 1/4in female NPT outlet(s).	1	2.20	\$90.00	<a href="#">PDF</a>

## Manual Isolation and Throttling Needle Valve Specifications

<b>Connection</b>	1/4in male NPT x 1/4in female NPT process connections
<b>Maximum Pressure</b>	Soft Seat: 6,000 psi @ 212°F (100°C) Hard Seat: 10,000 psi @ 104°F (40°C)
<b>Operating Temperature</b>	32°F to 383°F (0°C to 195°C)

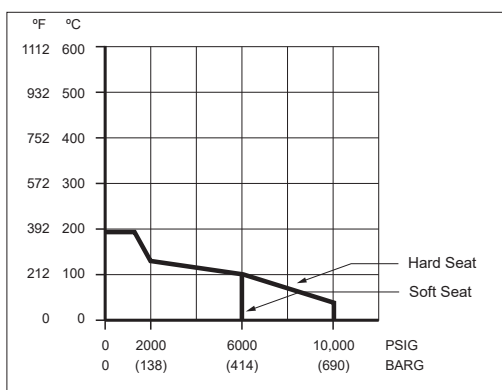

The maximum pressure and temperature are directly related for the BBV series valves. This derating chart should be used to find the maximum pressure allowed at the operating temperature.



# Manual Block and Bleed Needle Valves

Soft Seat Manual Isolation and Throttling Needle Valve Materials		
Description	Component Number	Component Material
Body*	1	316 SS
Bonnet	2	316 SS
Dustcap	3	Nylon
Needle / Needle Tip	4	316 SS
Handle	5	304 SS
Screw	6	304 SS
Fastening Screw	7	304 SS
O-rings	8	FKM (Viton®)
Seat	9	Delrin
Dwell Pin	10	304 SS
Vent Plug	11	316 SS

\* To avoid the possibility of galvanic corrosion, it is recommended not to use dissimilar metals together.

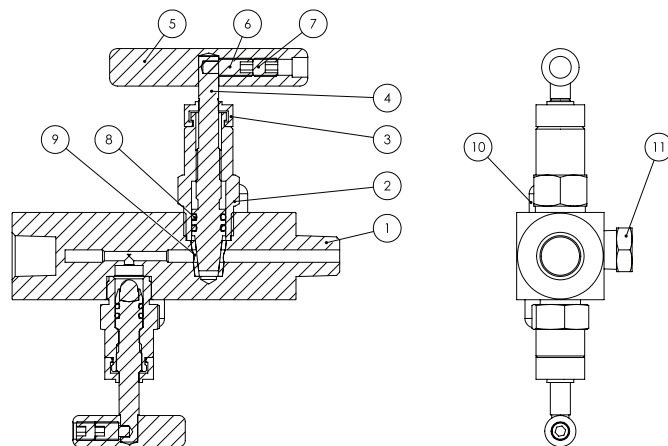

Hard Seat Manual Isolation and Throttling Needle Valve Materials		
Description	Component Number	Component Material
Body*	1	316 SS
Bonnet	2	316 SS
Dustcap	3	Nylon
Needle / Needle Tip	4	316 SS
Handle	5	304 SS
Screw	6	304 SS
Fastening Screw	7	304 SS
O-rings	8	FKM (Viton®)
Dwell Pin	9	304 SS
Vent Plug	10	316 SS

\* To avoid the possibility of galvanic corrosion, it is recommended not to use dissimilar metals together.

