

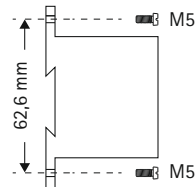

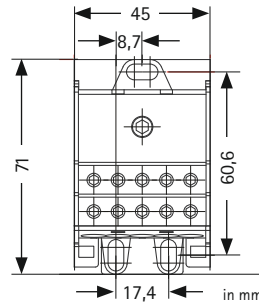

38676

I_n	125 A CU - IEC
	100 A AL - IEC
	115 A CU - UL
	90 A AL - UL
U_i	1000 V AC / 1500 V DC - IEC
	600 V AC/DC - UL

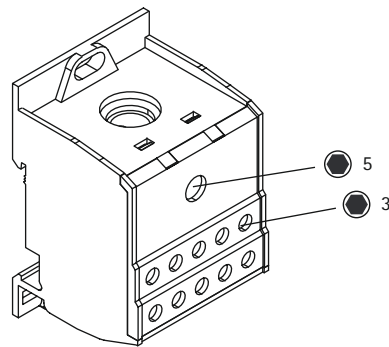

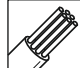
TORQUE			
3,5 Nm 31 lb.in	10 - 35 mm ² 8 - 2 AWG		1 × Ø 10 mm 15 mm
2 Nm 18 lb.in	2,5 - 10 mm ² 14 - 6 AWG	2,5 - 16 mm ² 14 - 4 AWG	10 × Ø 6,5 mm 11 mm

Technical changes and errors as well as changes in appearance reserved.

BAV-00125-C | 19.06.2024