

- Ⓓ Anschluss **ausschließlich** durch ausgebildete Elektro-Fachkräfte.
- ⒼB Electrical connection is to be made by trained electrical specialists **only**.
- Ⓕ Le branchement doit **uniquement** être effectué par des professionnels.
- Ⓡ Il collegamento deve essere eseguito **solo** da elettricisti specializzati.
- Ⓔ La conexión **sólo** debe ser realizada por electricistas debidamente formados.
- Ⓟ A ligação deve ser feita **exclusivamente** por profissional eléctrico especializado.
- ⒸZ Připojení smí **provádět** pouze kvalifikovaný personál.
- ⓅL Podłączenie **wyłącznie** przez specjalistów-elektryków.
- ⒻI Liittäminen kuuluu **ainoastaan** koulutettujen sähköalan ammattilaisten tehtäviin.
- ⓇUS Подключение проводится только специалистом-электриком.
- ⒻR Bağlantı **sadece** eğitimli elektrik teknisyenleri tarafından yapılmalıdır.
- ⒸN 布线需由专业电工执行

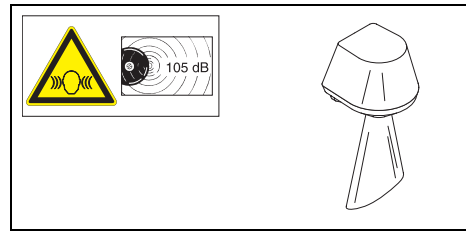

100 Hz	105 dB(A) / 1m
571 052 67	115 V~, 200 mA
571 052 68	230 V~, 70 mA
571 052 55	24 V=, 350 mA

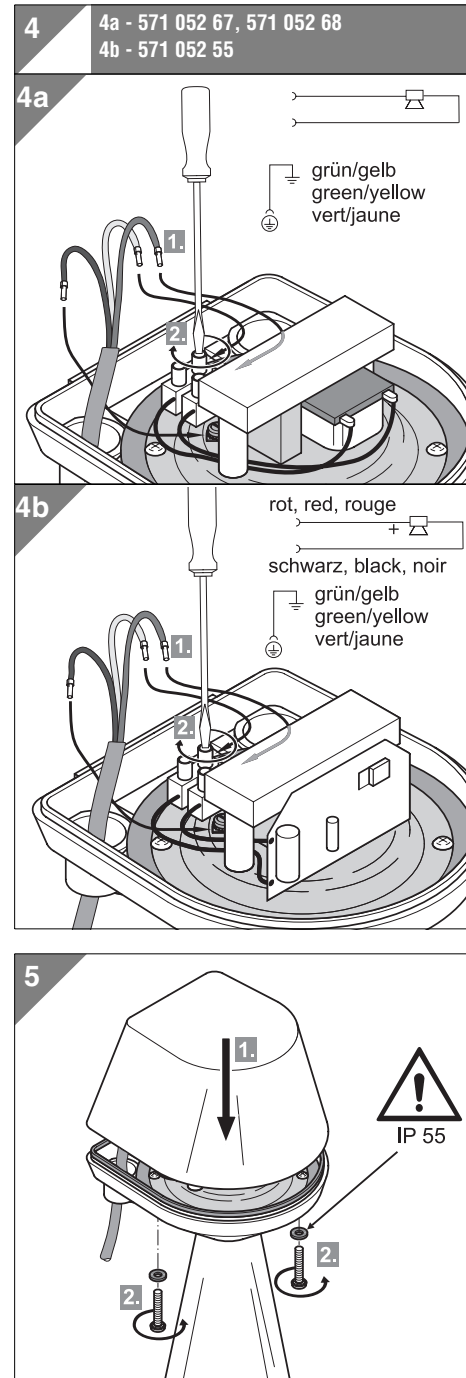
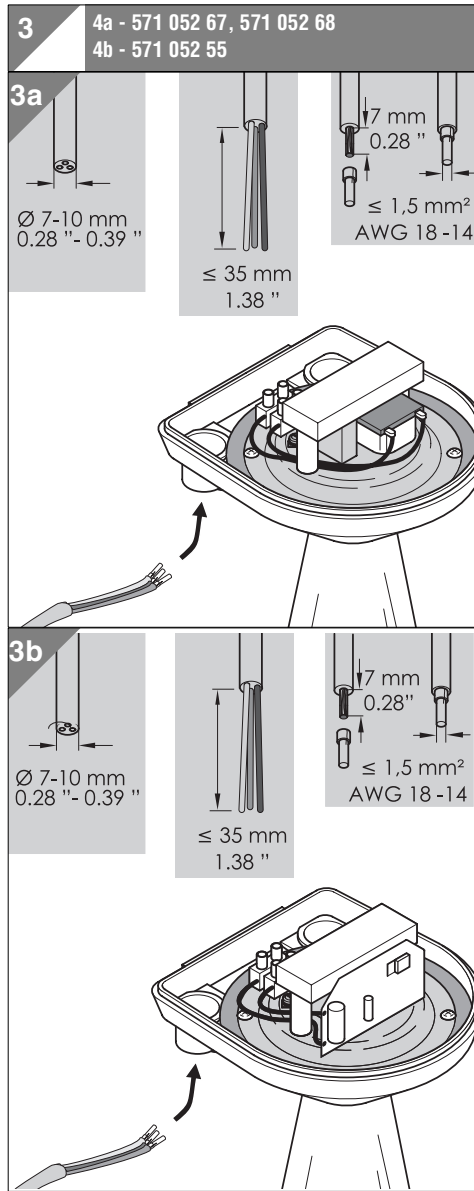
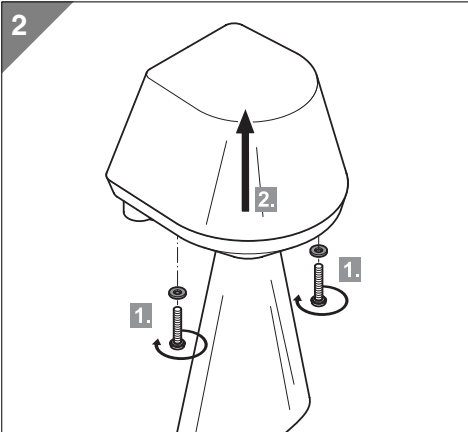
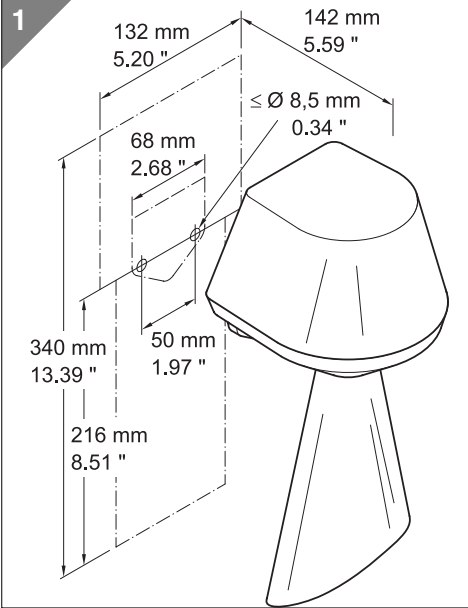

310.571.001.0208

© D

WERMA
SIGNALTECHNIK